

# OVERLAY DOOR ANGLE HINGE

L=R

AHS

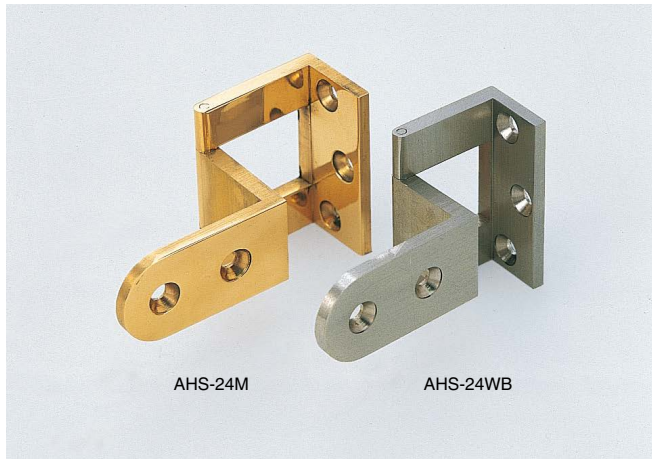

**Remarks**

Recommended for use in pairs.

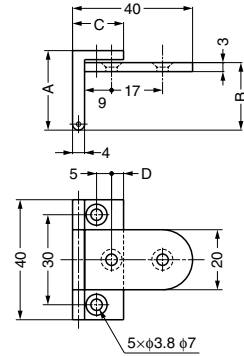
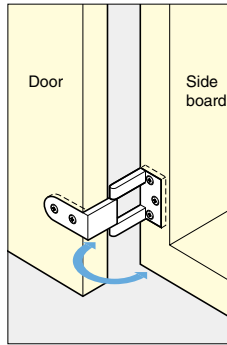

Item Code	Item Name	Material	Finish	A	B	C	D	Door				Weight	Box	Carton
								Width	Height	Thickness	Weight			
170-090-010	AHS-20M	Brass	Polished	26.5	22.5	17	4	Max. 450	Max. 700	20	Max. 2.6 kg/2 pcs	61 g	20 pcs	360 pcs
170-090-011	AHS-20WB	Brass	Satin Nickel	26.5	22.5	17	4	Max. 450	Max. 700	20	Max. 2.6 kg/2 pcs	61 g	20 pcs	360 pcs
170-090-015	AHS-24M	Brass	Polished	30.5	27	20	5.5	Max. 450	Max. 700	24	Max. 2.6 kg/2 pcs	71 g	20 pcs	360 pcs
170-090-016	AHS-24WB	Brass	Satin Nickel	30.5	27	20	5.5	Max. 450	Max. 700	24	Max. 2.6 kg/2 pcs	71 g	20 pcs	360 pcs

# OVERLAY DOOR ANGLE HINGE

L=R

AHW

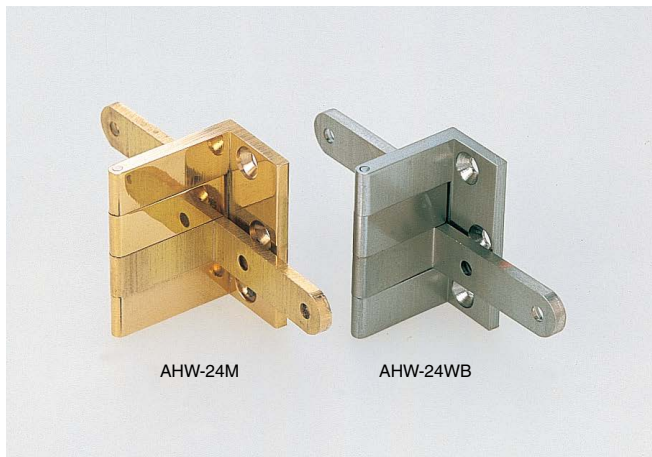

**Remarks**

Recommended for use in pairs.

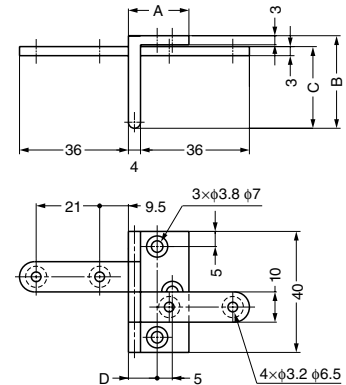
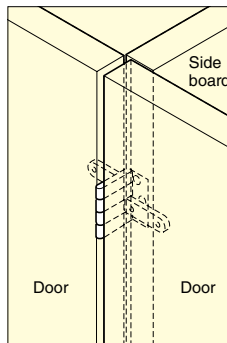

Item Code	Item Name	Material	Finish	A	B	C	D	Door				Weight	Box	Carton
								Width	Height	Thickness	Weight			
170-090-020	AHW-20M	Brass	Polished	17	26.5	22.5	8	Max. 450	Max. 700	20	Max. 2.6 kg/2 pcs	63 g	25 pcs	200 pcs
170-090-021	AHW-20WB	Brass	Satin Nickel	17	26.5	22.5	8	Max. 450	Max. 700	20	Max. 2.6 kg/2 pcs	63 g	25 pcs	200 pcs
170-090-025	AHW-24M	Brass	Polished	20	30.5	27	9.5	Max. 450	Max. 700	24	Max. 2.6 kg/2 pcs	72 g	20 pcs	80 pcs
170-090-026	AHW-24WB	Brass	Satin Nickel	20	30.5	27	9.5	Max. 450	Max. 700	24	Max. 2.6 kg/2 pcs	72 g	20 pcs	80 pcs