

BUTT HINGE

L=R TTS-100 SERIES

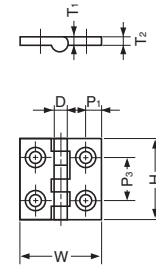

TTS-101 - 106

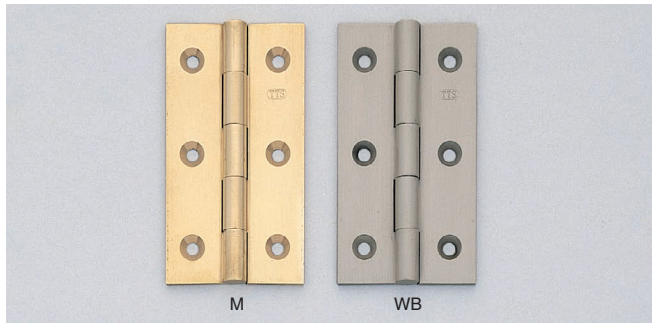
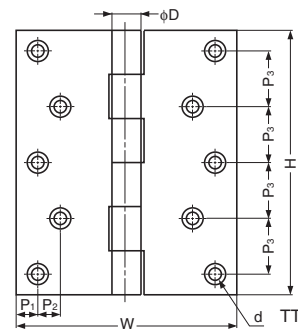

TTS-107 - 109

Item Code	Item Name	Finish	Material	H	W	T ₁	T ₂	D	P ₁	P ₂	P ₃	d	Weight	Box
170-090-144	TTS-101M	Polished	Brass	25	27	2	1.8	4.5	5	-	14	4xφ3	11 g	100 pcs
170-090-130	TTS-101WB	Satin Nickel	Brass	25	27	2	1.8	4.5	5	-	14	4xφ3	11 g	100 pcs
170-090-145	TTS-102M	Polished	Brass	32	27	2	1.8	4.5	5	-	19	4xφ3	15 g	100 pcs
170-090-131	TTS-102WB	Satin Nickel	Brass	32	27	2	1.8	4.5	5	-	19	4xφ3	15 g	100 pcs
170-090-146	TTS-103M	Polished	Brass	38	27	2	1.8	4.5	5	-	13	6xφ3	20 g	100 pcs
170-090-132	TTS-103WB	Satin Nickel	Brass	38	27	2	1.8	4.5	5	-	13	6xφ3	20 g	100 pcs
170-090-147	TTS-104M	Polished	Brass	50	32	2.2	2.1	5.2	6	-	18	6xφ3.5	30 g	100 pcs
170-090-133	TTS-104WB	Satin Nickel	Brass	50	32	2.2	2.1	5.2	6	-	18	6xφ3.5	30 g	100 pcs
170-090-148	TTS-105M	Polished	Brass	65	38	2.4	2.3	6.1	7	-	25	6xφ3.6	54 g	50 pcs
170-090-134	TTS-105WB	Satin Nickel	Brass	65	38	2.4	2.3	6.1	7	-	25	6xφ3.6	54 g	50 pcs
170-090-149	TTS-106M	Polished	Brass	75	42	2.6	2.5	7.1	8	-	27	6xφ3.8	77 g	50 pcs
170-090-135	TTS-106WB	Satin Nickel	Brass	75	42	2.6	2.5	7.1	8	-	27	6xφ3.8	77 g	50 pcs
170-090-150	TTS-107M	Polished	Brass	90	56	3.2	2.8	8	7	5	24.6	8xφ4.1	146 g	10 pcs
170-090-136	TTS-107WB	Satin Nickel	Brass	90	56	3.2	2.8	8	7	5	24.6	8xφ4.1	146 g	10 pcs
170-090-151	TTS-108M	Polished	Brass	100	68	3.5	3	8.5	9	6	26	8xφ4.5	206 g	10 pcs
170-090-137	TTS-108WB	Satin Nickel	Brass	100	68	3.5	3	8.5	9	6	26	8xφ4.5	206 g	10 pcs
170-090-152	TTS-109M	Polished	Brass	125	82	4.2	3.7	10	10	10	26.8	10xφ5.1	370 g	10 pcs
170-090-138	TTS-109WB	Satin Nickel	Brass	125	82	4.2	3.7	10	10	10	26.8	10xφ5.1	370 g	10 pcs

BUTT HINGE

L=R TTS-800 SERIES

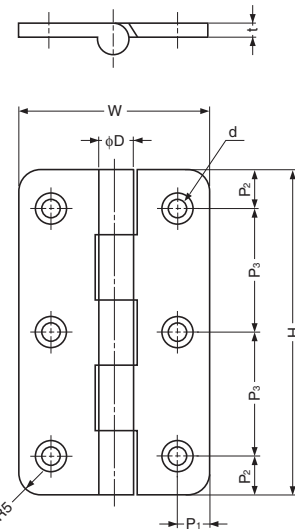
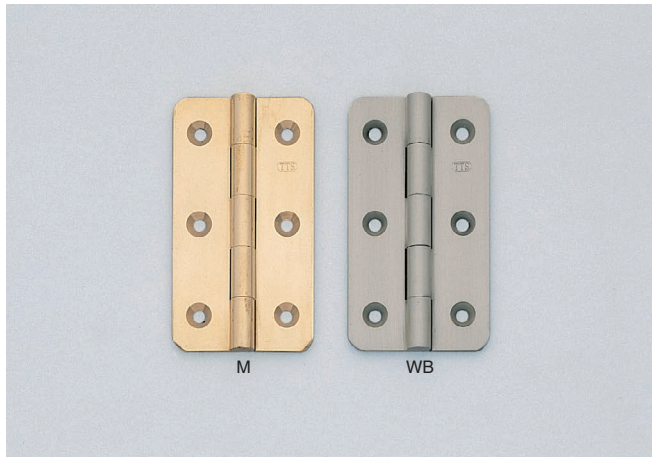

Item Code	Item Name	Finish	Material	H	W	t	D	P ₁	P ₂	P ₃	d	Weight	Box
170-090-174	TTS-801M	Polished	Brass	38	27	1.9	4.5	5	6	13	6xφ3	17 g	100 pcs
170-090-170	TTS-801WB	Satin Nickel	Brass	38	27	1.9	4.5	5	6	13	6xφ3	17 g	100 pcs
170-090-175	TTS-802M	Polished	Brass	50	32	2.3	5.2	6	7	18	6xφ3.5	31 g	100 pcs
170-090-171	TTS-802WB	Satin Nickel	Brass	50	32	2.3	5.2	6	7	18	6xφ3.5	31 g	100 pcs
170-090-176	TTS-803M	Polished	Brass	65	38	2.5	6.1	7	7.5	25	6xφ3.6	54 g	50 pcs
170-090-172	TTS-803WB	Satin Nickel	Brass	65	38	2.5	6.1	7	7.5	25	6xφ3.6	54 g	50 pcs
170-090-177	TTS-804M	Polished	Brass	75	42	2.6	7.1	8	10.5	27	6xφ3.8	77 g	50 pcs
170-090-173	TTS-804WB	Satin Nickel	Brass	75	42	2.6	7.1	8	10.5	27	6xφ3.8	77 g	50 pcs