

BUTT HINGE

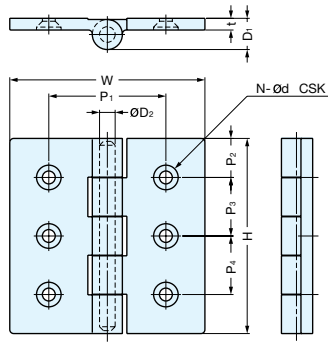

LSF



• 316 Stainless Steel construction ideal for harsh and highly corrosive environments.

Material	Finish
316 Stainless Steel	Polished

Item No.	H	W	P ₁	P ₂	P ₃	P ₄	t	D ₁	øD ₂	Knuckles	N	d	Weight (g)	Box (pcs)	Carton (pcs)
LSF-50	50 (1-31/32")	50 (1-31/32")	35	15.0	20	-	5	14	6	3	4	ø4.4, ø8.6	110	20	100
LSF-65	65 (2-9/16")	65 (2-9/16")	40	35	-	-	-	-	-						
LSF-75	75 (2-61/64")	75 (2-61/64")	50	17.5	40	-	6	16	8	5	6	ø6.6, ø12.6	305	10	50
LSF-100	100 (3-15/16")	100 (3-15/16")	60	20.0	30	30	-	-	-						

BUTT HINGE



28300, 28400

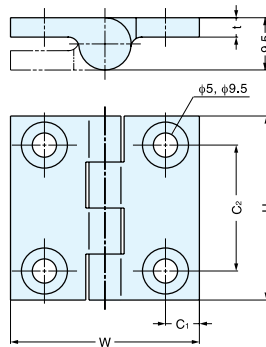

• 316 Stainless Steel construction ideal for harsh and highly corrosive environments.
 • Door weight: Max. 4kg/pair (8.8lbs/pair)
 • Door size: Max. W450 x H700 x t21 mm (W17-3/4" x H27-9/16" x t13/16")

Material	Finish
316 Stainless Steel	Polished

Item No.	H	W	t	C ₁	C ₂	Weight (g)	Box (pcs)	Carton (pcs)
28300	38 (1-1/2")	39 (1-17/32")	4	7.0	26	55	20	100
28400	50 (1-31/32")	50 (1-31/32")		7.5	34	90		

BUTT HINGE



27800, 27900

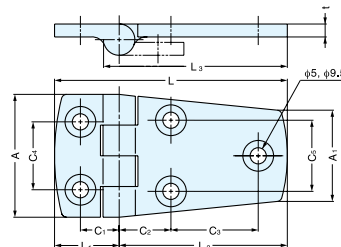

• 316 Stainless Steel construction ideal for harsh and highly corrosive environments.
 • Door weight: Max. 4kg/pair (8.8lbs/pair)
 • Door size: Max. W450 x H700 x t21 mm (W17-3/4" x H27-9/16" x t13/16")

Material	Finish
316 Stainless Steel	Polished

Item No.	L	L ₁	L ₂	L ₃	C ₁	C ₂	C ₃	C ₄	C ₅	A	A ₁	t	Weight (g)	Box (pcs)	Carton (pcs)
27900	58 (2-9/32")	20 (25/32")	38 (1-1/2")	42	12	13.5	16.5	21	20	38	28	4	70	20	100
27800	72 (2-53/64")		52 (2-3/64")	57		16.0	27.0	22	21				85		