

RECESSED PULL

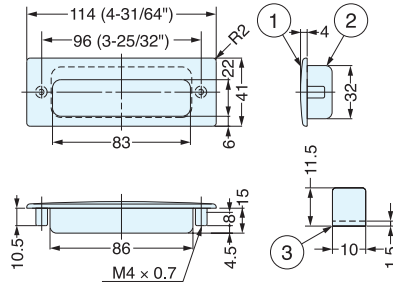

HH-KS



• All-stainless steel model ideal for harsh and high corrosive environments.

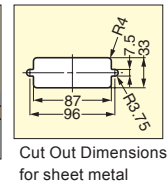
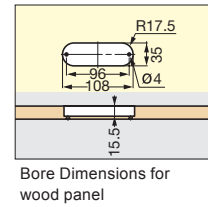

| Item No. | Finish | Weight (g) | Box (pcs) | Carton (pcs) |
|-----------|--------|------------|-----------|--------------|
| HH-KS114M | Mirror | 110 | 10 | 60 |
| HH-KS114S | Satin | | | |

| No. | Part Name | Material | Finish |
|-----|------------|---------------------|--------------|
| ① | Face Plate | 316 Stainless Steel | Mirror/Satin |
| ② | Case | 304 Stainless Steel | Satin |
| ③ | Spacer | | - |

RECESSED PULL



HH-DS

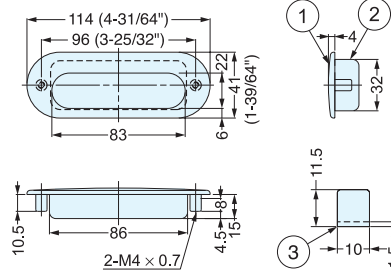

• All-stainless steel model ideal for harsh and high corrosive environments.

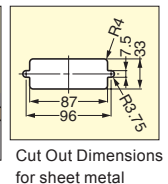
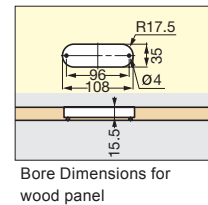

| Item No. | Finish | Weight (g) | Box (pcs) | Carton (pcs) |
|-----------|--------|------------|-----------|--------------|
| HH-DS114M | Mirror | 105 | 10 | 60 |
| HH-DS114S | Satin | | | |

| No. | Part Name | Material | Finish |
|-----|------------|---------------------|--------------|
| ① | Face Plate | 316 Stainless Steel | Mirror/Satin |
| ② | Case | 304 Stainless Steel | Satin |
| ③ | Spacer | | - |

RECESSED PULL



HH-K

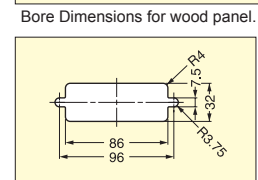
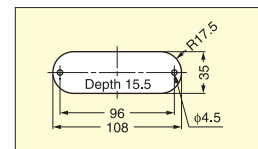
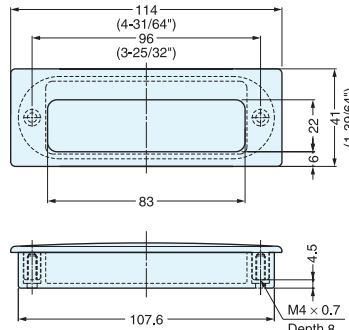

Cut Out Dimensions for sheet metal. Put sheet metal between front and back part for sheet metal applications. (Max. sheet metal thickness: 2 mm)

| Item No. | Weight (g) | Box (pcs) | Carton (pcs) |
|----------|------------|-----------|--------------|
| HH-K | 90 | 10 | 60 |

| Material | Finish/Color |
|---------------------|--------------|
| 316 Stainless Steel | Mirror |
| ABS | Black |