

# MULTI-PURPOSE LID (W/DAMPER) AD-KH With Lid



Video Link



- With damper to keep lid from slamming shut.
- New types are now available. (AD-KH020-HL and AD-KH028-HL)
- Made of stainless steel for corrosion resistance. Available in areas exposed to water.
- Wide opening.
- Balance weight restores lid to horizontal position.

**[Specifications]**

- Operating temperature: 0°C~40°C

**[Remarks]**

- Indoor use only.
- The closing speed varies depending on the operating temperature. For product stored below the freezing point, leave it indoor above 0°C for several hours before use.

**[Installation]**

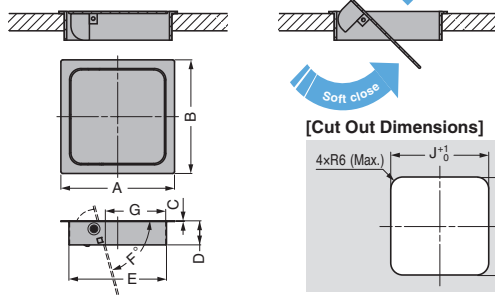

**[Cut Out Dimensions]**

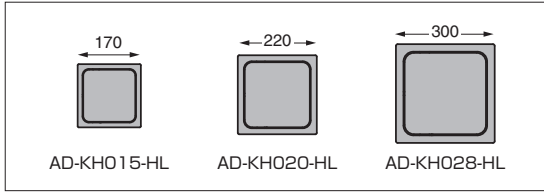
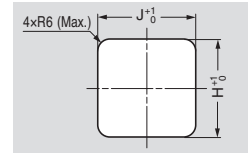

RHS	CAD	Item Code	Item Name	Old Item Name	Material	Finish	A	B	C	D	E	F	G	H	J	Weight (g)	Box (pcs)	Carton (pcs)
		210-022-108	AD-KH015-HL	AD-KH017-HL	Stainless Steel (SUS304)	Satin	170	170		36	146	80	93	147	147	970	1	10
	-	210-037-893	AD-KH020-HL	-			220	220	1.2	50	196	77	127	197	197	1400	1	6
	-	210-037-894	AD-KH028-HL	-			300	300		72	276	80	191	277	277	2700	1	4

※ Item name has been revised.

# SQUARE COVER FOR REFUSE BOX AN-KH

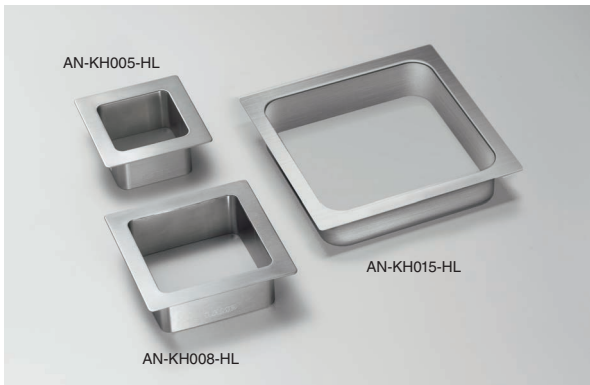

- Corrosion resistant.
- Small type AN-KH005-HL and AN-KH008-HL are newly launched.
- AN-KH005-HL is not for plastic bottles, suitable for separation.

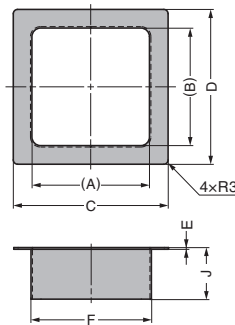
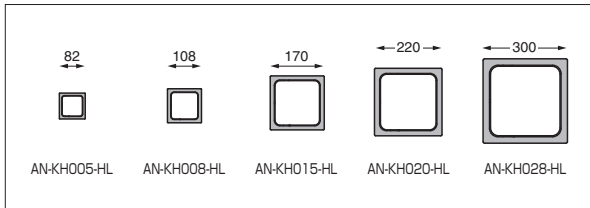
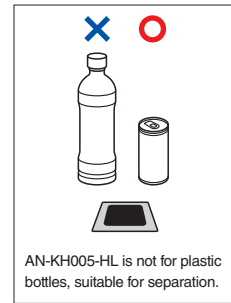

**[Cut Out Dimensions]**

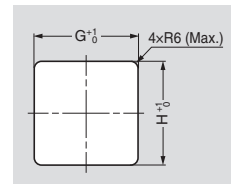

RHS	CAD	Item Code	Item Name	Old Item Name	Material	Finish	A	B	C	D	E	F	G	H	J	Weight (g)	Box (pcs)	Carton (pcs)	
		210-032-785	AN-KH005-HL	-	Stainless Steel (SUS304)	Satin	56	56	82	82		58	59	59		87	1	150	
		210-028-436	AN-KH008-HL	AN-KH001			82	82	108	108		84	85	85	36		126	1	10
		210-022-109	AN-KH015-HL	AN-KH017			144	144	170	170	1.2	146	147	147			217	1	10
-		210-037-895	AN-KH020-HL	-			194	194	220	220		196	197	197	50		388	1	6
-		210-037-896	AN-KH028-HL	-			274	274	300	300		276	277	277	72		733	1	6

※ Item name has been revised.