

**TENSION CATCH** Strong Force / Force Adjustable



SUS316

**BCTS-85J**



**Features**

- Can retain ball from top or sides allowing for different types of installations.
- The force is adjustable.
- The plate can slide 1.5 mm to align properly with the body.

**Remarks**

- The pushing and pulling force vary. Test the actual product before use.
- The force can be adjusted with a hex bar spanner (nominal 3).
- When adjusting the force, check the indicator and adjust until the left and right screws are level.

**Recommended Screw**

Size M5 cross-recessed binding screws

[Video Link](#)



**Application Example**

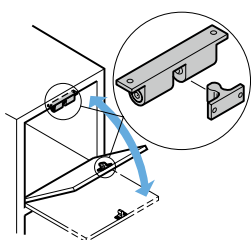

Can also retain ball from sides.

**Self Alignment**



Slides 1.5 mm to align properly.

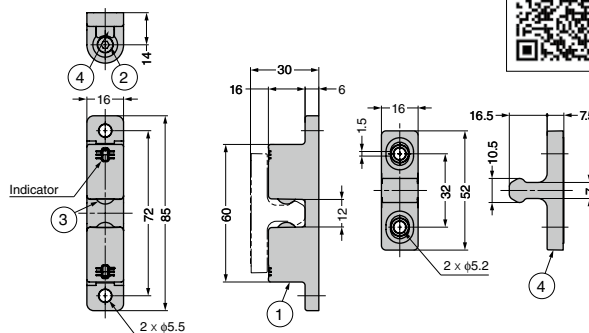

No.	Part Name	Material	Finish
①	Body	Stainless Steel (SCS14)	Electropolishing
②	Adjustment Screw	Stainless Steel (SUS316)	Plain
③	Ball	Stainless Steel (SUS316)	Plain
④	Counter Plate	Stainless Steel (SCS14)	Electropolishing
-	Compression Coil Springs	Stainless Steel (SUS631-WPC)	Plain

\*SCS14 is a cast steel material similar to SUS316.

CAD	Item Code	Item Name	Pulling Force		Pushing Force		Weight (g)
			N	kgf	N	kgf	
	140-043-510	BCTS-85J	8 - 82	0.8 - 8.4	8 - 77	0.8 - 7.9	168