

MAGNETIC CATCH

MC-159-8

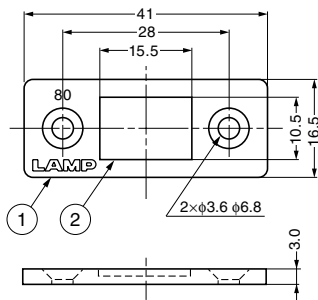

Body

Item Code	Item Name	Magnetic Force N	Magnetic Force kgf	Weight	Box	Carton
140-026-510	MC-159-8	78.4 N	8 kgf	14 g	200 pcs	1,000 pcs

Features

- 3mm ultra thin magnet operates well even in tight spaces
- Extremely strong magnetic force
- Similar items with different magnetic forces: MC-158, MC-159 (P.262), MC-159-SUS (below)

Remarks

Max. temperature: 80°C

Recommended Screw

Flat head screw M3 or Countersunk head wood screw 3.1

Sold Separately

Counter plate MC-YN001U (P.273)

No.	Part Name	Material	Finish
①	Body	Steel	Nickel
②	Magnet	Neodymium	Nickel

Counter Plate (Sold Separately)

Item Code	Item Name	Page
140-059-555	MC-YN001U	P.273

MAGNETIC CATCH



MC-159-SUS

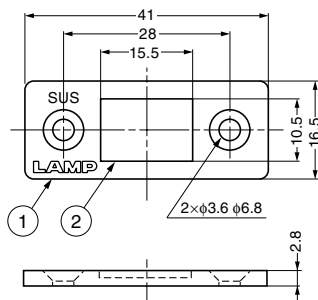

Body

Item Code	Item Name	Magnetic Force N	Magnetic Force kgf	Weight	Box	Carton
140-026-511	MC-159-SUS	49 N	5 kgf	13 g	200 pcs	1,000 pcs

Features

- 2.8mm ultra thin magnet operates well even in tight spaces
- Covered with an acrylic resin coating for high corrosion resistance.
- Very strong magnetic force
- Similar items with different magnetic forces: MC-158, MC-159 (P.262), MC-159-8 (above)

Remarks

Max. temperature: 80°C

Recommended Screw

Flat head screw M3 or Countersunk head wood screw 3.1

Sold Separately

Counter plate (made of SUS) MC-JM49, AS-68 (P.273)

No.	Part Name	Material	Finish
①	Body	Stainless Steel (SUS430)	Mirror
②	Magnet	Neodymium	Acrylic Coating

Counter Plate (Sold Separately)

Item Code	Item Name	Page
140-059-555	MC-YN001U	P.273

CATCHES & LATCHES

MAGNETIC CATCH