

SEALED MAGNETIC CATCH MC-JMS45WT With Swing Function



Cover removed

- Resin coated body prevents rusting.
- Magnetic surface can pivot for better contact with counter plate.
- Suitable for kitchen equipment using with MC-JMP45 (sold separately).

[Applications]

- Washing machine, kitchen equipment, etc.

[Remarks]

- Be sure to read the "Cautions" 1.
- Max. temperature: 80°C

[Sold Separately]

- Counter plate MC-JMP45 2
- Counter plate AS-68 3, MC-JM49 4

[Recommended Screws]

- M4 screw, tapping screw nominal 4 (truss or binding head, SUS)

[Movement of Magnet]

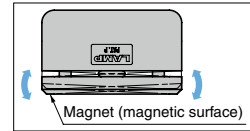

Magnet face can pivot.

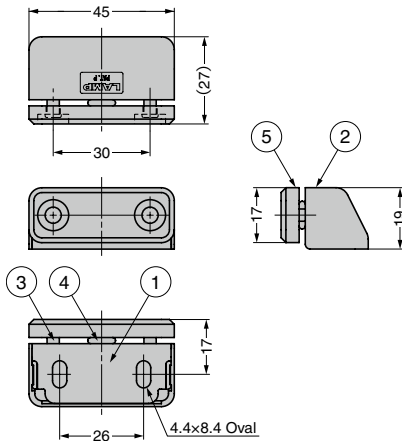

[Body]

RoHS	CAD	Item Code	Item Name	Magnetic Force N	Magnetic Force kgf	Weight (g)	Box (pcs)	Carton (pcs)
		140-024-597	MC-JMS45WT	29.4	3	26	24	240

Refer to 1 : P.607, 2 : P.638, 3, 4 : P.639, 5 : P.624

No.	Part Name	Material	Finish / Colour
①	Body (Thickness t = 1.5)	Stainless Steel (SUS304)	Barrel Polished
②	Cover	PP	White
③	Shaft	Stainless Steel (SUS303)	Plain
④	O-ring	Rubber (FKM)	Black
⑤	Magnet (MC-JM45WT 5)	PP/Neodymium	White

[Counter Plate] Sold Separately

RoHS	CAD	Item Code	Item Name	Weight (g)	Box (pcs)	Carton (pcs)
		140-050-122	MC-JMP45WT	7	100	1000
		140-029-241	MC-JMP45BL	8	100	1000
		140-050-138	AS-68	17	100	1000
		140-050-149	MC-JM49	10	100	1000

MAGNETIC CATCH MC-JMF54 Snap-in Installation



MC-JMF54BL



MC-JMF54WT

- The body covered with resin prevents rusting and avoids scattering of metal powder. Contact noise also can be reduced.
- Snap-in magnetic catch for sheet metal application.
- Magnetic surface can pivot for better contact with counter plate.

[Applications]

- Steel cabinet, washing machine, kitchen equipment, bathroom, etc.

[Remarks]

- Be sure to read the "Cautions" 1.
- Max. temperature: 80°C

[Sold Separately]

- Counter plate MC-JMP45 2
- Counter plate AS-68 3, MC-JM49 4

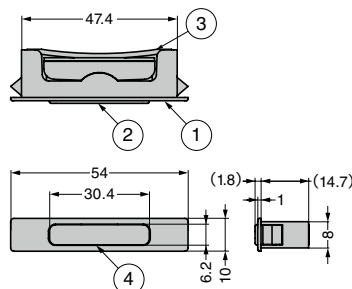

[Installation]

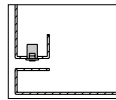

[Movement of Magnet]

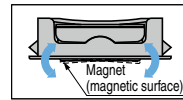

[Cut Out Dimensions]

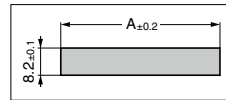

Door Thickness	A
0.7	48
0.8	
1.0	
1.2	49
1.6	
2.0	

No.	Part Name	Material	Finish / Colour
①	Body	PP	Black/White
②	Body		
③	Spring	POM	White
④	Magnet	Neodymium	Nickel

[Body]

RoHS	CAD	Item Code	Item Name	Colour	Magnetic Force N	Magnetic Force kgf	Weight (g)	Box (pcs)	Carton (pcs)
		140-026-601	MC-JMF54BL	Black	25	2.6	13	100	1000
		140-026-602	MC-JMF54WT	White					

Refer to 1 : P.607, 2 : P.638, 3, 4 : P.639

[Counter Plate] Sold Separately

RoHS	CAD	Item Code	Item Name	Weight (g)	Box (pcs)	Carton (pcs)
		140-050-122	MC-JMP45WT	7	100	1000
		140-029-241	MC-JMP45BL	8	100	1000
		140-050-138	AS-68	17	100	1000
		140-050-149	MC-JM49	10	100	1000