

MAGNETIC CATCH (SNAP-IN TYPE)

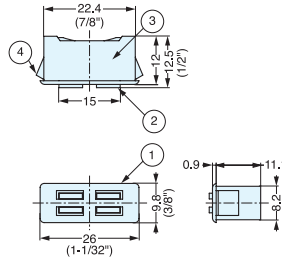

MC-FS34



- Snap-in magnetic catch for sheet metal applications.
- Compact size

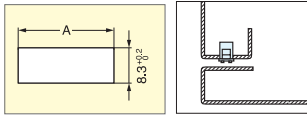

Cut Out Dimensions

Item No.	Body Color	Spring Color	Magnetic Force (kg)	Weight (g)	Box (pcs)	Carton (pcs)
MC-FS34WW	White	White	1.3 (2.9 lbs)	5.3	200	2000
MC-FS34GW	Grey		2.2 (4.8 lbs)			
MC-FS34WB	White	Blue	1.3 (2.9 lbs)			
MC-FS34BB	Black		2.2 (4.8 lbs)			
MC-FS34GB	Grey	Green	1.3 (2.9 lbs)			
MC-FS34WG	White		2.2 (4.8 lbs)			
MC-FS34GG	Grey					

Item No.	Panel Thickness	A
MC-FS34WW/GW	0.5	22.6 +0.2, 0
	0.8	23.7 +0.2, 0
MC-FS34WB/BB/GB	1.0	22.7 ±0.1
	1.2	23.5 ±0.1
	1.4	24.0 ±0.1
MC-FS34WG/GG	1.6	22.7 ±0.1
	2.0	23.8 ±0.1

No.	Part Name	Material	Finish/Color
①	Body	Polyamide	Gray/Black/White
②	Yoke	Steel	Yellow Zinc Chromate
③	Magnet	Ferrite	-
④	Spring	Polyacetal	Blue/Green/White

MAGNETIC CATCH (SNAP-IN TYPE)



MC-FS

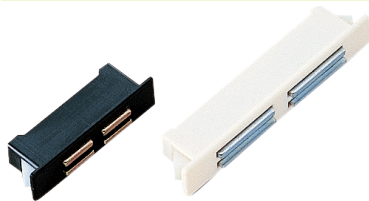

MC-FS5B

MC-FS10B

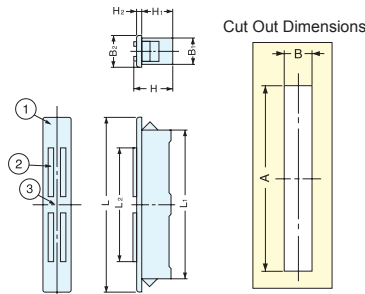

- Snap-in magnetic catch for sheet metal applications.

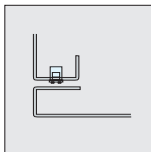

Installation

No.	Part Name	Material	Finish/Color
①	Housing	ABS	White (W), Black (B)
②	Yoke	Steel	Yellow Zinc Chromate
③	Magnet	Ferrite	-

Door Thickness	Cut Out Dimensions			
	MC-FS5		MC-FS10	
	A	B	A	B
0.8	34.1 (1-11/32")	8.2 (21/64")	55.0 (2-5/32")	
1.0			55.5 (2-3/16")	
1.2	56.0 (2-13/64")			
1.6	56.5 (2-7/32")			
2.0	36.5 (1-7/16")		8.2 (21/64")	

Item No.	L	L ₁	L ₂	B ₁	B ₂	H	H ₁	H ₂	Magnetic Force (kg)	Weight (g)	Box (pcs)	Carton (pcs)	
MC-FS5W	MC-FS5B	40	33.9 (1-11/32")	21.6	8	10	13.5 (17/32")	11.2	1.2	2.2 (4.8 lbs)	9	200	2000
MC-FS10W	MC-FS10B	64	54.5 (2-9/64")	43.0			14.0 (35/64")	11.5	1.5	4.5 (9.9 lbs)	20	50	1000

MAGNETIC CATCH (SNAP-IN TYPE)



MC-FP



White

Black

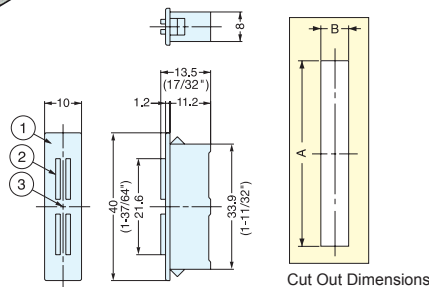

- Snap-in magnetic catch for sheet metal applications.
- Small design with a strong magnetic force.

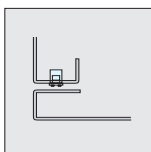

Installation

No.	Part Name	Material	Finish/Color
①	Housing	ABS	White (WT), Black (BL)
②	Yoke	Steel	Yellow Zinc Chromate
③	Magnet	Neodymium	-

Door Thickness	Cut Out Dimensions	
	A	B
0.8	34.1 (1-11/32")	8.2 (21/64")
1.0		
1.2		
1.6		
2.0		

Item No.	Magnetic Force (kg)	Weight (g)	Box (pcs)	Carton (pcs)
MC-FP5SWT	4.5 (9.9 lbs)	9	200	2000
MC-FP5SBL				