

## MAGNETIC CATCH MC200

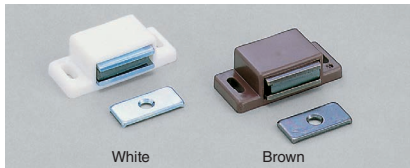

No.	Part Name	Material	Finish / Colour
①	Body	PE	White, Brown
②	Yoke	Steel (SPCC)	(White) Clear Zinc Chromate (Brown) Bronze
③	Magnet	Ferrite	—
④	Counter Plate	Steel (SPCC)	(White) Clear Zinc Chromate (Brown) Bronze

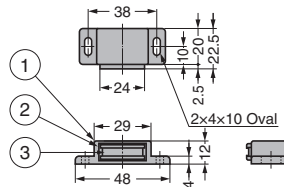

### [Remarks]

- Be sure to read the "Cautions" 1

### [Parts Included]

- Counter plate

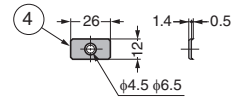

RoHS	CAD	Item Code	Item Name	Colour	Magnetic Force N	Magnetic Force kgf	Weight (g)	Box (pcs)	Carton (pcs)
RoHS	3D	140-058-030	MC200W	White	34.3	3.5	20	100	1000
RoHS	3D	140-058-031	MC200BR	Brown				100	1000
RoHS	3D	140-058-032	MC200W-1	White	53.9	5.5		100	1000
RoHS	3D	140-058-033	MC200BR-1	Brown				100	1000

Refer to 1 : P.607

## MAGNETIC CATCH MC009

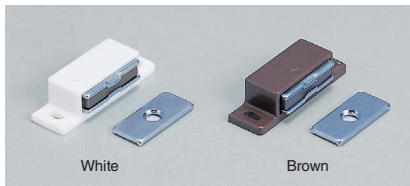

No.	Part Name	Material	Finish / Colour
①	Body	PE	White, Brown
②	Yoke	Steel (SPCC)	Clear Zinc Chromate
③	Magnet	Ferrite	—
④	Counter Plate	Steel (SPCC)	Clear Zinc Chromate

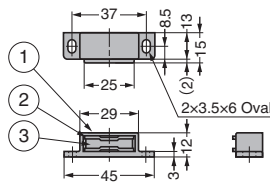

### [Remarks]

- Be sure to read the "Cautions" 1

### [Parts Included]

- Counter plate

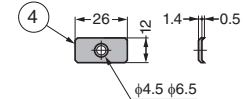

RoHS	CAD	Item Code	Item Name	Colour	Magnetic Force N	Magnetic Force kgf	Weight (g)	Box (pcs)	Carton (pcs)
RoHS	3D	140-040-008	MC009W	White	24.5	2.5	17	100	1000
RoHS	3D	140-058-010	MC009BR	Brown				100	1000
RoHS	3D	140-040-009	MC009SW	White	49	5		100	1000
—	3D	140-058-012	MC009SBR	Brown				100	1000

Refer to 1 : P.607

## MAGNETIC CATCH MC0097

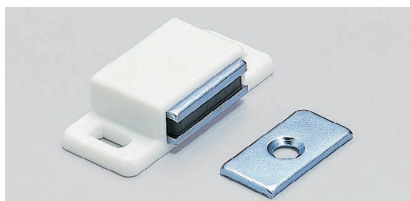

No.	Part Name	Material	Finish / Colour
①	Body	PE	White, Black
②	Yoke	Steel (SPCC)	Clear Zinc Chromate (Trivalent)
③	Magnet	Ferrite	—
④	Counter Plate	Steel (SPCC)	Clear Zinc Chromate (Trivalent)

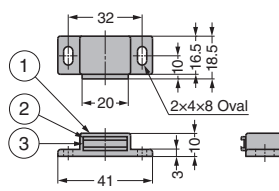

### [Remarks]

- Be sure to read the "Cautions" 1

### [Parts Included]

- Counter plate

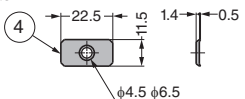

RoHS	CAD	Item Code	Item Name	Colour	Magnetic Force N	Magnetic Force kgf	Weight (g)	Box (pcs)	Carton (pcs)
RoHS	3D	140-050-331	MC0097W	White	14.7	1.5	12	100	1000
RoHS	3D	140-050-332	MC0097B	Black				100	1000
RoHS	3D	140-050-329	MC0097W-1	White	34.3	3.5		100	1000
RoHS	3D	140-050-330	MC0097B-1	Black				100	1000

Refer to 1 : P.607

## MAGNETIC CATCH MC84

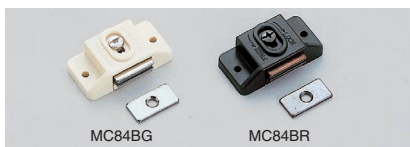

No.	Part Name	Material	Finish / Colour
①	Body	ABS	BR BG
②	Yoke	Steel (SPCC)	Bronze Nickel
③	Magnet	Ferrite	—
④	Back Cover	ABS	Brown White
⑤	Screw	Steel (SS)	Bronze Nickel
⑥	Counter Plate	Steel (SPCC)	—

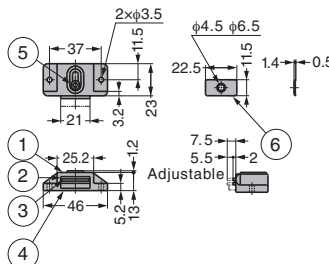

- Yoke position adjustable 5.5mm back and forward.

### [Remarks]

- Be sure to read the "Cautions" 1

### [Parts Included]

- Counter plate
- Pan head wood screw 3.1×13
- Countersunk head wood screw 2.7×13

RoHS	CAD	Item Code	Item Name	Colour	Magnetic Force N	Magnetic Force kgf	Weight (g)	Box (pcs)	Carton (pcs)
RoHS	3D	140-058-046	MC84BR	Brown	29.4	3	18	100	1000
RoHS	3D	140-058-047	MC84BG	Beige				100	1000

Refer to 1 : P.607