

# SHELF STANDARD

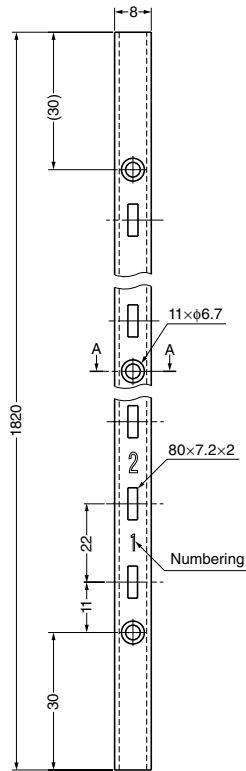

# SPN-1820



### Features

- Slim, 8mm wide shelf standard with a high load capacity.
- Height markers are placed at every 22mm for use as guides.
- This makes height adjustment very easy.
- Design holds shelf supports very firmly, preventing them from unintentionally dislodging.
- Easy to cut to desired length

### Sold Separately

- Shelf support SPN-15 (below)
- End cap SPN-17EC (below)

### Recommended Screws

Countersunk head tapping screw 3 or countersunk head wood screw 3.1

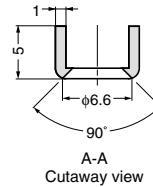

Item Code	Item Name	Type	Material	Finish	Holes	Weight	Carton
120-017-129	SPN-1820	w/Numbering	Stainless Steel (SUS430)	Satin	11	205 g	60 pcs

# SHELF SUPPORT



# SPN-15

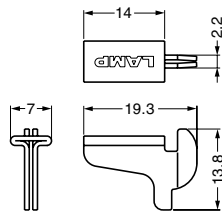

Shelf support

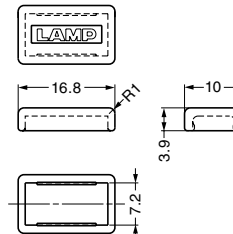

Cap for shelf support

### Cap for Shelf Support

### Features

For SPN-1820.

### Sold Separately

Cap for shelf support SPN-15C

### Shelf Support

Item Code	Item Name	Material	Colour	Weight	Box	Carton
120-017-693	SPN-15C	Elastomer (TPE)	White	0.5 g	400 pcs	4000 pcs

Item Code	Item Name	Material	Finish	Load Capacity/4 pcs	Weight	Box	Carton
120-017-692	SPN-15	Stainless Steel (SUS304)	Polished	785 N / 80 kgf	2 g	400 pcs	2000 pcs

# END CAP

# SPN-17EC

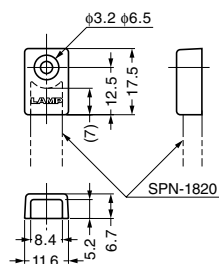

### Features

For SPN-1820.

Item Code	Item Name	Material	Colour	Weight	Box	Carton
120-017-694	SPN-17EC	Polypropylene (PP)	White	0.9 g	400 pcs	4000 pcs