

HOOK

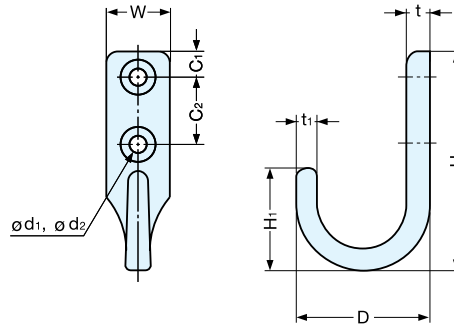

EL-25, 30



Material	Finish
304 Stainless Steel	Mirror

Item No.	D	H	H ₁	t	t ₁	W	C ₁	C ₂	d ₁	d ₂	Load Capacity (kg)	Weight (g)	Box (pcs)	Carton (pcs)	Screw
EL-25	26 (1-1/32")	40.0 (1-37/64")	19	5.5	4	12	5	12	3	6	20 (44 lbs)	19	30	300	2.7 × 16
EL-30	32 (1-17/64")	54.5 (2-9/64")	25	6.0	5	15	6	16	4	8		32	20	200	3.8 × 20

SMALL HOOKS

HOOK



EP-25, 40

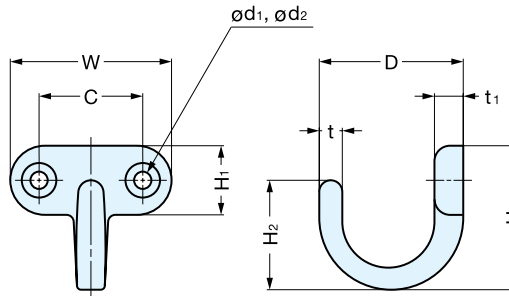

Material	Finish
304 Stainless Steel	Mirror

Item No.	D	W	H	H ₁	H ₂	t	t ₁	C	d ₁	d ₂	Load Capacity (kg)	Weight (g)	Box (pcs)	Carton (pcs)	Screw
EP-25	25 (63/64")	28	25 (63/64")	12	19	4	5	18	3	6	20 (44 lbs)	16	30	300	2.7 × 16
EP-40	32 (1-17/64")	36	33 (1-19/64")	16	25	5	6	23	4	8		31	20	200	3.8 × 20

HOOK



FC, FC-TI



FC



FC-TI

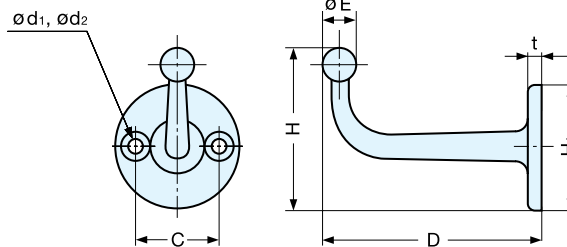

* Titanium Available Upon Request

Material	Finish
304 Stainless Steel	Mirror

Item No.	D	H	H ₁	t	C	d ₁	d ₂	E	Load Capacity (kg)	Weight (g)	Material	Box (pcs)	Carton (pcs)
FC-50	47 (1-27/32")	37 (1-29/64")	28	3	18.5	3.3	6.5	6.5	10 (22 lbs)	17	304 Stainless Steel	40	240
FC-50 Ti											Titanium		
FC-65	65 (2-9/16")	44 (1-47/64")	35	4	22.5	4.2	8.0	8.0	12 (26 lbs)	34	304 Stainless Steel	30	180
FC-65 Ti											Titanium		