

BRASS DOUBLE HOOK (BRASS NOUVEAU SERIES)

TEST METHOD 19



PXB-BN05



A design which grows thicker as it approaches its end points. Built with a thick and luxurious amount of brass. A design which harmonizes both classical and modernist styles.

Features

- The hooking end points are spherical, making it safer to use and decreasing the possibility of accidental injury.
- Meticulously manufactured to be very strong but appear delicate.

Remarks

The finish of the product may vary as the surface processing is affected by the individual properties of the material.

Enjoy the unique style of your own product.

Parts Included

- PXB-BN05-211: Size 4 x 20 cross-recessed pan head tapping screws

No.	Part Name	Material
①	Base	Brass
②	Arm	
③	Hex Socket Bolts	Steel

- PXB-BN05-231: Size 5 x 25 cross-recessed pan head tapping screws

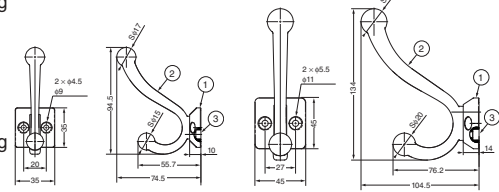

Variations



CAD	Item Code	Item Name	Material	Finish/Colour	Load Capacity N	Load Capacity kgf	Weight (g)
2D/3D	110-043-564	PXB-BN05-211-BM	Brass	Nickel Plating / Blasted Metal	83	8.5	165
2D/3D	110-043-565	PXB-BN05-211-PB		Polished / Polished Brass			
2D/3D	110-043-566	PXB-BN05-211-SB		Satin Finish / Satin Brass			
2D/3D	110-043-567	PXB-BN05-211-AB		Antique Brass Plating / Antique Brass			
2D/3D	110-043-568	PXB-BN05-211-BL		Coating / Matte Black			
2D/3D	110-043-582	PXB-BN05-231-BM	Brass	Nickel Plating / Blasted Metal	147	15	415
2D/3D	110-043-583	PXB-BN05-231-PB		Polished / Polished Brass			
2D/3D	110-043-584	PXB-BN05-231-SB		Satin Finish / Satin Brass			
2D/3D	110-043-585	PXB-BN05-231-AB		Antique Brass Plating / Antique Brass			
2D/3D	110-043-586	PXB-BN05-231-BL		Coating / Matte Black			

BALL HOOK

TEST METHOD 4

PXB-QL05-111



A curved hook with a ball end. The appearance looks almost as if the ball is gently floating at the end, giving a warm feeling to your interior.

Features

- Mounting screws are not visible, giving a seamless look.
- Rounded design is safe with no sharp corners.
- The matte black finish is coated with a special chromate. This type combines the desirable glossiness of paint with the unique strength of plating.

Parts Included

Size 4 x 32 cross-recessed flat head tapping screws

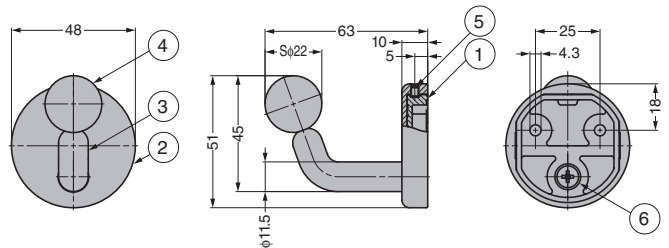

Variations



No.	Part Name	Material	Finish
①	Base	Zinc Alloy (ZDC)	See the table
②	Base Cover		
③	Arm		
④	Ball		
⑤	Hexagon Socket Set Screws	Steel	Trivalent Chromate Finish
⑥	Cross-Recessed Flat Head Screws		

CAD	Item Code	Item Name	Material	Finish/Colour	Load Capacity N	Load Capacity kgf	Weight (g)	Box (pcs)
2D/3D	110-037-955	PXB-QL05-111-CR	Zinc Alloy (ZDC)	Chrome Plating	100	10.2	160	8
2D/3D	110-037-956	PXB-QL05-111-GP		24K Gold Plating				8
2D/3D	110-037-957	PXB-QL05-111-BL		Chromate Finish/Matte Black				8