

HEAVY DUTY LEVELLING GLIDE ADHS, ADHSK, ADH

LOAD CAPACITY 29400~44100 N

TEST METHOD 14

SUS



ADHSK

ADHS

ADH

- Three types available: Steel ADH, stainless steel ADHS and ADHSK with anti-galling stainless steel bolt (See the following galling preventive treatment)
- ADHSK: Galling preventive treatment allows smoother vertical adjustment.
- Two types of M24 and M30 screw diameter. enables application to large machines and furniture.
- Recess for hex key at the screw head allows effective adjustment.

[Applications]

- Machine tools, conveyors, semiconductors, LCD production equipment.

[Galling Preventive Treatment]

Stainless steel is a material with low thermal conductivity and high thermal expansion coefficient. For this reason, the threaded bolt may expand due to the frictional heat during tightening, and the male and female thread may be galled and the bolt may be locked. Even when using ADHS, galling preventive treatment is recommended.

In ADHSK, by applying a lubricating paint to the threaded bolt and going through the firing treatment to enhance the slipperiness and adhesiveness, thread galling is hard to occur.

[Remarks]

- To prevent looseness after use, it is recommended to tighten with a double nut.

[Application Example]

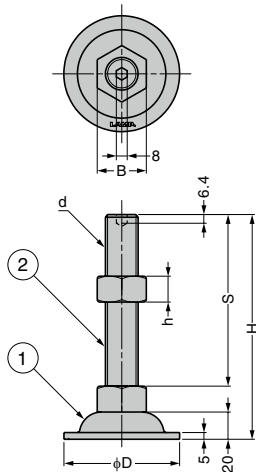
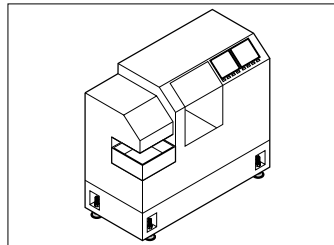

[ADHSK] Galling Preventive Stainless Steel

No.	Part Name	Material	Finish
①	Body	Stainless Steel (SUS304)	Polished
②	Threaded Bolt		Baking Finish

RoHS	CAD	Item Code	Item Name	D	d	H	S	h	B	Load Capacity N/pc	Load Capacity kgf/pc	Weight (g)	Box (pcs)	Carton (pcs)
☑	☑	200-012-538	ADHS-85-24-150K	83	M24	189	150	19	36	29400	3000	970	1	12
☑	☑	200-012-539	ADHS-85-24-200K			239	200			1080	1	24		
☑	☑	200-012-540	ADHS-85-30-150K	84	M30	194	150	24	46	39200	4000	1500	1	24
☑	☑	200-012-541	ADHS-85-30-200K			244	200			4500	1680	1	24	

[ADHS] Stainless Steel

No.	Part Name	Material	Finish
①	Body	Stainless Steel (SUS304)	Polished
②	Threaded Bolt		

RoHS	CAD	Item Code	Item Name	D	d	H	S	h	B	Load Capacity N/pc	Load Capacity kgf/pc	Weight (g)	Box (pcs)	Carton (pcs)
☑	☑	200-012-534	ADHS-85-24-150	83	M24	189	150	19	36	29400	3000	970	1	24
☑	☑	200-012-535	ADHS-85-24-200			239	200			1080	1	24		
☑	☑	200-012-536	ADHS-85-30-150	84	M30	194	150	24	46	39200	4000	1500	1	24
☑	☑	200-012-537	ADHS-85-30-200			244	200			4500	1680	1	24	

[ADH] Steel

No.	Part Name	Material	Finish
①	Body	Steel (SPHC)	Clear Zinc Chromate (Trivalent)
②	Threaded Bolt		

RoHS	CAD	Item Code	Item Name	D	d	H	S	h	B	Load Capacity N/pc	Load Capacity kgf/pc	Weight (g)	Box (pcs)	Carton (pcs)
☑	☑	200-012-530	ADH-85-24-150	84	M24	189	150	19	36	29400	3000	970	1	24
☑	☑	200-012-531	ADH-85-24-200			239	200			1090	1	24		
-	☑	200-012-532	ADH-85-30-150	84	M30	194	150	24	46	39200	4000	1530	1	24
☑	☑	200-012-533	ADH-85-30-200			244	200			4500	1750	1	24	