

# LEVELING GLIDE



**LOAD CAPACITY**  
60-200 kg  
132-440 lbs

**TEST 12**  
P.472

**MKRL**

LEVELING GLIDES  
CASTERS & LEVELING GLIDES



- Double structure of cover/bolt and base allow easy height adjustment without lifting the leg.
- Easy installation with hex socket on the bottom for allen key.

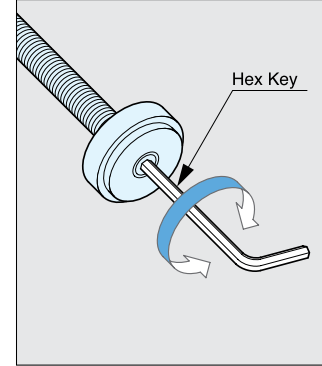
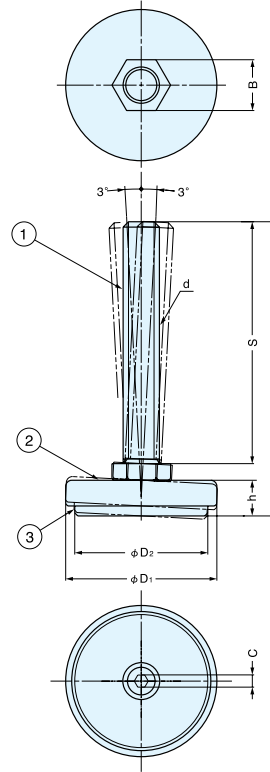

Height can be adjusted by 4mm hex key (not included)

No.	Part Name	Material	Finish
①	Bolt	Steel	Black Zinc Chromate
②	Cover		
③	Base	Elastomer	Black

Item No.	D <sub>1</sub>	D <sub>2</sub>	H	h	S	B
MKRL-32-10-80B6	32 (1-17/64")	27 (1-1/16")	95.8 (3-49/64")	10.8 (27/64")	80.0 (3-5/32")	17 (43/64")
MKRL-32-12-66B6			81.8 (3-7/32")		66.0 (2-19/32")	
MKRL-32-12-80B6			95.8 (3-49/64")		80.0 (3-5/32")	
MKRL-40-10-80B6	40 (1-37/64")	34 (1-11/32")	96.2 (3-25/32")	11.2 (7/16")	32.0 (1-17/64")	
MKRL-40-12-32B6			48.2 (1-57/64")		43.0 (1-11/16")	
MKRL-40-12-43B6			59.0 (2-21/64")		55.0 (2-11/64")	
MKRL-40-12-55B6			71.2 (2-51/64")		80.0 (3-5/32")	
MKRL-40-12-80B6			96.2 (3-25/32")		120.0 (4-23/32")	
MKRL-40-12-120B6			136.2 (5-23/64")		80.0 (3-5/32")	
MKRL-50-12-80B6	50 (1-31/32")	44 (1-47/64")	96.8 (3-13/16")	11.8 (15/32")	120.0 (4-23/32")	
MKRL-50-12-120B6			136.8 (5-25/64")		78.5 (3-3/32")	
MKRL-50-16-78B6			100.3 (3-61/64")		80.0 (3-5/32")	
MKRL-70-20-101B6	70 ( 2-3/4" )	64 (2-33/64")	124.5 (4-29/32")	11.5 (29/64")	101.0 (3-31/32")	30 (1-3/16")

Item No.	C	d	Load Capacity (kg)	Weight (g)	Box (pcs)	Carton (pcs)	
MKRL-32-10-80B6	4 (5/32")	M10 × 1.50	60 (132 lbs)	77	30	300	
MKRL-32-12-66B6		M12 × 1.75	75 (165 lbs)	84			
MKRL-32-12-80B6		M10 × 1.50	94	94			
MKRL-40-10-80B6		M12 × 1.75	60 (132 lbs)	80 (176 lbs)	95	25	250
MKRL-40-12-32B6					78	30	300
MKRL-40-12-43B6					86	25	250
MKRL-40-12-55B6					94		
MKRL-40-12-80B6					112		
MKRL-40-12-120B6					142	15	150
MKRL-50-12-80B6		138					
MKRL-50-12-120B6		168	10	100			
MKRL-50-16-78B6		M16 × 2.00	80 (176 lbs)	80 (176 lbs)	214	15	120
MKRL-70-20-101B6		M20 × 2.50			448	8	64