

MULTIPLE MOTION DOOR SYSTEM (FOR WOOD PANELS)



Multiple Motion Door System

MultiMo FLAT®

WARDROBE & CABINET DOOR HARDWARE

MULTIPLE MOTION DOOR SYSTEM

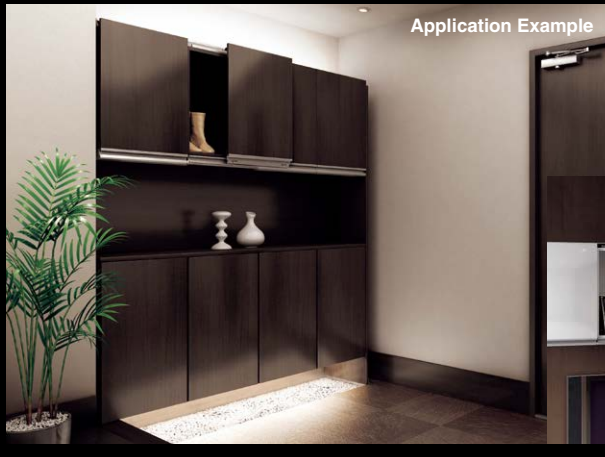

Mirror door can be used.

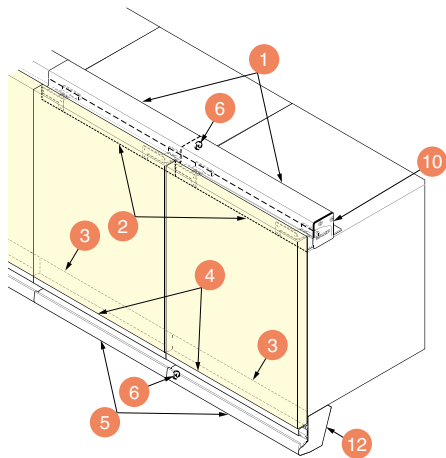

Door Width	297 mm, 447 mm, 597 mm, 897 mm
Door Height	300 - 900 mm
Door Thickness	15 - 23 mm
Door Weight	1.5 - 6.8 kg (Per One Door) *
Door Type	Connecting Multiple Sliding Units (Overlay)

*Including parts.

Features

- Cabinet doors can be rearranged freely, like puzzle pieces.
- Sleek Appearance
 - All doors are flush with each other when closed. Visually appealing, consistent design.
- Interchangeable Door Position
 - Opened doors can slide and be repositioned anywhere where there is space on the supporting rails.
- Extendible
 - Multiple doors can be added by connecting multiple sliding units.
- Soft & Smooth Movement
 - Built in damper for soft and smooth closing movement.
- Small Space Required
 - Great solution for shallow cabinets, hardware requires only 80mm depth.

Remarks

- Recommended using 3 or more doors for interchangeable door.
- Maximum door height is twice of door width.
- Glass door version is also available (P.620).
- (Wooden door and glass door models are not compatible within the same cabinet.)

Interchangeable door position (3 doors or more)

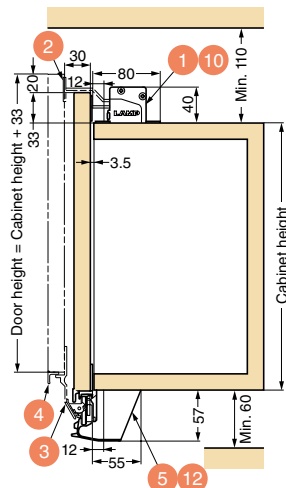
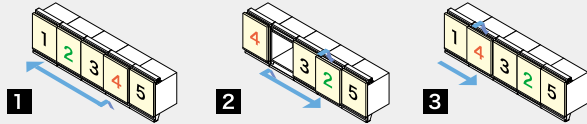

Cut Out Dimensions for Door Brackets 2, Door Sliding Profile 3, Door Handle 4

- Door width 297 mm, 447 mm
- Door width 597 mm, 897 mm

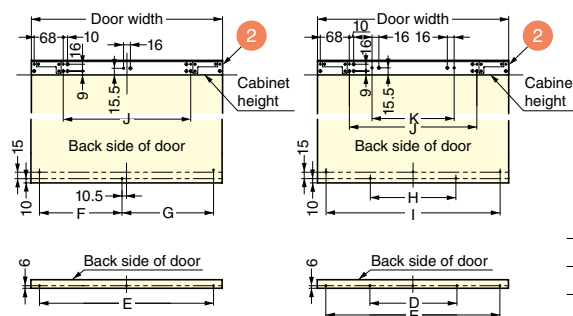

Door opening example (4 doors)

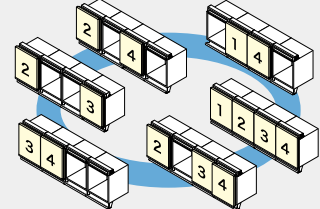

Provides various opening patterns. By adding more doors, the more opening patterns will be possible.

Door Width	D	E	F	G	H	I	J	K
297	-	257	118	139	-	-	148	-
447	-	407	193	214	-	-	298	-
597	278.5	557	-	-	300	557	448	200
897	428.5	857	-	-	400	857	748	300



Parts Set (Per Door)		Necessary Parts Same qty as door is necessary. Please order same model for a cabinet.	
Set Name	Item Code	Item Name	
a) Parts Set (Door Width 297 mm, Door Weight 1.5 - 2.4 kg)	250-121-211	MFS-W300/S2	
b) Parts Set (Door Width 447 mm, Door Weight 1.4 - 2.3 kg)	250-121-212	MFS-W450/S2	
c) Parts Set (Door Width 447 mm, Door Weight 2.4 - 3.3 kg)	250-121-213	MFS-W450/S3	
d) Parts Set (Door Width 597 mm, Door Weight 2.2 - 3.1 kg)	250-121-214	MFS-W600/S3	
e) Parts Set (Door Width 597 mm, Door Weight 3.2 - 4.1 kg)	250-121-215	MFS-W600/S4	
f) Parts Set (Door Width 597 mm, Door Weight 4.2 - 5.1 kg)	250-121-216	MFS-W600/S5	
g) Parts Set (Door Width 897 mm, Door Weight 3.9 - 4.8 kg)	250-121-217	MFS-W900/S5	
h) Parts Set (Door Width 897 mm, Door Weight 4.9 - 5.8 kg)	250-121-218	MFS-W900/S6	
i) Parts Set (Door Width 897 mm, Door Weight 5.9 - 6.8 kg)	250-121-219	MFS-W900/S7	

Parts Included

No.	Qty	Item Code	Dimensions	Description
1	1 pc	Upper Rail		<ul style="list-style-type: none"> Material Aluminium Alloy /Steel Finish Anodized /Clear Zinc Chromate
2	1 pc	Door Brackets		<ul style="list-style-type: none"> Material Steel/Elastomer (TPE) Finish Clear Zinc Chromate <p>*() is for Door Width 597 mm, 897 mm.</p>
3	1 pc	Door Sliding Profile		<ul style="list-style-type: none"> Material Aluminium Alloy /Steel /Polyacetal (POM) /Polyurethane (PUR) Finish Anodized /Clear Zinc Chromate <p>*() is for Door Width 597 mm, 897 mm.</p>
4	1 pc	Door Handle		<ul style="list-style-type: none"> Material Aluminium Alloy Finish Anodized <p>*() is for Door Width 597 mm, 897 mm.</p>
5	1 pc	Lower Rail		<ul style="list-style-type: none"> Material Aluminium Alloy /Steel /Polyacetal (POM) Finish Anodized /Clear Zinc Chromate <p>*() is for Door Width 597 mm, 897 mm.</p>
6	2 pcs	Connecting Pin		<ul style="list-style-type: none"> Material Stainless Steel
7	11 pcs (12 pcs)	Binding Head Tapping Screw 3.5x15		-
8	13 pcs (16 pcs)	Raised Countersunk Head Tapping Screw 3.5x14		-

Qty: () is for MFS-W600/S3, MFS-W600/S4, MFS-W600/S5, MFS-W900/S5, MFS-W900/S6 and MFS-W900/S7.

Mounting Application for Upper Rail ①

• Out side of top panel

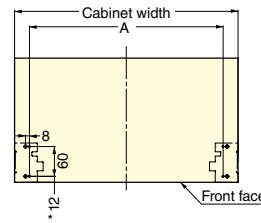

Cabinet Width	A
300	240
450	390
600	540
900	840

Mounting Application for Lower Rail ⑤

• Out side of bottom panel

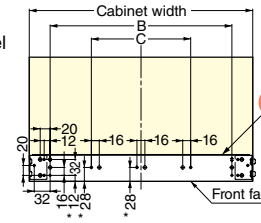

Cabinet Width	B	C
300	216	-
450	366	-
600	516	200
900	816	300

*When using gasket thicker than 3 mm, subtract [gasket thickness - 3 mm] from the marked dimensions.

End Cap Set (Per Door) Necessary Parts 1 set is necessary for 1 unit.

Set Name	Item Code	Item Name
End Cap Set	250-129-555	MFS-ED

Parts Included

No.	Qty	Item Code	Dimensions	Description
9	1 pc	Connecting Plate		<ul style="list-style-type: none"> Material Steel Finish Grey
10	1 pc	Installation Template		<ul style="list-style-type: none"> Material Steel Finish Grey
11	1 pc	Left Upper Rail End Cap		<ul style="list-style-type: none"> Material ABS Finish Grey
12	1 pc	Right Upper Rail End Cap		<ul style="list-style-type: none"> Material ABS Finish Grey
13	4 pcs	Raised Countersunk Head Tapping Screw 3.5x12 (Stainless Steel)		-

WARDROBE & CABINET DOOR HARDWARE

MULTIPLE MOTION DOOR SYSTEM