

PUSH LOCK



2150B, 2160B



Features

- For metal-framed glass doors and sheet metal double sliding doors.
- How to lock:
2150B - push cylinder to lock.
2160B - turn key to lock and unlock.
- 24 key changes available.

Parts Included

Countersunk head screw M3 × 5

Installation

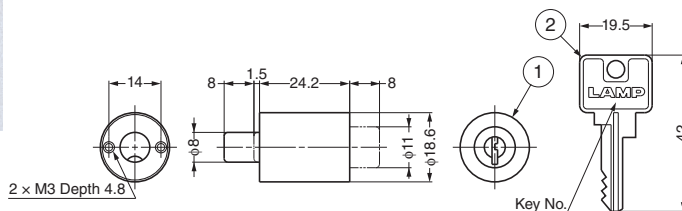
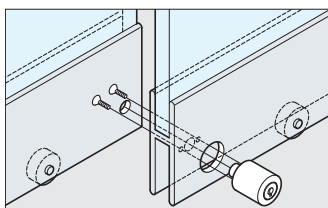

No.	Part Name	Material	Finish
①	Body	Zinc Alloy (ZDC)	Nickel
②	Key	Brass	Nickel

Item Code	Old Item Code	Item Name	Key Type	How to Lock	Cylinder Diameter	Frame Thickness	Weight	Box	Carton
150-060-410	—	2150B-B	Key Different	Without Key	φ18.6	24	50 g	24 pcs	240 pcs
150-001-388	150-060-411	2150B-D	Key Alike	Without Key	φ18.6	24	50 g	24 pcs	240 pcs
150-060-069	—	2160B-B	Key Different	With Key	φ18.6	24	50 g	24 pcs	240 pcs
150-001-384	150-060-070	2160B-D	Key Alike	With Key	φ18.6	24	50 g	24 pcs	240 pcs

GLASS DOOR LOCK

6300-D



Features

- For metal-framed glass doors or sheet metal double sliding doors.
- Easy installation. Just 10 mm bore required on the door.
- Remove cylinder along with key to unlock.
- 96 key changes available.

Installation

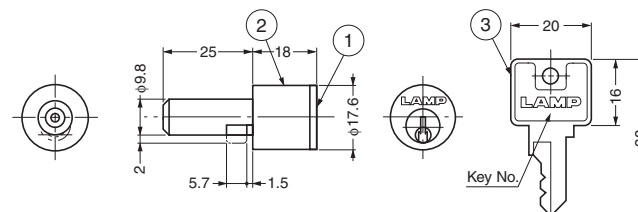
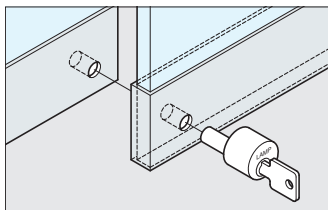

No.	Part Name	Material	Finish
①	Body	Zinc Alloy (ZDC)	Satin Nickel
②	Cylinder Case	Brass	Nickel
③	Key	Brass	Nickel

Item Code	Item Name	Key Type	Cylinder Diameter	Frame Thickness	Metal Sheet Thickness	Weight	Box	Carton
150-001-145	6300-D	Key Alike	φ9.8	19	1.2	50 g	24 pcs	240 pcs