

CABINET LOCK 2100 Lock Series



2100



Features

- For drawer and cabinet door application.
- 6 key changes available.
- Keys can be shared with other 2100 Lock Series.
- Cylinder and Ring can be made with polished finish at surcharge.

Parts Included

Countersunk head wood screw 3.1 × 20, 2.1 × 10 (SUS)

Optional Parts

Spacer TSSP (P.324)



How to Switch: for Drawer/Right-handed Door Application

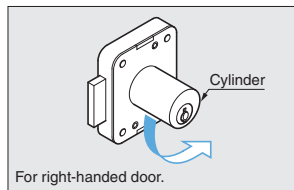

For right-handed door.

- Turn lock cylinder 90° (counter clockwise for drawer).
- Key No. is to be forwarded upside.

Installation

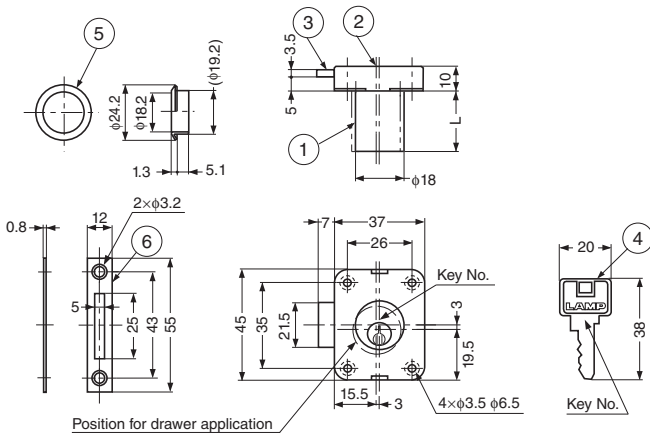
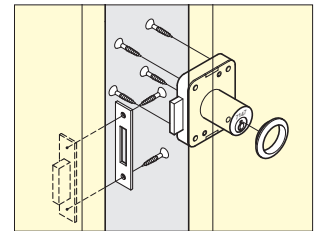
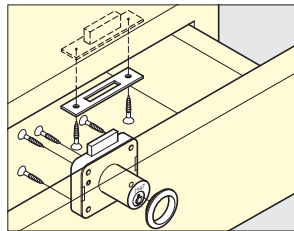

Position for drawer application

No.	Part Name	Material	Finish
①	Cylinder	Brass	Satin Nickel
②	Body	Brass	Nickel
③	Dead Bolt	Brass	Nickel
④	Key	Brass	Nickel
⑤	Ring	Brass	Satin Nickel
⑥	Strike	Stainless Steel (SUS304)	Plain

Item Code	Item Name	Key Type	Cylinder Diameter	Door Thickness	L	Weight	Box	Carton
150-001-013	2100-24-B	Key Different	φ18	24	24	116 g	12 pcs	120 pcs
150-001-014	2100-24-D	Key Alike	φ18	24	24	116 g	12 pcs	120 pcs
150-001-015	2100-30-B	Key Different	φ18	30	30	125 g	12 pcs	120 pcs
150-001-016	2100-30-D	Key Alike	φ18	30	30	125 g	12 pcs	120 pcs

