

RECESSED HOOK

TEST METHOD 18

NF-R



Pearl Chrome

Chrome

Matte Black

Application Example

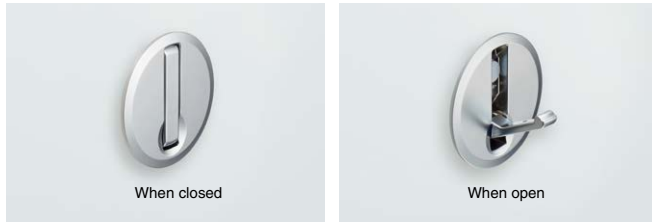

When closed

When open

Features

- The arm section is spring powered and automatically folds back in when no force is exerted on it.
- The product does not protrude when the arm is folded in, creating a neat design and ensuring safety.
- Can also be mounted to sheet metal using the NF-50D or NF-50 bracket (sold separately).
- A square type is also available.

Remarks

- Remove the cushioning rubber before mounting to a wooden surface.

Sold Separately

NF-50D bracket, NF-50 bracket (P.129)

Recommended Screw

- Wood mounting (thickness 25-29 mm): Size 4 x 15 cross-recessed pan head tapping screws
- Wood mounting (thickness 30 mm or more): Size 4 x 20 cross-recessed pan head tapping screws

No.	Part Name	Material
①	Main Body	Zinc Alloy (ZDC)
②	Arm	
③	Spring	Stainless Steel (SUS304)
④	Knurled Pin	Stainless Steel (SUS303)
⑤	Cushioning Rubber	Chloroprene Rubber (CR)

NF-R52

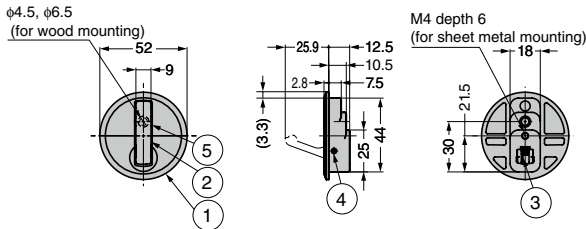

Wood Mounting (thickness 25-29 mm)

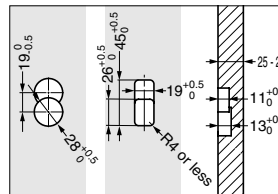

Wood Mounting (thickness 30 mm or more)

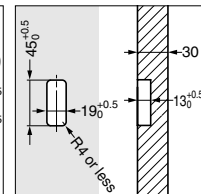

Metal Sheet Mounting

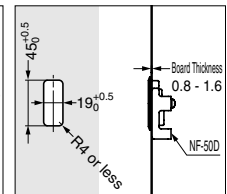

NF-R64

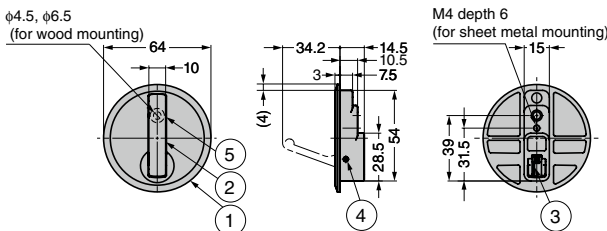

Wood Mounting (thickness 25-29 mm)

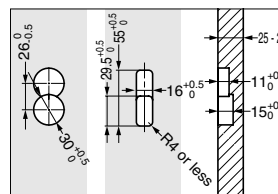

Wood Mounting (thickness 30 mm or more)

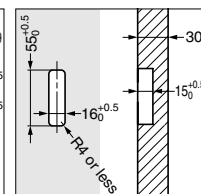

Metal Sheet Mounting

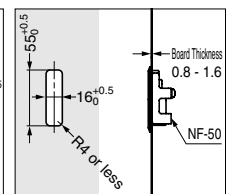

NF-R77

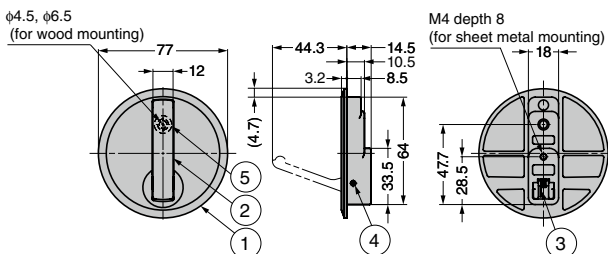

Wood Mounting (thickness 25-29 mm)

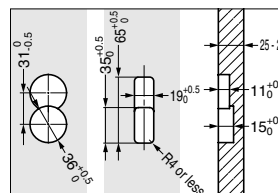

Wood Mounting (thickness 30 mm or more)

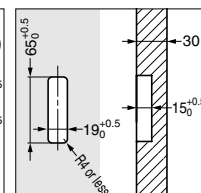

Metal Sheet Mounting

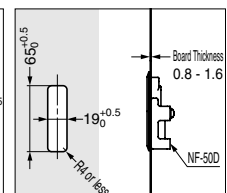

CAD	Item Code	Item Name	Finish/Colour	Load Capacity N	Load Capacity kgf	Weight (g)	Box (pcs)	Carton (pcs)				
2D/3D	110-041-175	NF-R52-SCR	Pearl Chrome Plating	196	20	70	10	120				
2D/3D	110-041-176	NF-R52-CR	Chrome Plating				10	120				
2D/3D	110-041-177	NF-R52-BL	Baked Enamel Finish/Matte Black				10	120				
2D/3D	110-020-068	NF-R64-SCR	Pearl Chrome Plating			90	20	70	10	120		
2D/3D	110-041-178	NF-R64-CR	Chrome Plating						10	120		
2D/3D	110-041-179	NF-R64-BL	Baked Enamel Finish/Matte Black						10	120		
2D/3D	110-034-954	NF-R64-GP	24K Gold Plating, Clear Coating					130	20	90	10	120
2D/3D	110-041-180	NF-R77-SCR	Pearl Chrome Plating								10	120
2D/3D	110-041-181	NF-R77-CR	Chrome Plating								10	120
2D/3D	110-041-182	NF-R77-BL	Baked Enamel Finish/Matte Black			10	120					