

MULTI-PURPOSE LIDS W/DAMPER (W/KEY) **INSTRUCTION** **SUS** **AZ-GD230L-HL**



**Features**

- The lid opening can be locked shut, preventing unauthorised substances from being inserted. This makes it easy to limit access to the waste area and prevent unintended uses.
- The indicator turns red when locked.
- The square type quarter turn lock makes it easy to remove obstructions such as chewing gum.
- Fitted with a vibration reduction mechanism to significantly reduce wobbling and clicking sounds.
- Soft-close functionality. Built-in damper causes lid to gently close when released, preventing slamming sounds.
- Side plates on the plate interior prevent fingers from getting stuck or pinched when lid closes.
- Designed for vertical use.
- Optional inlet guide to prevent items from falling out. (Sold separately)

**Specifications**

Operating temperature: 0°C - 40°C

**Application**

Dining areas on trains and in public locations including railway stations, retail facilities, and convenience stores.

**Remarks**

- Cannot be used outdoors.
- The closing speed of the cover varies depending on the temperature of the operating environment. If the product has been stored in subzero temperatures, expose it to indoor temperatures of 0°C or higher for several hours before use.

**Parts Included**

Key (200-0403 ), cautionary sticker, instruction manual

**Optional Parts**

AZ-SLP230 Inlet Guide (Sold separately)

**Recommended Screw**

Pan head tapping screws (nominal size 3) or pan head M3 screws (4 pcs)

MISCELLANEOUS

MULTI-PURPOSE LIDS W/DAMPER (W/KEY)

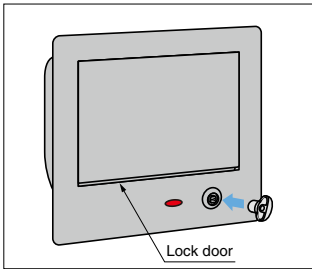

The cover of the inlet can be locked shut, preventing unauthorised substances from being inserted. This makes it easy to limit use of the waste chute to the intended purpose.

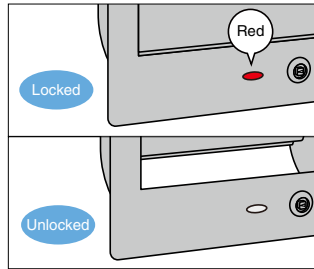

The indicator is red when locked.



Recommended for settings such as on-board transportation, where restricted usage of waste chutes is often required.



Key is 100 - 90 type.

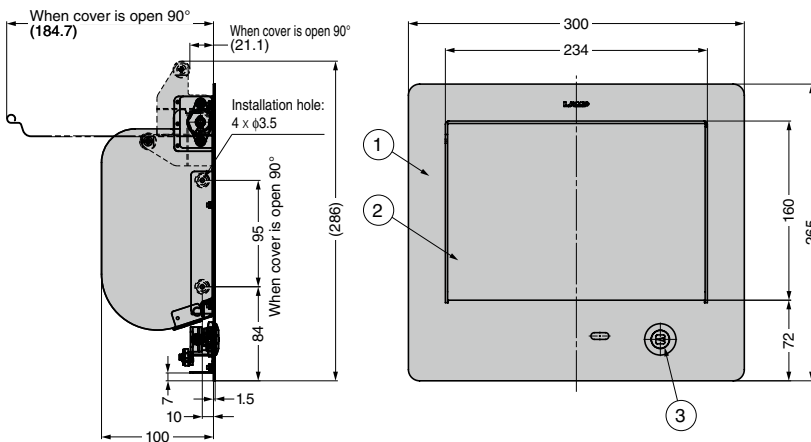

**Installation Hole Dimensions**

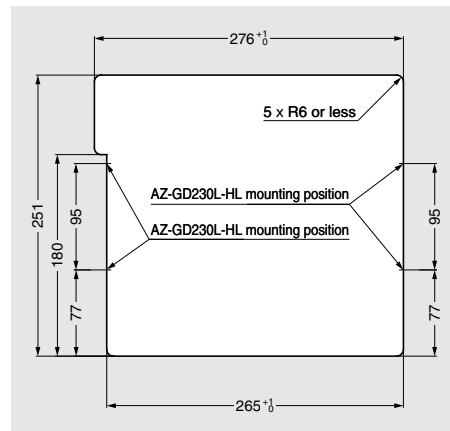

No.	Part Name	Material	Finish
①	Front Plate	Stainless Steel	Satin
②	Cover	(SUS304)	
③	Lock	Zinc Alloy/Steel	Chrome Plating/Gloss Chromate Finish

CAD	Item Code	Item Name	Material	Finish	Weight (g)	Box (pc)	Carton (pcs)
	210-037-892	AZ-GD230L-HL	Stainless Steel (SUS304)	Satin	2250	1	6