

CASTER WITH LEVELLING GLIDE AF Plate Type

LOAD CAPACITY 2499 N

- With integrated levelling glide.
- Low profile and heavy duty
- Ideal for fixtures and devices without frequent movement (long fixation period).
- Built-in bearing of wheel shaft provides excellent rotation and smooth movement.
- Can be installed at the four corners of cabinet.

[Applications]

- Medical equipment, automatic equipment, semiconductor equipment, financial equipment, other heavy equipment required for space saving, heavy equipment fixed for a long time, etc.

HEAVY DUTY CASTERS

SINGLE WHEEL CASTERS

TWIN WHEEL CASTERS

CASTERS WITH LEVELLING GUIDES

BALL CASTERS

SLIDING DOOR ROLLERS

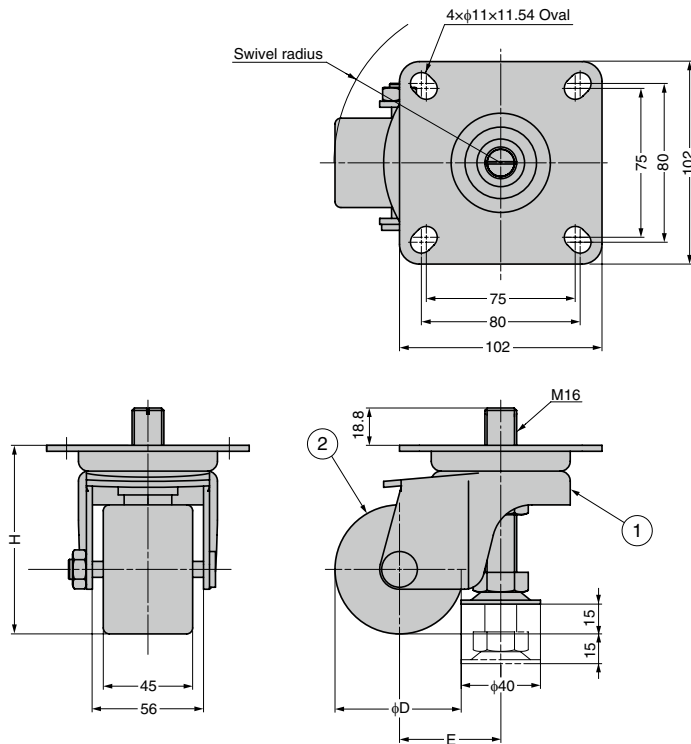

No.	Part Name	Material	Finish/Colour
①	Body	Steel (SPHC)	Clear Zinc Chromate (Trivalent)
②	Wheel	PA	Black

RoHS	CAD	Item Code	Item Name	D	H	E	Swivel Radius	Load Capacity N/pc	Load Capacity kgf/pc	Weight (kg)	Box (pcs)	Carton (pcs)
		200-130-390	AF-50	50	74	46	73	2499	255	1.19	18	-
		200-130-391	AF-65	65	95	51	84			1.32	12	-