

DUAL BRAKE SYSTEM CASTER (THREADED BOLT TYPE) EX-100N



Features

- Distinctive brake indicator makes it easy to recognize.
- A single lever locks both the wheel swivel and rotation.
- The large brake lever and easy to recognize indicator make operation easy.
- Both the wheel and the pivot have built-in ball bearings, making rotation and swiveling very smooth.
- Front rubber bumper protects from impacts. Type without brake also has back rubber bumper to protect feet.

w/ Brake

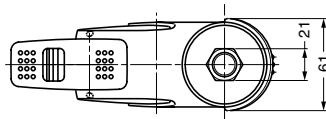

w/o Brake

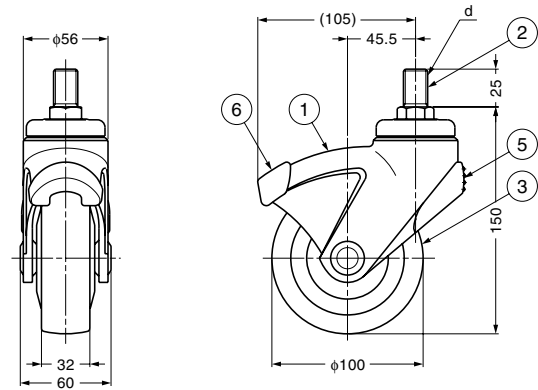
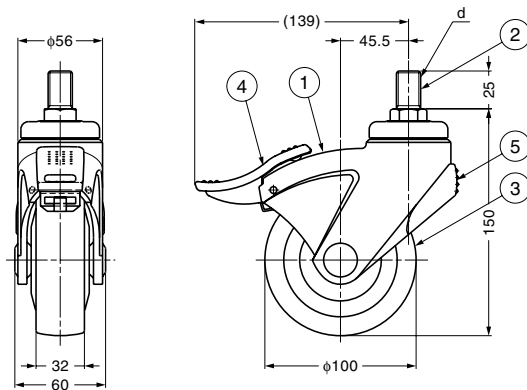
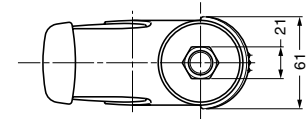

No.	Part Name	Material	Finish/Colour
①	Body	Polyamide (PA)	Light Grey
②	Threaded Bolt	Steel	Gloss Chromate
③	Wheel	Polypropylene (PP)/Elastomer (TPE)	Dark Grey
④	Brake	Polyamide (PA)	Dark Grey
⑤	Rear Bumper	Elastomer (TPE)	Dark Grey
⑥	Front Bumper	Elastomer (TPE)	Dark Grey

Item Code	Item Name	Type	d	Load Capacity N	Load Capacity kgf	Weight	Carton
200-132-736	EX-100N12S	With Brake	M12	980 N	100 kgf	785 g	20 pcs
200-132-730	EX-100N12	Without Brake	M12	980 N	100 kgf	647 g	20 pcs
200-132-733	EX-100N16S	With Brake	M16	980 N	100 kgf	698 g	20 pcs
200-132-732	EX-100N16	Without Brake	M16	980 N	100 kgf	661 g	20 pcs