

DUAL BRAKE SYSTEM CASTER

EX-100

Functional Caster Designed for Easy Operation

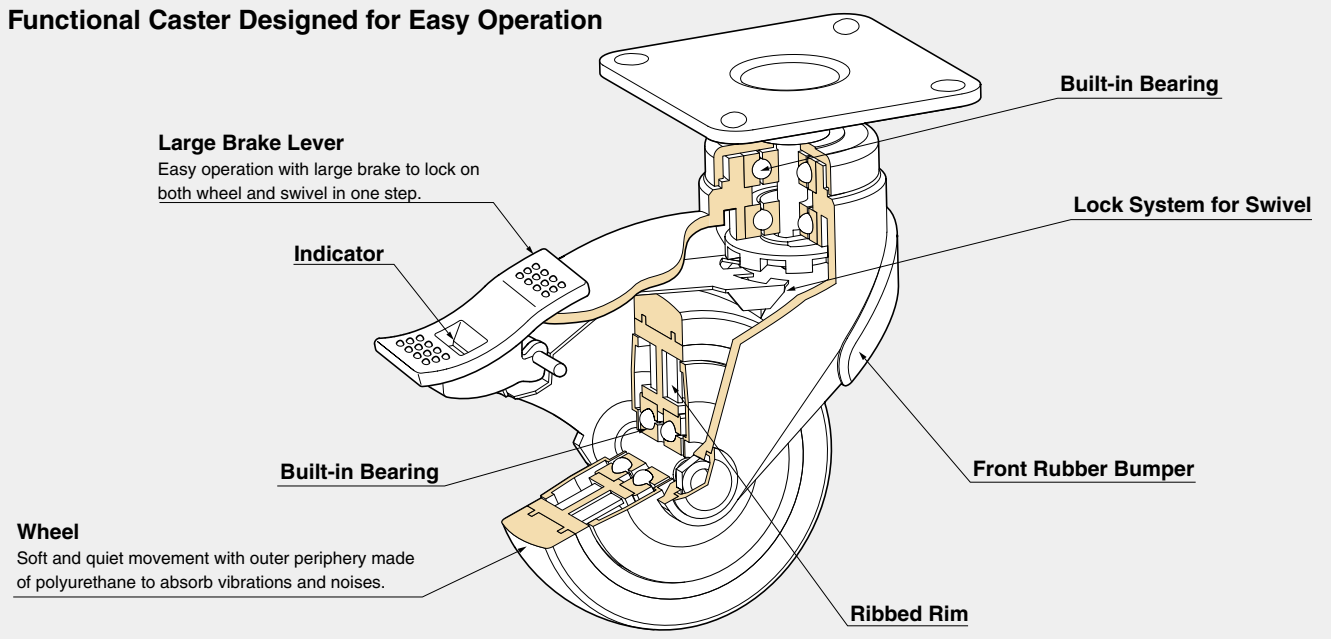

CASTERS & LEVELING GLIDES

DUAL BRAKE SYSTEM CASTER

DUAL BRAKE SYSTEM CASTER (PLATE TYPE)

EX-100P



Features

- Distinctive brake indicator makes it easy to recognize.
- A single lever locks both the wheel swivel and rotation.
- The large brake lever and easy to recognize indicator make operation easy.
- Both the wheel and the pivot have built-in ball bearings, making rotation and swiveling very smooth.
- Front rubber bumper protects from impacts. Type without brake also has back rubber bumper to protect feet.

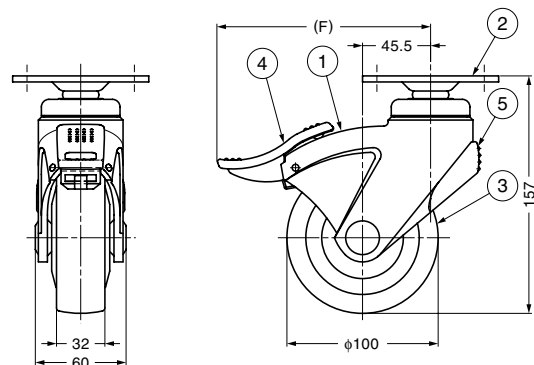
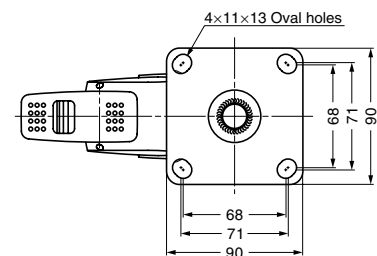

No.	Part Name	Material	Finish/Colour
①	Body	Polyamide (PA)	Light Grey
②	Plate	Steel	Gloss Chromate
③	Wheel	Polypropylene (PP)/Elastomer (TPE)	Dark Grey
④	Brake	Polyamide (PA)	Dark Grey
⑤	Rear Bumper	Elastomer (TPE)	Dark Grey

Item Code	Item Name	Type	F	Load Capacity N	Load Capacity kgf	Weight	Carton
200-132-735	EX-100PS	With Brake	139	980 N	100 kgf	899 g	20 pcs
200-132-734	EX-100P	Without Brake	105	980 N	100 kgf	867 g	20 pcs