

**RHOMBUSMUTTER****RHOMBUS NUT**

Ausführung Nut 8, Zinkdruckguss

Beschreibung Befestigungselement für Profilmütern, leicht eindrehbar, bleibt in der Nut verschiebbar

Material Zinkdruckguss, blank

Liefereinheit 100 Stück

Model *Slot 8, zinc die-cast*

Description *To fasten components to profiles, easy to insert, remains mobile in the slot*

Material *Zinc die-cast, plain*

Pack Quantity *100 pieces*

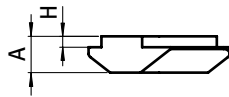
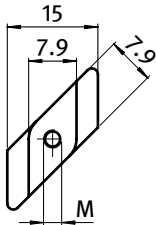

| Rhombusmutter <i>Rhombus Nut</i> | A [mm] | H [mm] | Größe <i>Size</i> | Gewicht [g] <i>Weight [g]</i> | Profil <i>Profile</i> | Teil-Nr. <i>Part #</i> |
|-------------------------------------|-----------|-----------|----------------------|----------------------------------|--------------------------|-----------------------------|
| | 6.0 | 1.8 | M3 | 4.1 | B | 096R080318Z |
| | 6.0 | 1.8 | M4 | 4.0 | B | 096R080418Z |
| | 6.0 | 1.8 | M5 | 3.9 | B | 096R080518Z |
| | 7.7 | 3.0 | M3 | 5.1 | I | 096R080330Z |
| | 7.7 | 3.0 | M4 | 5.0 | I | 096R080430Z |
| | 7.7 | 3.0 | M5 | 4.9 | I | 096R080530Z |