

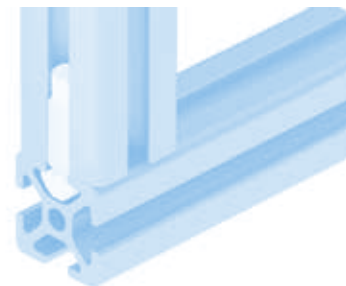

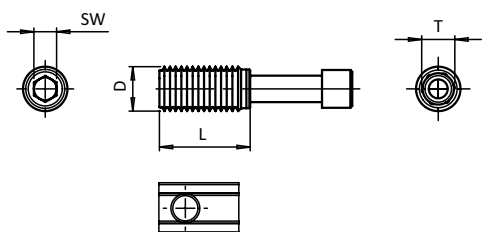



T-MATIC VERBINDER

T-MATIC CONNECTOR

Ausführung Stahl**Beschreibung** zur schnellen und stabilen Verbindung von zwei Aluminiumprofilen ohne Profilbearbeitung; selbstformendes Gewinde ohne Spanbildung**Material** Stahl, verzinkt**Liefereinheit** 100 Stück**Hinweis** * leicht eindrehbare Version mit geringerem Eindrehwiderstand
** passendes Abdeckblech siehe Seite 442**Model** Steel**Description** To connect two aluminum profiles fast and solid, assembly without machining; self-forming thread, without chipping**Material** Zinc plated steel**Pack Quantity** 100 pieces**Tip** * Version with lower screw-in resistance
** Compatible cover plate see page 442

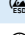
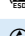
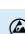
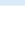
T-Matic Verbinder T-Matic Connector	D [mm]	L [mm]	SW	T	ESD	Nut Slot	Profilbreite Profile Width	Schraube Screw	Gewicht [g] Weight [g]	Profil Profile	Teil-Nr. Part #
ohne Nutenstein Without T-slot nut	7.0	14.0	3	T25		5	20	M4 × 20	4.0	I	099H051
	7.0	24.0	3	T25		5	20	M4 × 30	6.4	I	099H053
	10.0	20.0	5	T40		6	30	M6 × 29	11.0	I	099H061
	11.5	24.0	5	T45		8	30	M6 × 34	15.5	B	099H083
	12.0	24.0	6	T50		8	40	M8 × 35	21.0	I	099H081 **
	11.5	24.0	6	T50		8	40	M8 × 35	20.3	I	099H081L* **
	12.0	32.0	6	T50		8	40	M8 × 43	27.0	I	099H082
	14.0	24.0	6	T50		8	45	M8 × 37	31.5		099H084
	12.0	24.0	6			10	40, 45	M8 × 37	21.0	B	099H102
	13.0	24.0	6			10	45	M8 × 37	26.0	B	099H101
mit Nutenstein With T-slot nut	7.0	14.0	3	T25		5	20	M4 × 20	6.0	I	099H052
	7.0	24.0	3	T25		5	20	M4 × 30	8.2	I	099H054
	10.0	20.0	5	T40		6	30	M6 × 29	16.0	I	099H062
	11.5	24.0	5			8	30	M6 × 34	15.0	B	099H087
	12.0	24.0	6			8	40	M8 × 35	30.0	I	099H085 **
	11.5	24.0	6			8	40	M8 × 35	29.0	I	099H085L* **
	12.0	32.0	6			8	40	M8 × 43	36.0	I	099H086
	14.0	24.0	6			8	45	M8 × 37	40.5		099H088
	12.0	24.0	6			10	40, 45	M8 × 37	32.0	B	099H104
	13.0	24.0	6			10	45	M8 × 37	37.0	B	099H103
	7.0	14.0	3	T25		5	20	M4 × 20	6.0	I	099H052ESD
	7.0	24.0	3	T25		5	20	M4 × 30	8.2	I	099H054ESD
	10.0	20.0	5	T40		6	30	M6 × 29	16.0	I	099H062ESD
	11.5	24.0	5			8	30	M6 × 34	15.0	B	099H087ESD
	12.0	24.0	6			8	40	M8 × 35	30.0	I	099H085ESD **
	11.5	24.0	6			8	40	M8 × 35	29.0	I	099H085LES * **
	12.0	32.0	6			8	40	M8 × 43	36.0	I	099H086ESD
	12.0	24.0	6			10	40, 45	M8 × 37	32.0	B	099H104ESD
	13.0	24.0	6			10	45	M8 × 37	37.0	B	099H103ESD