

Scharniere Hinges

Edelstahlscharniere *Stainless Steel Hinges*

Kombischarniere *Combi Hinges*



EDELSTAHL-KOMBISCHARNIER 40

STAINLESS STEEL COMBI HINGE 40

Ausführung	aushängbar	Model	Detachable
Beschreibung	für Flächenelemente und Aluminiumprofile	Description	To hinge panels or aluminum profiles
Material	Flügel: Edelstahl 1.4401 Achse: Edelstahl 1.4104	Material	Wing: Stainless steel SS316 Axle: Stainless steel SS430 F
Befestigung	vorderseitig mit Senkschrauben M6	Fastening	From the front, using M6 countersunk screws
Liefereinheit	10 Stück	Pack Quantity	10 pieces

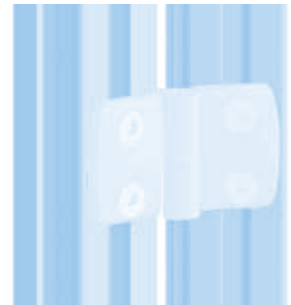
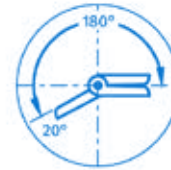
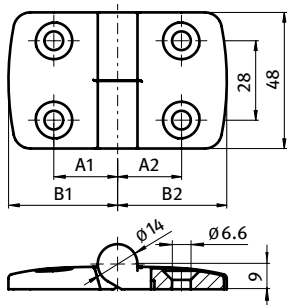

Kombischarnier Combi Hinge	A1 [mm]	A2 [mm]	B1 [mm]	B2 [mm]	F _{Amax} [N]	F _{Rmax} [N]	Bezeichnung Description	Gewicht [g] Weight [g]	Teil-Nr. Part #
L: links <i>Left</i>	22.5	22.5	38.5	38.5	500	1200	40/40	204.0	095E4040L
R: rechts <i>Right</i>	22.5	22.5	38.5	38.5	500	1200	40/40	204.0	095E4040R

