

Scharniere Hinges

Edelstahlscharniere *Stainless Steel Hinges*

Kombischarniere *Combi Hinges*



**EDELSTAHL-KOMBISCHARNIER 30**

**STAINLESS STEEL COMBI HINGE 30**

<b>Ausführung</b>	aushängbar	<b>Model</b>	Detachable
<b>Beschreibung</b>	für Flächenelemente und Aluminiumprofile	<b>Description</b>	To hinge panels or aluminum profiles
<b>Material</b>	Flügel: Edelstahl 1.4401 Achse: Edelstahl 1.4104	<b>Material</b>	Wing: Stainless steel SS316 Axle: Stainless steel SS430 F
<b>Befestigung</b>	vorderseitig mit Senkschrauben M6	<b>Fastening</b>	From the front, using M6 countersunk screws
<b>Liefereinheit</b>	10 Stück	<b>Pack Quantity</b>	10 pieces

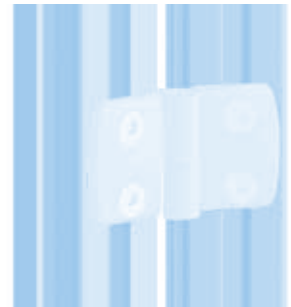
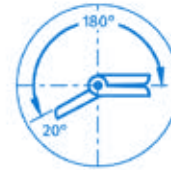
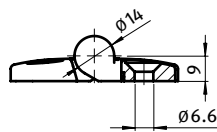
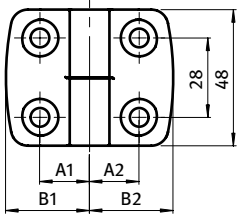

Kombischarnier Combi Hinge	A1 [mm]	A2 [mm]	B1 [mm]	B2 [mm]	F <sub>Amax</sub> [N]	F <sub>Rmax</sub> [N]	Bezeichnung Description	Gewicht [g] Weight [g]	Teil-Nr. Part #
L: links <i>Left</i>	17.5	17.5	29.5	29.5	710	1000	30/30	160.0	<b>095E3030L</b>
R: rechts <i>Right</i>	17.5	17.5	29.5	29.5	710	1000	30/30	160.0	<b>095E3030R</b>

