

Nutmuttern und -schrauben *T-Nuts and T-Bolts*Nutensteine *T-slot Nuts*Nut 8 *Slot 8***NUTENSTEIN 13,5 × 7,2 MM, EINSCHWENKBAR****ROLL-IN T-SLOT NUT 13.5 × 7.2 MM**

**Ausführung** Nut 8, mit Führungssteg und Federkugel, Stahl / Edelstahl

**Beschreibung** einschwenkbarer Nutenstein mit Führungssteg und Federkugel

**Material** Nutenstein: Stahl, verzinkt / Edelstahl 1.4301 / 1.4305  
Profil: Stahl, blank, ohne Gewinde  
Kugel: Edelstahl

**Liefereinheit** 100 Stück

**Extras**  elektrostatisch entladend, verschiedene Längen mit mehreren Gewinden in unterschiedlichen Größen auf Anfrage

**Model** Slot 8, self-aligning with spring loaded ball, steel / stainless steel





**Description** Self-aligning roll-in T-slot nut with spring loaded ball

**Material** T-slot nut: Zinc plated steel / stainless steel SS304 / SS303  
Rod: Steel, plain, without thread  
Ball: Stainless steel

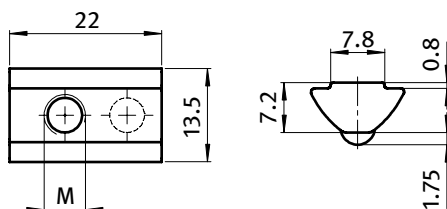
**Pack Quantity** 100 pieces

**Specials**  electrostatically discharging, different lengths with multiple threads in different sizes available on request

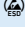

Nutenstein T-slot Nut	ESD	Größe Size	Gewicht [g] Weight [g]	Profil Profile	Teil-Nr. Part #
Stahl <i>Steel</i>		M3	10.9	I	<b>096023</b>
		M4	10.8	I	<b>096024</b>
		M5	10.5	I	<b>096025</b>
		M6	9.9	I	<b>096026</b>
		M8	9.0	I	<b>096028</b>
		10-32 UNF	10.9	I	<b>09602U10-32</b>
Stahl <i>Steel</i>	elektrostatisch entladend  <i>electrostatically discharging</i>	M4	10.8	I	<b>096024S01</b>
	elektrostatisch entladend  <i>electrostatically discharging</i>	M5	10.5	I	<b>096025S01</b>
	elektrostatisch entladend  <i>electrostatically discharging</i>	M6	9.9	I	<b>096026S01</b>
	elektrostatisch entladend  <i>electrostatically discharging</i>	M8	9.0	I	<b>096028S01</b>
Edelstahl <i>Stainless steel</i>		M5	10.5	I	<b>096025E</b>
		M6	9.9	I	<b>096026E</b>
		M8	9.0	I	<b>096028E</b>
Profil, Stahl <i>Rod, steel</i>		1500 mm	834.0	I	<b>096020.1500</b>