

# DZUS® QUARTER-TURN FASTENERS

## DZUS® Quarter-Turn Fasteners



## DZUS® Quarter-Turn Fasteners

Southco offers an extensive selection of **DZUS®** Quarter-Turn Fasteners to satisfy a broad range of requirements for quick access, high strength, and economical performance. Each product line comes with its own set of matched receptacles for accurate, secure engagement and convenient mounting in a range of applications.

## The **DZUS®** advantage

- Low installation cost
- Fast, repeatable access
- Lower assembly cost
- Faster service calls
- Better ergonomics
- Improved aesthetics

82



85



D8



D1



D4



D5



## PANEX Quarter-Turn Design

- Bail and wing design
- Snap-on, ergonomic bail covers
- Available in bright, black and chrome finishes



.....and more is on the way.

For the latest updates and additions to all of Southco's quick access products go to [www.southco.com/dzus](http://www.southco.com/dzus)



D7



NY



# DZUS® Quarter-Turn Fasteners

## System selection guide

### Typical assembly



- 82
- 85
- D8
- D1
- D4
- D5
- D7
- NY

### Notes

TMT measures total material thickness (TMT) of the application. Tolerance in this measurement must be below the figure given in the selection table.



Available on request. Requires a modification request to Southco Engineering. Please contact your local Southco representative or send us an email to [info@southco.com](mailto:info@southco.com)



[www.southco.com/DZUS](http://www.southco.com/DZUS)

DZUS® Quarter-Turn Systems	TMT Tolerance	Cycle Life	Tensile Load	Vibration Resistance	Stainless Steel Available
<b>Determine the best quick access fastening system for your application</b>			Guidelines: Moderate = 500-2000 High = 2000 +		
<b>82 and 85 Lion</b> • High strength • High cycle life • Variety of styles	 0.5 (.020)	High	High	Moderate	✓
<b>D8 PANEX Fasteners</b> • Grip tolerant • Moderate cycle life • Variety of styles	 0.9 (.035)	Moderate	Medium	Moderate	☎
<b>D1 Dart</b> • Plastic design • Light-weight • New Wing design	 1.2 (.049)	High	Low	Moderate	N/A
<b>D4 Standard</b> • High clamp force • High strength • Vibration resistant	 0.6 (.024)	Moderate	High	High	✓
<b>D5 Panel Line</b> • Captive to outer panel • Vibration resistant • Visual latched indication	 0.23 (.021)	Moderate	High	High	N/A
<b>D7 Pilot</b> • Push-to-close • Vibration resistant • Quarter-turn-to-open	 2.4 (.98)	High	Medium	Moderate	☎
<b>D7 Arrow</b> • Push-to-close • Quarter-turn-to-open • Light-duty	 3.1 (.12)	High	Low	Moderate	N/A
<b>NY Q-Latch</b> • Turn to close • Snap-in installation • Quarter-turn-to-open	 2.26 (.089)	High	Low	Moderate	N/A

Dimensions in millimeters (inch) unless otherwise stated

		Receptacle Type - Check Below Availability and Recommended Panel Configuration												
Determine frame type and select receptacle		Clip-On	Self-Clinching	Snap-In	Front Load Clip-In	Blind Press-In	Ultrasonic	Rivet-On	Weld-On	Side Mount	Vibration Isolating	Heavy Duty S-Spring	Flaring Assembly	Strip
QUARTER-TURN FASTENERS	82, 85 Lion	✓	✓	✓		✓	✓	✓	✓	✓	✓			
	D8 PANEX Fasteners	✓	✓		✓	✓	✓	✓	✓	✓				
	D1 Dart	✓		✓				✓						
	D4 Standard	✓		✓				✓	✓			✓		
	D5 Panel Line											✓		✓
	D7 Pilot			✓										
	D7 Arrow			✓									✓	
	NY Q-Latch			✓									✓	
FRAME TYPE	Near Edge Installation	✓		✓	✓			✓	✓	✓	✓	✓	✓	✓
	Sheet Metal Installation	✓	✓	✓	✓			✓	✓	✓	✓	✓	✓	✓
	Plastic and Composites	✓		✓	✓	✓	✓	✓		✓	✓	✓	✓	✓
	Blind Holes and Tubular Frames			✓	✓	✓	✓						✓	
	Metal Casting	✓		✓	✓	✓		✓		✓	✓	✓	✓	✓
	High Vibration	✓		✓	✓			✓	✓	✓	✓	✓		✓



## DZUS® Quarter-Turn Fasteners

Actuation styles

### DZUS® Online Help

Interactive product guide

➔ View product animations

➔ View solutions

➔ Get detailed product information including CAD models downloaded in your native format

82

85

D8

D1

D4

D5

D7

NY



Available on request. Requires a modification request to **SOUTHCO®** Engineering. Please contact your local **SOUTHCO®** representative or send us an email to [info@southco.com](mailto:info@southco.com)



[www.southco.com/dzus](http://www.southco.com/dzus)

### ACTUATION STYLES

Select the actuation style	ACTUATION STYLES						
	Tool Actuated				Hand Actuated		
	Slotted Access	Phillips Recess	Hex Recess	Security Recess	Ball Style	Wing Style	Knob Style
82/85 Lion 	✓	✓	✓	✓	✓	✓	
D8 PANEX Fasteners 	✓	✓	✓	✓	✓	✓	
D1 Dart 	✓		✓			✓	✓
D4 Standard 	✓	✓	✓		✓	✓	
D5 Panel Line 	✓						
D7 Pilot 		✓					
D7 Arrow 	✓		✓			✓	✓
NY Q-Latch 	✓					✓	

Dimensions in millimeters (inch) unless otherwise stated

DZUS®

southco®  
CONNECT · CREATE · INNOVATE

### (DZUS® specification worksheet)

Use the following worksheet to specify the parts for your

**DZUS® quick access system (Example in blue)**

System type: **82 DZUS® Lion quarter-turn fastener**

#### 1. Select receptacle type: Clip-on: 82-47-113-15 page 383

**Notes:** Stud selection column letter shown will be used to determine stud length in step 4. Ensure the receptacle chosen will accommodate the frame thickness.

#### 2. Select retainer and accessories and note any adjustment values:

**Accessories:** Cupped washer, black 82-46-101-41 page 385

**Retainer:** Stainless Steel, 82-32-201-20

**Adjustment values:**

**When using a cupped washer, add 0.5 (.020) to outer panel thickness or total material thickness (TMT).**

#### 3. Specify stud length: To determine stud length, first determine the material thickness value, TMT.

**Notes:** Each receptacle has a unique formula to calculate the value of TMT. Use the formulas given with the receptacle you choose. Add accessory adjustment values to TMT as appropriate.

Select the configuration that best represents the application

Application configuration: **Type 2** (page 383)

Outer panel thickness: **2 (.078)**

Frame thickness: **2 (.078)**

Gap thickness: **0 (0)**

Accessory adjustment: **Add 0.5 (.020) to outer panel (P)**

**Configuration Type 2:**

Calculate TMT using the formulas given for the receptacle.

**Example:**

**TMT = P + F + 1.4 (.055) + 0.5 (.020) (for cupped washer thickness)**

**TMT = 2 (.078) + 2 (.078) + 1.4 (.055) + 0.5 (.020) = 5.9 (.232).**

#### 4. Finish the stud part number: (page 379)

Head style: **Wing head**

Material: **Steel, zinc plated**

**Final list of materials:**

- 82 -47-113-15** Receptacle: Steel clip-on
- 82 -32-201-20** Retainer: Stainless steel
- 82 -46-101-41** Accessory: Cupped washer, black
- 82 -12-240-16** Stud: Wing head, K=240, steel, zinc plated

**Notes:** Ensure final list of materials are from the same product class and size

#### Choose system (page 376)

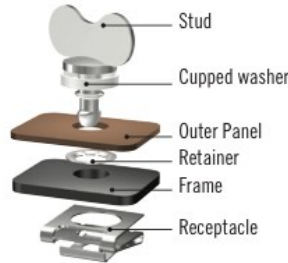

#### 1. Select receptacle type

Clip-on receptacle 82-47-113-15

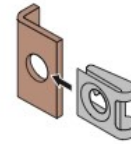

#### 2. Select accessories

Cup washer add 0.5 (.020) to the outer panel thickness (P) 82-46-101-41

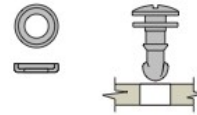

#### 3. Calculate TMT

Type 1



$$TMT = P + F$$

Type 2



$$TMT = P + F + 1.4 (.055)$$

#### Configuration 2

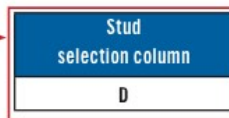

Use the TMT value to find the correct stud length on the stud selector page.

The correct column of TMT ranges is given on the receptacle page.

TMT Range		K
Min.	Max.	
2.3 (.090)	2.8 (.110)	100
2.8 (.110)	3.3 (.130)	120
3.3 (.130)	3.8 (.150)	140
3.8 (.150)	4.3 (.170)	160
4.3 (.170)	4.8 (.190)	180
4.8 (.190)	5.3 (.210)	200
5.3 (.210)	5.8 (.230)	220
5.8 (.230)	6.3 (.250)	240

#### Stud: Part Number Selection

**H** Head style ← Enter number from selection table

- 11 Oval slot
- 12 Wing head
- 15 Bail RA
- 16 Bail RB
- 78 Hex recess
- 19 Oval Phillips recess
- T Tool head recess

**K** Length ← Enter number from selection table

**M** Material ←

- 16 Steel, zinc plated
- 20 Stainless steel

**82 - H - K - M**



# 82 DZUS® Performance Quarter-Turn Fasteners Studs

## Material and Finish

Studs: Steel, zinc plated and chromate or stainless steel  
 Bail cover: ABS, black

## Accessories

Tool head recess key:  
 Part number: 29-90-214-10

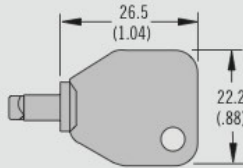

## H Head Styles - Tool Actuated

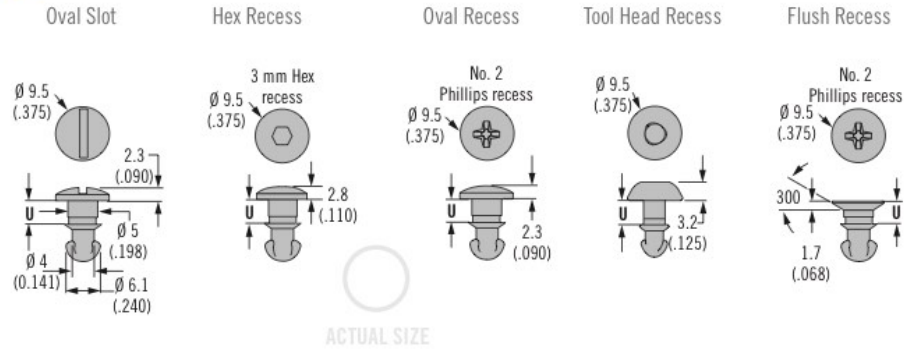

## H Head Styles - Hand Actuated

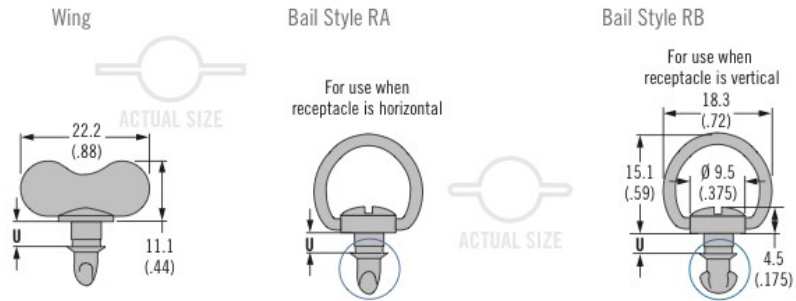

## Optional Bail Cover

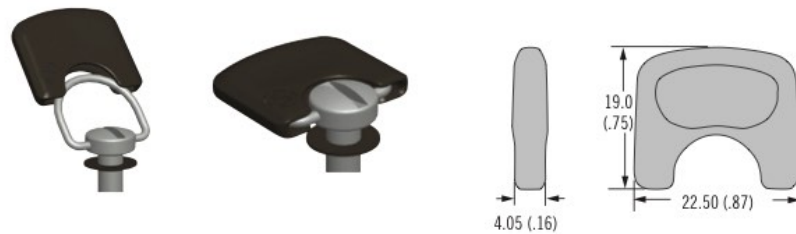

Bail Cover Part Number
82-2-B-000

## Stud Panel Preparation

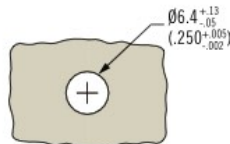

## Flush Head Styles

(when outer panel is 1.3 (.050) or greater)

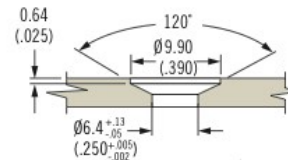

## Installation Notes

Bail cover:  
 A retainer must be fitted under the stud head to fit flush with surface  
 Retainer part number 82-32-301-12 (see page 385)

**INFO CLIC** [www.southco.com/82](http://www.southco.com/82)

Dimensions in millimeters (inch) unless otherwise stated

**DZUS® southco®**  
 CONNECT · CREATE · INNOVATE

# 82 DZUS® Lion Quarter-Turn Fasteners

## Stud selection



379

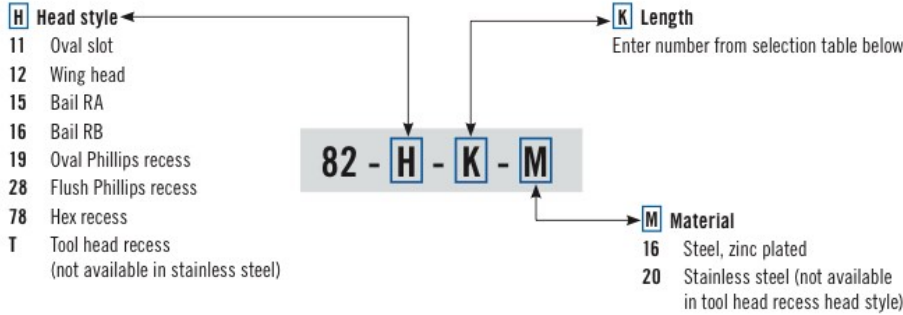

Stud Length Table									
A		B		C		D		K	U
TMT Range For: 82-35-306-10		TMT Range For: 82-35-308-55 82-35-310-55		TMT Range For: 82-35-315-55		TMT Range For: All Other Receptacles			
Min.	Max.	Min.	Max.	Min.	Max.	Min.	Max.		
0.7 (.026)	1.2 (.045)	~	~	~	~	2.3 (.090)	2.8 (.110)	100	3.2 (.127)
1.2 (.045)	1.7 (.065)	~	~	~	~	2.8 (.110)	3.3 (.130)	120	3.7 (.147)
1.7 (.065)	2.2 (.085)	~	~	~	~	3.3 (.130)	3.8 (.150)	140	4.2 (.167)
2.2 (.085)	2.7 (.105)	0 (0)	0.5 (.019)	1.3 (.050)	1.8 (.070)	3.8 (.150)	4.3 (.170)	160	4.7 (.187)
2.7 (.105)	3.2 (.125)	0.5 (.019)	1 (.039)	1.8 (.070)	2.3 (.090)	4.3 (.170)	4.8 (.190)	180	5.3 (.207)
3.2 (.125)	3.7 (.145)	1 (.039)	1.5 (.059)	2.3 (.090)	2.8 (.110)	4.8 (.190)	5.3 (.210)	200	5.8 (.227)
3.7 (.145)	4.2 (.165)	1.5 (.059)	2 (.079)	2.8 (.110)	3.3 (.130)	5.3 (.210)	5.8 (.230)	220	6.3 (.247)
4.2 (.165)	4.7 (.185)	2 (.079)	2.5 (.099)	3.3 (.130)	3.8 (.150)	5.8 (.230)	6.3 (.250)	240	6.8 (.267)
4.7 (.185)	5.2 (.205)	2.5 (.099)	3 (.119)	3.8 (.150)	4.3 (.170)	6.4 (.250)	6.9 (.270)	260	7.3 (.287)
5.2 (.205)	5.7 (.225)	3 (.119)	3.5 (.139)	4.3 (.170)	4.8 (.190)	6.9 (.270)	7.4 (.290)	280	7.8 (.307)
5.7 (.225)	6.2 (.245)	3.5 (.139)	4.1 (.159)	4.8 (.190)	5.3 (.210)	7.4 (.290)	7.9 (.310)	300	8.3 (.327)
~	~	4.1 (.159)	4.6 (.179)	5.3 (.210)	5.8 (.230)	7.9 (.310)	8.4 (.330)	320	8.8 (.347)
~	~	4.6 (.179)	5.1 (.199)	5.8 (.230)	6.3 (.250)	8.4 (.330)	8.9 (.350)	340	9.3 (.367)
~	~	5.1 (.199)	5.6 (.219)	6.3 (.250)	6.8 (.270)	8.9 (.350)	9.4 (.370)	360	9.8 (.387)
~	~	5.6 (.219)	6.1 (.239)	6.8 (.270)	7.3 (.290)	9.4 (.370)	9.9 (.390)	380	10.3 (.407)
~	~	6.1 (.239)	6.6 (.259)	7.3 (.290)	7.8 (.310)	9.9 (.390)	10.4 (.410)	400	10.8 (.427)
~	~	6.6 (.259)	7.1 (.279)	7.8 (.310)	8.3 (.330)	10.4 (.410)	10.9 (.430)	420	11.4 (.447)
~	~	7.1 (.279)	7.6 (.299)	8.3 (.330)	8.8 (.350)	10.9 (.430)	11.4 (.450)	440	11.9 (.467)
~	~	7.6 (.299)	8.1 (.319)	8.8 (.350)	9.3 (.370)	11.4 (.450)	11.9 (.470)	460	12.4 (.487)
~	~	8.1 (.319)	8.6 (.339)	9.3 (.370)	9.8 (.390)	11.9 (.470)	12.4 (.490)	480	12.9 (.507)
~	~	8.6 (.339)	9.1 (.359)	9.8 (.390)	10.3 (.410)	12.5 (.490)	12.9 (.510)	500	13.4 (.527)
~	~	9.1 (.359)	9.6 (.379)	10.3 (.410)	10.8 (.430)	13 (.510)	13.5 (.530)	520	13.9 (.547)
~	~	9.6 (.379)	10.1 (.399)	10.8 (.430)	11.3 (.450)	13.5 (.530)	14 (.550)	540	14.4 (.567)
~	~	10.1 (.399)	10.6 (.419)	11.3 (.450)	11.8 (.470)	14 (.550)	14.5 (.570)	560	14.9 (.587)
~	~	10.6 (.419)	11.1 (.439)	11.8 (.470)	12.3 (.490)	14.5 (.570)	15 (.590)	580	15.4 (.607)

### Part Number Selection

82

85

D8

D1

D4

D5

D7

NY



### To select correct fastener:

#### 1. Select receptacle

Choose a receptacle from pages 380-384

#### 2. Select retainer and accessories

from page 385 and note any adjustment values

#### 3. Specify stud length

Calculate the total material thickness (TMT) using the formula given for the receptacle selected. Find the range of TMT using the stud length selection table (left) using the column (A, B, C, or D) given for the receptacle selected, find **K**.

#### 4. Complete the stud part number

by specifying the head style **H**, stud length **K**, and material **M**.

#### Example:

For rivet-on with base receptacle 82-35-302-15 use column D

For TMT value calculated as 5.2 (.206), K = 200

For slotted head style in steel material, completed part number: 82-11-200-16

A complete example can be found on page 377

#### Notes

Stainless steel material may require a higher minimum order quantity. Contact Southco for details.







## 82 DZUS® Lion Quarter-Turn Fasteners Receptacles

### Material and Finish

Steel, zinc immersion coating

### 82 Installation Notes

85 Install with  $\varnothing$  2.5 (3/32) rivets, spring plate must float freely after riveting

D8

D1

D4

D5

D7

NY

### Part Number

See table

### Notes

Utilize stud selection column indicated when choosing a stud length from the stud length table on page 379

### Rivet-On With Base

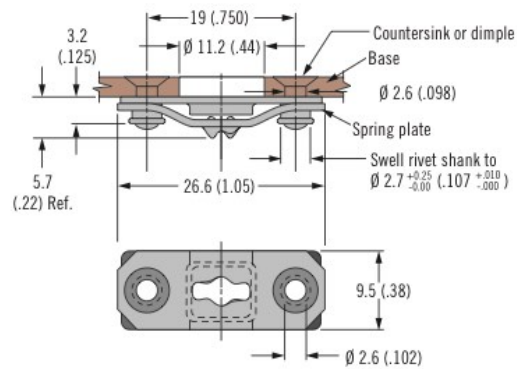

ACTUAL SIZE

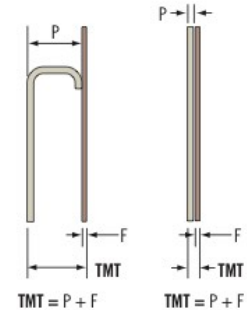

Part Number	Stud Selection Column
82-35-302-15	D

### Material and Finish

Steel, zinc immersion coating or stainless steel

### Installation Notes

Install with  $\varnothing$  2.5 (3/32) rivets, spring plate must float freely after riveting

### Rivet-On Without Base

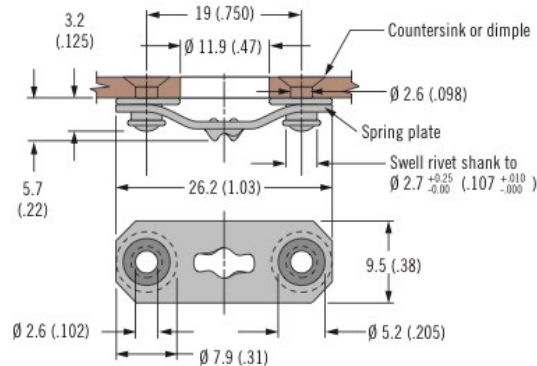

ACTUAL SIZE

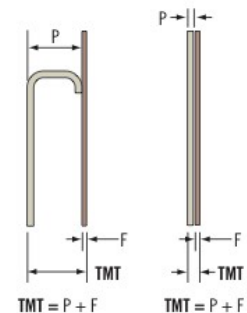

Material	Part Number	Stud Selection Column
Steel	82-35-295-15	D
Stainless steel	82-35-295-20	

### Part Number

See table

### Notes

Utilize stud selection column indicated when choosing a stud length from the stud length table on page 379

INFO CLIC [www.southco.com/82](http://www.southco.com/82)

Dimensions in millimeters (inch) unless otherwise stated

DZUS® southco®  
CONNECT · CREATE · INNOVATE

# 82 DZUS® Lion Quarter-Turn Fasteners Receptacles



381

## Weld-On

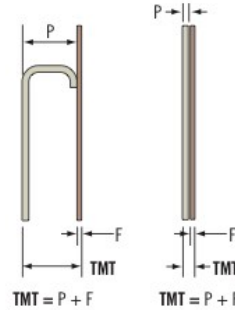
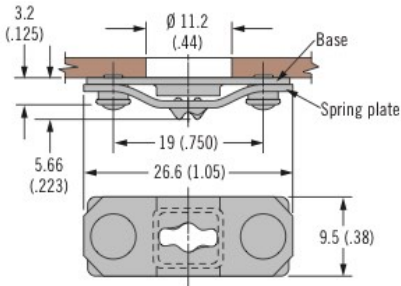

ACTUAL SIZE

Part Number	Stud Selection Column
82-35-303-15	D

## Material and Finish

Steel, zinc immersion coating

## Installation Notes

Spring plate must float freely after welding

82

85

D8

D1

D4

D5

D7

NY



## Part Number

See table

## Notes

Utilize stud selection column indicated when choosing a stud length from the stud length table on page 379

## Side Mount

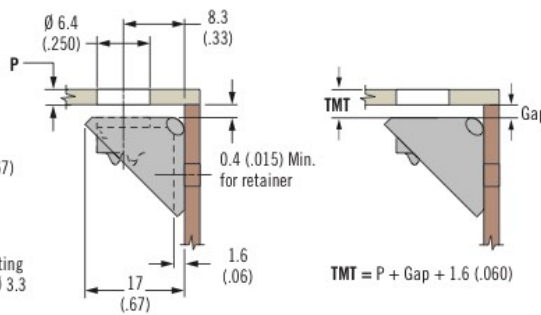
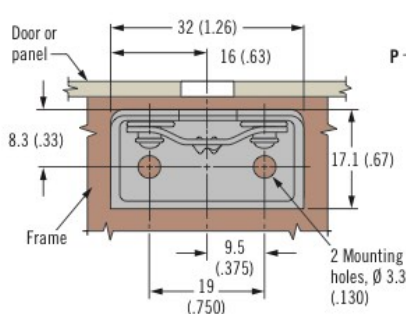

ACTUAL SIZE

Part Number	Stud Selection Column
82-45-101-15	D

## Material and Finish

Steel, zinc immersion coating

## Installation Notes

Install with  $\varnothing 2.5$  (3/32) rivets

## Part Number

See table

## Notes

Utilize stud selection column indicated when choosing a stud length from the stud length table on page 379



## 82 DZUS<sup>®</sup> Lion Quarter-Turn Fasteners Receptacles

### Material and Finish

Steel, zinc plated and neoprene

82

### Installation Notes

Install with  $\varnothing$  2.5 (3/32) rivets

85

D8

D1

D4

D5

D7

NY

### Part Number

See table

### Notes

Utilize stud selection column indicated when choosing a stud length from the stud length table on page 379

### Vibration Isolating

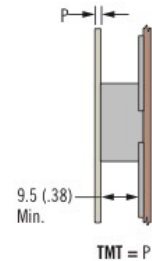
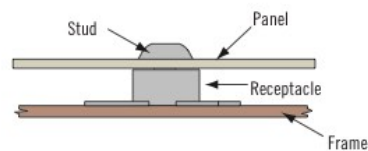
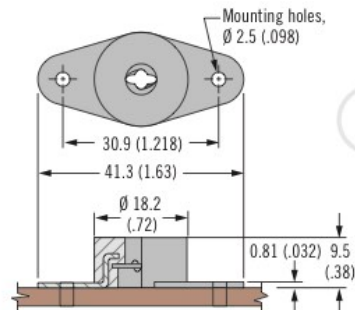

Part Number	Stud Selection Column
82-35-306-10	A

### Material and Finish

Steel, zinc plated and stainless steel

### Installation Notes

Installation Tool



Part Number: 29-8125-309

### Snap-In - Front Mount

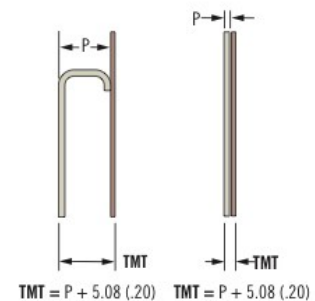
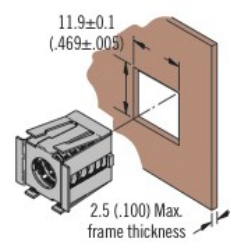
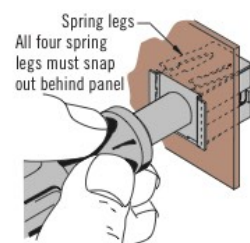
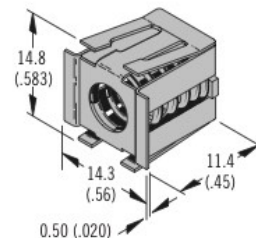

Part Number	Stud Selection Column
82-35-309-56	D

INFO CLIC [www.southco.com/82](http://www.southco.com/82)

Dimensions in millimeters (inch) unless otherwise stated

**DZUS<sup>®</sup>** **southco<sup>®</sup>**  
CONNECT · CREATE · INNOVATE

# 82 DZUS® Lion Quarter-Turn Fasteners Receptacles



383

## Clip-On

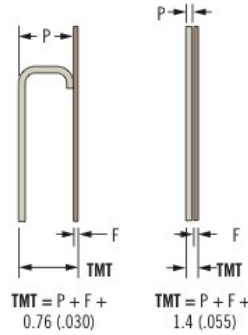
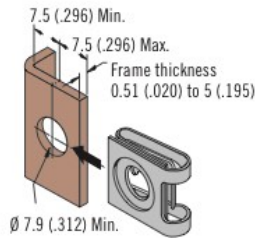
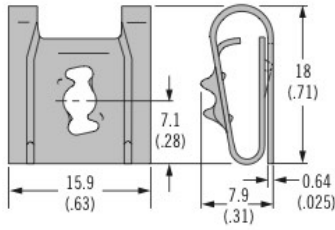

## By Hand



## With Screwdriver



Material	Part Number	Stud Selection Column
Steel	82-47-113-15	D
Stainless steel	82-47-113-20	

## Material and Finish

Steel, zinc immersion coating or stainless steel

82

85

D8

D1

D4

D5

D7

NY

## Part Number

See table

## Notes

Utilize stud selection column indicated when choosing a stud length from the stud length table on page 379

## Press-In

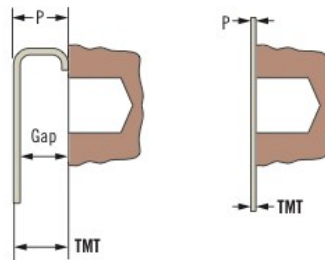
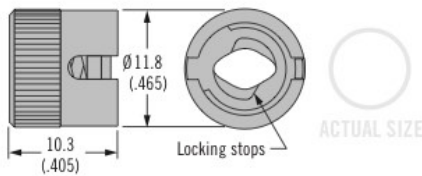

$$TMT = P + \text{Gap} - 0.5 (.020) \text{ (when gap is } > \text{ retainer thickness)}$$

$$TMT = P + \text{(Retainer adjustment value)} - 0.5 (.020)$$

## Solid Install

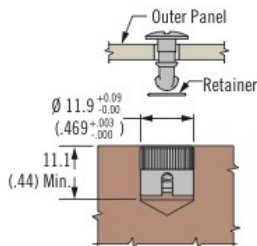

## Blind Install

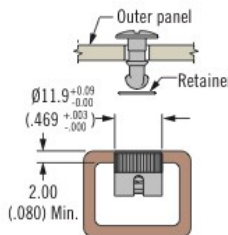

Part Number	Stud Selection Column
82-35-308-55	B

## Material and Finish

Steel, zinc plated and stainless steel

## Installation Notes

Press receptacle flush to frame

## Notes

Receptacle shown installed flush to the frame. To eliminate the gap between the frame and outer panel, install to a depth  $\geq$  the thickness of the selected retainer. This depth should be added to the TMT.

## Part Number

See table

## Notes

Utilize stud selection column indicated when choosing a stud length from the stud length table on page 379



## 82 DZUS® Lion Quarter-Turn Fasteners

### Receptacles · Self-clinching

#### Material and Finish

Steel, zinc plated and stainless steel

82

#### Installation Notes

Press receptacle flush to frame

85

D8

#### Notes

Receptacle shown installed flush to the frame. To eliminate the gap between the frame and outer panel, install to a depth  $\geq$  the thickness of the selected retainer. This depth should be added to the TMT.

D1

D4

D5

D7

NY

#### Part Number

See table

#### Notes

Utilize stud selection column indicated when choosing a stud length from the stud length table on page 379

#### Ultrasonic For Thermoplastics

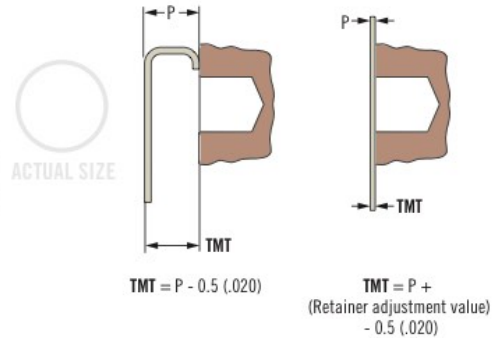
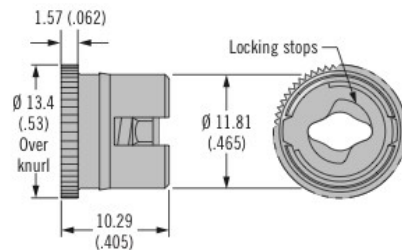

#### Installation

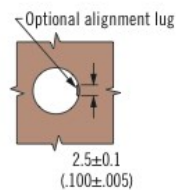

#### Blind Hole Installation

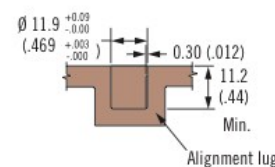

#### Thru Hole Installation

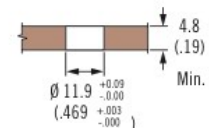

Part Number	Stud Selection Column
82-35-310-55	B

#### Material and Finish

Steel, zinc plated and stainless steel

#### Installation Notes

For use in low carbon steels, aluminum and stainless steels in the annealed condition that are R<sub>s</sub> 85 or softer

See page 543 for installation guidelines

#### Part Number

See table

#### Notes

Utilize stud selection column indicated when choosing a stud length from the stud length table on page 379

#### Shielded – Self-Clinching

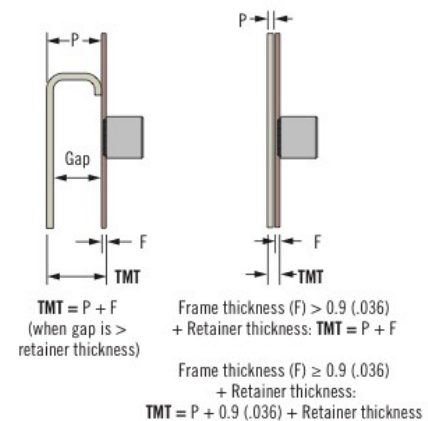
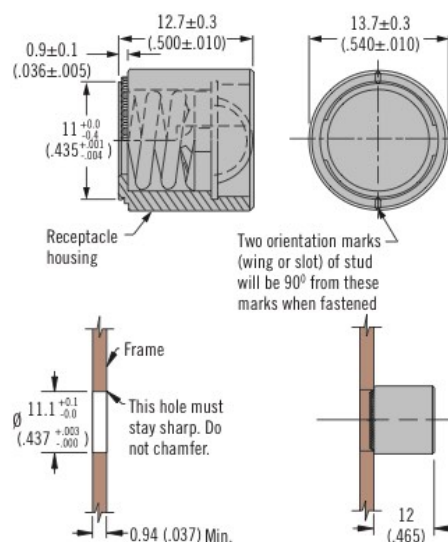

Part Number	Stud Selection Column
82-35-315-55	C

INFO CLIC [www.southco.com/82](http://www.southco.com/82)

Dimensions in millimeters (inch) unless otherwise stated

DZUS® southco®  
CONNECT · CREATE · INNOVATE

# 82 DZUS® Lion Quarter-Turn Fasteners

## Retainers · Accessories



385

### Retainer Push-On

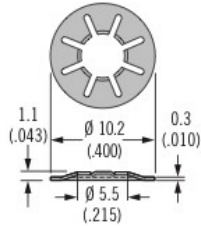

### Retainer Push-On Plastic

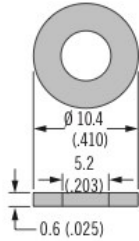

### Retainer Split

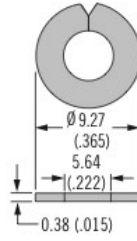

### Sealing Washer

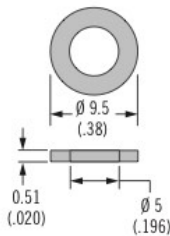

### Ejector Spring

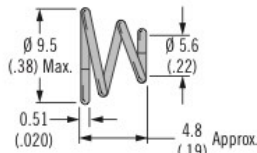

### Cupped Washer

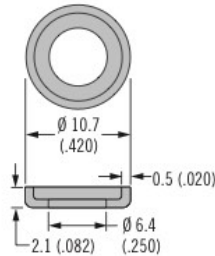

### Flat Wear Washer

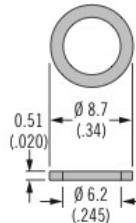

### Snap-In Retainer

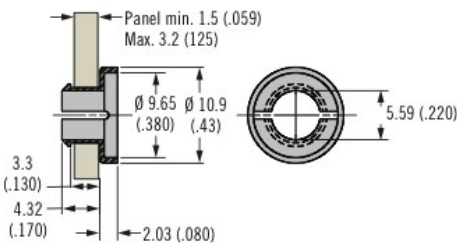

### Material and Finish

See table

### Installation Notes

For standard retainers:

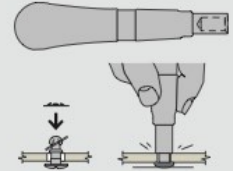

Part Number: 82-0-22542-11

For split retainers:



Part Number: 82-0-7595-11

### Notes

For snap-in retainer:  
Min. stud **K** = 180 when using snap-in retainer (see page 379 for **K** reference).

Install stud into retainer before inserting into panel

Type	Part Number	Material	Adjustment Value
Push-on retainer	82-32-201-20	Stainless steel	Add 0.25 (.010)
Push-on plastic retainer	82-32-301-12	Nylon, black	Add 0.64 (.025)
Split retainer	82-32-101-20	Stainless steel	Add 0.38 (.015)
Sealing washer	82-43-201-38	Neoprene nitrile rubber, black	Add 0.51 (.020)
Ejector spring	43-13-1-24	Stainless steel	Add 0.51 (.020)
Cupped washer	82-46-101-39	Nylon, white	Add 0.51 (.020)
	82-46-101-41	Nylon, black	
Flat wear washer	82-46-103-39	Nylon, white	Add 0.51 (.020)
Snap-in retainer	82-32-401-41	Nylon, black	Add 0.51 (.020)

**DZUS®** southco®  
CONNECT · CREATE · INNOVATE

Dimensions in millimeters (inch) unless otherwise stated



[www.southco.com/82](http://www.southco.com/82)

82

85

D8

D1

D4

D5

D7

NY





## 85 DZUS® Lion Quarter-Turn Fasteners Studs

### Material and Finish

Studs: Steel, zinc plated  
or stainless steel  
Bail cover: ABS, black

82

85

### Accessories

Tool head recess key:  
Part number: 29-90-215-10

D8

D1

D4

D5

D7

NY

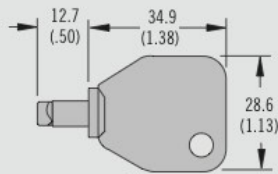

### H Head Styles - Tool Actuated

#### Oval Slot

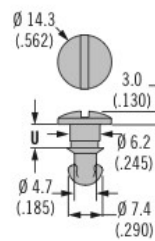

#### Hex Recess

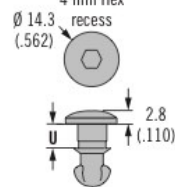

#### Phillips Recess

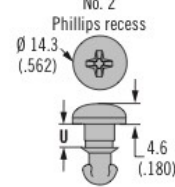

#### Tool Head Recess

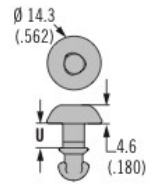

ACTUAL SIZE

### H Head Styles - Hand Actuated

#### Wing

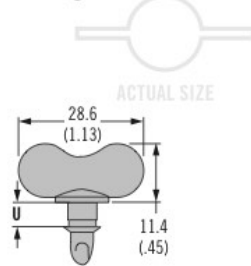

ACTUAL SIZE

#### Bail Style RA

For use when  
receptacle is horizontal

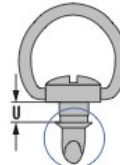

#### Bail Style RB

For use when  
receptacle is vertical

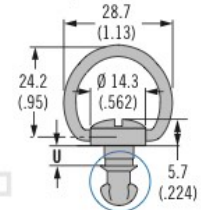

ACTUAL SIZE

### Installation Notes

Bail cover:

A wear washer must be fitted under  
the stud head to fit flush with  
surface

Wear washer part number  
85-34-301-12 (see page 391)

### Optional Bail Cover

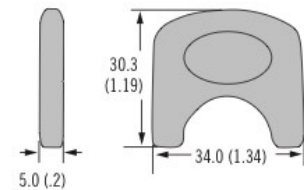

#### Bail Cover Part Number

85-5-B-000

### Stud Panel Preparation

Prepare Hole

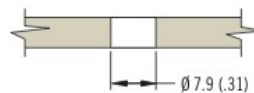

Dimensions in millimeters (inch) unless otherwise stated



[www.southco.com/85](http://www.southco.com/85)

**DZUS®** | **southco®**  
CONNECT · CREATE · INNOVATE

# 85 DZUS® Lion Quarter-Turn Fasteners

## Stud selection

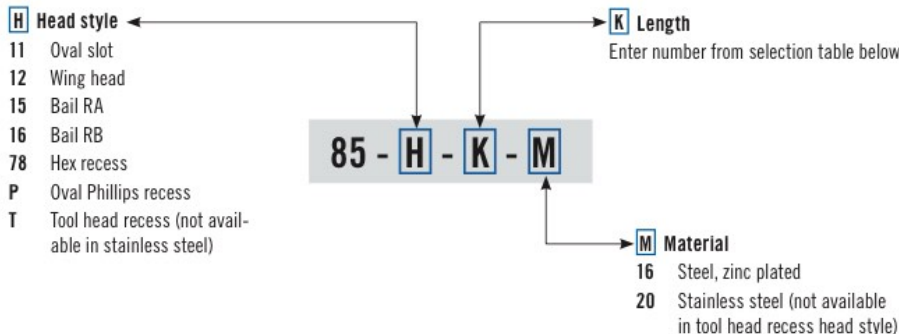

Stud Length Table							
A		B		C		K	U
TMT Range For: 85-35-308-55		TMT Range For: 85-35-311-55		TMT Range For: All other receptacles			
Min.	Max.	Min.	Max.	Min.	Max.		
~	~	~	~	2.3 (.090)	2.8 (.110)	100	5.2 (.205)
~	~	~	~	2.8 (.110)	3.3 (.130)	120	5.7 (.225)
~	~	~	~	3.3 (.130)	3.8 (.150)	140	6.2 (.245)
~	~	~	~	3.8 (.150)	4.3 (.170)	160	6.7 (.265)
~	~	~	~	4.3 (.170)	4.8 (.190)	180	7.2 (.285)
~	~	~	~	4.8 (.190)	5.3 (.210)	200	7.7 (.305)
~	~	~	~	5.3 (.210)	5.8 (.230)	220	8.3 (.325)
~	~	1.3 (.050)	1.8 (.070)	5.8 (.230)	6.3 (.250)	240	8.8 (.345)
0.4 (.015)	0.9 (.035)	1.8 (.070)	2.3 (.090)	6.4 (.250)	6.9 (.270)	260	9.3 (.365)
0.9 (.035)	1.4 (.055)	2.3 (.090)	2.8 (.110)	6.9 (.270)	7.4 (.290)	280	9.8 (.385)
1.4 (.055)	1.9 (.075)	2.8 (.110)	3.3 (.130)	7.4 (.290)	7.9 (.310)	300	10.3 (.405)
1.9 (.075)	2.4 (.095)	3.3 (.130)	3.8 (.150)	7.9 (.310)	8.4 (.330)	320	10.8 (.425)
2.4 (.095)	2.9 (.115)	3.8 (.150)	4.3 (.170)	8.4 (.330)	8.9 (.350)	340	11.3 (.445)
2.9 (.115)	3.4 (.135)	4.3 (.170)	4.8 (.190)	8.9 (.350)	9.4 (.370)	360	11.8 (.465)
3.4 (.135)	3.9 (.155)	4.8 (.190)	5.3 (.210)	9.4 (.370)	9.9 (.390)	380	12.3 (.485)
3.9 (.155)	4.4 (.175)	5.3 (.210)	5.8 (.230)	9.9 (.390)	10.4 (.410)	400	12.8 (.505)
4.4 (.175)	4.9 (.195)	5.8 (.230)	6.3 (.250)	10.4 (.410)	10.9 (.430)	420	13.3 (.525)
5 (.195)	5.5 (.215)	6.4 (.250)	6.9 (.270)	10.9 (.430)	11.4 (.450)	440	13.8 (.545)
5.5 (.215)	6 (.235)	6.9 (.270)	7.4 (.290)	11.4 (.450)	11.9 (.470)	460	14.4 (.565)
6 (.235)	6.5 (.255)	7.4 (.290)	7.9 (.310)	11.9 (.470)	12.4 (.490)	480	14.9 (.585)
6.5 (.255)	7 (.275)	7.9 (.310)	8.4 (.330)	12.5 (.490)	12.9 (.510)	500	15.4 (.605)
7 (.275)	7.5 (.295)	8.4 (.330)	8.9 (.350)	13 (.510)	13.5 (.530)	520	15.9 (.625)
7.5 (.295)	8 (.315)	8.9 (.350)	9.4 (.370)	13.5 (.530)	14 (.550)	540	16.4 (.645)
8 (.315)	8.5 (.335)	9.4 (.370)	9.9 (.390)	14 (.550)	14.5 (.570)	560	16.9 (.665)
8.5 (.335)	9 (.355)	9.9 (.390)	10.4 (.410)	14.5 (.570)	15 (.590)	580	17.4 (.685)

### Part Number Selection

82

85

D8

D1

D4

D5

D7

NY



### To select correct fastener:

#### 1. Select receptacle

Choose a receptacle from page 388-390

#### 2. Select retainer and accessories

from page 391 and note any adjustment values

#### 3. Specify stud length

Calculate the total material thickness (TMT) using the formula given for the receptacle selected. Find the range of TMT using the stud length selection table (left) using the column (A, B or C) given for the receptacle selected, find **K**

#### 4. Complete the stud part number

by specifying the head style **H**, stud length **K**, and material **M**

#### Example:

For rivet-on with base receptacle 85-35-295-15 use column C

For TMT value calculated as 5.2 (.206), K = 200

For slotted head style in steel material, completed part number: 85-11-200-16

A complete example can be found on page 377

#### Notes

Stainless steel material may require a higher minimum order quantity. Contact Southco for details.







## 85 DZUS® Lion Quarter-Turn Fasteners Receptacles

### Material and Finish

Steel, zinc immersion coating or stainless steel

82

85

D8

D1

D4

D5

D7

NY

### Part Number

See table

### Notes

Utilize stud selection column indicated when choosing a stud length from the stud length table on page 387

### Clip-On

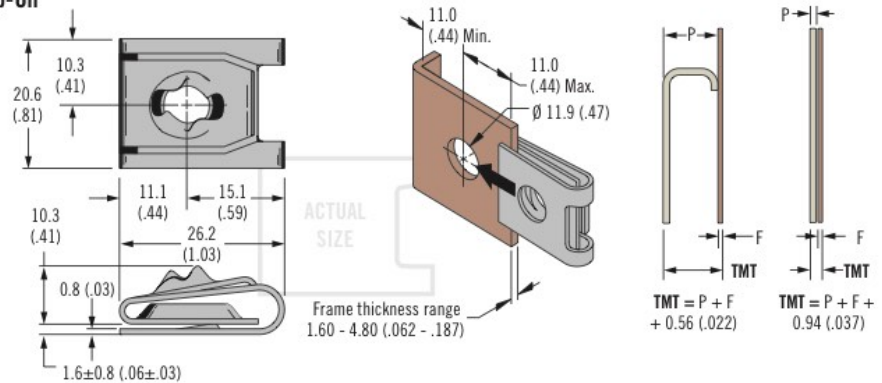

### By Hand



### With Screwdriver



Material	Part Number	Stud Selection Column
Steel	85-47-101-15	C
Stainless steel	85-47-101-20	

### Material and Finish

Steel, zinc plated and stainless steel

### Installation Tool

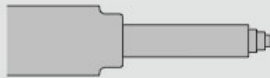

Part Number: 29-8125-309

### Part Number

See table

### Notes

Utilize stud selection column indicated when choosing a stud length from the stud length table on page 387

### Snap-In – Front Mount

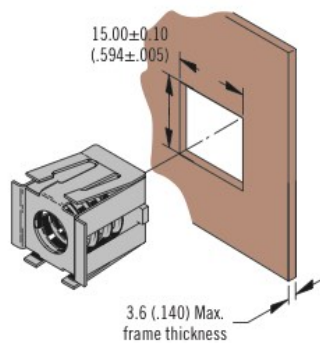
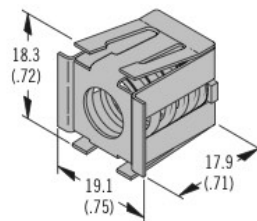

ACTUAL SIZE

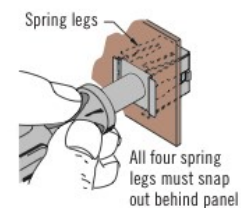
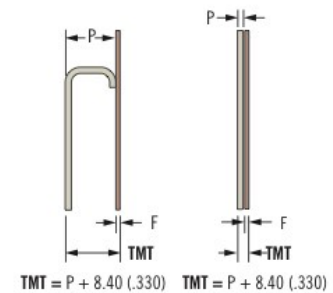

Part Number	Stud Selection Column
85-35-309-56	C

INFO CLIC [www.southco.com/85](http://www.southco.com/85)

Dimensions in millimeters (inch) unless otherwise stated

DZUS® southco®  
CONNECT · CREATE · INNOVATE

# 85 DZUS® Lion Quarter-Turn Fasteners Receptacles



389

## Press-In

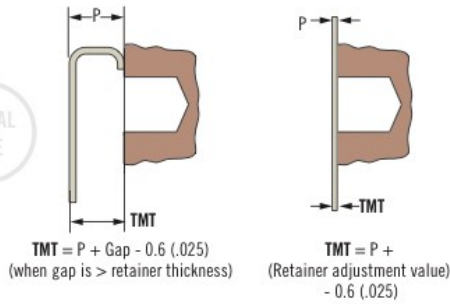
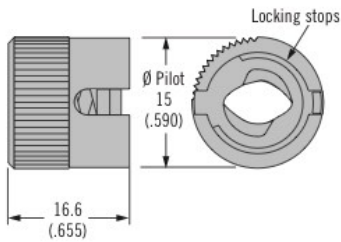

## Solid Install

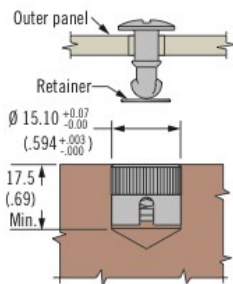

## Blind Install

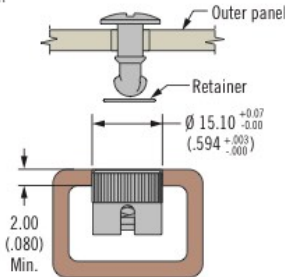

Part Number	Stud Selection Column
85-35-308-55	A

## Material and Finish

Steel, zinc plated and stainless steel

## Installation Notes

Press receptacle flush to frame

## Notes

Receptacle shown installed flush to the frame. To eliminate the gap between the frame and outer panel, install to a depth  $\geq$  the thickness of the selected retainer. This depth should be added to the TMT.

## Part Number

See table

## Notes

Utilize stud selection column indicated when choosing a stud length from the stud length table on page 387

## Shielded – Self-Clinching

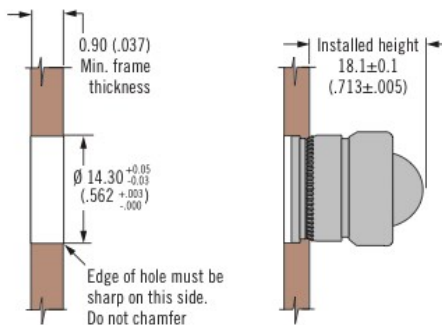
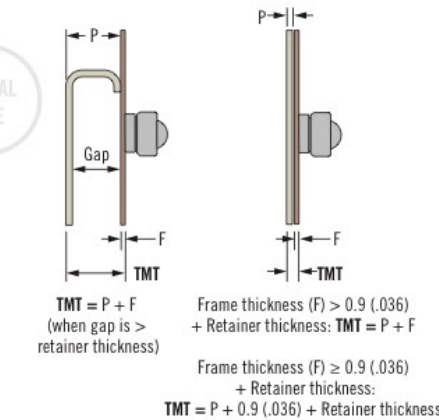
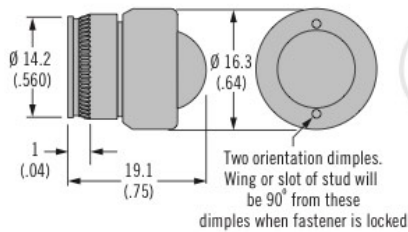

Part Number	Stud Selection Column
85-35-311-55	B

## Material and Finish

Steel, zinc plated and stainless steel

## Installation Notes

For use in low carbon steels, aluminum and stainless steels in the annealed condition that are R<sub>85</sub> or softer.

See page 543 for installation guidelines

## Installation Tool



Part number: 90-2825-11

## Part Number

See table

## Notes

Utilize stud selection column indicated when choosing a stud length from the stud length table on page 387



## 85 DZUS® Lion Quarter-Turn Fasteners Receptacles

### Material and Finish

Steel, zinc immersion coating or stainless steel

82

### Installation Notes

Install with  $\phi 3$  (.125) rivets, spring must float freely after riveting

85

D8

D1

### Part Number

See table

D4

### Notes

Utilize stud selection column indicated when choosing a stud length from the stud length table on page 387

D5

D7

NY

### Rivet-On With Base

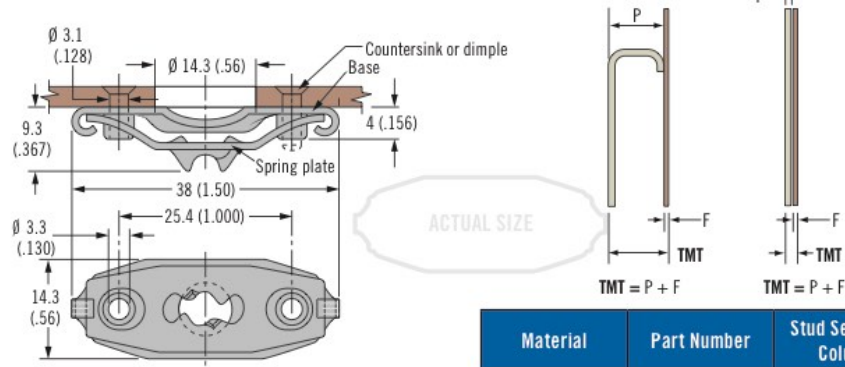

Material	Part Number	Stud Selection Column
Steel	85-35-295-15	C
Stainless steel	85-35-295-20	

### Material and Finish

Steel, zinc immersion coating

### Installation Notes

Spring must float freely after welding

### Part Number

See table

### Notes

Utilize stud selection column indicated when choosing a stud length from the stud length table on page 387

### Weld-On

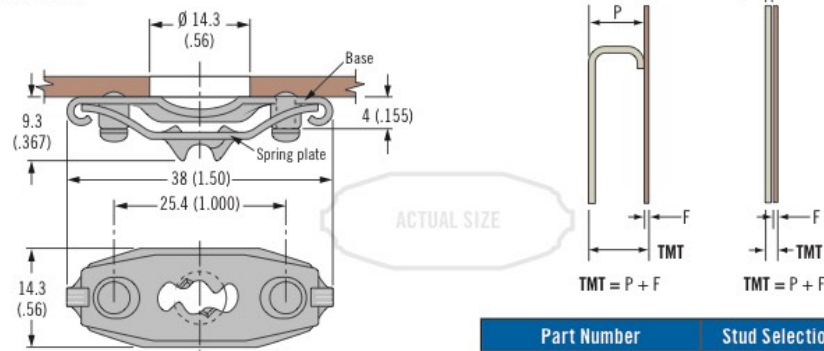

Part Number	Stud Selection Column
85-35-296-15	C

### Material and Finish

Steel, zinc immersion coating

### Part Number

See table

### Notes

Utilize stud selection column indicated when choosing a stud length from the stud length table on page 387

### Side Mount

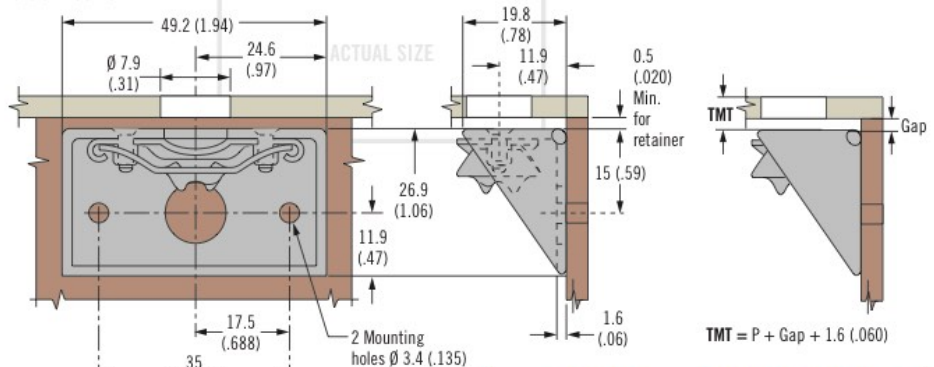

Part Number	Stud Selection Column
85-45-101-15	C

INFO CLIC [www.southco.com/85](http://www.southco.com/85)

Dimensions in millimeters (inch) unless otherwise stated

DZUS® southco®  
CONNECT · CREATE · INNOVATE

# 85 DZUS® Lion Quarter-Turn Fasteners

## Retainers · Accessories



391

### Retainers

Push-On - Stainless Steel

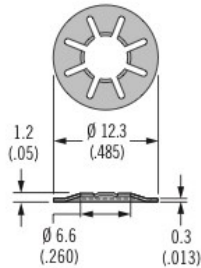

Push-On - Plastic

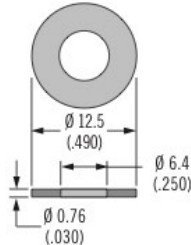

Push-On - Neoprene

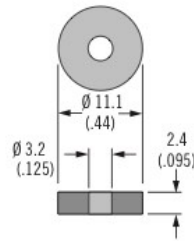

Sealing Washer

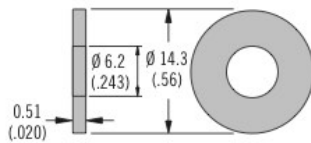

Ejector Spring

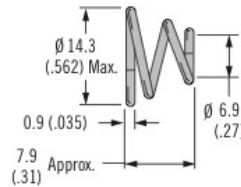

Cupped Washer

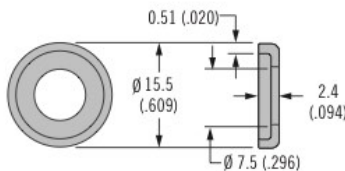

Flat Wear Washer

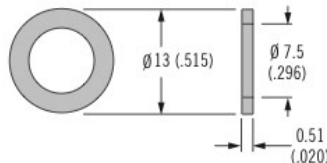

Type	Part Number	Material	Adjustment Value
Push-on - Stainless steel	85-34-201-20	Stainless steel	Add 0.33 (.013)
Push-on - Plastic	85-34-301-12	Nylon, black	Add 0.76 (.030)
Push-on - Neoprene	85-33-101-27	Neoprene, black	Add 1.22 (.048)
Sealing washer	85-43-201-38	Neoprene nitrile rubber, black	Add 0.51 (.020)
Ejector spring	14-18-150-24	Stainless steel	Add 1.00 (.039)
Cupped washer	85-46-101-39	Nylon, white	Add 0.51 (.020)
	85-46-101-41	Nylon, black	
Flat wear washer	85-46-103-39	Nylon, white	Add 0.51 (.020)

**DZUS®** southco®  
CONNECT · CREATE · INNOVATE

Dimensions in millimeters (inch) unless otherwise stated

### Material and Finish

See table

### Installation Notes

For standard retainers use tool



Part number 85-0-22543-11

82

85

D8

D1

D4

D5

D7

NY



### Part Number

See table

### Adjustment value:

When using accessories the components add thickness

Add the adjustment value to your outer panel thickness (P) when calculating TMT (see page 377 for example)



[www.southco.com/85](http://www.southco.com/85)



# D8 DZUS® PANEX Quarter-Turn Fasteners

## Studs · Size 4

### Material and Finish

Studs: Steel, zinc plated plus chromate or chrome plated  
 Bail cover: ABS, black

82

85

D8

D1

D4

D5

D7

NY



### H Head Styles - Tool Actuated

Oval Slot

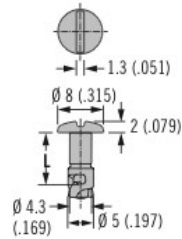

Hex Recess

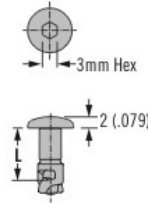

Phillips Recess

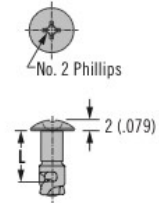

### H Head Styles - Hand Actuated

Wing

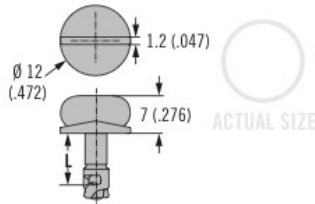

Bail

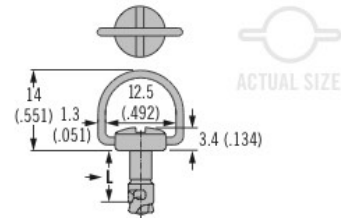

### Installation Notes

Bail cover:  
 A Retainer must be fitted under the stud head to fit flush with surface  
 Retainer part number  
 D8-324-100-040 (see page 397)

### Optional Bail Cover

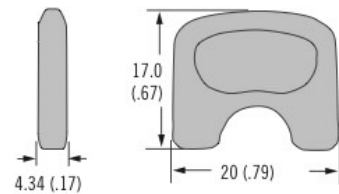

Bail Cover Part Number
D8-4-B-000

### Stud Panel Preparation

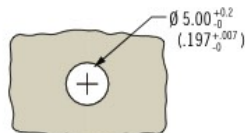

Dimensions in millimeters (inch) unless otherwise stated



[www.southco.com/D8](http://www.southco.com/D8)

# D8 DZUS® PANEX Quarter-Turn Fasteners

## Stud selection · Size 4



### Part Number Selection

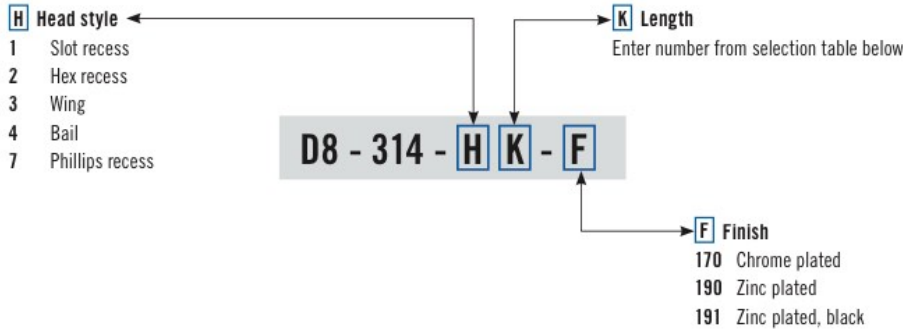

Stud Length Table											K	L ±.15 ±(.006)
A		B		C		D		E				
Min.	Max.	Min.	Max.	Min.	Max.	Min.	Max.	Min.	Max.			
TMT Range For: D8-334-400-121 D8-334-500-121		TMT Range For: D8-334-300-121 D8-334-310-121		TMT Range For: D8-334-200-190		TMT Range For: D8-334-100-300		TMT Range For: D8-334-110-190				
1.0 (.04)	1.9 (.07)	1.5 (.06)	2.4 (.09)	~	~	~	~	~	~	08	8 (.315)	
2.0 (.08)	2.9 (.11)	2.5 (.10)	3.4 (.13)	~	~	~	~	~	~	09	9 (.354)	
3.0 (.12)	3.9 (.15)	3.5 (.14)	4.4 (.17)	~	~	0.7 (.03)	1.6 (.06)	1.7 (.07)	2.6 (.10)	10	10 (.394)	
4.0 (.16)	4.9 (.19)	4.5 (.18)	5.4 (.21)	~	~	1.7 (.07)	2.6 (.10)	2.7 (.11)	3.6 (.14)	11	11 (.433)	
5.0 (.20)	5.9 (.23)	5.5 (.22)	6.4 (.25)	1.5 (.06)	2.4 (.09)	2.7 (.11)	3.6 (.14)	3.7 (.15)	4.6 (.18)	12	12 (.472)	
6.0 (.24)	6.9 (.27)	6.5 (.26)	7.4 (.29)	2.5 (.10)	3.4 (.13)	3.7 (.15)	4.6 (.18)	4.7 (.19)	5.6 (.22)	13	13 (.512)	
7.0 (.28)	7.9 (.31)	7.5 (.30)	8.4 (.33)	3.5 (.14)	4.4 (.17)	4.7 (.19)	5.6 (.22)	5.7 (.22)	6.6 (.26)	14	14 (.551)	
8.0 (.31)	8.9 (.35)	8.5 (.33)	9.4 (.37)	4.5 (.18)	5.4 (.21)	5.7 (.22)	6.6 (.26)	6.7 (.26)	7.6 (.30)	15	15 (.591)	
9.0 (.35)	9.9 (.39)	9.5 (.37)	10.4 (.41)	5.5 (.22)	6.4 (.25)	6.7 (.26)	7.6 (.30)	7.7 (.30)	8.6 (.34)	16	16 (.630)	
10.0 (.39)	10.9 (.43)	10.5 (.41)	11.4 (.45)	6.5 (.26)	7.4 (.29)	7.7 (.30)	8.6 (.34)	8.7 (.34)	9.6 (.38)	17	17 (.669)	
11.0 (.43)	11.9 (.47)	11.5 (.45)	12.4 (.49)	7.5 (.30)	8.4 (.33)	8.7 (.34)	9.6 (.38)	9.7 (.38)	10.6 (.42)	18	18 (.709)	
12.0 (.47)	12.9 (.51)	12.5 (.49)	13.4 (.53)	8.5 (.33)	9.4 (.37)	9.7 (.38)	10.6 (.42)	10.7 (.42)	11.6 (.46)	19	19 (.748)	
13.0 (.51)	13.9 (.55)	13.5 (.53)	14.4 (.57)	9.5 (.37)	10.4 (.41)	10.7 (.42)	11.6 (.46)	11.7 (.46)	12.6 (.50)	20	20 (.787)	
14.0 (.55)	14.9 (.59)	14.5 (.57)	15.4 (.61)	10.5 (.41)	11.4 (.45)	11.7 (.46)	12.6 (.50)	12.7 (.50)	13.6 (.54)	21	21 (.827)	
15.0 (.59)	15.9 (.63)	15.5 (.61)	16.4 (.65)	11.5 (.45)	12.4 (.49)	12.7 (.50)	13.6 (.54)	13.7 (.54)	14.6 (.57)	22	22 (.866)	
16.0 (.63)	16.9 (.67)	16.5 (.65)	17.4 (.69)	12.5 (.49)	13.4 (.53)	13.7 (.54)	14.6 (.57)	14.7 (.58)	15.6 (.61)	23	23 (.906)	
17.0 (.67)	17.9 (.70)	17.5 (.69)	18.4 (.72)	13.5 (.53)	14.4 (.57)	14.7 (.58)	15.6 (.61)	15.7 (.62)	16.6 (.65)	24	24 (.945)	
18.0 (.71)	18.9 (.74)	18.5 (.73)	19.4 (.76)	14.5 (.57)	15.4 (.61)	15.7 (.62)	16.6 (.65)	16.7 (.66)	17.6 (.69)	25	25 (.984)	
19.0 (.75)	19.9 (.78)	19.5 (.77)	20.4 (.80)	15.5 (.61)	16.4 (.65)	16.7 (.66)	17.6 (.69)	17.7 (.70)	18.6 (.73)	26	26 (1.02)	
20.0 (.79)	20.9 (.82)	20.5 (.81)	21.4 (.84)	16.5 (.65)	17.4 (.69)	17.7 (.70)	18.6 (.73)	18.7 (.74)	19.6 (.77)	27	27 (1.06)	
21.0 (.83)	21.9 (.86)	21.5 (.85)	22.4 (.88)	17.5 (.69)	18.4 (.72)	18.7 (.74)	19.6 (.77)	19.7 (.78)	20.6 (.81)	28	28 (1.10)	
22.0 (.87)	22.9 (.90)	22.5 (.89)	23.4 (.92)	18.5 (.73)	19.4 (.76)	19.7 (.78)	20.6 (.81)	20.7 (.81)	21.6 (.85)	29	29 (1.14)	
23.0 (.91)	23.9 (.94)	23.5 (.93)	24.4 (.96)	19.5 (.77)	20.4 (.80)	20.7 (.81)	21.6 (.85)	21.7 (.85)	22.6 (.89)	30	30 (1.18)	

### To select correct fastener:

#### 1. Select receptacle

Choose a receptacle from pages 394-396

#### 2. Select retainer and accessories

from page 397 and note any adjustment values

#### 3. Specify stud length

Calculate the total material thickness (TMT) using the formula given for the receptacle selected. Find the range of TMT using the length selection table (left) using the column (A, B, C, D or E) given for the receptacle selected.

#### 4. Complete the stud part number

by specifying the head style **H**, stud length **K**, and material **M**

#### Example:

For rivet-on

D8-334-400-121 use column A  
For TMT value calculated as 5.2 (.206), K = 12

For slotted head style in steel, zinc plated material, completed part number: D8-314-112-190

A complete example can be found on page 377.





## D8 DZUS® PANEX Quarter-Turn Fasteners Receptacles · Size 4

### Material and Finish

Steel, zinc immersion coating

82

### Installation Notes

85

Install with  $\varnothing 3$  (.125) rivets

D8

### Part Number

D1

See table

D4

### Notes

D5

Utilize stud selection column indicated when choosing a stud length from the stud length table on page 393

D7

NY

### Rivet-On

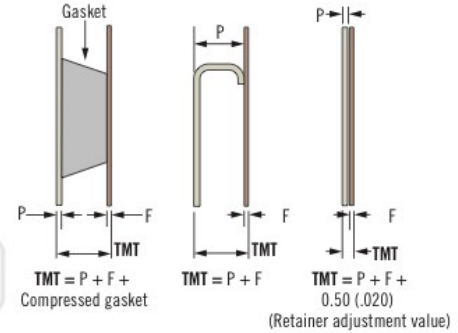
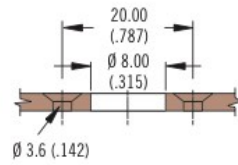
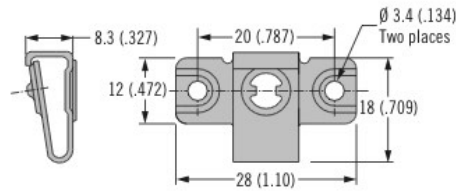

Part Number	Stud Selection Column
D8-334-400-121	A

### Material and Finish

Steel, zinc immersion coating

### Part Number

See table

### Notes

Utilize stud selection column indicated when choosing a stud length from the stud length table on page 393

### Weld-On

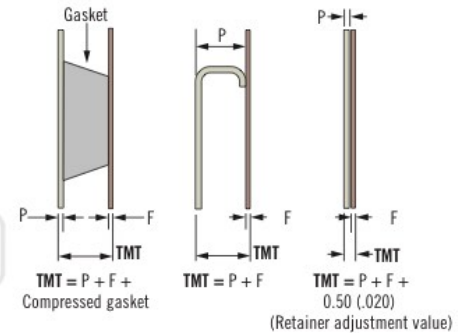
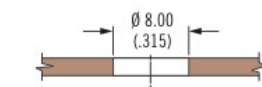
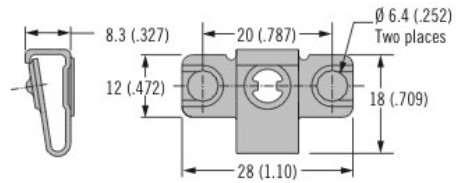

Part Number	Stud Selection Column
D8-334-500-121	A

### Material and Finish

Steel, zinc immersion coating

### Part Number

See table

### Notes

Utilize stud selection column indicated when choosing a stud length from the stud length table on page 393

### Side Mount

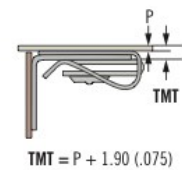
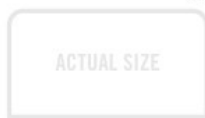
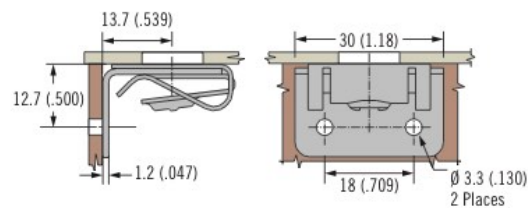

Part Number	Stud Selection Column
D8-334-310-121	B



[www.southco.com/D8](http://www.southco.com/D8)

Dimensions in millimeters (inch) unless otherwise stated

**DZUS®** **southco®**  
CONNECT · CREATE · INNOVATE

# D8 DZUS® PANEX Quarter-Turn Fasteners

## Receptacles · Size 4



395

### Clip-On

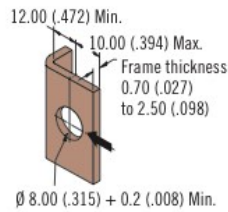
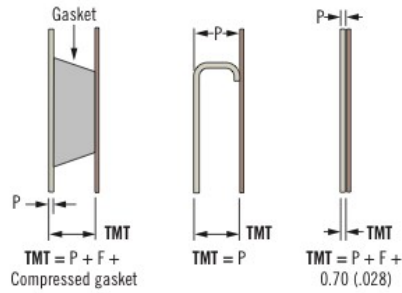
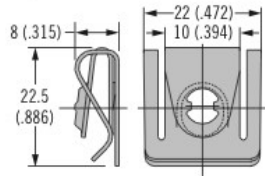

Part Number	Stud Selection Column
D8-334-300-121	B

### Material and Finish

Steel, zinc immersion coating

82

85

D8

D1

D4

D5

D7

NY

### Part Number

See table

### Notes

Utilize stud selection column indicated when choosing a stud length from the stud length table on page 393

### Front Mount

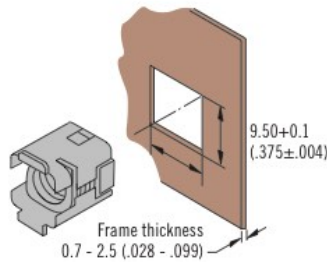
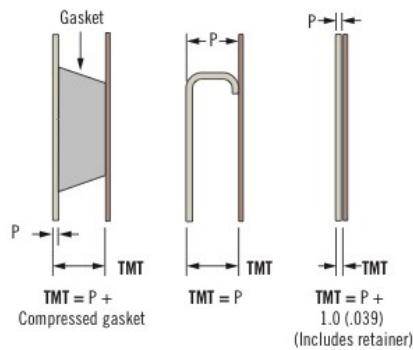
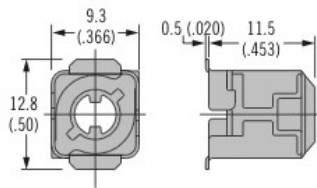

### Installation

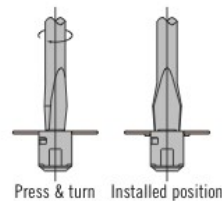

Part Number	Stud Selection Column
D8-334-200-190	C

### Material and Finish

Steel, zinc plated and stainless steel

### Part Number

See table

### Notes

Utilize stud selection column indicated when choosing a stud length from the stud length table on page 393





# D8 DZUS® PANEX Quarter-Turn Fasteners

## Receptacles · Size 4

### Material and Finish

Brass and steel, zinc plated

### 82 Installation Notes

Press receptacle flush to frame

### 85 Notes

**D8** Receptacle shown installed flush to the frame. To eliminate the gap between the frame and outer panel, install to a depth  $\geq$  the thickness of the selected retainer. This depth should be added to the TMT.

D1

D4

D5

D7

NY



### Part Number

See table

### Notes

Utilize stud selection column indicated when choosing a stud length from the stud length table on page 393

### Material and Finish

Steel, zinc plated

### Notes

For use in low carbon steels, aluminum and stainless steels in the annealed condition that are RB85 or softer

See page 543 for installation guidelines

### Part Number

See table

### Notes

Utilize stud selection column indicated when choosing a stud length from the stud length table on page 393



[www.southco.com/D8](http://www.southco.com/D8)

### Press-In - Front Mount

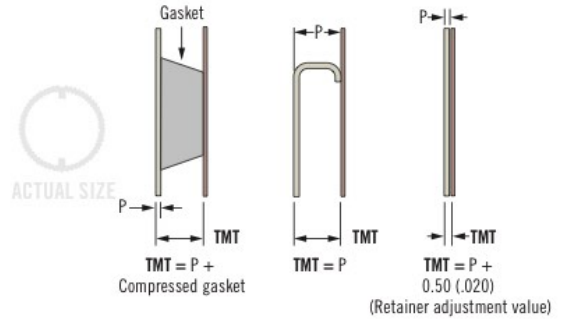
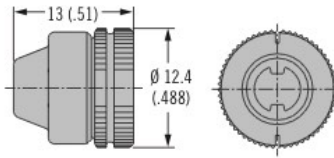

### Solid Install

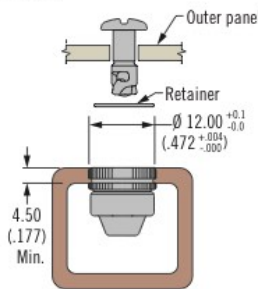

### Blind Install

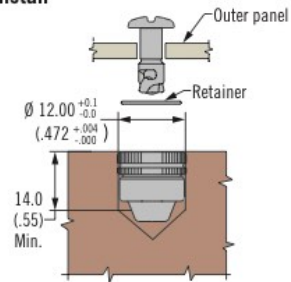

Part Number	Stud Selection Column
D8-334-100-300	D

### Press-In - Self-Clinching

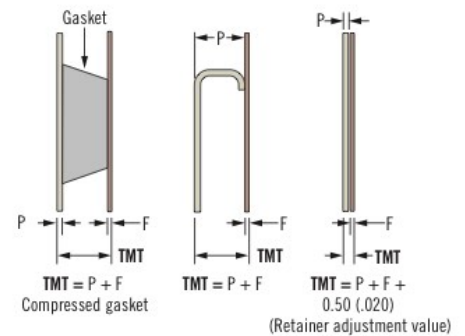
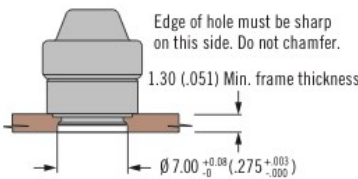
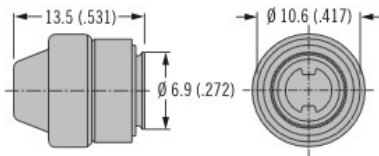

Part Number	Stud Selection Column
D8-334-110-190	E

Dimensions in millimeters (inch) unless otherwise stated



# D8 DZUS® PANEX Quarter-Turn Fasteners

## Retainers · Accessories · Size 4



397

### Retainer Push-On

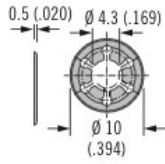

### Retainer Push-On Plastic

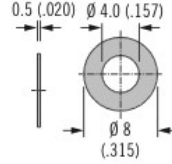

Type	Part Number	Material	Adjustment Value
Push-on plastic	D8-324-100-040	High density polyethylene, black	Included in TMT calculation
Push-on	D8-324-101-200	Stainless steel	

### Material and Finish

See table

82

85

**D8**

D1

D4

D5

D7

NY



### Part Number

See table

### Retainer Spring (Must be secured with steel retainer)

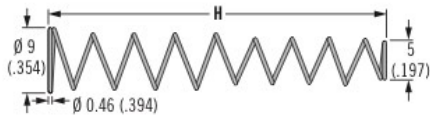

### With Retaining Spring

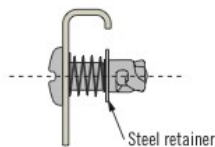

### Without Retaining Spring

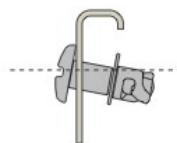

Part Number	H	X Min.	X Max.
D8-324-200-200	48 (1.89)	14 (.551)	44 (1.73)
D8-324-201-200	20 (.787)	5 (.197)	16 (.630)

**DZUS®** | **southco®**  
CONNECT · CREATE · INNOVATE

Dimensions in millimeters (inch) unless otherwise stated



[www.southco.com/D8](http://www.southco.com/D8)



# D8 DZUS® PANEX Quarter-Turn Fasteners

## Studs · Size 6

### Material and Finish

Studs: Steel, zinc plated and chromate or chrome plated or stainless steel  
 Key: Steel with zinc plate and chromate

Bail cover: ABS, black

### Accessories

Tamper resistant stud key:  
 Part number: D8-316-007-969



### Installation Notes

Bail cover: A Retainer must be fitted under the stud head to fit flush with surface

Retainer part number D8-326-100-040 (see page 403)

### H Head Styles - Tool Actuated

#### Oval Slot

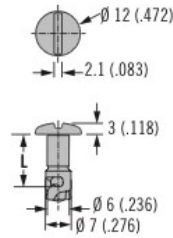

#### Hex Recess

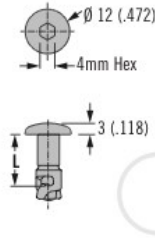

#### Phillips Recess

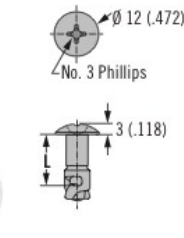

#### Tamper Resistant

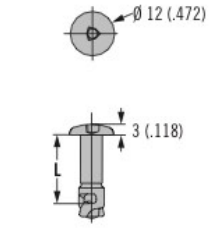

ACTUAL SIZE

### H Head Styles - Hand Actuated

#### Wing

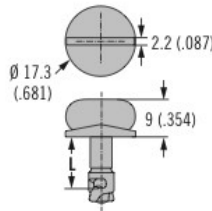

ACTUAL SIZE

#### Bail

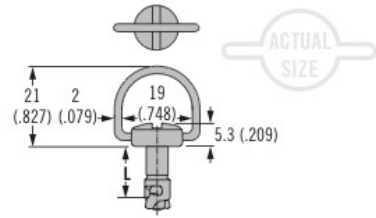

ACTUAL SIZE

### Optional Bail Cover

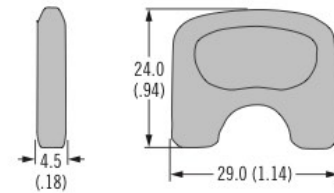

#### Bail Cover Part Number

D8-6-B-000

### Stud Panel Preparation

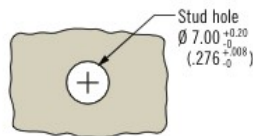

Dimensions in millimeters (inch) unless otherwise stated

# D8 DZUS® PANEX Quarter-Turn Fasteners

## Stud selection · Size 6



### Part Number Selection

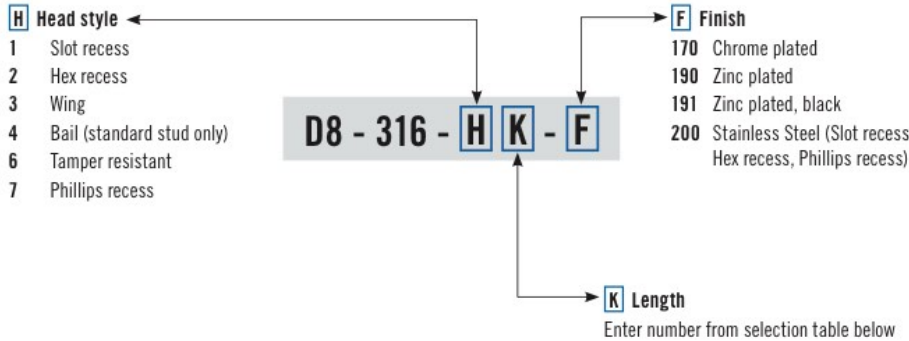

Stud Length Table											
A		B		C		D		E		K	L ±.15 ±(.006)
Min.	Max.	Min.	Max.	Min.	Max.	Min.	Max.	Min.	Max.		
TMT Range For: D8-336-400-121 D8-336-500-121		TMT Range For: D8-336-300-121 D8-336-310-121 D8-336-330-121		TMT Range For: D8-336-200-190		TMT Range For: D8-336-100-300		TMT Range For: D8-336-110-190			
~	~	1.5 (.06)	2.4 (.09)	~	~	~	~	~	~	09	9 (.354)
2.5 (.10)	3.4 (.13)	2.5 (.10)	3.4 (.13)	~	~	~	~	~	~	10	10 (.394)
3.5 (.14)	4.4 (.17)	3.5 (.14)	4.4 (.17)	~	~	~	~	~	~	11	11 (.433)
4.5 (.18)	5.4 (.21)	4.5 (.18)	5.4 (.21)	~	~	0.7 (.03)	1.6 (.06)	1.7 (.07)	2.6 (.10)	12	12 (.472)
5.5 (.22)	6.4 (.25)	5.5 (.22)	6.4 (.25)	~	~	1.7 (.07)	2.6 (.10)	2.7 (.11)	3.6 (.14)	13	13 (.512)
6.5 (.26)	7.4 (.29)	6.5 (.26)	7.4 (.29)	~	~	2.7 (.11)	3.6 (.14)	3.7 (.15)	4.6 (.18)	14	14 (.551)
7.5 (.30)	8.4 (.33)	7.5 (.30)	8.4 (.33)	~	~	3.7 (.15)	4.6 (.18)	4.7 (.19)	5.6 (.22)	15	15 (.591)
8.5 (.33)	9.4 (.37)	8.5 (.33)	9.4 (.37)	0.8 (.03)	1.7 (.07)	4.7 (.19)	5.6 (.22)	5.7 (.22)	6.6 (.26)	16	16 (.630)
9.5 (.37)	10.4 (.41)	9.5 (.37)	10.4 (.41)	1.8 (.07)	2.7 (.11)	5.7 (.22)	6.6 (.26)	6.7 (.26)	7.6 (.30)	17	17 (.669)
10.5 (.41)	11.4 (.45)	10.5 (.41)	11.4 (.45)	2.8 (.11)	3.7 (.15)	6.7 (.26)	7.6 (.30)	7.7 (.30)	8.6 (.34)	18	18 (.709)
11.5 (.45)	12.4 (.49)	11.5 (.45)	12.4 (.49)	3.8 (.15)	4.7 (.19)	7.7 (.30)	8.6 (.34)	8.7 (.34)	9.6 (.38)	19	19 (.748)
12.5 (.49)	13.4 (.53)	12.5 (.49)	13.4 (.53)	4.8 (.19)	5.7 (.22)	8.7 (.34)	9.6 (.38)	9.7 (.38)	10.6 (.42)	20	20 (.787)
13.5 (.53)	14.4 (.57)	13.5 (.53)	14.4 (.57)	5.8 (.23)	6.7 (.26)	9.7 (.38)	10.6 (.42)	10.7 (.42)	11.6 (.46)	21	21 (.827)
14.5 (.57)	15.4 (.61)	14.5 (.57)	15.4 (.61)	6.8 (.27)	7.7 (.30)	10.7 (.42)	11.6 (.46)	11.7 (.46)	12.6 (.50)	22	22 (.866)
15.5 (.61)	16.4 (.65)	15.5 (.61)	16.4 (.65)	7.8 (.31)	8.7 (.34)	11.7 (.46)	12.6 (.50)	12.7 (.50)	13.6 (.54)	23	23 (.906)
16.5 (.65)	17.4 (.69)	16.5 (.65)	17.4 (.69)	8.8 (.35)	9.7 (.38)	12.7 (.50)	13.6 (.54)	13.7 (.54)	14.6 (.57)	24	24 (.945)
17.5 (.69)	18.4 (.72)	17.5 (.69)	18.4 (.72)	9.8 (.39)	10.7 (.42)	13.7 (.54)	14.6 (.57)	14.7 (.58)	15.6 (.61)	25	25 (.984)
18.5 (.73)	19.4 (.76)	18.5 (.73)	19.4 (.76)	10.8 (.43)	11.7 (.46)	14.7 (.58)	15.6 (.61)	15.7 (.62)	16.6 (.65)	26	26 (1.02)
19.5 (.77)	20.4 (.80)	19.5 (.77)	20.4 (.80)	11.8 (.46)	12.7 (.50)	15.7 (.62)	16.6 (.65)	16.7 (.66)	17.6 (.69)	27	27 (1.06)
20.5 (.81)	21.4 (.84)	20.5 (.81)	21.4 (.84)	12.8 (.50)	13.7 (.54)	16.7 (.66)	17.6 (.69)	17.7 (.70)	18.6 (.73)	28	28 (1.10)
21.5 (.85)	22.4 (.88)	21.5 (.85)	22.4 (.88)	13.8 (.54)	14.7 (.58)	17.7 (.70)	18.6 (.73)	18.7 (.74)	19.6 (.77)	29	29 (1.14)
22.5 (.89)	23.4 (.92)	22.5 (.89)	23.4 (.92)	14.8 (.58)	15.7 (.62)	18.7 (.74)	19.6 (.77)	19.7 (.78)	20.6 (.81)	30	30 (1.18)

### To select correct fastener:

#### 1. Select receptacle

Choose a receptacle from pages 400-402

#### 2. Select retainer and accessories

from page 403 and note any adjustment values

#### 3. Specify stud length

Calculate the total material thickness (TMT) using the formula given for the receptacle selected. Find the range of TMT using the stud length selection table (left) using the column (A, B, C, D or E) given for the receptacle selected.

#### 4. Complete the stud part number

by specifying the head style **H**, stud length **K**, and material **M**

#### Example:

For rivet-on

D8-336-400-121 use column A

For TMT value calculated as 5.2 (.206), K = 12

For slotted head style in steel material, completed part number: D8-316-112-190

A complete example can be found on page 377.





## D8 DZUS® PANEX Quarter-Turn Fasteners

### Receptacles · Size 6

#### Material and Finish

Steel, zinc immersion coating or stainless steel

82

#### Installation Notes

Install with  $\varnothing 3$  (.125) rivets

85

D8

#### Part Number

See table

D1

D4

#### Notes

Utilize stud selection column indicated when choosing a stud length from the stud length table on page 399

D5

D7

NY

#### Rivet-On

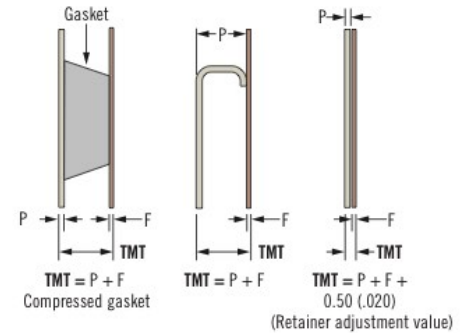
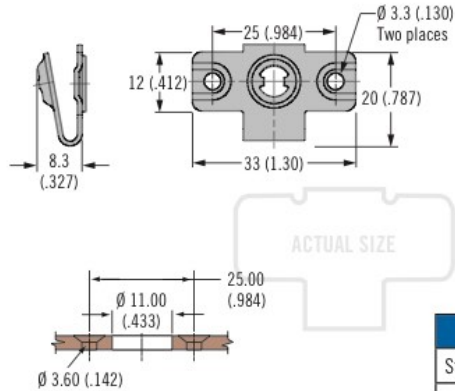

	Part Number	Stud Selection Column
Steel	D8-336-400-121	A
Stainless steel	D8-336-400-200	

#### Material and Finish

Steel, zinc immersion coating

#### Part Number

See table

#### Notes

Utilize stud selection column indicated when choosing a stud length from the stud length table on page 399

#### Weld-On

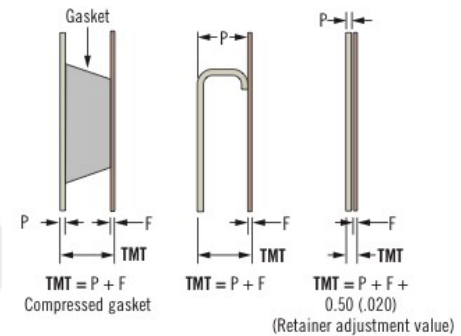
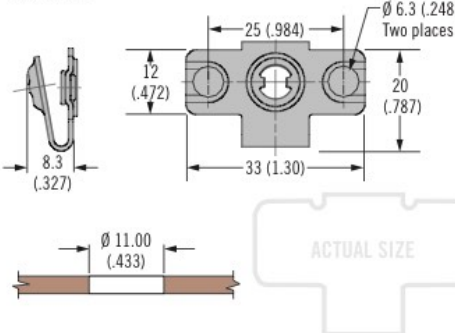

	Part Number	Stud Selection Column
	D8-336-500-121	A

#### Material and Finish

Steel, zinc immersion coating

#### Part Number

See table

#### Notes

Utilize stud selection column indicated when choosing a stud length from the stud length table on page 399

#### Side Mount

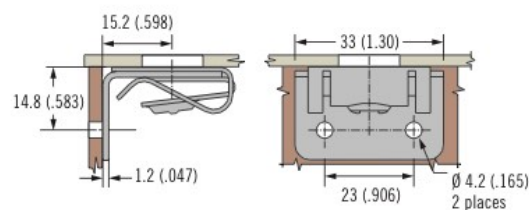

	Part Number	Stud Selection Column
	D8-336-310-121	B

INFO CLIC [www.southco.com/D8](http://www.southco.com/D8)

Dimensions in millimeters (inch) unless otherwise stated

**DZUS®** **southco®**  
CONNECT · CREATE · INNOVATE

# D8 DZUS® PANEX Quarter-Turn Fasteners

## Receptacles · Size 6



401

### Clip-On

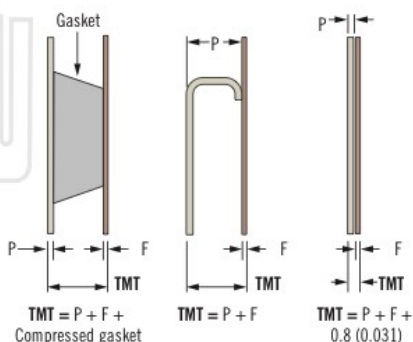
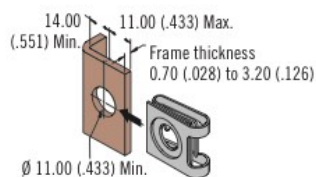
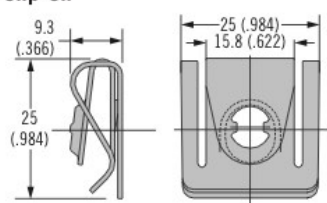

Part Number	Stud Selection Column
D8-336-300-121	B

### Material and Finish

Steel, zinc immersion coating

82

85

D8

### Part Number

See table

D1

D4

### Notes

Utilize stud selection column indicated when choosing a stud length from the stud length table on page 399

D5

D7

NY

### Clip-On - Mini

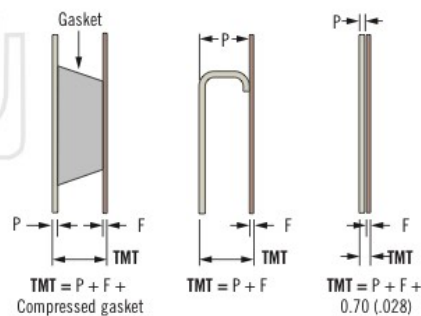
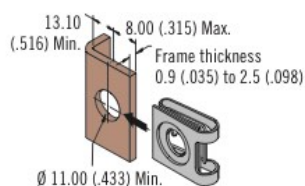
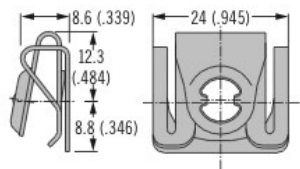

Part Number	Stud Selection Column
Steel D8-336-330-121	B
Stainless steel D8-336-330-200	

### Material and Finish

Steel, zinc immersion coating or stainless steel

### Part Number

See table

### Notes

Utilize stud selection column indicated when choosing a stud length from the stud length table on page 399

### Front Mount

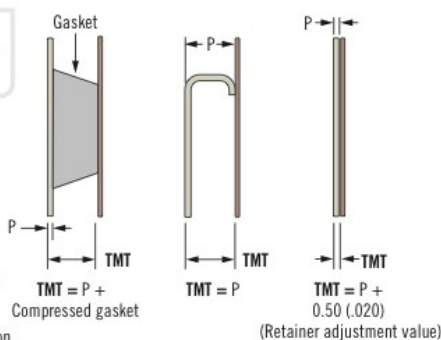
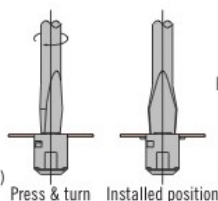
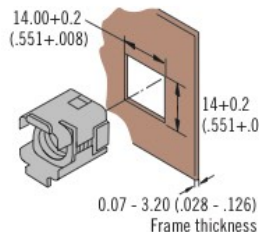
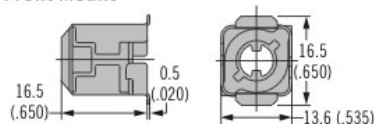

Part Number	Stud Selection Column
D8-336-200-190	C

### Material and Finish

Steel, zinc plated and stainless steel

### Part Number

See table

### Notes

Utilize stud selection column indicated when choosing a stud length from the stud length table on page 399

**DZUS® southco®**  
CONNECT · CREATE · INNOVATE

Dimensions in millimeters (inch) unless otherwise stated



[www.southco.com/D8](http://www.southco.com/D8)



## D8 DZUS® PANEX Quarter-Turn Fasteners Receptacles · Size 6

### Material and Finish

Brass and steel, zinc plated

82

### Installation Notes

85

Press receptacle flush to frame

D8

### Notes

D1

Receptacle shown installed flush to the frame. To eliminate the gap between the frame and outer panel, install to a depth  $\geq$  the thickness of the selected retainer. This depth should be added to the TMT.

D4

D5

D7

NY

### Part Number

See table

### Notes

Utilize stud selection column indicated when choosing a stud length from the stud length table on page 399

### Press-In - Front Mount

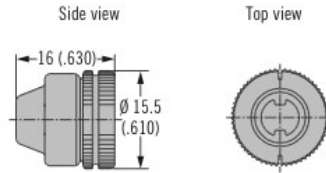

### Solid Install

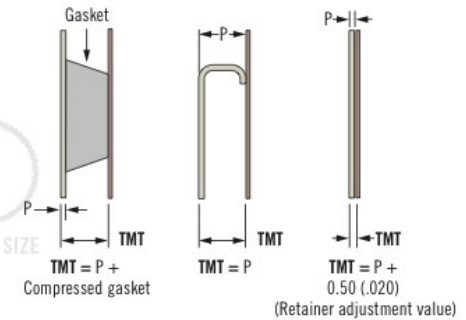
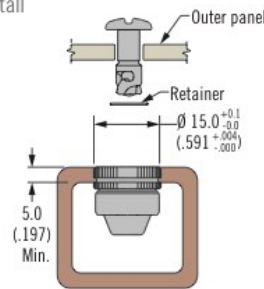

### Blind Install

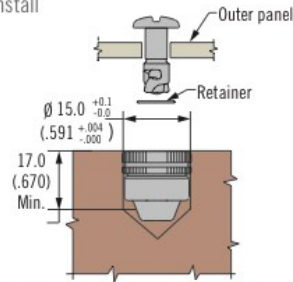

Part Number	Stud Selection Column
D8-336-100-300	D

### Material and Finish

Steel, zinc plated

### Installation Notes

See page 543 for installation guidelines

### Press-In - Self-Clinching

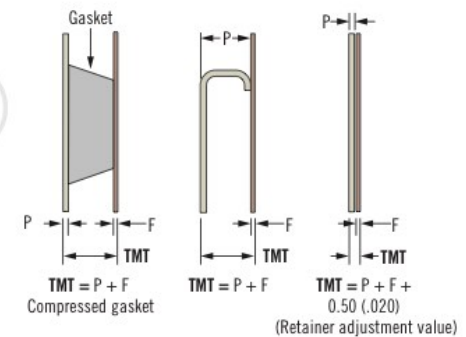
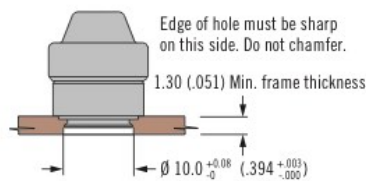
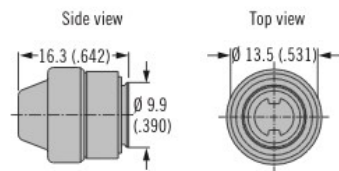

Part Number	Stud Selection Column
D8-336-110-190	E

### Part Number

See table

### Notes

Utilize stud selection column indicated when choosing a stud length from the stud length table on page 399

INFO CLIC [www.southco.com/D8](http://www.southco.com/D8)

Dimensions in millimeters (inch) unless otherwise stated

DZUS® southco®  
CONNECT · CREATE · INNOVATE

# D8 DZUS® PANEX Quarter-Turn Fasteners

## Retainers and Accessories · Size 6



403

### Retainer Push-On, Stainless Steel

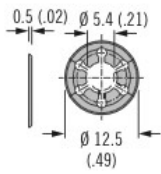

### Retainer Push-On, Plastic

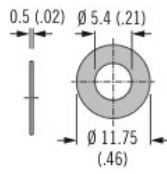

### Cupped Washer

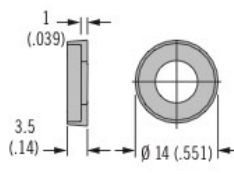

### Ejector Spring

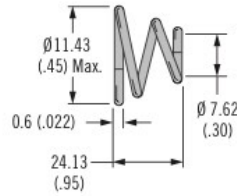

### Ejector Spring and Cup Assembly

(Must be secured with stainless steel retainer)

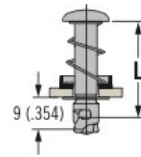

Type	Part Number	Material	Adjustment Value
Push-on plastic	D8-326-100-040	High density polyethylene, black	Included in TMT calculation
Push-on	D8-326-101-200	Stainless steel	
Cupped washer	D8-376-001-049	Thermoplastic, black	Add 1.00 (.039)
Ejector spring	D4-EHF5-3-950QA	Stainless steel	Add 1.00 (.039)

### Material and Finish

See table

### Accessories

When using the ejecting version add 2 (.079) to your TMT

### Notes

Cupped washer only available for tool recess head styles (slot, Phillips, hex, tamper resistant)

Assembly consists of spring, cup and stud ordered separately, shipped bulk

### Part Number

See table

### Retainer Spring (Must be secured with steel retainer)

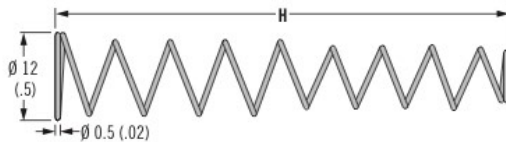

### With Retaining Spring

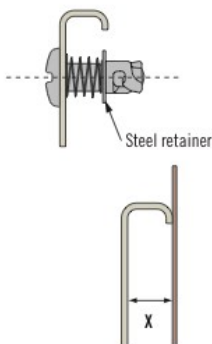

### Without Retaining Spring

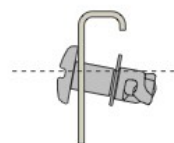

Part Number	H	X Min.	X Max.
D8-326-200-200	48 (1.89)	19 (.75)	44 (1.73)
D8-326-201-200	25 (.98)	5 (.197)	21 (.83)

**DZUS®** southco®  
CONNECT · CREATE · INNOVATE

Dimensions in millimeters (inch) unless otherwise stated



[www.southco.com/D8](http://www.southco.com/D8)

82
85
<b>D8</b>
D1
D4
D5
D7
NY





## D8 DZUS® PANEX Quarter-Turn Fasteners

### Studs · Size 9

#### Material and Finish

Studs: Steel, zinc plated and chromate or chrome plated

82

85

D8

D1

D4

D5

D7

NY



#### H Head Styles - Tool Actuated

##### Oval Slot

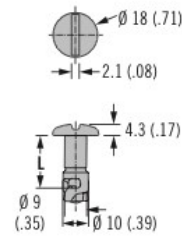
ACTUAL  
SIZE

##### Hex Recess

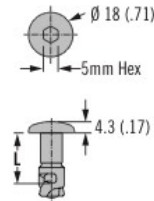

##### Phillips Recess

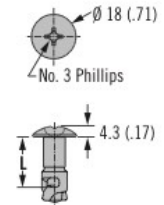

#### H Head Styles - Hand Actuated

##### Wing

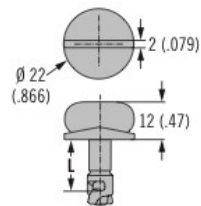
ACTUAL  
SIZE

##### Bail

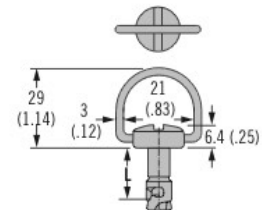
ACTUAL  
SIZE

#### Stud Panel Preparation

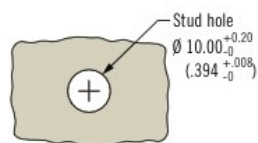
INFO  
CLIC
[www.southco.com/D8](http://www.southco.com/D8)

Dimensions in millimeters (inch) unless otherwise stated

**DZUS®** | **southco®**  
CONNECT · CREATE · INNOVATE

# D8 DZUS® PANEX Quarter-Turn Fasteners

## Stud selection · Size 9

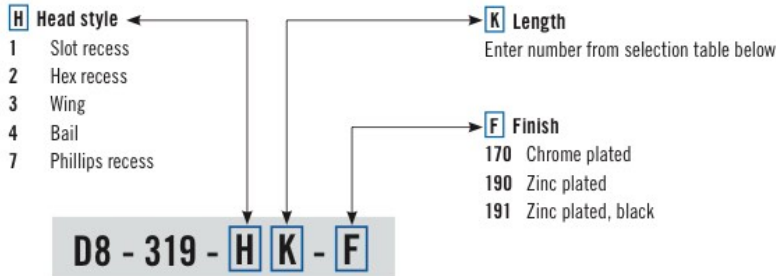

### Part Number Selection

82

85

**D8**

D1

D4

D5

D7

NY



### To select correct fastener:

#### 1. Select receptacle

Choose a receptacle from pages 406-408

#### 2. Select retainer and accessories

from page 409 and note any adjustment values

#### 3. Specify stud length

Calculate the total material thickness (TMT) using the formula given for the receptacle selected. Find the range of TMT using the stud length selection table (left) using the column (A, or B) given for the receptacle selected.

#### 4. Complete the stud part number

by specifying the head style **H**, stud length **K**, and material **M**

#### Example:

For rivet-on

D8-339-400-121 use column A

For TMT value calculated as 5.2 (.206), K = 13

For slotted head style in steel, zinc plated material, completed part number: D8-319-113-190

A complete example can be found on page 377.

#### Notes

Stainless steel material may require a higher minimum order quantity.

Contact Southco for details.

Stud Length Table					
A		B		K	L ±.15 (.006)
Min.	Max.	Min.	Max.		
TMT Range For: D8-339-400-121 D8-339-500-121 D8-339-300-121 D8-339-301-121 D8-339-305-121		TMT Range For: D8-339-200-190			
3.0 (.12)	3.9 (.15)	~	~	11	11 (.433)
4.0 (.16)	4.9 (.19)	~	~	12	12 (.472)
5.0 (.20)	5.9 (.23)	~	~	13	13 (.512)
6.0 (.24)	6.9 (.27)	~	~	14	14 (.551)
7.0 (.28)	7.9 (.31)	~	~	15	15 (.591)
8.0 (.31)	8.9 (.35)	~	~	16	16 (.630)
9.0 (.35)	9.9 (.39)	~	~	17	17 (.669)
10.0 (.39)	10.9 (.43)	~	~	18	18 (.709)
11.0 (.43)	11.9 (.47)	~	~	19	19 (.748)
12.0 (.47)	12.9 (.51)	~	~	20	20 (.787)
13.0 (.51)	13.9 (.55)	~	~	21	21 (.827)
14.0 (.55)	14.9 (.59)	2.5 (.10)	3.4 (.13)	22	22 (.866)
15.0 (.59)	15.9 (.63)	3.5 (.14)	4.4 (.17)	23	23 (.906)
16.0 (.63)	16.9 (.67)	4.5 (.18)	5.4 (.21)	24	24 (.945)
17.0 (.67)	17.9 (.70)	5.5 (.22)	6.4 (.25)	25	25 (.984)
18.0 (.71)	18.9 (.74)	6.5 (.26)	7.4 (.29)	26	26 (1.02)
19.0 (.75)	19.9 (.78)	7.5 (.30)	8.4 (.33)	27	27 (1.06)
20.0 (.79)	20.9 (.82)	8.5 (.33)	9.4 (.37)	28	28 (1.10)
21.0 (.83)	21.9 (.86)	9.5 (.37)	10.4 (.41)	29	29 (1.14)
22.0 (.87)	22.9 (.90)	10.5 (.41)	11.4 (.45)	30	30 (1.18)





## D8 DZUS® PANEX Quarter-Turn Fasteners

### Receptacles · Size 9

#### Material and Finish

Steel, zinc immersion coating

82

#### Installation Notes

85

Install with  $\varnothing 3$  (.125) rivets

D8

D1

D4

D5

D7

NY

#### Part Number

See table

#### Notes

Utilize stud selection column indicated when choosing a stud length from the stud length table on page 405

#### Rivet-On

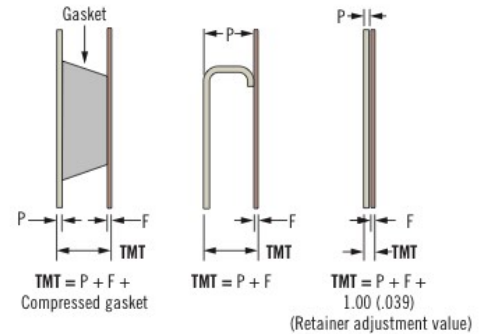
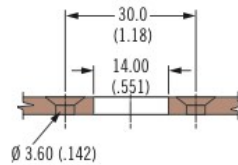
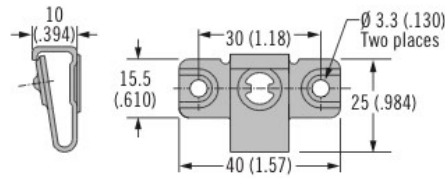

Part Number	Stud Selection Column
D8-339-400-121	A

#### Material and Finish

Steel, zinc immersion coating

#### Weld-On

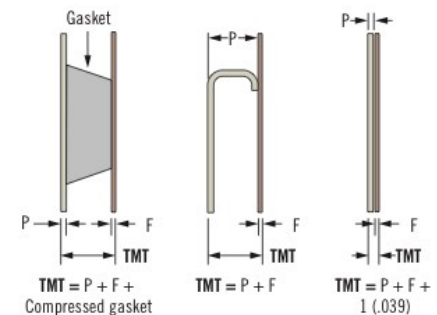
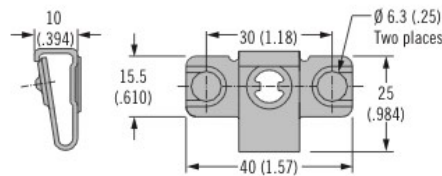

Part Number	Stud Selection Column
D8-339-500-121	A

#### Part Number

See table

#### Notes

Utilize stud selection column indicated when choosing a stud length from the stud length table on page 405



[www.southco.com/D8](http://www.southco.com/D8)

Dimensions in millimeters (inch) unless otherwise stated

**DZUS®** **southco®**  
CONNECT · CREATE · INNOVATE

# D8 DZUS® PANEX Quarter-Turn Fasteners

## Receptacles · Size 9



407

### Side Mount

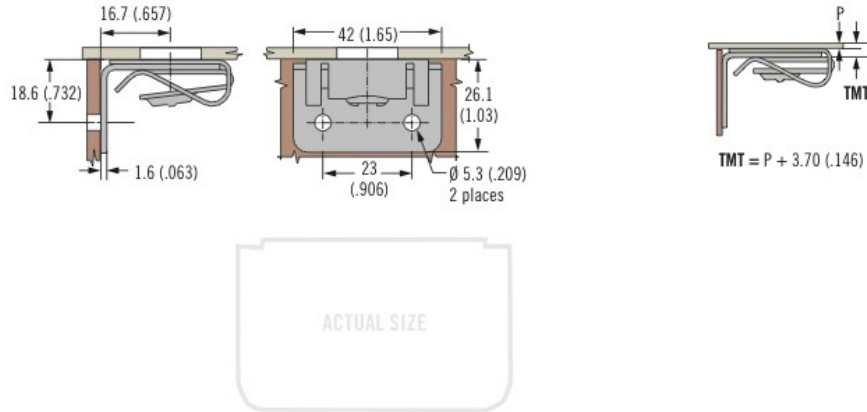

Part Number	Stud Selection Column
D8-339-305-121	A

### Material and Finish

Steel, zinc immersion coating

82

85

**D8**

D1

D4

D5

D7

NY



### Part Number

See table

### Notes

Utilize stud selection column indicated when choosing a stud length from the stud length table on page 405

### Clip-On

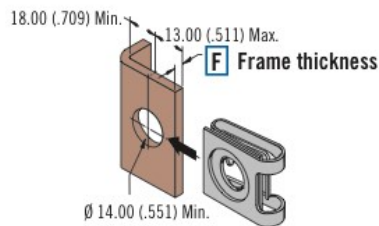
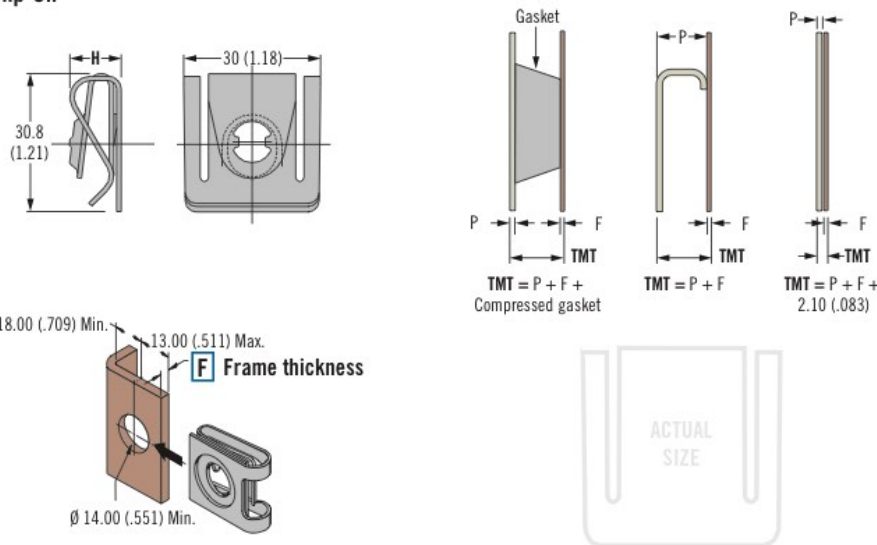

F Frame Thickness Range	Part Number	H	Stud Selection Column
0.7 - 3.2 (.028 - .126)	D8-339-300-121	10.7 (.421)	A
3.2 - 5.5 (.126 - .217)	D8-339-301-121	11.3 (.445)	

### Material and Finish

Steel, zinc immersion coating

### Part Number

See table

### Notes

Utilize stud selection column indicated when choosing a stud length from the stud length table on page 405



# D8 DZUS® PANEX Quarter-Turn Fasteners

## Receptacles · Size 9

### Material and Finish

Steel, zinc plated

82

85

**D8**

D1

D4

D5

D7

NY



### Front Mount

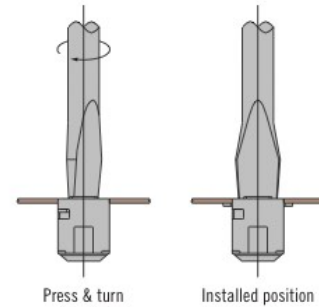
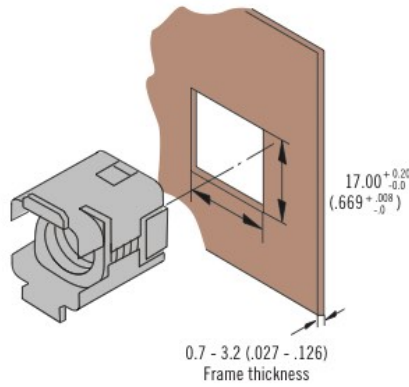
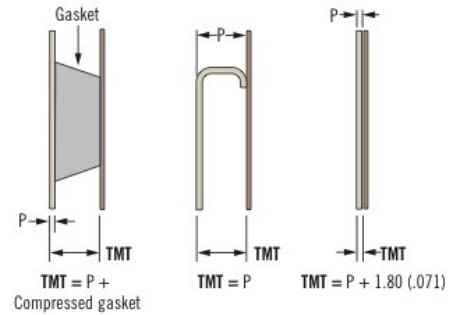
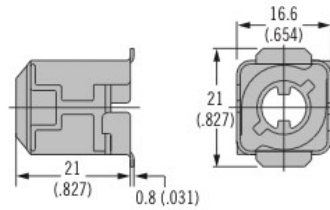

### Part Number

See table

### Notes

Utilize stud selection column indicated when choosing a stud length from the stud length table on page 405

Type	Part Number	Stud Selection Column
Front mount	D8-339-200-190	<b>B</b>



[www.southco.com/D8](http://www.southco.com/D8)

Dimensions in millimeters (inch) unless otherwise stated

**DZUS**®

**southco**®  
CONNECT · CREATE · INNOVATE

# D8 DZUS® PANEX Quarter-Turn Fasteners

## Retainers and accessories · Size 9



409

### Retainer Push-On, Plastic

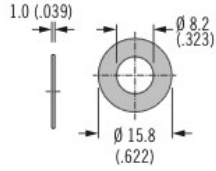

### Retainer Push-On, Steel

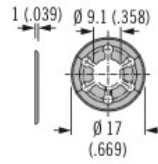

Type	Part Number	Material	Adjustment Value
Push-on Plastic	D8-329-101-040	Nylon 6/6 Black	Included in TMT calculation
Push-on	D8-329-101-200	Stainless steel	

### Material and Finish

See table

82

85

**D8**

D1

D4

D5

D7

NY



### Retainer Spring (Must be secured with steel retainer)

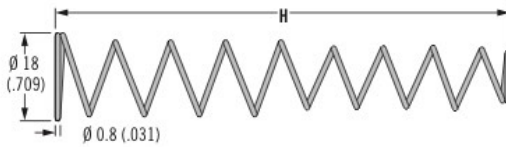

### With Retaining Spring

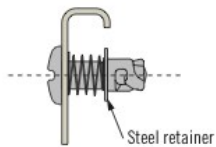

### Without Retaining Spring

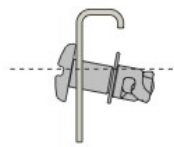

Part Number	H	X Min.	X Max.
D8-329-200-200	48 (1.89)	7 (.276)	43 (1.69)

**DZUS®** | **southco®**  
CONNECT · CREATE · INNOVATE

Dimensions in millimeters (inch) unless otherwise stated



[www.southco.com/D8](http://www.southco.com/D8)



# D1 DZUS® Dart Quarter-Turn Fasteners

## Studs, Glass-filled nylon

### Material and Finish

Glass-filled nylon, black

### Adjustment formula

Add 2.3 (.090) to panel thickness and recalculate your TMT when using self-ejecting stud assembly

82  
85  
D8

D1

D4

D5

D7

NY



### To select correct fastener:

#### 1. Select receptacle

Choose a receptacle from pages 411-413

#### 2. Select retainer and accessories

from page 413 and note any adjustment values

#### 3. Specify stud length

Calculate the total material thickness (TMT) using the formula given for the receptacle selected. Find the range of TMT using the stud length selection table (right) using the column (A, B, C, or D) given for the receptacle selected.

#### 4. Complete the stud part number

by specifying the head style **H**, stud length **K**, and material **M**

Example: For rivet-on

D1-004-001-010 use column A  
For TMT value calculated as 5.2 (.206), K = 55

For slotted head style, completed part number: D1-004-055-030  
A complete example can be found on page 377.

### Part Number Selection

### H Head Styles - Tool Actuated

Slot Recess

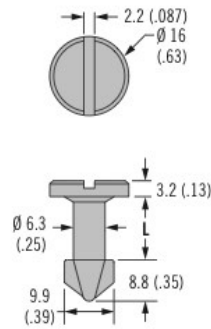

Hex Recess

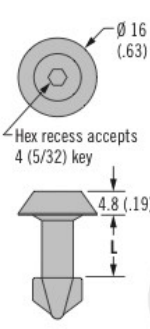

### H Head Styles - Hand Actuated

Slotted Recess Knob

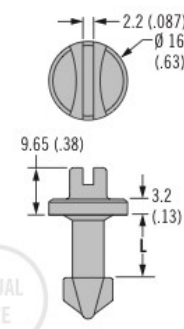

Wing

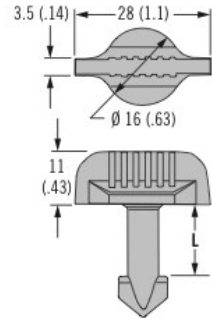

### Standard Stud Assembly

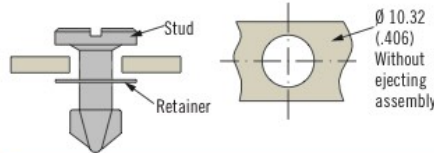

### Self-Ejecting Stud Assembly

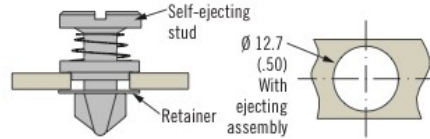

Stud Length Table									
A		B		C		D		K	L
TMT Range For: D1-004-001-010		TMT Range For: D1-004-00(F)-010		TMT Range For: D1-004-92(F)-010		TMT Range For: D1-004-91(F)-010 D1-004-01(F)-010			
Min.	Max.	Min.	Max.	Min.	Max.	Min.	Max.		
2.54 (.100)	3.80 (.149)	~	~	4.32 (.170)	5.58 (.219)	4.13 (.163)	5.39 (.212)	045	11.4 (.45)
3.81 (.150)	5.07 (.199)	3.81 (.150)	5.07 (.199)	5.59 (.220)	6.85 (.269)	5.40 (.213)	6.66 (.262)	050	12.7 (.50)
5.08 (.200)	6.34 (.249)	5.08 (.200)	6.34 (.249)	6.86 (.270)	8.12 (.319)	6.67 (.263)	7.93 (.312)	055	14.0 (.55)
6.35 (.250)	7.61 (.299)	6.35 (.250)	7.61 (.299)	8.13 (.320)	9.39 (.369)	7.94 (.313)	9.20 (.362)	060	15.2 (.60)
7.62 (.300)	8.88 (.349)	7.62 (.300)	8.88 (.349)	9.40 (.370)	10.66 (.419)	9.21 (.363)	10.47 (.412)	065	16.5 (.65)
8.89 (.350)	10.15 (.399)	8.89 (.350)	10.15 (.399)	10.67 (.420)	11.93 (.469)	10.48 (.413)	11.74 (.462)	070	17.8 (.70)
10.16 (.400)	11.42 (.449)	10.16 (.400)	11.42 (.449)	11.94 (.470)	13.20 (.519)	11.75 (.463)	13.01 (.512)	075	19.1 (.75)
11.43 (.450)	12.69 (.499)	11.43 (.450)	12.69 (.499)	13.21 (.520)	14.47 (.569)	13.02 (.513)	14.28 (.562)	080	20.3 (.80)
12.70 (.500)	13.96 (.549)	12.70 (.500)	13.96 (.549)	14.48 (.570)	15.74 (.619)	14.29 (.563)	15.55 (.612)	085	21.6 (.85)
13.97 (.550)	15.23 (.599)	13.97 (.550)	15.23 (.599)	15.75 (.620)	17.01 (.669)	15.56 (.613)	16.82 (.662)	090	22.9 (.90)
15.24 (.600)	16.50 (.649)	15.24 (.600)	16.50 (.649)	17.02 (.670)	18.28 (.719)	16.83 (.663)	18.09 (.712)	095	24.1 (.95)
16.51 (.650)	17.77 (.699)	16.51 (.650)	17.77 (.699)	18.29 (.720)	19.55 (.769)	18.10 (.713)	19.36 (.762)	100	25.4 (1.0)

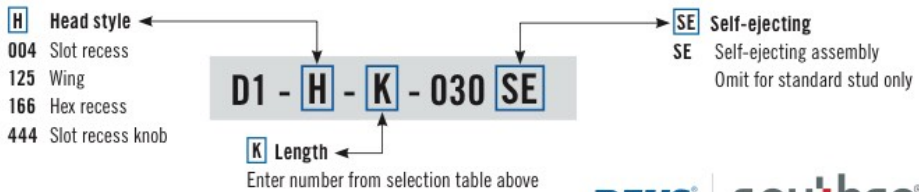

INFO CLIC [www.southco.com/D1](http://www.southco.com/D1)

Dimensions in millimeters (inch) unless otherwise stated



# D1 DZUS® Dart Quarter-Turn Fasteners Receptacles, Acetal



411

## Rivet-On

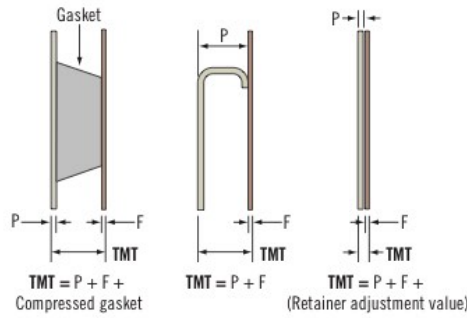
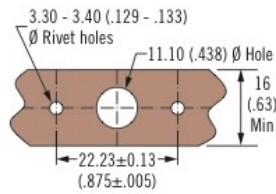
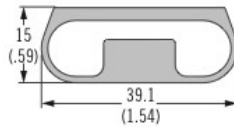
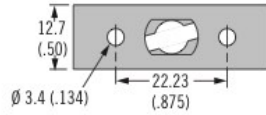

Part Number	Stud Selection Column
D1-004-001-010	A

## Material and Finish

Acetal, black

## Notes

After selecting receptacle use stud selection letter **A** and follow instruction on page 410

82

85

D8

D1

D4

D5

D7

NY



## Part Number

See table

## Snap-In Back Load

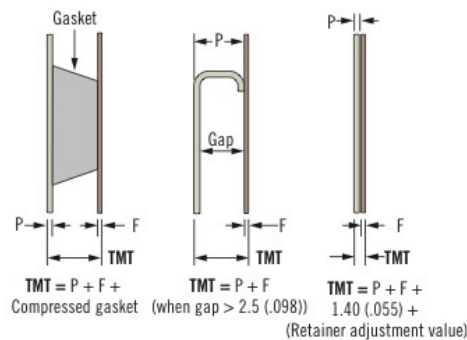
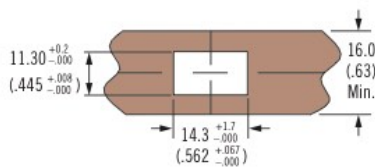
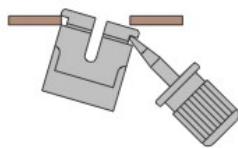
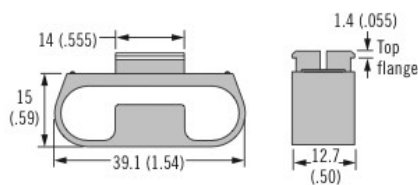

E Frame Thickness		Part Number	Stud Selection Column
Min.	Max.		
.90 (.035)	1.27 (.050)	D1-004-002-010	B
1.63 (.064)	2.00 (.080)	D1-004-003-010	
2.30 (.090)	2.64 (.104)	D1-004-004-010	
3.00 (.119)	3.40 (.135)	D1-004-005-010	
3.65 (.144)	4.00 (.158)	D1-004-006-010	

## Material and Finish

Acetal black

## Notes

Utilize stud selection column indicated when choosing a stud length from the stud length table on page 410

## Part Number

See table







# D1 DZUS® Dart Quarter-Turn Fasteners Receptacles, Acetal

## Material and Finish

Acetal, black

82

85

D8

D1

D4

D5

D7

NY

## Part Number

See table

## Notes

Utilize stud selection column indicated when choosing a stud length from the stud length table on page 410

### Mini Snap-In - Back Load

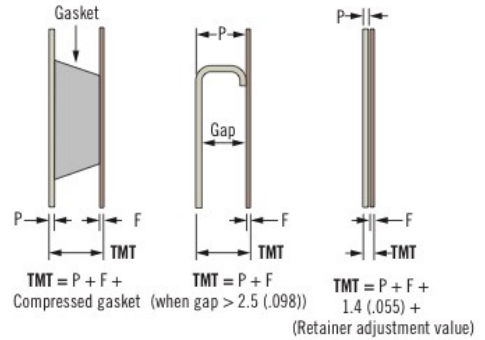
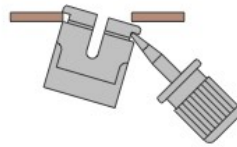
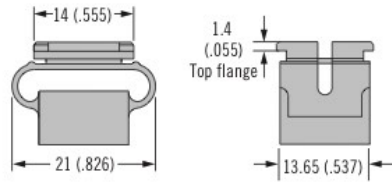

F Frame Thickness		Part Number	Stud Selection Column
Min.	Max.		
0.81 (.032)	1.27 (.050)	D1-004-012-010	D
1.29 (.051)	2.54 (.100)	D1-004-013-010	

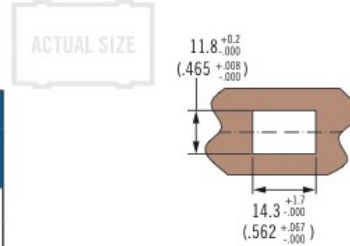

## Material and Finish

Acetal, black

### Mini Snap-In - Front Load

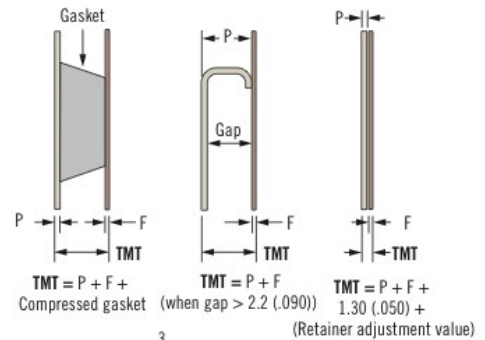
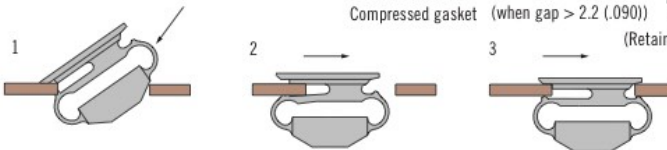
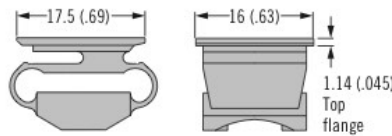

F Frame Thickness		Part Number	Stud Selection Column
Min.	Max.		
0.90 (.035)	1.25 (.049)	D1-004-911-010	D
1.30 (.051)	1.75 (.069)	D1-004-912-010	
1.80 (.071)	2.25 (.089)	D1-004-913-010	
2.30 (.091)	2.75 (.109)	D1-004-914-010	
2.80 (.111)	3.25 (.129)	D1-004-915-010	

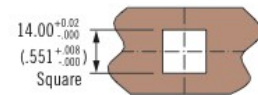

## Part Number

See table

## Notes

Utilize stud selection column indicated when choosing a stud length from the stud length table on page 410



Dimensions in millimeters (inch) unless otherwise stated



# D1 DZUS® Dart Quarter-Turn Fasteners

## Receptacles · Retainers · Accessories



413

### Clip-On

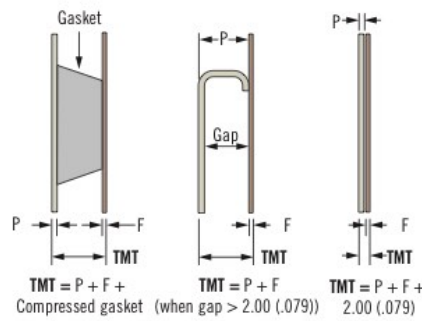
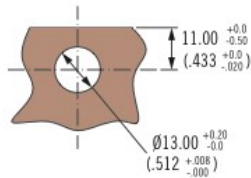
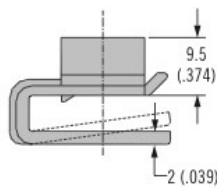
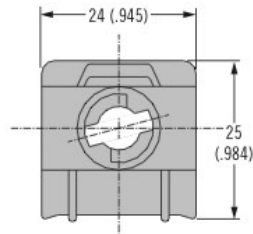

F Frame Thickness		Part Number	Stud Selection Column
Min.	Max.		
0.70 (.027)	2.30 (.090)	D1-004-921-010	C
2.30 (.090)	3.90 (.153)	D1-004-922-010	
3.9 (.153)	5.5 (.217)	D1-004-923-010	

### Material and Finish

Acetal, black

82

85

D8

D1

D4

D5

D7

NY

### Part Number

See table

### Notes

Utilize stud selection column indicated when choosing a stud length from the stud length table on page 410

### Retainer Split

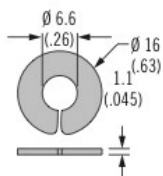

### Self-Ejecting Springs

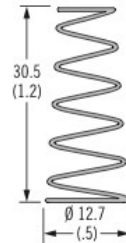
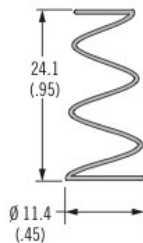

### Self-Ejecting Cup

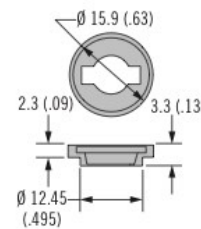

### Material and Finish

See table

### Part Number

See table

### Notes

#### Adjustment value:

When using accessories the components increase TMT

Add the adjustment value to your outer panel thickness (P) when calculating TMT (see page 377 for example)

Type	K Range	Part Number	Material	Adjustment Value
Retainer split	All	D1-004-000-010	Acetal, black	Add 1.1 (.045)
Self-ejecting springs	045 to 070	D1-X1135-2S	Stainless steel	Add 2.3 (.090)
Self-ejecting springs	075 to 100	D1-X1137-2S	Stainless steel	
Self-ejecting cup	All	D1-X1129	Acetal, black	



Dimensions in millimeters (inch) unless otherwise stated



[www.southco.com/D1](http://www.southco.com/D1)



# D4 DZUS® Standard Line Quarter-Turn Fasteners

## Stud selection · Size 3

### Material and Finish

Studs:  
Steel, zinc plated or stainless steel

82

85

D8

D1

**D4**

D5

D7

NY

### To select correct fastener:

#### 1. Select receptacle

Choose a receptacle from page 415

#### 2. Select retainer and accessories

from page 416 and note any adjustment values

#### 3. Specify stud length

Calculate the total material thickness (TMT) using the formula given for the receptacle selected. Find the range of TMT using the stud length selection table (right) using the column (A or B) given for the receptacle selected.

#### 4. Complete the stud part number

by specifying the head style **H**, stud length **K**, and material **M**

Example: For rivet-on

D4-S3-175 use column A

For TMT value calculated as 5.2 (.206), K = 35

For slotted head style in steel material, completed part number: D4-AJ3-35

A complete example can be found on page 377.

#### Notes

Stainless steel material may require a higher minimum order quantity. Contact Southco for details.

### H Head Styles - Tool Actuated

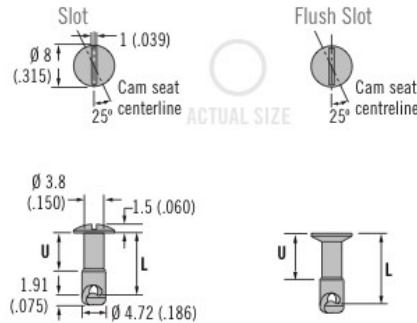

### Flush

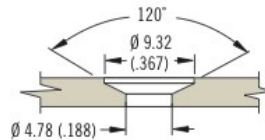

### H Head Styles - Hand Actuated

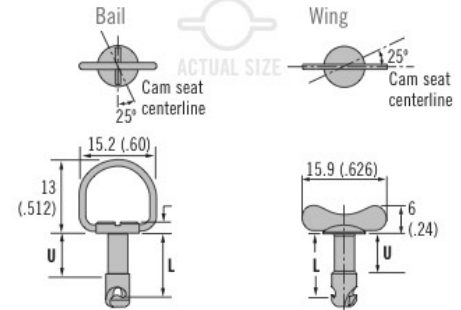

### Standard

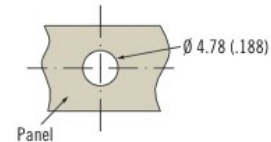

- H** Head style
- AJ** Slot
- AJW** Wing head
- BJR** Bail
- FJ** Flush slot

**K** Length  
Enter number from selection table below

**M** Material  
**SS** Stainless steel  
Omit for steel, zinc plated

**D4 - H 3 - K M**

Stud Length Table

A		B		K	U	L			
TMT Range For: Rivet-On Receptacle D4-S3-175	TMT Range For: Rivet-On Receptacle D4-S3-150	TMT Range For: Weld-On Receptacle D4-X735-205	TMT Range For: Weld-On Receptacle D4-X735-180						
Min.	Max.	Min.	Max.	Min.	Max.	Min.			
2.41 (.095)	3.02 (.119)	3.05 (.12)	3.66 (.144)	1.65 (.065)	2.26 (.089)	2.29 (.114)	25	1.91 (.075)	6.35 (.250)
3.68 (.145)	4.29 (.169)	4.32 (.17)	4.93 (.194)	2.92 (.115)	3.53 (.139)	4.17 (.164)	30	2.54 (.100)	7.62 (.300)
4.95 (.195)	5.56 (.219)	5.59 (.22)	6.2 (.244)	4.19 (.165)	4.8 (.189)	5.44 (.214)	35	3.81 (.150)	8.89 (.350)
6.22 (.245)	6.83 (.269)	6.86 (.27)	7.47 (.294)	5.46 (.215)	6.07 (.239)	6.71 (.264)	40	5.08 (.200)	10.16 (.400)
7.49 (.295)	8.1 (.319)	8.13 (.32)	8.74 (.344)	6.73 (.265)	7.34 (.289)	7.98 (.314)	45	5.77 (.225)	11.43 (.450)
8.76 (.345)	9.37 (.369)	9.4 (.37)	10.01 (.394)	8.00 (.315)	8.61 (.339)	9.25 (.364)	50	6.35 (.250)	12.70 (.500)
10.03 (.395)	10.64 (.419)	10.67 (.42)	11.28 (.444)	9.27 (.365)	9.88 (.389)	10.52 (.414)	55	6.99 (.275)	13.97 (.550)
11.3 (.445)	11.91 (.469)	11.94 (.47)	12.55 (.494)	10.54 (.415)	11.15 (.439)	11.79 (.464)	60	7.62 (.300)	15.24 (.600)
12.57 (.495)	13.18 (.519)	13.21 (.52)	13.82 (.544)	11.81 (.465)	12.42 (.489)	13.06 (.514)	65	8.89 (.350)	16.51 (.650)
13.84 (.545)	14.45 (.569)	14.48 (.57)	15.09 (.594)	13.08 (.515)	13.69 (.539)	14.33 (.564)	70		17.78 (.700)
15.11 (.595)	15.72 (.619)	15.75 (.62)	16.36 (.644)	14.35 (.565)	14.96 (.589)	15.6 (.614)	75	9.5 (.375)	19.05 (.750)
16.38 (.645)	16.99 (.669)	17.02 (.67)	17.63 (.694)	15.62 (.615)	16.23 (.639)	16.87 (.664)	80	10.16 (.400)	20.32 (.800)

INFO CLIC [www.southco.com/D4](http://www.southco.com/D4)

Dimensions in millimeters (inch) unless otherwise stated



# D4 DZUS® Standard Line Quarter-Turn Fasteners

## Receptacles · Size 3



415

### Rivet-On

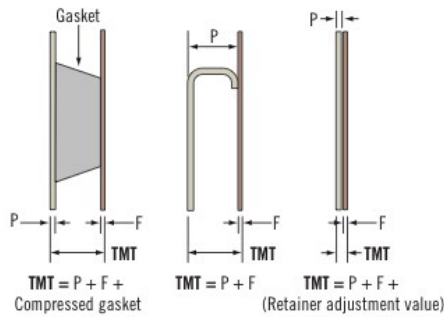
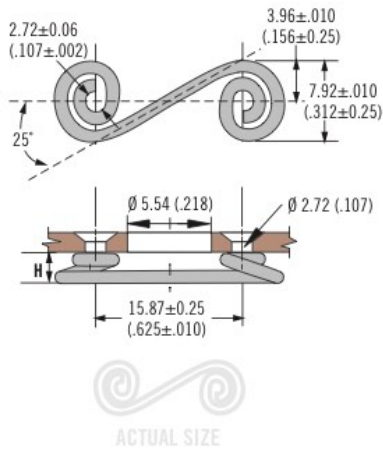

Part Number		H±0.25(.010)	Stud Selection Column
Steel	Stainless Steel		
D4-S3-150	D4-S3-150SS	3.81 (.150)	A
D4-S3-175	D4-S3-175SS	4.45 (.175)	

### Material and Finish

Steel, zinc plated or stainless steel

### Notes

After selecting receptacle use stud selection letter **A** and follow instruction on page 414

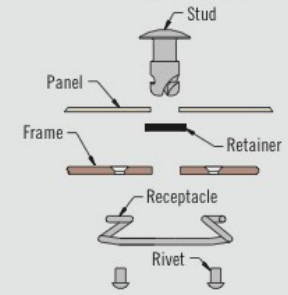

### Part Number

See table

### Weld-On

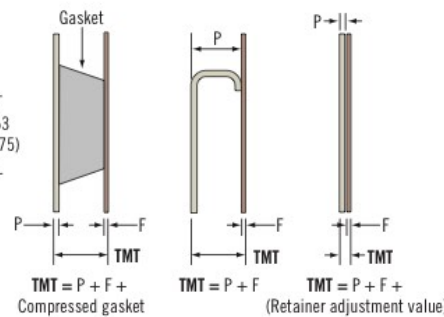
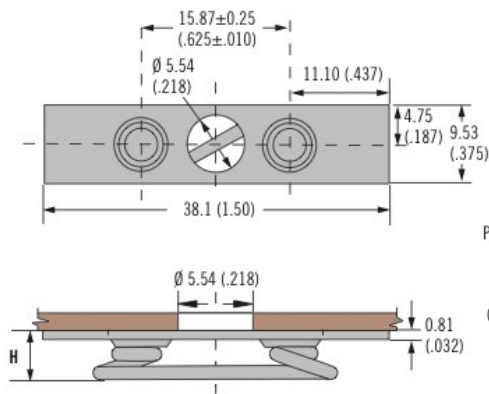

Part Number	H	Stud Selection Column
D4-X735-180	4.57 (.180)	B
D4-X735-205	5.21 (.205)	

### Material and Finish

Steel, zinc plated

### Notes

After selecting receptacle use stud selection letter **B** and follow instruction on page 414

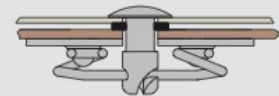

### Part Number

See table



## D4 DZUS® Standard Line Quarter-Turn Fasteners

### Retainers · Size 3, 4, 5 and 6

#### Material and Finish

Retaining ring: Steel, zinc plated

Retaining spring: Stainless steel

Retainer GH: Aluminum, natural

Retainer GP, natural: HD Polythene

Retainer GP, black: Polypropylene

#### Installation Notes

1. Place the retainer on the mandrel as shown
2. Align ring or spring ends so that they will miss the stud cam
3. Place mandrel in end of stud cam
4. Place tool over mandrel
5. Push retainer until it is sealed in stud undercut

#### Notes

Tooling:

29 - TFRS hand tool: Spreads the inside diameter of retainers over stud shanks and then pushes them into stud undercuts.

29 - TB1A block: Nests stud heads during installation. (Any flat block may be used for BJR bail head studs).

#### Part Number

See table

#### Retainer GP

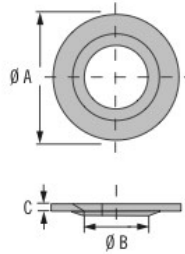

#### Retainer GH

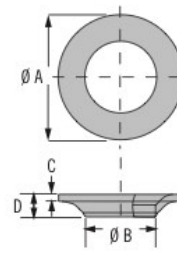

#### Retaining Ring

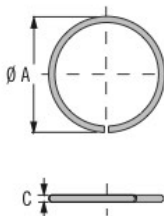

#### Install Retainer GP, Retaining Ring and SX

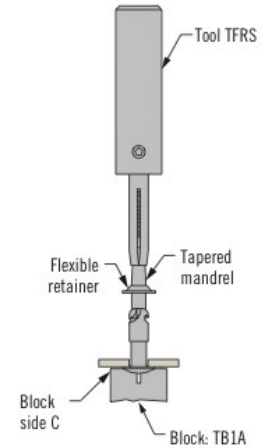

#### Retaining Spring

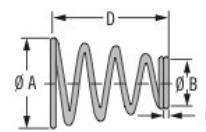

#### Install Retainer GH

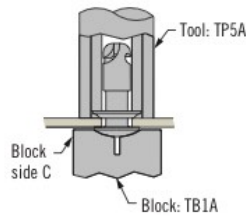

Standard Hole  
Small diameter faces panel



Oversized Hole  
Large diameter faces panel

Size	Type	Part Number	Ø A	Ø B	C	D	Adjustment Value	Installation Tool Part Number
3	Retainer GP, natural	D4-GP3	7.9 (.311)	4.06 (.160)	0.5 (.020)	N/A	Add 0.51 (.020)	29-TFRS3 and 29-TB1A3
	Retainer GP, black	D4-GP3B						
	Retainer GH	D4-GH3	4.8 (.188)	0.38 (.015)	1.3 (.051)	Add 0.38 (.015)	29-TP5A3 and 29-TB1A3	
	Retaining ring	D4-RR3	5.3 (.209)	N/A	0.56 (.022)	N/A	Add 0.56 (.022)	29-TFRS3 and 29-TB1A3
	Retaining spring	D4-SX520	7.9 (.311)	3.8 (.149)	0.46 (.018)	17.5 (.689)	Add 0.91 (.036)	
4	Retainer GP, natural	D4-GP4	11.1 (.437)	5.4 (.21)	0.7 (.028)	N/A	Add 0.7 (.028)	29-TFRS4 and 29-TB1A4
	Retainer GP, black	D4-GP4B						
	Retainer GH	D4-GH4	6.35 (.250)	0.64 (.025)	2.1 (.083)	Add 0.64 (.025)	29-TP5A4 and 29-TB1A4	
	Retaining ring	D4-RR4	7.1 (.280)	N/A	0.71 (.028)	N/A	Add 0.74 (.029)	29-TFRS4 and 29-TB1A4
	Retaining spring	D4-SX523	11.1 (.437)	5.1 (.200)	0.64 (.025)	17.5 (.689)	Add 1.28 (.050)	
5	Retainer GP, natural	D4-GP5	14.3 (.562)	6.5 (.256)	0.83 (.033)	N/A	Add 0.86 (.034)	29-TFRS5 and 29-TB1A5
	Retainer GP, black	D4-GP5B						
	Retainer GH	D4-GH5	7.9 (.311)	0.88 (.035)	2.7 (.106)	Add 0.78 (.031)	29-TP5A5 and 29-TB1A5	
	Retaining ring	D4-RR5	8.92 (.351)	N/A	0.91 (.036)	N/A	Add 0.91 (.035)	29-TFRS5 and 29-TB1A5
	Retaining spring	D4-SX510	14.3 (.562)	6.5 (.256)	0.82 (.032)	19 (.748)	Add 1.64 (.064)	
6	Retainer GH	D4-GH6	15.9 (.625)	9.5 (.374)	0.88 (.035)	2.9 (.114)	Add .88 (.035)	29-TP5A6 and 29-TB1A6
	Retaining ring	D4-RR6	10.78 (.424)	N/A	1.14 (.045)	N/A	Add 1.14 (.045)	29-TFRS6 and 29-TB1A6
	Retaining spring	D4-SX518	15.9 (.625)	8 (.315)	0.88 (.035)	19 (.748)	Add 1.76 (.070)	



[www.southco.com/D4](http://www.southco.com/D4)

Dimensions in millimeters (inch) unless otherwise stated

**DZUS®** **southco®**  
CONNECT · CREATE · INNOVATE

# D4 DZUS® Standard Line Quarter-Turn Fasteners

## Retainers · Size 3, 4, 5 and 6



417

### Retainer GA

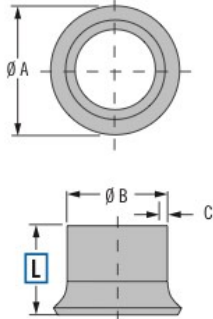

### Installation Retainer GA

1.



2.

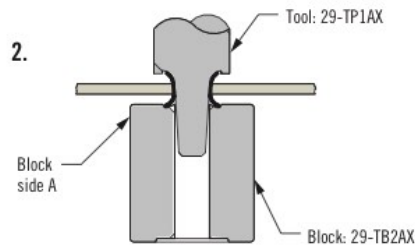

3.

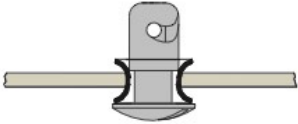

4.

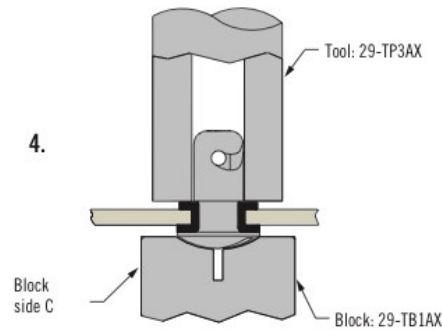

Size	Panel Thickness	L	Part Number	$\varnothing A$	$\varnothing B$	C	Adjustment Formula	Installation Tool Part Number
3	0.38 - 0.64 (.015 - .025)	4.45 (.175)	D4-GA3-175	$\varnothing 7.9$ (.311)	5.6 (.220)	0.38 (.015)	Add 0.38 (.015)	29-TP1A3, 29-TP3A3, 29-TB1A3 and 29-TB2A3 (all required)
	0.66 - 1.27 (.026 - .050)	5.08 (.200)	D4-GA3-200					
	1.29 - 2.38 (.051 - .094)	6.35 (.250)	D4-GA3-250					
4	0.38 - 0.64 (.015 - .025)	4.45 (.175)	D4-GA4-175	10.3 (.405)	7.9 (.311)	1.28 (.050)	Add 1.28 (.050)	29-TP1A4, 29-TP3A4 and 29-TB1A4 (all required)
	0.66 - 1.27 (.026 - .050)	5.08 (.200)	D4-GA4-200					
	1.29 - 2.38 (.051 - .094)	6.35 (.250)	D4-GA4-250					
5	0.38 - 0.64 (.015 - .025)	4.45 (.175)	D4-GA5-175	12.7 (.500)	9.5 (.374)	1.42 (.056)	Add 1.42 (.056)	29-TP1A5, 29-TP3A5, 29-TB1A5 and 29-TB2A5 (all required)
	0.66 - 1.27 (.026 - .050)	5.08 (.200)	D4-GA5-200					
	1.29 - 2.38 (.051 - .094)	6.35 (.250)	D4-GA5-250					
6	0.38 - 0.64 (.015 - .025)	4.45 (.175)	D4-GA6-175	15.1 (.594)	11.1 (.437)	1.42 (.056)	Add 1.42 (.056)	29-TP1A6, 29-TP3A6, 29-TB1A6 and 29-TB2A6 (all required)
	0.66 - 1.27 (.026 - .050)	5.08 (.200)	D4-GA6-200					
	1.29 - 2.38 (.051 - .094)	6.35 (.250)	D4-GA6-250					

### Material and Finish

Retainer GA: Aluminum, natural

### Installation Notes

1. Insert retainer in panel hole
2. Set retainer
3. Insert stud
4. Flatten retainer

82

85

D8

D1

D4

D5

D7

NY



**DZUS®** | **southco®**  
CONNECT · CREATE · INNOVATE

Dimensions in millimeters (inch) unless otherwise stated

INFO  
CLIC

[www.southco.com/D4](http://www.southco.com/D4)





# D4 DZUS® Standard Line Quarter-Turn Fasteners

## Stud selection · Size 4

### Material and Finish

Studs:  
Steel, zinc plated or stainless steel

82

85

D8

D1

D4

D5

D7

NY



### To select correct fastener:

#### 1. Select receptacle

Choose a receptacle from pages 420-421

#### 2. Select retainer and accessories

from pages 416-417 and note any adjustment values

#### 3. Specify stud length

Calculate the total material thickness (TMT) using the formula given for the receptacle selected. Find the range of TMT using the stud length selection table (right) using the column (A, B, C, or D) given for the receptacle selected.

#### 4. Complete the stud part number

by specifying the head style **H**, stud length **K**, and material **M**

Example:

For rivet-on

D4-S4-225 use column A

For TMT value calculated as 5.2 (.206), K = 40

For slotted head style in steel material, completed part number: D4-AJ4-40

A complete example can be found on page 377

### H Head Styles - Tool Actuated

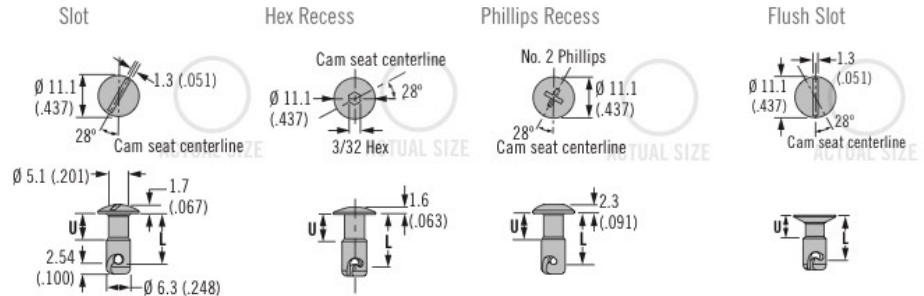

### H Head Styles - Hand Actuated

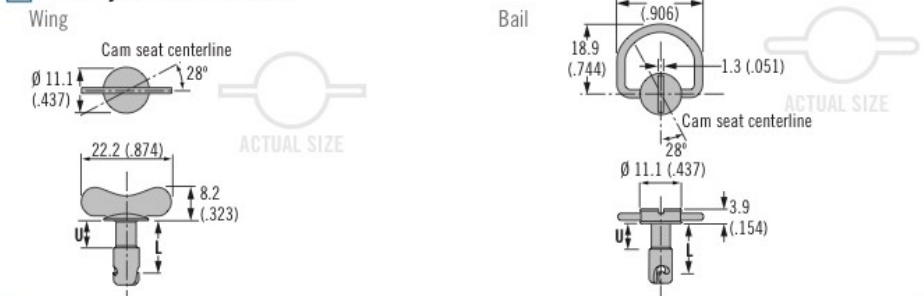

Stud Length Table

A		B		K	U	L				
TMT Range For: Rivet-On Receptacle D4-S4-225	TMT Range For: Rivet-On Receptacle D4-S4-200	TMT Range For: Weld-On Receptacle D4-X485-300	TMT Range For: Weld-On Receptacle D4-X485-275							
Min.	Max.	Min.	Max.	Min.	Max.	Min.	Max.			
1.27 (.050)	1.88 (.074)	1.91 (.075)	2.51 (.099)	-	-	-	-	25	1.91 (.075)	6.35 (.250)
2.54 (.100)	3.15 (.124)	3.18 (.125)	3.78 (.149)	0.64 (.025)	1.24 (.049)	1.27 (.050)	1.88 (.074)	30	2.54 (.100)	7.62 (.300)
3.81 (.150)	4.42 (.174)	4.45 (.175)	5.05 (.199)	1.91 (.075)	2.51 (.099)	2.54 (.100)	3.15 (.124)	35	3.81 (.150)	8.89 (.350)
5.08 (.200)	5.69 (.224)	5.72 (.225)	6.32 (.249)	3.18 (.125)	3.78 (.149)	3.81 (.150)	4.42 (.174)	40	5.08 (.200)	10.16 (.400)
6.35 (.250)	6.96 (.274)	6.99 (.275)	7.59 (.299)	4.45 (.175)	5.05 (.199)	5.08 (.200)	5.69 (.224)	45	5.72 (.225)	11.43 (.450)
7.62 (.300)	8.23 (.324)	8.26 (.325)	8.86 (.349)	5.72 (.225)	6.32 (.249)	6.35 (.250)	6.96 (.274)	50	6.35 (.250)	12.70 (.500)
8.89 (.350)	9.50 (.374)	9.53 (.375)	10.13 (.399)	6.99 (.275)	7.59 (.299)	7.62 (.300)	8.23 (.324)	55	6.99 (.275)	13.97 (.550)
10.16 (.400)	10.77 (.424)	10.80 (.425)	11.40 (.449)	8.26 (.325)	8.86 (.349)	8.89 (.350)	9.50 (.374)	60	7.62 (.300)	15.24 (.600)
11.43 (.450)	12.04 (.474)	12.07 (.475)	12.67 (.499)	9.53 (.375)	10.13 (.399)	10.16 (.400)	10.77 (.424)	65	8.89 (.350)	16.51 (.650)
12.70 (.500)	13.31 (.524)	13.34 (.525)	13.94 (.549)	10.80 (.425)	11.40 (.449)	11.43 (.450)	12.04 (.474)	70		17.78 (.700)
13.97 (.550)	14.58 (.574)	14.61 (.575)	15.21 (.599)	12.07 (.475)	12.67 (.499)	12.70 (.500)	13.31 (.524)	75	10.16 (.400)	19.05 (.750)
15.24 (.600)	15.85 (.624)	15.88 (.625)	16.48 (.649)	13.34 (.525)	13.94 (.549)	13.97 (.550)	14.58 (.574)	80		20.32 (.800)
16.51 (.650)	17.12 (.674)	17.15 (.675)	17.75 (.699)	14.61 (.575)	15.21 (.599)	15.24 (.600)	15.85 (.624)	85	12.70 (.500)	21.59 (.850)
17.78 (.700)	18.39 (.724)	18.42 (.725)	19.02 (.749)	15.88 (.625)	16.48 (.649)	16.51 (.650)	17.12 (.674)	90		22.86 (.900)
19.05 (.750)	19.66 (.774)	19.69 (.775)	20.29 (.799)	17.15 (.675)	17.75 (.699)	17.78 (.700)	18.39 (.724)	95	15.24 (.600)	24.13 (.950)
20.32 (.800)	20.93 (.824)	20.96 (.825)	21.56 (.849)	18.42 (.725)	19.02 (.749)	19.05 (.750)	19.66 (.774)	100		25.40 (1.00)

INFO CLIC [www.southco.com/D4](http://www.southco.com/D4)

Dimensions in millimeters (inch) unless otherwise stated

DZUS® southco®  
CONNECT · CREATE · INNOVATE

**Flush**

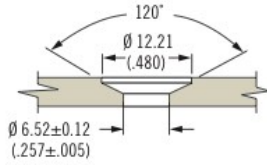

**Standard**

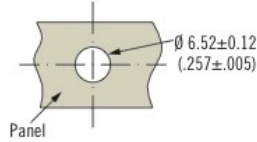

**Part Number Selection**

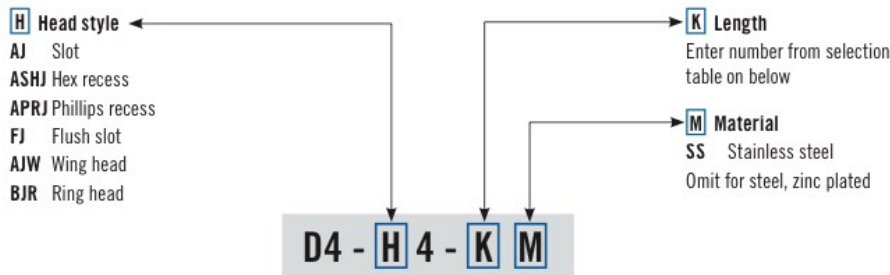

Stud Length Table						
C				K	U	L
TMT Range For: Clip-On Receptacle D4-SL4-305		TMT Range For: Clip-On Receptacle D4-SL4-280				
Min.	Max.	Min.	Max.			
~	~	~	~	25	1.91 (.075)	6.35 (.250)
~	~	1.17 (.046)	1.78 (.070)	30	2.54 (.100)	7.62 (.300)
1.80 (.071)	2.41 (.095)	2.44 (.096)	3.05 (.120)	35	3.81 (.150)	8.89 (.350)
3.07 (.121)	3.68 (.145)	3.71 (.146)	4.32 (.170)	40	5.08 (.200)	10.16 (.400)
4.34 (.171)	4.95 (.195)	4.98 (.196)	5.59 (.220)	45	5.72 (.225)	11.43 (.450)
5.61 (.221)	6.22 (.245)	6.25 (.246)	6.86 (.270)	50	6.35 (.250)	12.70 (.500)
6.88 (.271)	7.49 (.295)	7.52 (.296)	8.13 (.320)	55	6.99 (.275)	13.97 (.550)
8.15 (.321)	8.76 (.345)	8.79 (.346)	9.40 (.370)	60	7.62 (.300)	15.24 (.600)
9.42 (.371)	10.03 (.395)	10.06 (.396)	10.67 (.420)	65	8.89 (.350)	16.51 (.650)
10.69 (.421)	11.30 (.445)	11.33 (.446)	11.94 (.470)	70		17.78 (.700)
11.96 (.471)	12.57 (.495)	12.60 (.496)	13.21 (.520)	75	10.16 (.400)	19.05 (.750)
13.23 (.521)	13.84 (.545)	13.87 (.546)	14.48 (.570)	80		20.32 (.800)
14.50 (.571)	15.11 (.595)	15.14 (.596)	15.75 (.620)	85	12.7 (.500)	21.59 (.850)
15.77 (.621)	16.38 (.645)	16.41 (.646)	17.02 (.670)	90	15.24 (.600)	22.86 (.900)
17.04 (.671)	17.65 (.695)	17.68 (.696)	18.29 (.720)	95		24.13 (.950)
18.31 (.721)	18.92 (.745)	18.95 (.746)	19.56 (.770)	100		25.40 (1.00)

Stud Length Table					
D			K	U	L
TMT Range For: Snap-In - Rear Mount Receptacle D4-SQC4-F					
Min.	Max.	D4-GP4B			
0.48 (.019)	1.09 (.043)	None	45	5.72 (.225)	11.43 (.450)
1.12 (.044)	1.73 (.068)	One	50	6.35 (.250)	12.70 (.500)
1.75 (.069)	2.36 (.093)	None	50		
2.39 (.094)	3.00 (.118)	One	55	6.99 (.275)	13.97 (.550)
3.02 (.119)	3.63 (.143)	None	55		
3.66 (.144)	4.27 (.168)	One	60	7.62 (.300)	15.24 (.600)
4.29 (.169)	4.90 (.193)	None	60		
4.93 (.194)	5.54 (.218)	One	65	8.89 (.350)	16.51 (.650)
5.56 (.219)	6.17 (.243)	None	65		
6.20 (.244)	6.81 (.268)	One	70		
6.83 (.269)	7.44 (.293)	None	70	10.16 (.400)	17.78 (.700)
7.47 (.294)	8.08 (.318)	One	75		
8.10 (.319)	8.71 (.343)	None	75	10.16 (.400)	19.05 (.750)
8.74 (.344)	9.35 (.368)	One	80		
9.37 (.369)	9.98 (.393)	None	80		20.32 (.800)





# D4 DZUS® Standard Line Quarter-Turn Fasteners

## Receptacles · Size 4

### Material and Finish

Steel, zinc plated or stainless steel

### Notes

After selecting receptacle use stud selection letter **A** and follow instruction on page 418

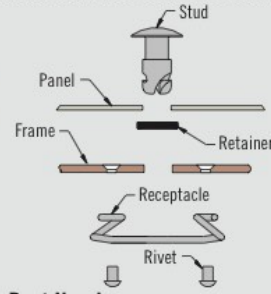

### Part Number

See table

Utilize stud selection column indicated when choosing a stud length from the stud length table on page 418-419

### Material and Finish

Steel, zinc plated or stainless steel

### Notes

After selecting receptacle use stud selection letter **B** and follow instruction on page 418

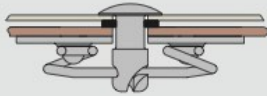

### Part Number

See table

Utilize stud selection column indicated when choosing a stud length from the stud length table on page 418-419



### Rivet-On

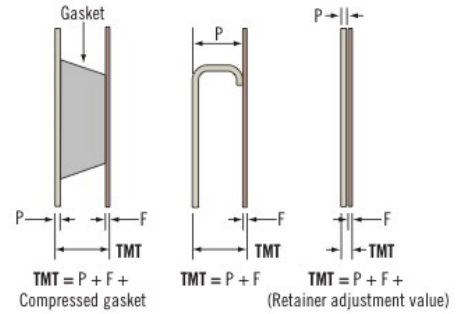
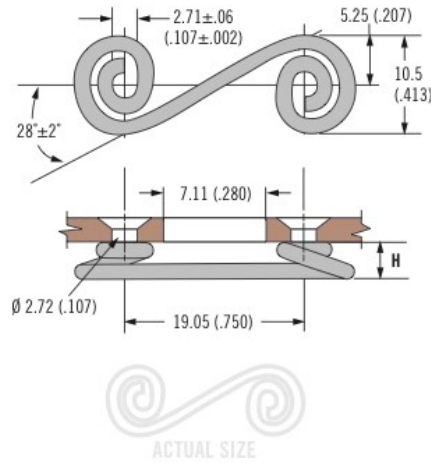

Part Number		H	Stud Selection Column
Steel	Stainless Steel		
D4-S4-200	D4-S4-200SS	5.08 (.200)	A
D4-S4-225	D4-S4-225SS	5.72 (.225)	

### Weld-On

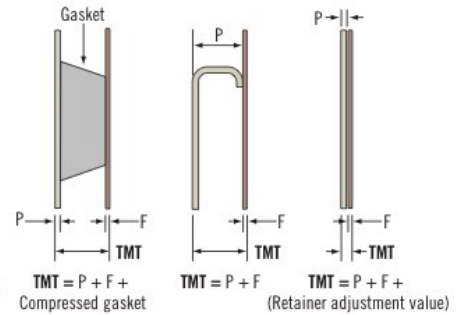
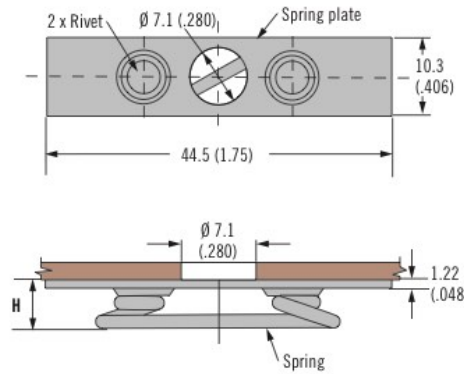

Part Number		H	Stud Selection Column
Steel	Stainless Steel		
D4-X485-275	D4-X485-275SS	6.98 (.275)	B
D4-X485-300	D4-X485-300SS	7.62 (.300)	

Dimensions in millimeters (inch) unless otherwise stated



# D4 DZUS® Standard Line Quarter-Turn Fasteners

## Receptacles - Size 4



421

### Clip-On

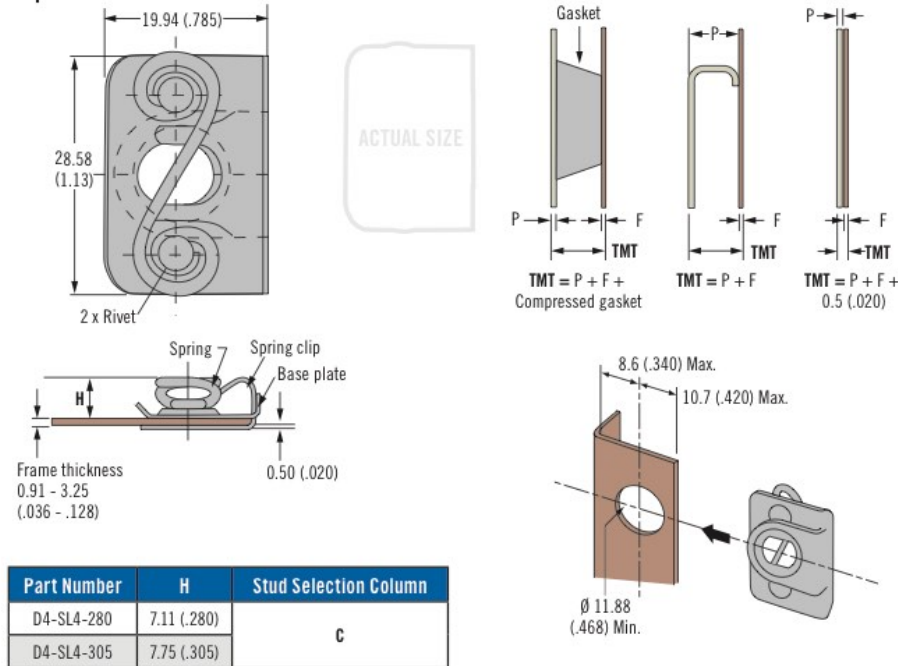

### Material and Finish

Steel, zinc plated

### Notes

After selecting receptacle use stud selection letter **C** and follow instruction on page 418

### Part Number

See table

Utilize stud selection column indicated when choosing a stud length from the stud length table on pages 418-419

### Snap-In - Rear Mount

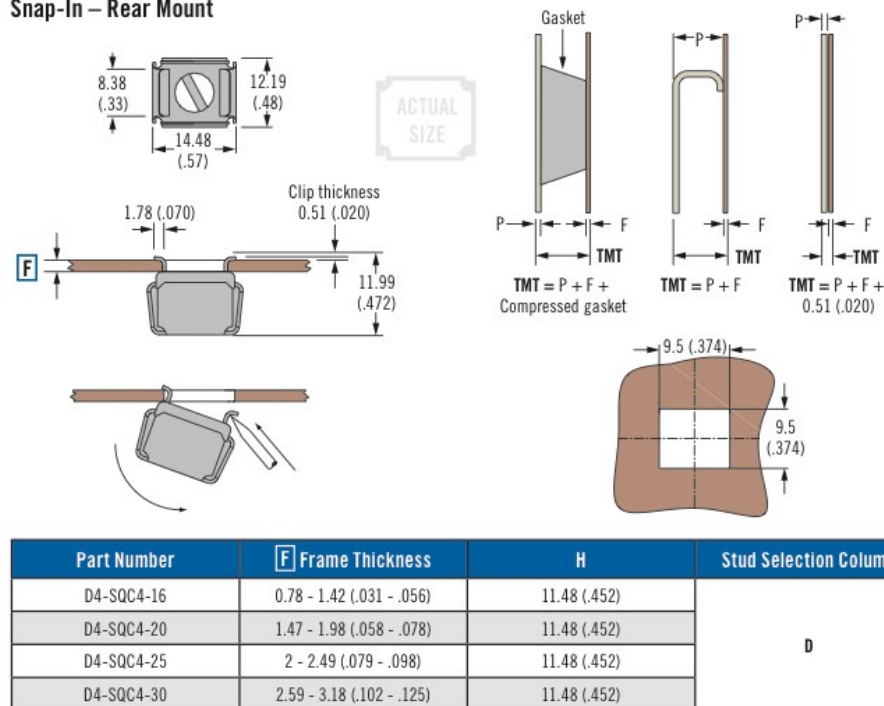

### Material and Finish

Steel, zinc plated

### Installation Notes

For stud retention use only retaining ring part number: D4-RR4

### Notes

After selecting receptacle use stud selection letter **D** and follow instruction on page 418

### Part Number

See table

Utilize stud selection column indicated when choosing a stud length from the stud length table on page 418-419



# D4 DZUS® Standard Line Quarter-Turn Fasteners

Stud selection · Size 5

## Material and Finish

Studs:

Steel, zinc plated or stainless steel

82

85

D8

D1

D4

D5

D7

NY



## To select correct fastener:

### 1. Select receptacle

Choose a receptacle from pages 424-425

### 2. Select retainer and accessories

from pages 416-417 and note any adjustment values

### 3. Specify stud length

Calculate the total material thickness (TMT) using the formula given for the receptacle selected. Find the range of TMT using the stud length selection table (right) using the column (A, B or C) given for the receptacle selected.

### 4. Complete the stud part number

by specifying the head style **H**, stud length **K**, and material **M**

Example:

For rivet-on

D4-S5-225 use column A

For TMT value calculated as 5.21 (.205), K = 40

For slotted head style in steel material, completed part number: D4-AJ5-40

A complete example can be found on page 377.

## Notes

Stainless steel material may require a higher minimum order quantity. Contact Southco for details.

## H Head Styles - Tool Actuated

Slot

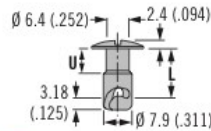
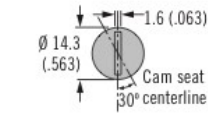

Hex Recess

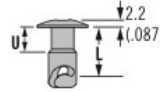
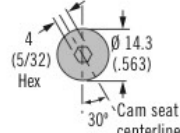

Phillips Recess

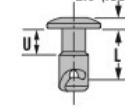
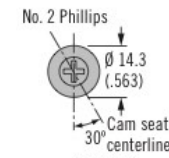

Flush slot

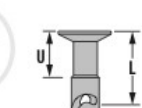
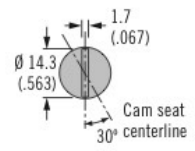

## H Head Styles - Hand Actuated

Wing

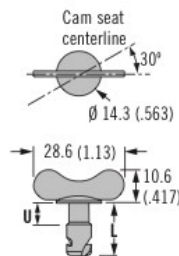

Bail

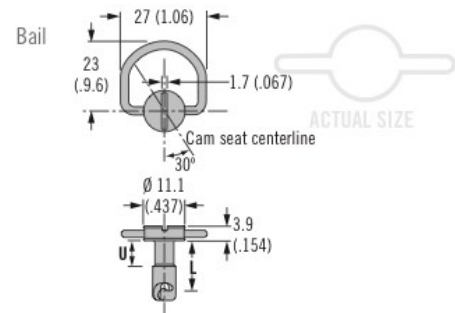

ACTUAL SIZE

Stud Length Table

A		B		U	L	K				
TMT Range For: Rivet-On Receptacle D4-S5-225	TMT Range For: Rivet-On Receptacle D4-S5-200	TMT Range For: Weld-On Receptacle D4-X414-310	TMT Range For: Weld-On Receptacle D4-X414-285							
Min.	Max.	Min.	Max.	Min.	Max.	Min.	Max.			
2.67 (.105)	3.28 (.129)	3.3 (.13)	3.91 (.154)	~	~	~	~	3.18 (.125)	7.62 (.300)	30
3.94 (.155)	4.55 (.179)	4.57 (.18)	5.18 (.204)	1.65 (.065)	2.26 (.089)	2.29 (.09)	2.9 (.114)	4.83 (.200)	8.89 (.350)	35
5.21 (.205)	5.82 (.229)	5.84 (.23)	6.45 (.254)	2.92 (.115)	3.53 (.139)	3.56 (.14)	4.17 (.164)	4.83 (.200)	10.16 (.400)	40
6.48 (.255)	7.09 (.279)	7.11 (.28)	7.72 (.304)	4.19 (.165)	4.8 (.189)	4.83 (.19)	5.44 (.214)	4.83 (.200)	11.43 (.450)	45
7.75 (.305)	8.36 (.329)	8.38 (.33)	8.99 (.354)	5.46 (.215)	6.07 (.239)	6.1 (.24)	6.71 (.264)	6.35 (.250)	12.70 (.500)	50
9.02 (.355)	9.63 (.379)	9.65 (.38)	10.26 (.404)	6.73 (.265)	7.34 (.289)	7.37 (.29)	7.98 (.314)	6.99 (.275)	13.97 (.550)	55
10.29 (.405)	10.9 (.429)	10.92 (.43)	11.53 (.454)	8.00 (.315)	8.61 (.339)	8.64 (.34)	9.25 (.364)	7.62 (.300)	15.24 (.600)	60
11.56 (.455)	12.17 (.479)	12.19 (.48)	12.8 (.504)	9.27 (.365)	9.88 (.389)	9.91 (.39)	10.52 (.414)	8.89 (.350)	16.51 (.650)	65
12.83 (.505)	13.44 (.529)	13.46 (.53)	14.07 (.554)	10.54 (.415)	11.15 (.439)	11.18 (.44)	11.79 (.464)	10.16 (.400)	17.78 (.700)	70
14.1 (.555)	14.71 (.579)	14.73 (.58)	15.34 (.604)	11.81 (.465)	12.42 (.489)	12.45 (.49)	13.06 (.514)	10.16 (.400)	19.05 (.750)	75
15.37 (.605)	15.98 (.629)	16.00 (.63)	16.61 (.654)	13.08 (.515)	13.69 (.539)	13.72 (.54)	14.33 (.564)	12.7 (.500)	20.32 (.800)	80
16.64 (.655)	17.25 (.679)	17.27 (.68)	17.88 (.704)	14.35 (.565)	14.96 (.589)	14.99 (.59)	15.6 (.614)	12.7 (.500)	21.59 (.850)	85
17.91 (.705)	18.52 (.729)	18.54 (.73)	19.15 (.754)	15.62 (.615)	16.23 (.639)	16.26 (.64)	16.87 (.664)	15.24 (.600)	22.86 (.900)	90
19.18 (.755)	19.79 (.779)	19.81 (.78)	20.42 (.804)	16.89 (.665)	17.5 (.689)	17.53 (.69)	18.14 (.714)	15.24 (.600)	24.13 (.950)	95
20.45 (.805)	21.06 (.829)	21.08 (.83)	21.69 (.854)	18.16 (.715)	18.77 (.739)	18.8 (.74)	19.41 (.764)	17.78 (.70)	25.40 (1.00)	100



[www.southco.com/D4](http://www.southco.com/D4)

Dimensions in millimeters (inch) unless otherwise stated

**DZUS®** southco®  
CONNECT · CREATE · INNOVATE

**Flush**

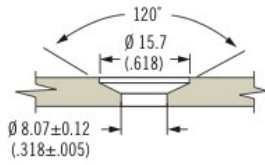

**Standard**

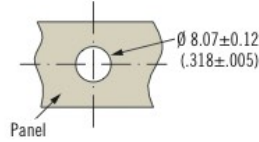

**Part Number Selection**

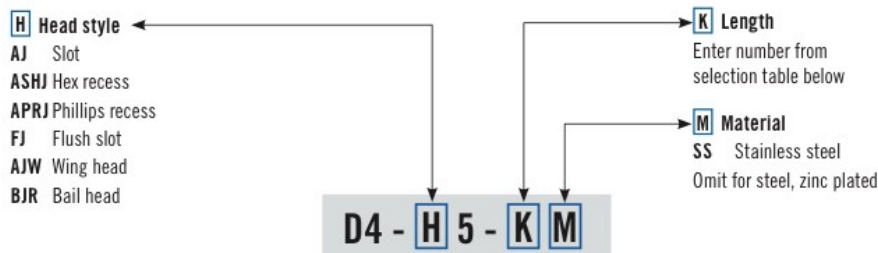

Stud Length Table						
C				U	L	K
TMT Range For: Clip-On Receptacle D4-SL5-305		TMT Range For: Clip-On Receptacle D5-SL5-280				
Min.	Max.	Min.	Max.			
~	~	1.17 (.046)	1.78 (.07)	3.18 (.125)	7.62 (.300)	<b>30</b>
1.8 (.071)	2.41 (.095)	2.44 (.096)	3.05 (.12)		8.89 (.350)	<b>35</b>
3.07 (.121)	3.68 (.145)	3.71 (.146)	4.32 (.17)	4.83 (.200)	10.16 (.400)	<b>40</b>
4.34 (.171)	4.95 (.195)	4.98 (.196)	5.59 (.22)		11.43 (.450)	<b>45</b>
5.61 (.221)	6.22 (.245)	6.25 (.246)	6.86 (.27)	6.35 (.250)	12.70 (.500)	<b>50</b>
6.88 (.271)	7.49 (.295)	7.52 (.296)	8.13 (.32)	6.99 (.275)	13.97 (.550)	<b>55</b>
8.15 (.321)	8.76 (.345)	8.79 (.346)	9.4 (.37)	7.62 (.300)	15.24 (.600)	<b>60</b>
9.42 (.371)	10.03 (.395)	10.06 (.396)	10.67 (.42)	8.89 (.350)	16.51 (.650)	<b>65</b>
10.69 (.421)	11.3 (.445)	11.33 (.446)	11.94 (.47)	10.16 (.400)	17.78 (.700)	<b>70</b>
11.96 (.471)	12.57 (.495)	12.6 (.496)	13.21 (.52)		19.05 (.750)	<b>75</b>
13.23 (.521)	13.84 (.545)	13.87 (.546)	14.48 (.57)	12.7 (.500)	20.32 (.800)	<b>80</b>
14.5 (.571)	15.11 (.595)	15.14 (.596)	15.75 (.62)		21.59 (.850)	<b>85</b>
15.77 (.621)	16.38 (.645)	16.41 (.646)	17.02 (.67)	15.24 (.600)	22.86 (.900)	<b>90</b>
17.04 (.671)	17.65 (.695)	17.68 (.696)	18.29 (.72)		24.13 (.950)	<b>95</b>
18.31 (.721)	18.92 (.745)	18.95 (.746)	19.56 (.77)	17.78 (.70)	25.40 (1.00)	<b>100</b>





# D4 DZUS® Standard Line Quarter-Turn Fasteners

## Receptacles · Size 5

### Material and Finish

Steel, zinc plated or stainless steel

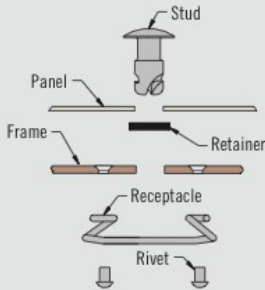

### Rivet-On

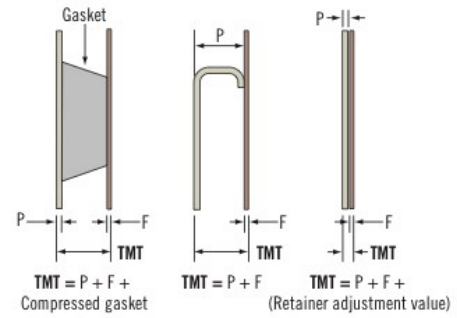
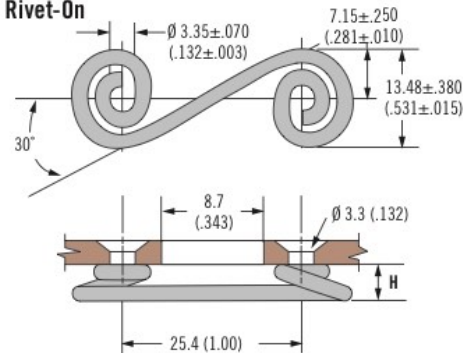

- 82
- 85
- D8
- D1
- D4**
- D5
- D7
- NY

### Part Number

See table

### Notes

Utilize stud selection column indicated when choosing a stud length from the stud length table on pages 422-423

Part Number		H	Stud Selection Column
Steel	Stainless Steel		
D4-S5-200	D4-S5-200SS	5.08 (.200)	A
D4-S5-225	D4-S5-225SS	5.72 (.225)	

### Material and Finish

Steel, zinc plated or stainless steel

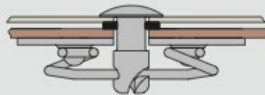

### Weld-On

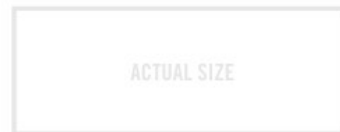
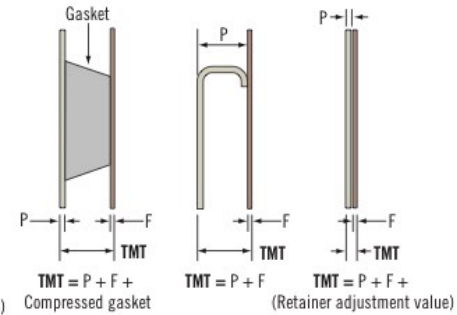
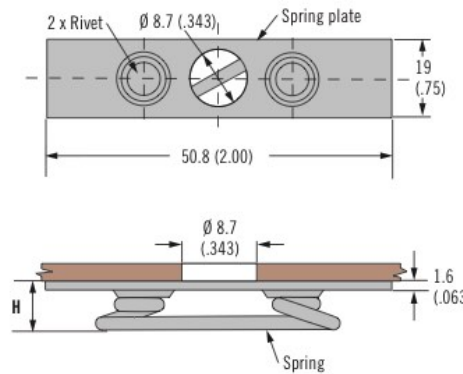

### Part Number

See table

### Notes

Utilize stud selection column indicated when choosing a stud length from the stud length table on pages 422-423

Part Number		H	Stud Selection Column
Steel	Stainless Steel		
D4-X414-285	D4-X414-285SS	7.2 (.285)	B
D4-X414-310	D4-X414-310SS	7.9 (.310)	



Dimensions in millimeters (inch) unless otherwise stated



# D4 DZUS® Standard Line Quarter-Turn Fasteners

## Receptacles · Size 5



425

### Clip-On

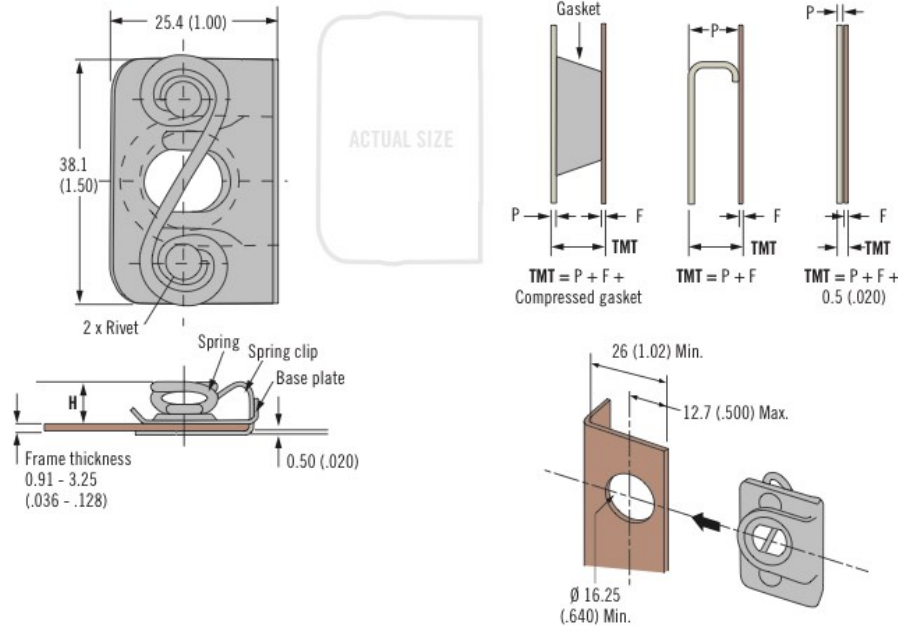

**Note:**  
Panel misalignment can be tolerated by increasing the support hole to 17.86 (.703) and decreasing the hole center to edge distance to 11.43 (.450)

Part Number	H	Stud Selection Column
D4-SL5-280	7.11 (.280)	C
D4-SL5-305	7.75 (.305)	

### Material and Finish

Steel, zinc plated

82

85

D8

D1

**D4**

D5

D7

NY



### Part Number

See table

### Notes

Utilize stud selection column indicated when choosing a stud length from the stud length table on pages 422-423



# D4 DZUS® Standard Line Quarter-Turn Fasteners

## Stud selection · Size 6

### Material and Finish

Studs:  
Steel, zinc plated or stainless steel

82

85

D8

D1

D4

D5

D7

NY

### To select correct fastener:

#### 1. Select receptacle

Choose a receptacle from page 427

#### 2. Select retainer and accessories

from pages 416-417 and note any adjustment values

#### 3. Specify stud length

Calculate the total material thickness (TMT) using the formula given for the receptacle selected. Find the range of TMT using the stud length selection table (right) using the column (A or B) given for the receptacle selected.

#### 4. Complete the stud part number

by specifying the head style **H**, stud length **K**, and material **M**

Example:

For rivet-on

D4-S6-300 use column A

For TMT value calculated as 5.2 (.206), K = 45

For slotted head style in steel material, completed part number: D4-AJ6-45

A complete example can be found on page 377.

### Notes

Stainless steel material may require a higher minimum order quantity. Contact Southco for details.

### H Head Styles - Tool Actuated

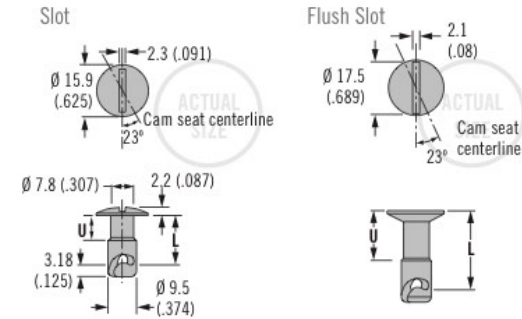

### H Head Styles - Hand Actuated

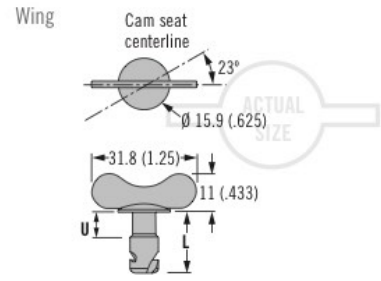

### Flush

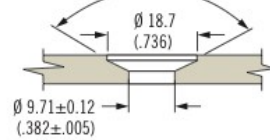

### Standard

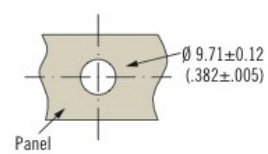

### H Head style

- AJ Slot recess
- AJW Wing head
- FJ Flush slot

### K Length

Enter number from selection table below

### M Material

- SS Stainless steel
- Omit for steel, zinc plated

D4 - H 6 - K M

Stud Length Table

A		B				U	L	K		
TMT Range For: Rivet-On Receptacle D4-S6-300	TMT Range For: Rivet-On Receptacle D4-S6-275	TMT Range For: Weld-On Receptacle D4-X441-335	TMT Range For: Weld-On Receptacle D4-X441-310	U	L				K	
Min.	Max.	Min.	Max.	Min.	Max.	Min.	Max.			
2.29 (.090)	2.90 (.114)	2.92 (.115)	3.53 (.139)	1.40 (.055)	2.01 (.079)	2.03 (.080)	2.64 (.104)	4.45 (.175)	8.89 (.350)	35
3.56 (.140)	4.17 (.164)	4.19 (.165)	4.80 (.189)	2.67 (.105)	3.28 (.129)	3.30 (.130)	3.91 (.154)	5.08 (.200)	10.16 (.400)	40
4.83 (.190)	5.44 (.214)	5.46 (.215)	6.07 (.239)	3.94 (.155)	4.55 (.179)	4.57 (.180)	5.18 (.204)	5.72 (.225)	11.43 (.450)	45
6.10 (.240)	6.71 (.264)	6.73 (.265)	7.34 (.289)	5.21 (.205)	5.82 (.229)	5.84 (.230)	6.45 (.254)	6.35 (.250)	12.70 (.500)	50
7.37 (.290)	7.98 (.314)	8.00 (.315)	8.61 (.339)	6.48 (.255)	7.09 (.279)	7.11 (.280)	7.72 (.304)	6.99 (.275)	13.97 (.550)	55
8.64 (.340)	9.25 (.364)	9.27 (.365)	9.88 (.389)	7.75 (.305)	8.36 (.329)	8.38 (.330)	8.99 (.354)	7.62 (.300)	15.24 (.600)	60
9.91 (.390)	10.52 (.414)	10.54 (.415)	11.15 (.439)	9.02 (.355)	9.63 (.379)	9.65 (.380)	10.26 (.404)	8.89 (.350)	16.51 (.650)	65
11.18 (.440)	11.79 (.464)	11.81 (.465)	12.42 (.489)	10.29 (.405)	10.90 (.429)	10.92 (.430)	11.53 (.454)		17.78 (.700)	70
12.45 (.490)	13.06 (.514)	13.08 (.515)	13.69 (.539)	11.56 (.455)	12.17 (.479)	12.19 (.480)	12.80 (.504)	10.16 (.400)	19.05 (.750)	75
13.72 (.540)	14.33 (.564)	14.35 (.565)	14.96 (.589)	12.83 (.505)	13.44 (.529)	13.46 (.530)	14.07 (.554)	11.43 (.450)	20.32 (.800)	80
14.99 (.590)	15.60 (.614)	15.62 (.615)	16.23 (.639)	14.10 (.555)	14.71 (.579)	14.73 (.580)	15.34 (.604)	12.7 (.500)	21.59 (.850)	85
16.26 (.640)	16.87 (.664)	16.89 (.665)	17.50 (.689)	15.37 (.605)	15.98 (.629)	16.00 (.630)	16.61 (.654)	13.97 (.550)	22.86 (.900)	90
17.53 (.690)	18.14 (.714)	18.16 (.715)	18.77 (.739)	16.64 (.655)	17.25 (.679)	17.27 (.680)	17.88 (.704)	15.24 (.600)	24.13 (.950)	95
18.80 (.740)	19.41 (.764)	19.43 (.765)	20.04 (.789)	17.91 (.705)	18.52 (.729)	18.54 (.730)	19.15 (.754)	16.51 (.650)	25.40 (1.00)	100

INFO CLIC [www.southco.com/D4](http://www.southco.com/D4)

Dimensions in millimeters (inch) unless otherwise stated

DZUS® southco®  
CONNECT · CREATE · INNOVATE

# D4 DZUS® Standard Line Quarter-Turn Fasteners

## Receptacles · Size 6



427

### Rivet-On

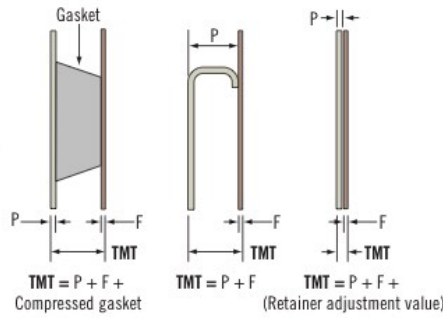
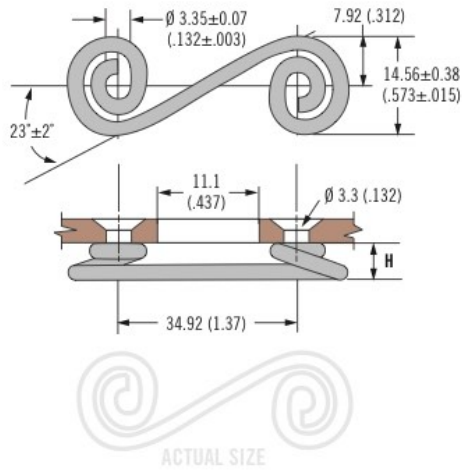

Part Number		H	Stud Selection Column
Steel	Stainless Steel		
D4-S6-275	D4-S6-275SS	6.99 (.275)	A
D4-S6-300	D4-S6-300SS	7.62 (.300)	

### Material and Finish

Steel, zinc plated or stainless steel

### Notes

After selecting receptacle use stud selection letter **A** and follow instruction on page 426

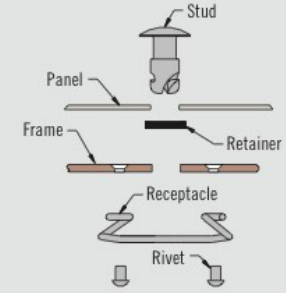

### Part Number

See table

### Weld-On

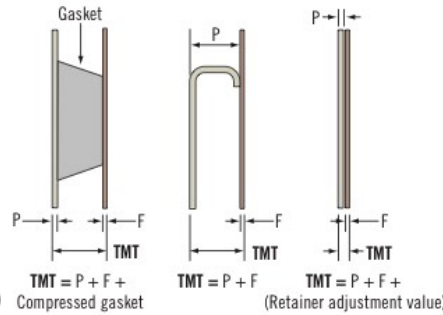
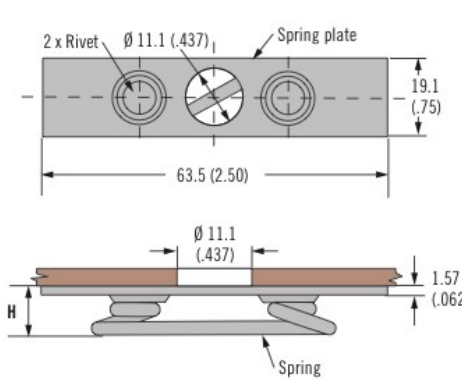

Part Number	H	Stud Selection Column
D4-X441-310	7.87 (.310)	B
D4-X441-335	8.51 (.335)	

### Material and Finish

Steel, zinc plated

### Notes

After selecting receptacle use stud selection letter **B** and follow instruction on page 426

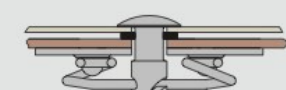

### Part Number

See table





## D5 DZUS® Panel Line Quarter-turn Fasteners Studs

DZUS® Panel line features captive, flare-in stud assemblies and continuous receptacle strip.

- Captive to outer panel
- Predictable clamping force
- High vibration resistance
- Visual latched indication

### Material and Finish

Steel, zinc plated

### Performance Details

Rated tensile and shear:  
890 N (200 lbs.) when used with  
DZUS® receptacles

### Stud assembly

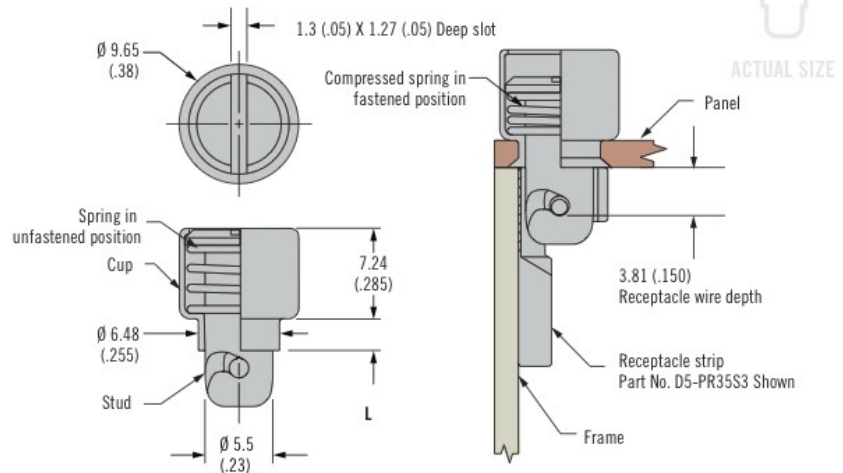

### Panel Preparation

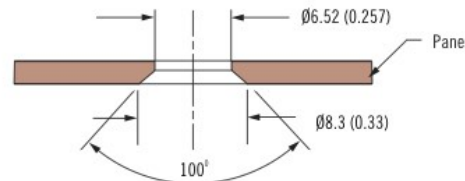

1. Select receptacle type
2. D5-PR35S3 (angle) or D5-PR35-IS3 (flat) receptacle types. Determine outer panel thickness and use column A. Select from column C for assemblies.

### OR

D5-PB35 (Single hole wire form) receptacle type. Determine outer panel thickness and use column A, then calculate total material thickness (TMT) required as indicated in column B. Select from column C for assemblies.

Other options available. For complete details on variety, part numbers, installation and specification, go to



[www.southco.com/D5](http://www.southco.com/D5)

Panel line stud assembly options					
A		Cup flange length L	B		C
Outer panel dimensions			Stud assembly		
A Min.	A Max.		TMT Range for: D5-PB35		
			Min.	Max.	
1.27 (.050)	1.50 (.059)	1.78 (.070)	3.81 (.150)	4.04 (.159)	D5-PFSC35-37A-190
1.52 (.060)	1.75 (.069)	2.03 (.080)	4.06 (.160)	4.29 (.169)	D5-PFSC35-38A-190
1.77 (.070)	2.01 (.079)	2.29 (.090)	4.32 (.170)	4.55 (.179)	D5-PFSC35-39A-190
2.03 (.080)	2.26 (.089)	2.54 (.100)	4.57 (.180)	4.80 (.189)	D5-PFSC35-40A-190
2.29 (.090)	2.51 (.099)	2.80 (.110)	4.83 (.190)	5.05 (.199)	D5-PFSC35-41A-190
2.54 (.100)	2.77 (.109)	3.05 (.120)	5.08 (.200)	5.31 (.209)	D5-PFSC35-42A-190
2.79 (.110)	3.02 (.119)	3.30 (.130)	5.33 (.210)	5.56 (.219)	D5-PFSC35-43A-190
3.05 (.120)	3.28 (.129)	3.56 (.140)	5.59 (.220)	5.82 (.229)	D5-PFSC35-44A-190

Dimensions in millimeters (inch) unless otherwise stated

### Installation Tools

#### Panel installation

Flare tool      Support block



29-TP1PT35A      29-TB1PT35A

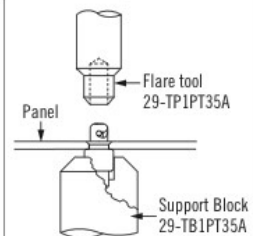

**DZUS®** **southco®**  
CONNECT · CREATE · INNOVATE

# D5 DZUS® Panel Line Quarter-turn Fasteners Receptacles



429

## Angle

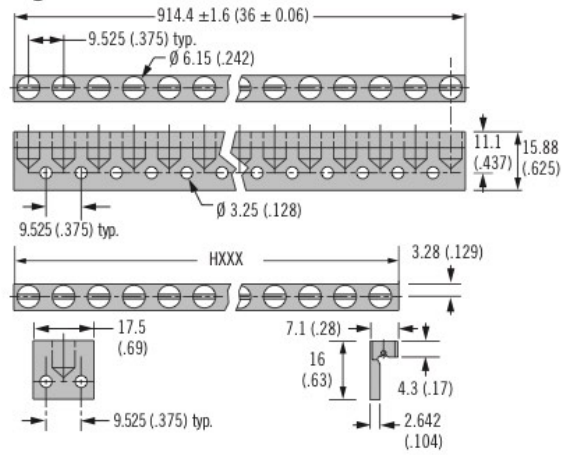

## Flat

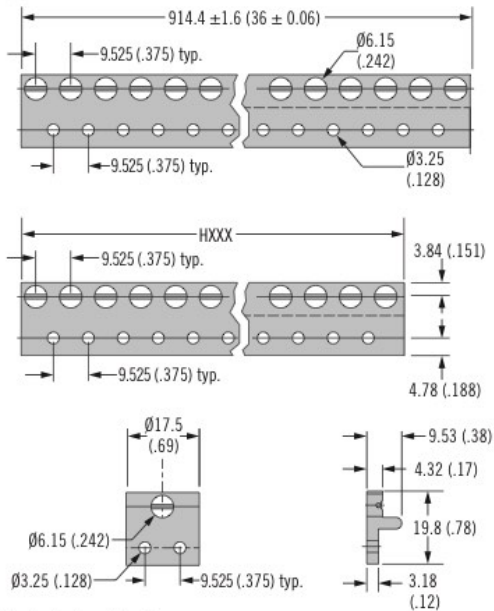

## Single hole wire form

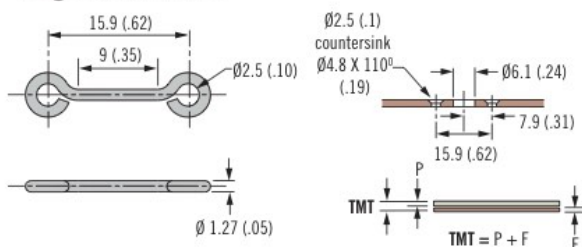

Angle Receptacle		Stud selection column
Standard length D5-PR35S3		A
Custom length D5-PR35HXXX		
Single hole D5-PRB35		

Flat Receptacle		Stud selection column
Standard length D5-PR35-1S3		A
Custom length D5-PR35-1HXXX		
Single hole D5-PRC35		

Single hole wire form receptacle		Stud selection column
D5-PB35		B

## Material and Finish

Right angle, flat aluminum and stainless steel

Single hole wire form steel zinc plated

## Select Receptacle Profile

1. Right angle or flat
2. Single hole, standard length (96 holes) or custom length
3. If custom length HXXX (2 holes Min. - 319 holes Max.) determine number of useable receptacle holes.  
Total length = No of useable holes multiplied by 9.525 (.375) minus 1.525 (.06)

Example:

319 useable holes  
= 319 x 9.525 (.375)  
- 1.525 (.06) = 3037 (119.56)  
Replace HXXX with H319

\* Longer standard lengths available. Contact Southco for details.

**DZUS®** | **southco®**  
CONNECT · CREATE · INNOVATE

Dimensions in millimeters (inch) unless otherwise stated

Other options available. For complete details on variety, part numbers, installation and specification, go to



[www.southco.com/D5](http://www.southco.com/D5)



## D7 DZUS® Pilot Quarter-Turn Fasteners Studs

### Material and Finish

Studs: Steel, zinc plated plus chromate

Washer: Neoprene, black

### Notes

Select stud and washer part number from table based on your panel thickness **P**

### Part Number

See table

Order stud and washer separately

### Studs

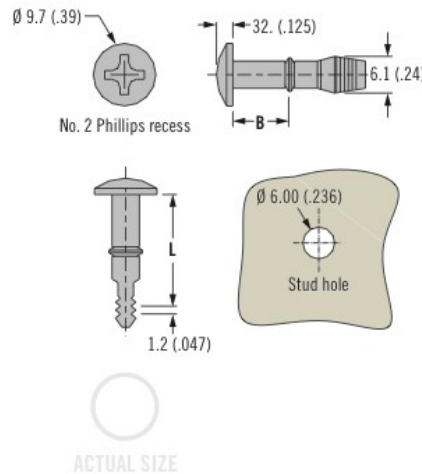

### Washer

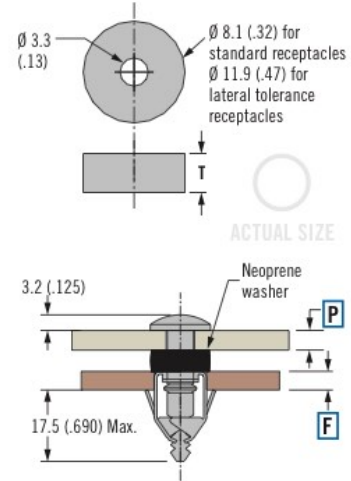

Panel Thickness <b>P</b>	Stud L	Stud B	T Washer Thickness	Part Number			
				Stud		Neoprene Washer	
				Black chromate	Bright chromate	For standard receptacle	For lateral tolerance receptacle
1.3 (.05) to 1.7 (.07)	16 (.63)	7.1 (.28)	4.1 (.16)	D7-265-716-191	D7-265-716-190	D7-275-040-400	D7-275-140-400
1.8 (.07) to 2.2 (.09)	16 (.63)	7.1 (.28)	3.6 (.14)	D7-265-716-191	D7-265-716-190	D7-275-035-400	D7-275-135-400
2.3 (.09) to 2.7 (.11)	17.8 (.70)	8.9 (.35)	5.1 (.20)	D7-265-718-191	D7-265-718-190	D7-275-050-400	D7-275-150-400
2.8 (.11) to 3.2 (.12)	17.8 (.70)	8.9 (.35)	4.6 (.18)	D7-265-718-191	D7-265-718-190	D7-275-045-400	D7-275-145-400
3.3 (.13) to 3.7 (.15)	17.8 (.70)	8.9 (.35)	4.1 (.16)	D7-265-718-191	D7-265-718-190	D7-275-040-400	D7-275-140-400
3.8 (.15) to 4.2 (.17)	17.8 (.70)	8.9 (.35)	3.6 (.14)	D7-265-718-191	D7-265-718-190	D7-275-035-400	D7-275-135-400
4.3 (.17) to 4.8 (.19)	20.0 (.79)	10.9 (.43)	5.1 (.20)	D7-265-720-191	D7-265-720-190	D7-275-050-400	D7-275-150-400

### Material and Finish

Steel, zinc plated and thermoplastic black

### Notes

Select stud and washer part number from table based on your panel thickness **P**

### Part Number

See table

Stud, cup and spring shipped pre-assembled

Order retainer separately

### Self-Ejecting Studs

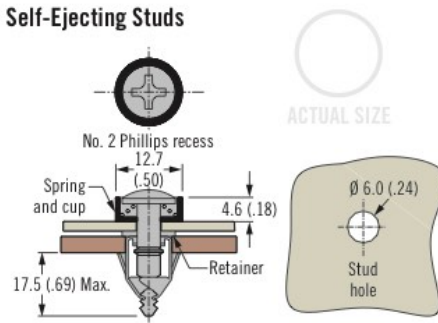

Panel Thickness <b>P</b>	Part Number	
	Black	Bright
0.5 - 3.0 (.02 - .12)	D7-290-718-191	D7-290-718-190
2.5 - 5.1 (.10 - .20)	D7-290-720-191	D7-290-720-190

### Retainer, Plastic

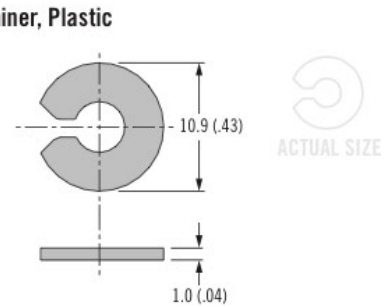

Part Number
D7-275-203-040

INFO CLIC [www.southco.com/D7](http://www.southco.com/D7)

Dimensions in millimeters (inch) unless otherwise stated

DZUS® southco®  
CONNECT · CREATE · INNOVATE

# D7 DZUS® Pilot Quarter-Turn Fasteners Receptacles



431

## Standard

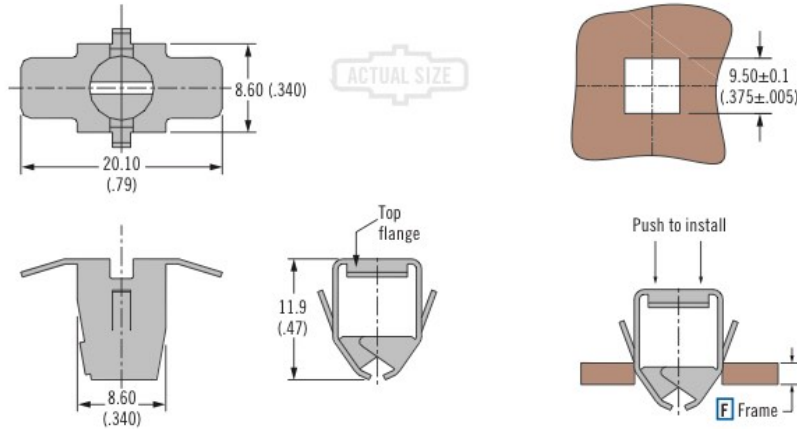

F Frame Thickness		Part Number
Min.	Max.	
0.63 (.025)	1.24 (.049)	D7-285-101-161
1.27 (.050)	1.75 (.069)	D7-285-102-161
1.78 (.070)	2.26 (.089)	D7-285-103-161

## Material and Finish

Spring steel, zinc phosphate

## Notes

Select receptacle based on frame thickness **F**

82

85

D8

D1

D4

D5

**D7**

NY



## Part Number

See table

## Lateral Tolerance

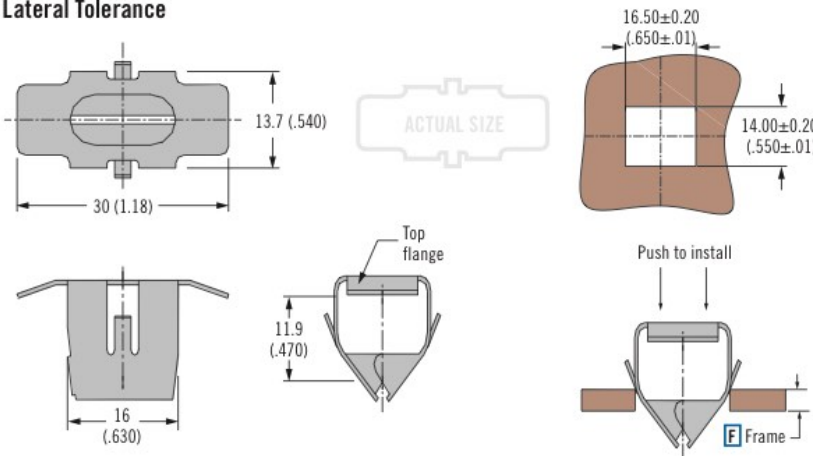

F Frame Thickness		Part Number
Min.	Max.	
0.63 (.025)	1.24 (.049)	D7-285-201-161
1.27 (.050)	1.75 (.069)	D7-285-202-161
1.78 (.070)	2.26 (.089)	D7-285-203-161
2.29 (.090)	2.77 (.109)	D7-285-204-161
2.79 (.110)	3.28 (.129)	D7-285-205-161

## Material and Finish

Spring steel, zinc phosphate

## Notes

Select receptacle based on frame thickness **F**

## Part Number

See table



## D7 DZUS® Arrow Quarter-Turn Fasteners Assembly

- Surface install
- Panel mounted assembly

82

### Material and Finish

85

Acetal, black

D8

### Performance Details

Flammability rating: UL94-HB

D1

ASTM E-162 Flame spread Index:

D4

130

D5

D7

NY

### D7 Arrow Installation notes

200 series:

1. Press receptacle into outer panel.
2. Press stud into receptacle.
3. Press and turn stud to latch
4. Turn stud 90 degree to unlatch.

2001 series:

1. Separate Stud and receptacle from runner.
2. Press receptacle into outer panel.
3. Press stud into receptacle.
4. Press and turn stud to latch
5. Turn stud 90 degree to unlatch

### Part Number

See table

200 Series: Order one receptacle and stud from the same size separately

2001 Series: Complete assembly supplied with runner attached as shown

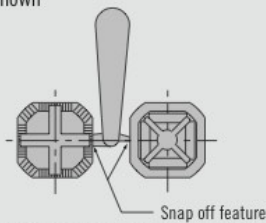

[www.southco.com/D7A](http://www.southco.com/D7A)

### 200 Series (order stud and receptacle separately)

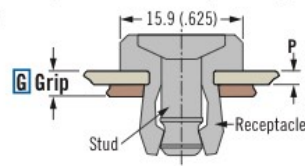
Locked

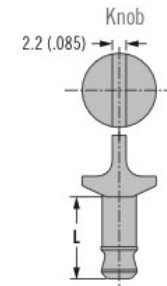
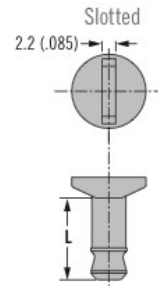
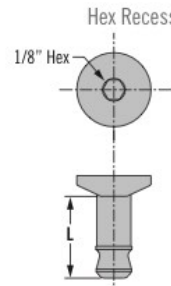
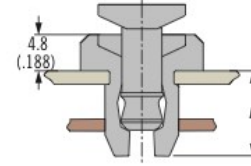

Released



### 2001 Series

Latched

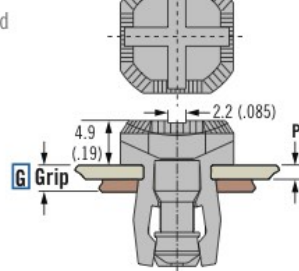

Unlatched

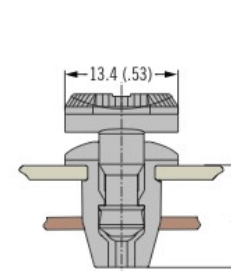

Installation

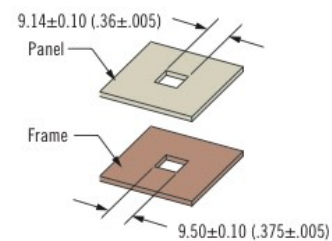
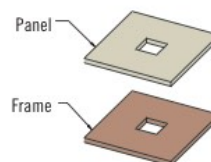

Series	A	Receptacle		Part Number	Grip Range		Stud		
		Panel Thickness			Min.	Max.	Hex recess	Slotted recess	Knob
		Min.	Max.						
200	12.3 (.48)	0.50 (.020)	1.78 (.070)	D7-200-802-010	2.03 (.080)	5.08 (.200)	D7-200-701-010	D7-200-711-010	D7-200-721-010
	13.7 (.54)	1.80 (.071)	3.10 (.125)	D7-201-802-010	3.43 (.135)	6.35 (.250)	D7-201-701-010	D7-201-711-010	D7-201-721-010
2001	12.0 (.47)	Complete Assembly			2.5 (.098)	6.7 (.263)	D7-2001-010		
		0.05 (.020)	1.7 (.067)	-					

Dimensions in millimeters (inch) unless otherwise stated

**DZUS®** | **southco®**  
CONNECT · CREATE · INNOVATE

# NY DZUS® Q-Latch Quarter-Turn Fasteners Assembly



433

## Latched

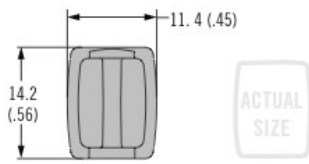

## Unlatched

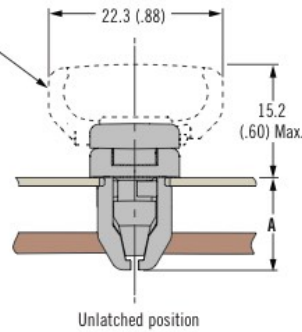
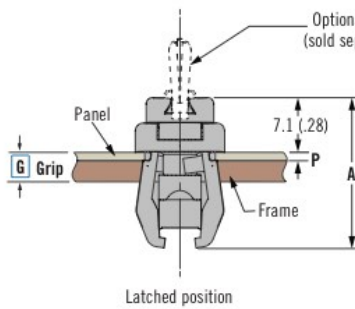

G	Grip Range		P Max.	A
	Min.	Max.		
1	1.50 (.059)	3.76 (.148)	1.0 (.042)	12.7 (.50)
2	1.93 (.076)	4.19 (.165)	1.5 (.057)	12.95 (.51)
3	3.00 (.118)	5.26 (.207)	2.5 (.098)	13.97 (.55)
4	4.62 (.182)	6.88 (.271)	4.1 (.162)	15.75 (.62)

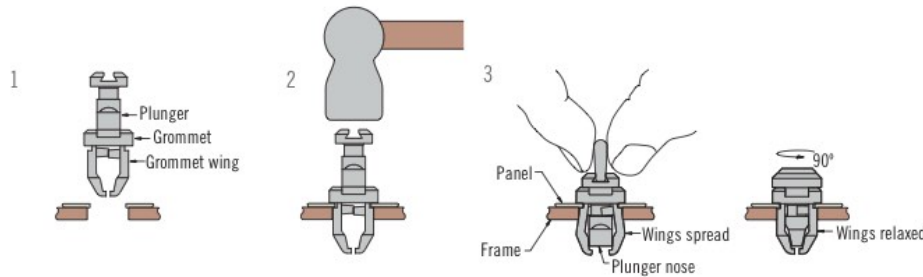
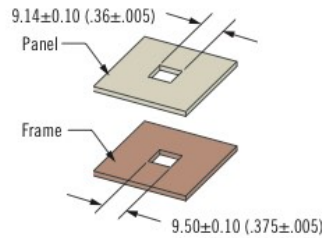

- Surface install
- Panel mounted assembly

### Material and Finish

Acetal copolymer resin, black

82

85

D8

D1

D4

D5

D7

NY



### NY Q-latch Installation notes

1. Insert assembly into outer panel.
2. Strike head of assembly to captivate assembly into outer panel.
3. Turn stud 90 degree to latch and unlatch.
4. Slide wing into slot

### Part Number Selection

Latch assembly shipped as one piece

Wing must be ordered separately

### Assembly

### Optional Wing (order separately)

NY - N6 - G - F

NY - H6 - F

- G** Grip range
- 1 1.50 - 3.76 (.059 - .148)
  - 2 1.93 - 4.19 (.076 - .165)
  - 3 3.00 - 5.26 (.118 - .207)
  - 4 4.62 - 6.88 (.182 - .271)

- F** Finish
- 10 Polycarbonate, white
  - 20 Polycarbonate, black
  - 30 Polysulfone, black
  - 31 Polysulfone, white



Dimensions in millimeters (inch) unless otherwise stated



[www.southco.com/NY4](http://www.southco.com/NY4)