

REVISION HISTORY			
REV	DATE	BY	DESCRIPTION
D	15FEB2021	ABK/VK	PRN: P2021-0313

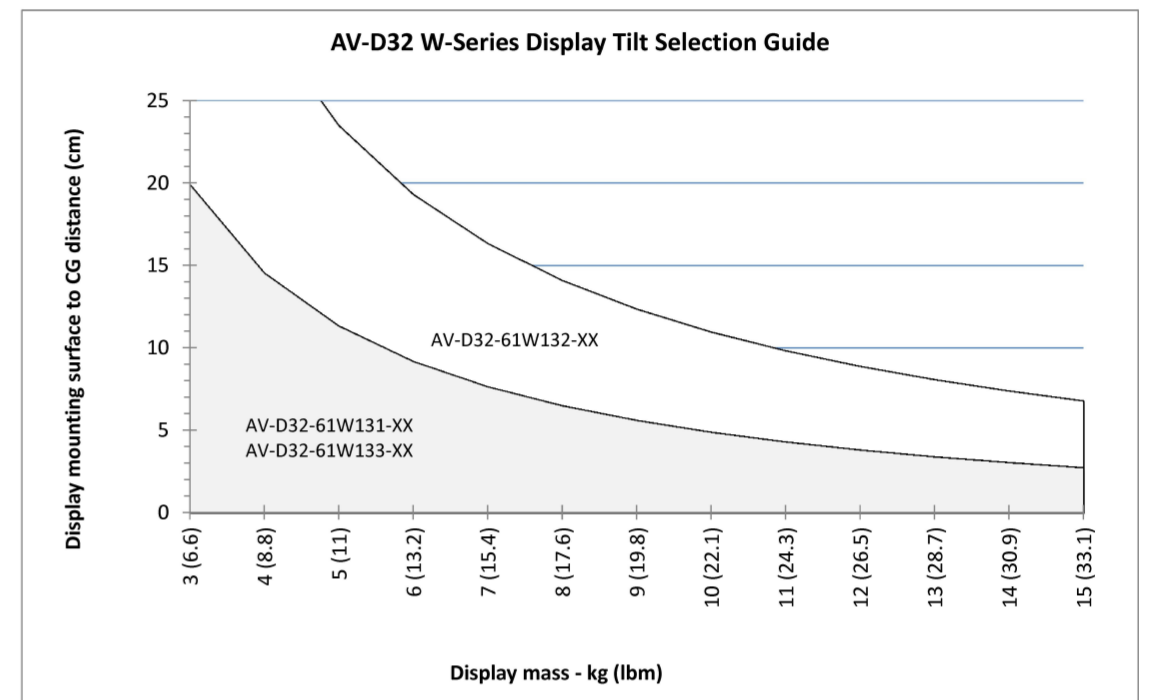
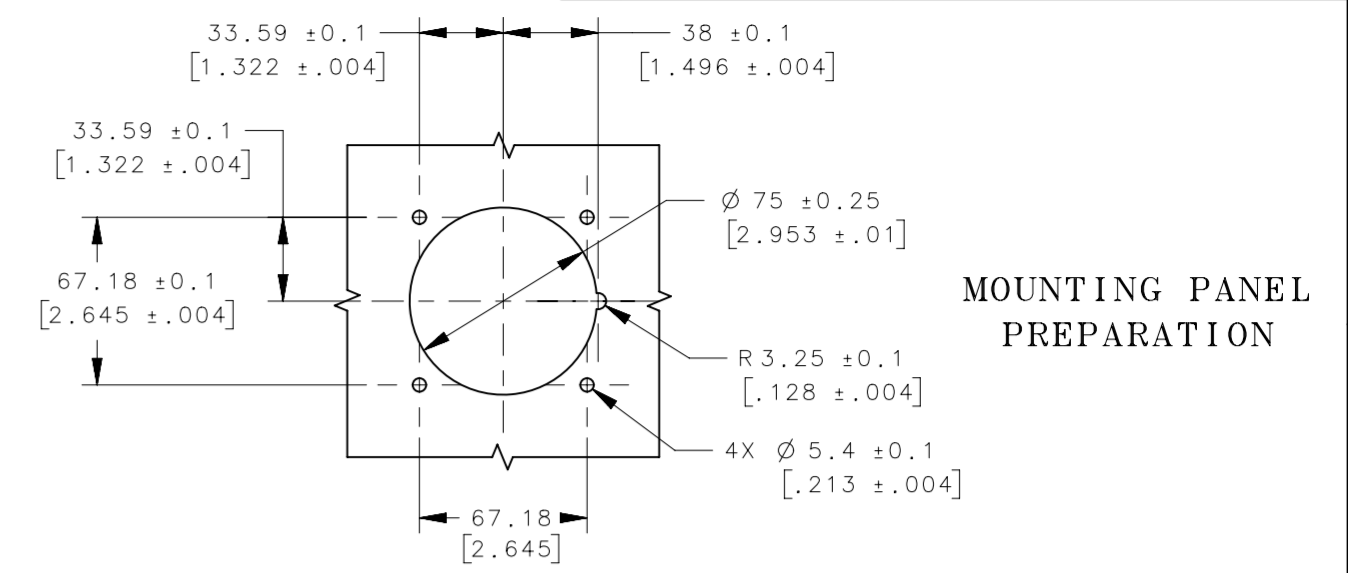
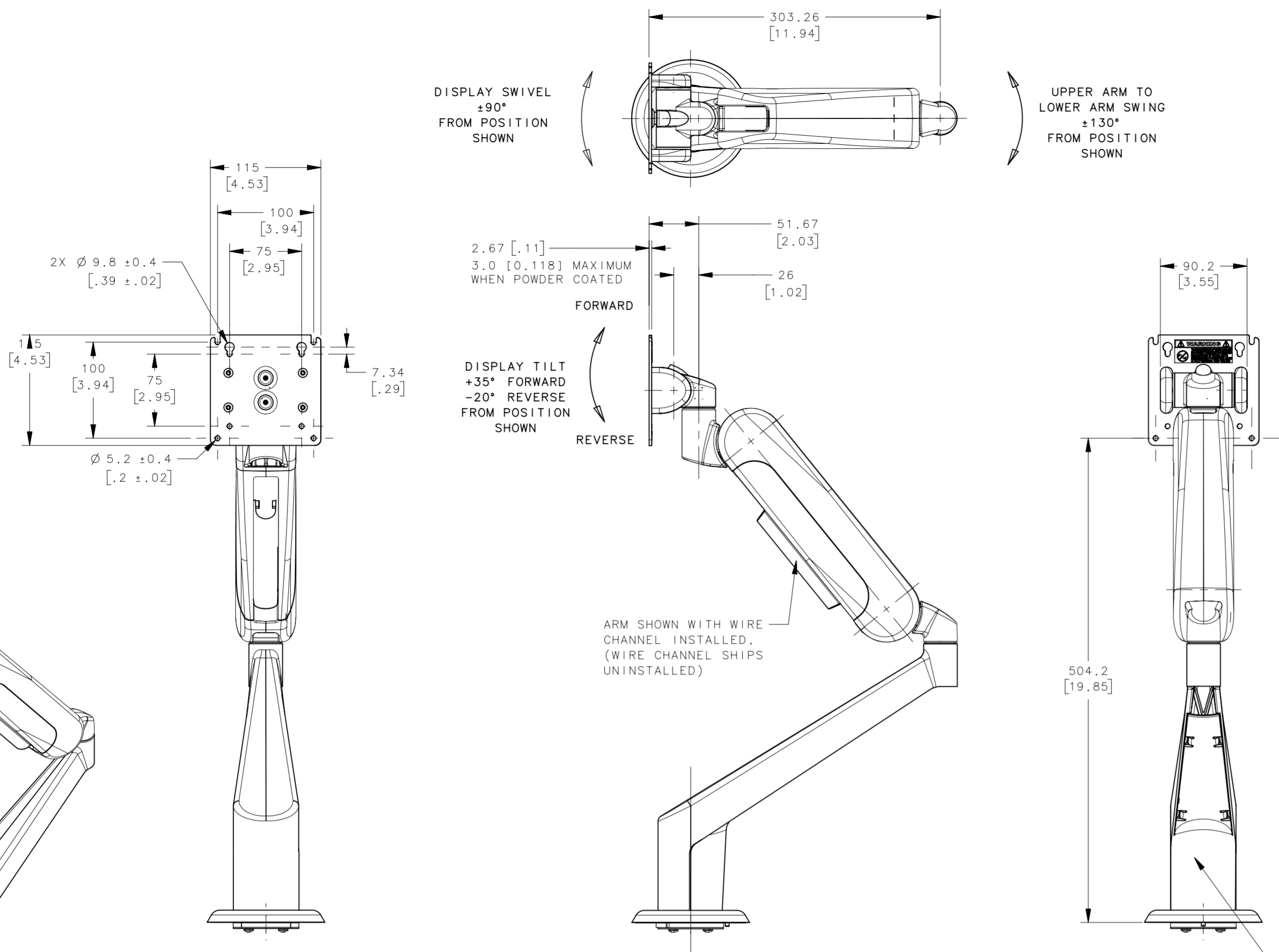

- NOTES:
- FINISH PER SOUTHCO COSMETIC SPECIFICATION S-121. ALL POWDER COATED EXTERIOR VISIBLE SURFACES CLASS C AND PLASTIC COVERS CLASS B.
  - TILT TORQUE MEASURE WITH DISPLAY MOUNTING PLATE IN THE VERTICAL 0° ± 5° POSITION WHEN TILTING IN THE REVERSE DIRECTION. THE TILT TORQUE VARIES WITH THE COUNTERBALANCE (WHEN EQUIPPED) IN THE FORWARD AND REVERSE DIRECTIONS.
  - THE DISPLAY MOUNTING PLATE TO TILT HOUSING ANGULAR FREE PLAY TO BE 1.5° MAXIMUM.
  - THE ARM IS ADJUSTABLE TO SUPPORT DISPLAYS OF WEIGHT WITHIN RANGE SPECIFIED IN THE TABLE BELOW. THE DISPLAY IS ADJUSTED BY USING A 5 mm HEX KEY IN THE TOP OF THE LOWER HOUSING. THIS IS ACCESSED BY LOWERING THE ARM POSITION WITH THE DISPLAY ATTACHED TO JUST BELOW THE HORIZONTAL POSITION. THE ADJUSTMENT SCREW IS TURNED CLOCKWISE FOR A LIGHTER DISPLAY AND COUNTERCLOCKWISE FOR HEAVIER DISPLAYS. THE ARM SHIPS WITH THE ADJUSTMENT FOR THE HEAVIEST DISPLAY. (SEE SHEET 2 OF 4)
  - MATERIALS AND FINISHES:  
 TILT ADAPTERS: DIE CAST ALUMINUM ANODIZED AND POWDER COATED  
 ARM, TILT HOUSING, UPPER KNUCKLE, LOWER KNUCKLE, AND ARM ADAPTER: DIE CAST ALUMINUM, POWDER COATED  
 TILT SLEEVE, THRUST WASHER, LOCK BASE, AND SHELL: ACETAL, BLACK  
 BASE WASHER: PTFE FILLED ACETAL, BROWN  
 O-RING: FLUOROCARBON RUBBER  
 COILED PIN: STEEL, PHOSPHATE COATED  
 TILT SHAFT, TORQUE ELEMENTS AND STOP WASHER: STEEL, NATURAL FINISH  
 TORSION SPRING: CARBON STEEL, NICKEL PLATED (WHEN EQUIPPED)  
 DISPLAY SCREWS AND RETAINERS: STEEL, BLACK OXIDE  
 DISPLAY STOPS: POLYETHYLENE, WHITE  
 LINK BUSHING AND STRUT ADJUST BUSHING: BRASS, NATURAL  
 LINK FLANGED SLEEVE: STEEL, TEFLON COATED  
 STRUT PIN: STEEL, NICKEL PLATED  
 BASE WASHER, STOP PIN, BASE PLATE: STAINLESS STEEL, PASSIVATED  
 STRUT ADJUST ADAPTER: ZINC, NICKEL PLATED  
 GAS SPRING: STEEL AND ZINC, PAINTED  
 ARM LINKS, STRUT BALL MOUNT: STEEL, ZINC PLATED  
 ARM PIVOT SHAFTS: STAINLESS STEEL AND NYLON  
 LINK PINS: STEEL, NICKEL PLATED  
 UPPER ARM COVERS, LOWER ARM COVER AND WIRE CHANNEL: PC/ABS  
 ESCUTCHEON: PC  
 LUBRICANT: HYDROCARBON BASE AND SILICONE BASE  
 INSIDE ARM COVERS: POLYAMIDE (NYLON)

**WARNING:**  
 TO REDUCE THE RISK OF INJURY MOVE ARM INTO HIGHEST POSITION BEFORE REMOVING DEVICE ATTACHED TO ARM. ARM TO REMAIN IN HIGHEST POSITION UNTIL DEVICE IS FULLY MOUNTED INTO THE ARM.

PART NUMBER	REVERSE TILT TORQUE N*m (lbf*in)	FORWARD TILT TORQUE N*m (lbf*in)	DISPLAY SWIVEL SYMMETRIC TORQUE N*m (lbf*in)	SYMMETRIC TORQUE TO MOVE UPPER ARM ASSEMBLY N*m (lbf*in)	SYMMETRIC TORQUE TO MOVE LOWER ARM ASSEMBLY N*m (lbf*in)	RECOMMENDED DISPLAY WEIGHT RANGE	COLOR
AV-D32-61W131-50	7.9 (70)	1.13 (10)	4.29 N*m (38 lbf*in) NOMINAL / 2.17 N*m (19.2 lbf*in) MINIMUM	6.0 N*m (53.1 lbf*in) NOMINAL / 4.2 N*m (37.1 lbf*in) MINIMUM	6.0 N*m (53.1 lbf*in) NOMINAL / 2.0 N*m (17.7 lbf*in) MINIMUM	2 To 7 kg (4.4 TO 15.4 lbm)	BLACK
OFFICE WHITE							
AV-D32-61W132-50	15.4 (136)	2.26 (20)	4.29 N*m (38 lbf*in) NOMINAL / 2.17 N*m (19.2 lbf*in) MINIMUM	6.0 N*m (53.1 lbf*in) NOMINAL / 4.2 N*m (37.1 lbf*in) MINIMUM	6.0 N*m (53.1 lbf*in) NOMINAL / 2.0 N*m (17.7 lbf*in) MINIMUM	5 TO 10 kg (11 TO 22 lbm)	BLACK
OFFICE WHITE							
AV-D32-61W133-50							BLACK
AV-D32-61W133-76	8.6 (76)	6.0 (53)	4.29 N*m (38 lbf*in) NOMINAL / 2.17 N*m (19.2 lbf*in) MINIMUM	6.0 N*m (53.1 lbf*in) NOMINAL / 4.2 N*m (37.1 lbf*in) MINIMUM	6.0 N*m (53.1 lbf*in) NOMINAL / 2.0 N*m (17.7 lbf*in) MINIMUM	2 To 7 kg (4.4 TO 15.4 lbm)	OFFICE WHITE
OFFICE WHITE							

THIRD ANGLE PROJECTION	
MILLIMETERS [IN]	
SURFACE AREA mm²	TOLERANCES UNLESS OTHERWISE NOTED
VOLUME mm³	DESCRIPTION: HINGE & CONTROLLED MOTION DEVICE STANDARD ARTICULATING NON-LOCKING DOUBLE ARM
PROPRIETARY ITEM EXCEPT FOR USES EXPRESSLY GRANTED IN WRITING, INFORMATION DISCLOSED HEREON IS CONFIDENTIAL AND ALL RIGHTS, PATENT AND OTHERWISE, ARE RESERVED BY SOUTHCO, INC.	SIZE SYSTEM: A2 NX DWG NO.: J-AV-D32-61W131
PER ASME Y14.5M-1994	DRAWN BY: GEA DATE: 22MAR2017 SCALE: 1:1 SHEET: 1 OF 4

8

7

6

5

4

3

2

1

REVISION HISTORY

REV	DATE	BY	DESCRIPTION
D	15FEB2021	ABK/VK	PRN: P2021-0313

### ARM DISPLAY WEIGHT ADJUSTMENT

(ARM TO BE ADJUSTED WITH DISPLAY MOUNTED)

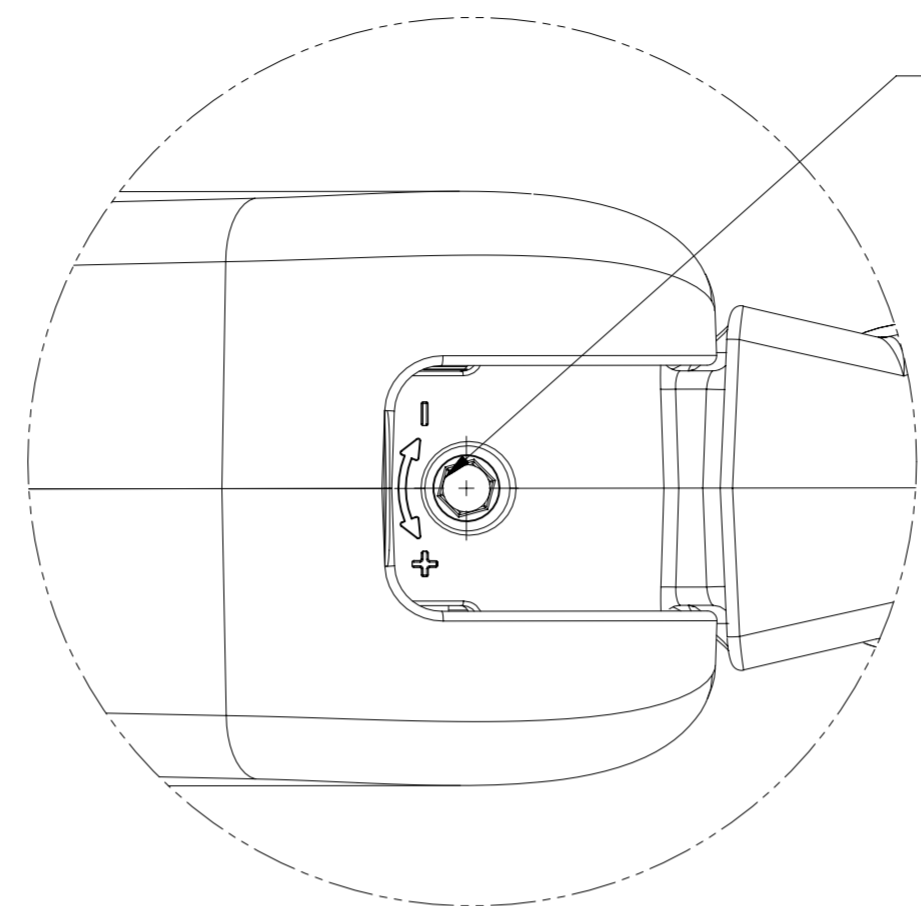

DISPLAY WEIGHT ADJUSTMENT  
5mm HEX RECESS FOR HEX KEY

- TURN SCREW CW (CLOCKWISE) TO DECREASE TENSION FOR A LIGHTER DISPLAY
- + TURN SCREW CCW (COUNTERCLOCKWISE) TO INCREASE TENSION FOR A HEAVIER DISPLAY

(NOTE: ADJUSTMENT IS EASIER IF ARM IS POSITIONED BELOW HORIZONTAL WITH THE DISPLAY ATTACHED)

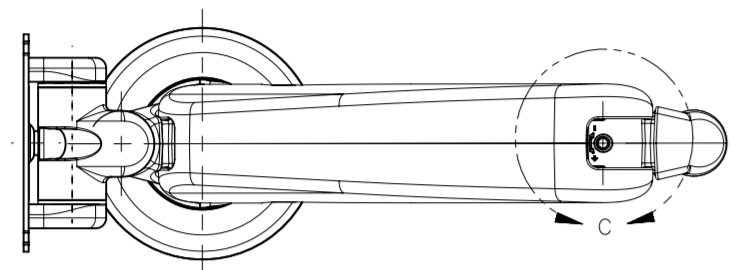

LOWEST ARM POSITION

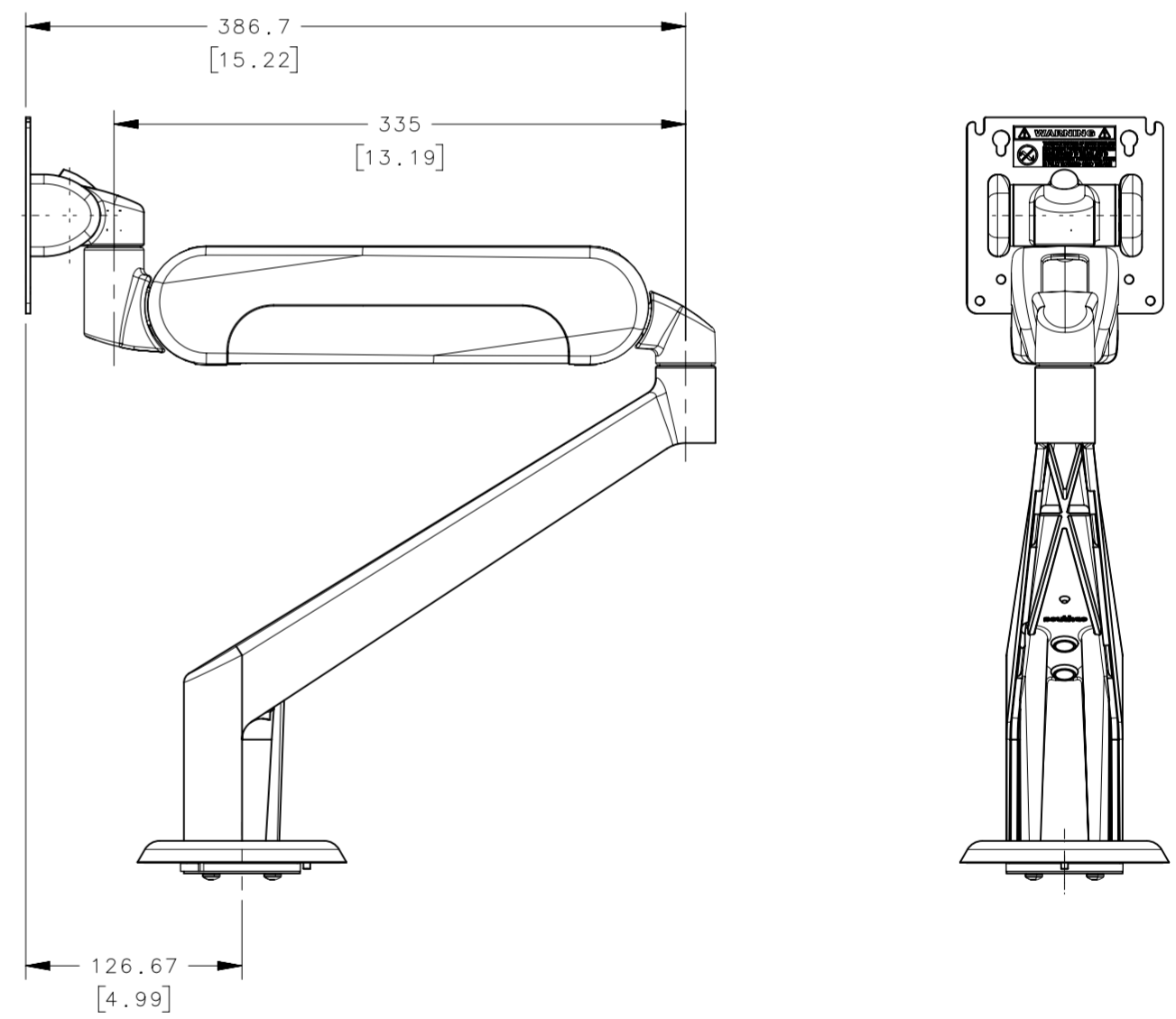

HORIZONTAL ARM POSITION

DETAIL C  
SCALE 5:4

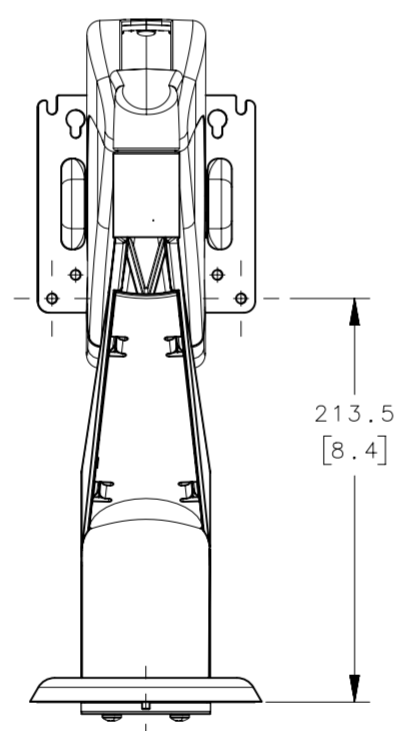
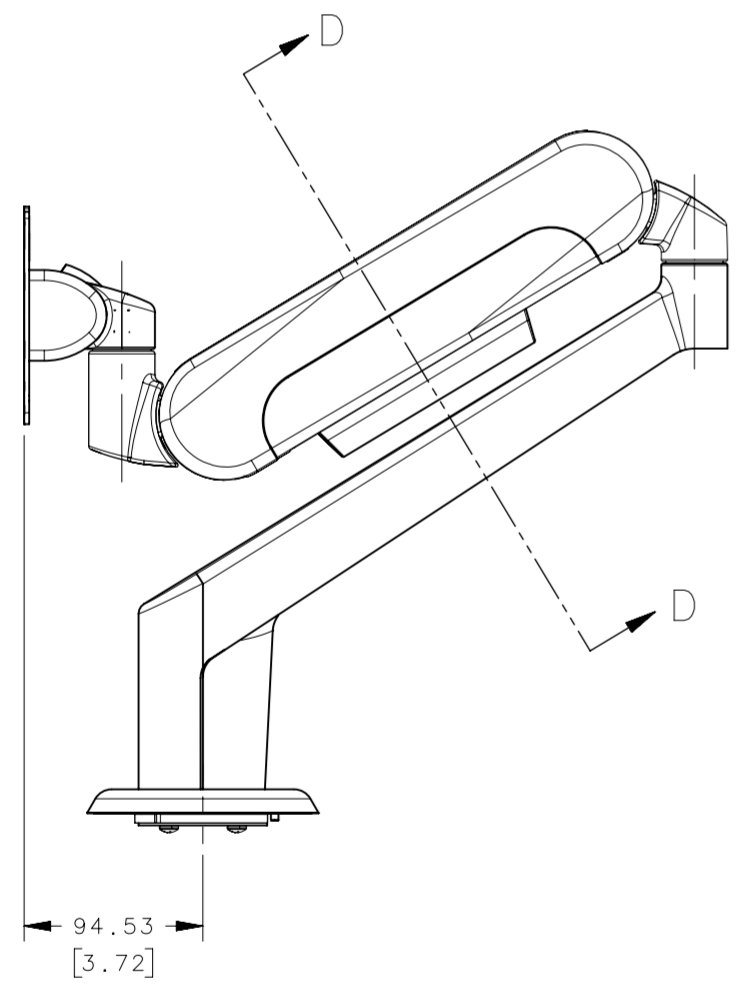

94.53  
[3.72]

213.5  
[8.4]

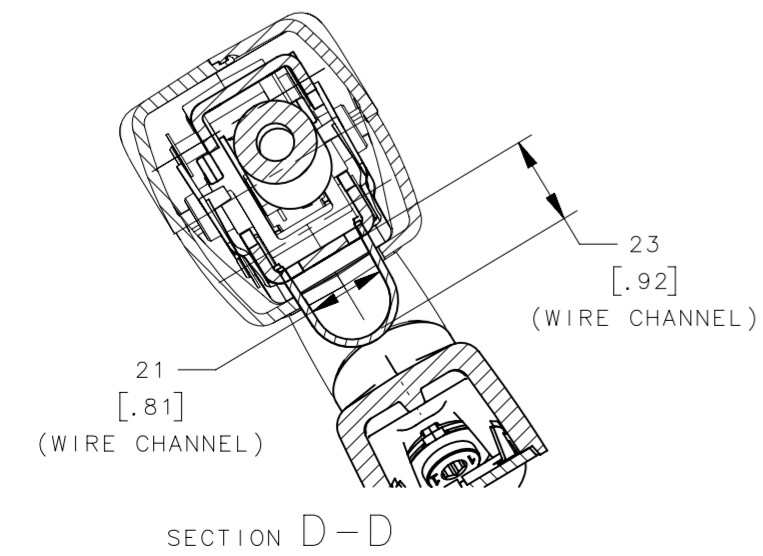

SECTION D-D

THIRD ANGLE PROJECTION				<b>southco</b> CONNECT · CREATE · INNOVATE	
MILLIMETERS [IN]					
SURFACE AREA		TOLERANCES UNLESS OTHERWISE NOTED		DESCRIPTION	
VOLUME		ALL DIMENSIONS WITHOUT TOLERANCES ARE FOR REFERENCE ONLY.		HINGE & CONTROLLED MOTION DEVICE STANDARD ARTICULATING NON-LOCKING DOUBLE ARM	
PROPRIETARY ITEM		PER ASME Y14.5M-1994		SIZE SYSTEM A2 NX DWG NO. J-AV-D32-61W131	
EXCEPT FOR USES EXPRESSLY GRANTED IN WRITING, INFORMATION DISCLOSED HEREON IS CONFIDENTIAL AND ALL RIGHTS, PATENT AND OTHERWISE, ARE RESERVED BY SOUTHCO, INC.		DRAWN BY GEA		DATE 22MAR2017 SCALE 1:1 SHEET 2 OF 4	

REVISION HISTORY			
REV	DATE	BY	DESCRIPTION
D	15FEB2021	ABK/VK	PRN: P2021-0313

REFER TO TABLE ON SHEET 1 FOR RECOMMENDED DISPLAY WEIGHT RANGE

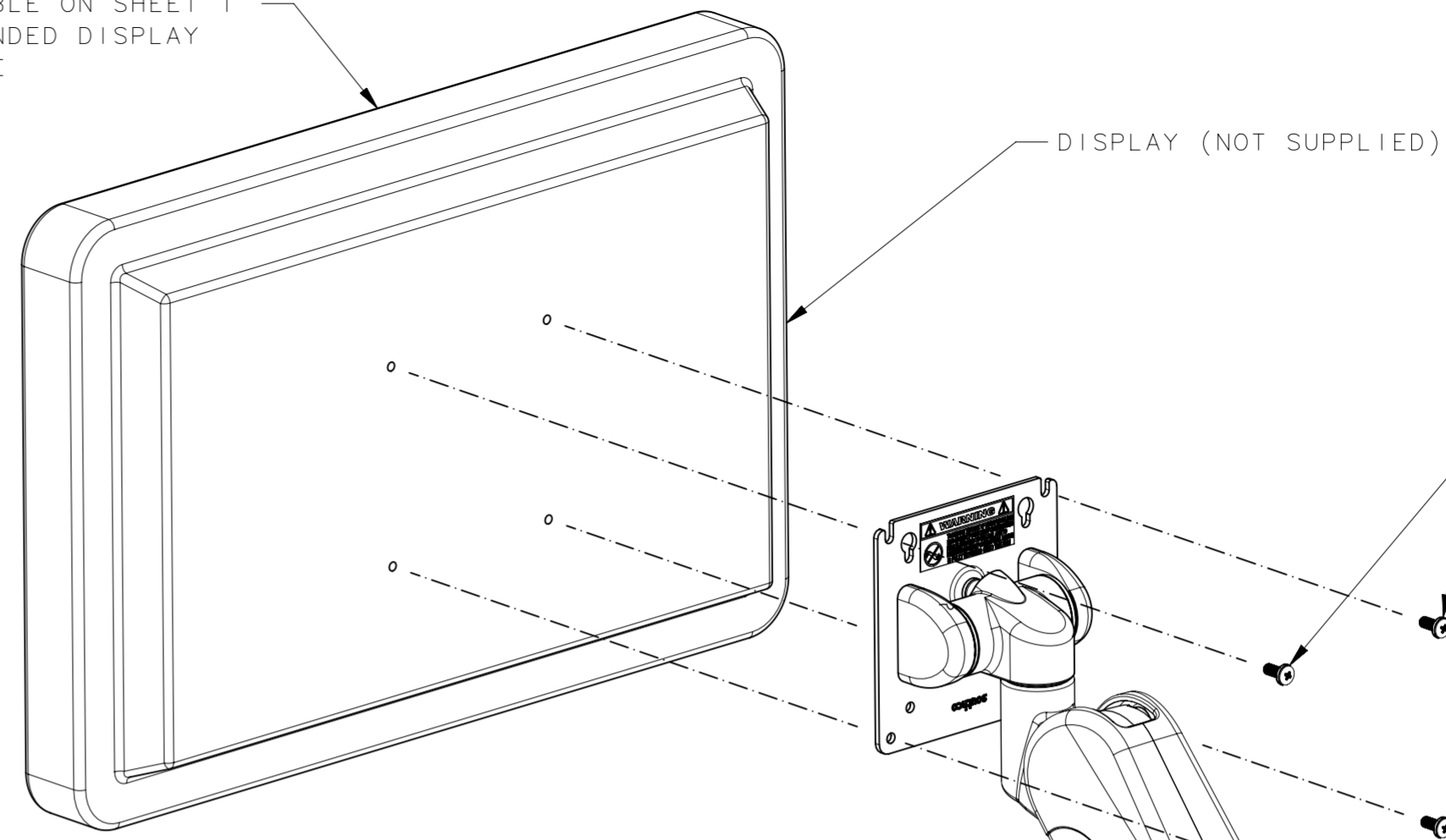

DISPLAY (NOT SUPPLIED)

DISPLAY MOUNTING HARDWARE (NOT SUPPLIED)

**INSTALL DISPLAY WITH THE ARM IN THE HIGHEST POSITION.**

NOTE: SEE SHEET 2 OF 4 FOR ARM ADJUSTMENT PROCEDURE TO ADJUST FOR WEIGHT OF DISPLAY WHEN INSTALLED.

M5 SCREWS OR HEX BOLTS (NOT SUPPLIED) WITH TAPPED PANEL OR USE HEX NUTS AS REQUIRED.

NOTE: ARM MOUNTING SCREWS MUST HAVE SUFFICIENT THREAD ENGAGEMENT TO SUPPORT ARM ASSEMBLY.

REMOVE LOWER ARM COVER, LIFT ESCUTCHEON UPWARD FROM ARM BASE TO ACCESS MOUNTING PLATE TO ATTACH ARM ASSEMBLY.

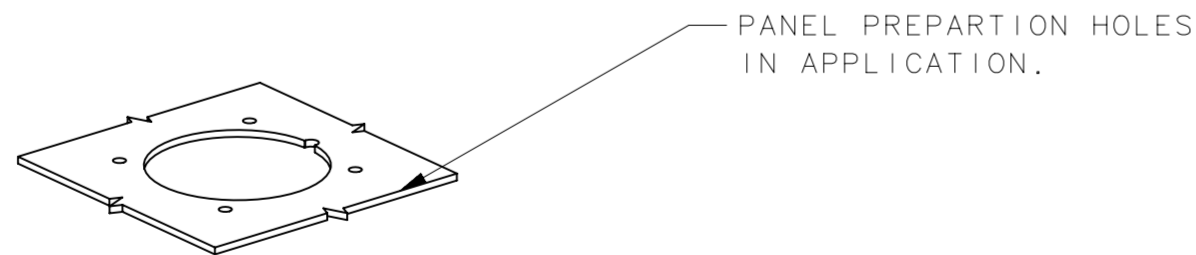

PANEL PREPARATION HOLES IN APPLICATION.

THIRD ANGLE PROJECTION		<b>southco</b> CONNECT · CREATE · INNOVATE	
MILLIMETERS [IN]			
SURFACE AREA mm <sup>2</sup>		DESCRIPTION	
VOLUME mm <sup>3</sup>		HINGE & CONTROLLED MOTION DEVICE	
PROPRIETARY ITEM		STANDARD ARTICULATING NON-LOCKING DOUBLE ARM	
EXCEPT FOR USES EXPRESSLY GRANTED IN WRITING, INFORMATION DISCLOSED HEREON IS CONFIDENTIAL AND ALL RIGHTS, PATENT AND OTHERWISE, ARE RESERVED BY SOUTHCO, INC.		SIZE SYSTEM A2 NX	DWG NO. J-AV-D32-61W131
PER ASME Y14.5M-1994		DRAWN BY GEA	DATE 22MAR2017
		SCALE 1:1	SHEET 3 OF 4

8

7

6

5

4

3

2

1

REVISION HISTORY			
REV	DATE	BY	DESCRIPTION
D	15FEB2021	ABK/VK	PRN: P2021-0313

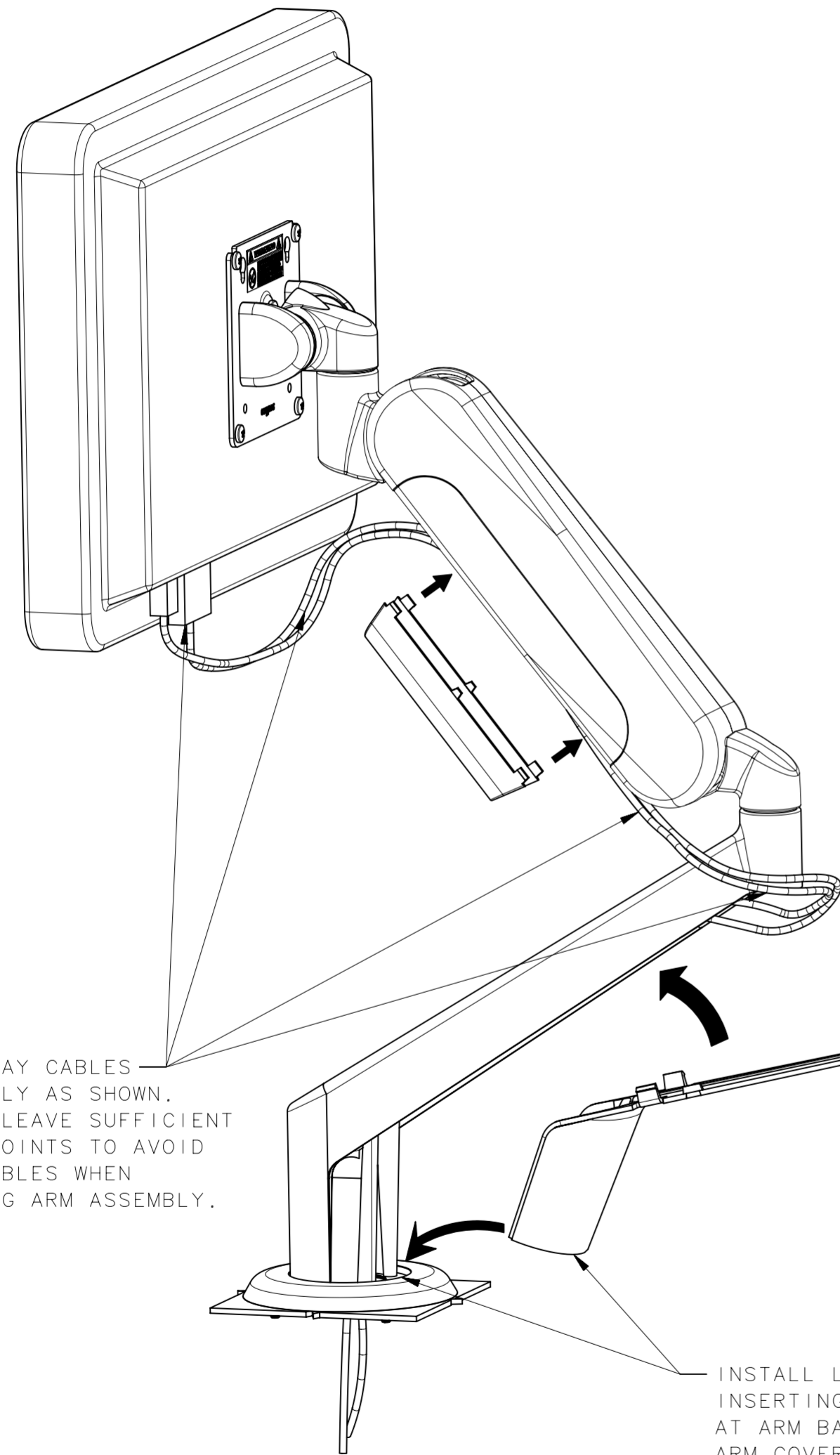

ROUTE DISPLAY CABLES APPROXIMATELY AS SHOWN. BE SURE TO LEAVE SUFFICIENT LENGTH AT JOINTS TO AVOID DAMAGING CABLES WHEN MANIPULATING ARM ASSEMBLY.

REMOVE LOWER ARM COVER BY PULLING DOWN ON THIS END TO DISENGAGE SNAP TABS FROM LOWER ARM.

INSTALL LOWER ARM COVER BY INSERTING THIS END INTO RECESS AT ARM BASE. THEN PIVOT LOWER ARM COVER UPWARD TO ENGAGE SNAP TABS INSIDE LOWER ARM.

TAB ON WIRE CHANNEL ENGAGES INTO SLOT ON BOTTOM OF LINK IN UPPER ARM ASSEMBLY.

TO REMOVE OR INSTALL WIRE CHANNEL, SQUEEZE SIDE WALLS AT EITHER END TO DISENGAGE OR ENGAGE THE SNAP TABS WITH THE SLOTS IN UPPER LINK.

THERE IS NO SPECIFIC ORIENTATION OF THE WIRE CHANNEL.

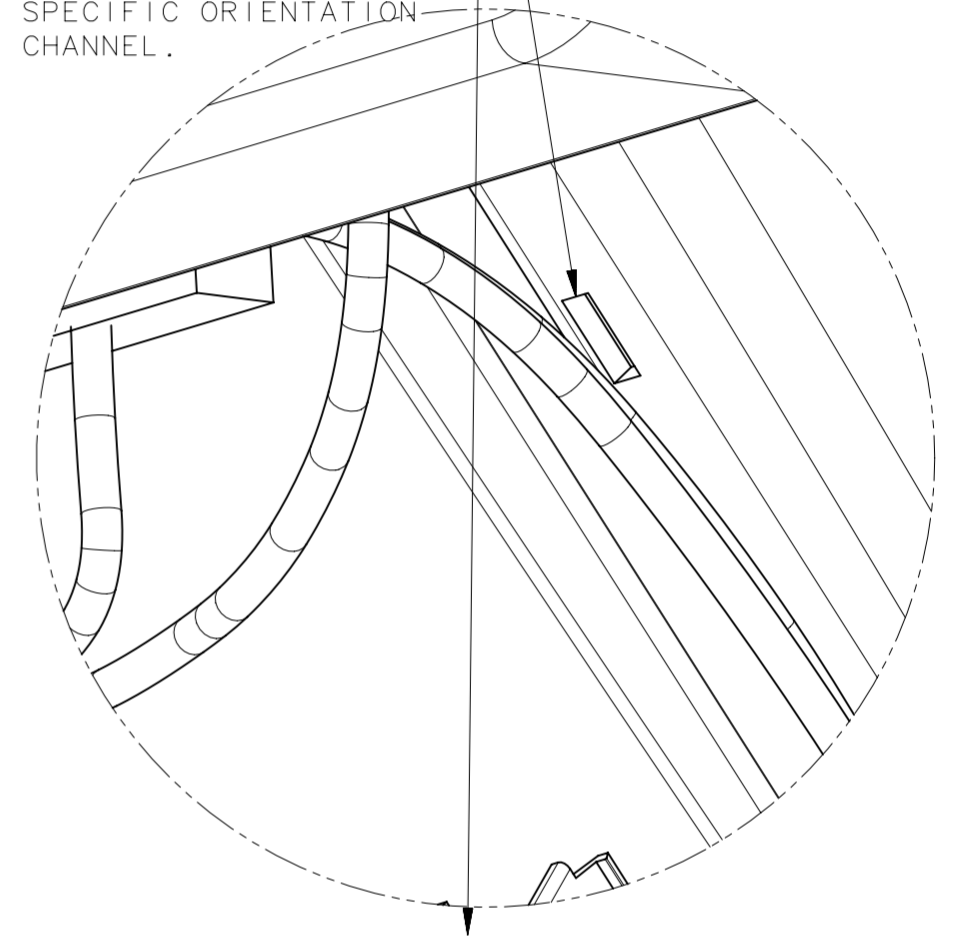

DETAIL B  
SCALE 4:3

THIRD ANGLE PROJECTION				<b>southco</b> CONNECT · CREATE · INNOVATE	
MILLIMETERS [IN]					
SURFACE AREA mm <sup>2</sup>		TOLERANCES UNLESS OTHERWISE NOTED		DESCRIPTION	
VOLUME mm <sup>3</sup>		ALL DIMENSIONS WITHOUT TOLERANCES ARE FOR REFERENCE ONLY.		HINGE & CONTROLLED MOTION DEVICE STANDARD ARTICULATING NON-LOCKING DOUBLE ARM	
PROPRIETARY ITEM		PER ASME Y14.5M-1994		SIZE SYSTEM A2 NX DWG NO. J-AV-D32-61W131	
EXCEPT FOR USES EXPRESSLY GRANTED IN WRITING, INFORMATION DISCLOSED HEREON IS CONFIDENTIAL AND ALL RIGHTS, PATENT AND OTHERWISE, ARE RESERVED BY SOUTHCO, INC.		DRAWN BY GEA		DATE 22MAR2017 SCALE 1:1 SHEET 4 OF 4	

8

7

6

5

4

3

2

1