

PROPRIETY ITEM - EXCEPT FOR USES EXPRESSLY GRANTED IN WRITING. INFORMATION DISCLOSED HEREON IS CONFIDENTIAL AND ALL RIGHTS PATENT AND OTHERWISE ARE RESERVED BY SOUTHCO, INC.

| REVISION RECORD | | | |
|-----------------|-----------------|--------|-----------|
| SYMB | DESCRIPTION | BY | DATE |
| H | PRN: P2015-0910 | MJS/SB | 12MAY2015 |

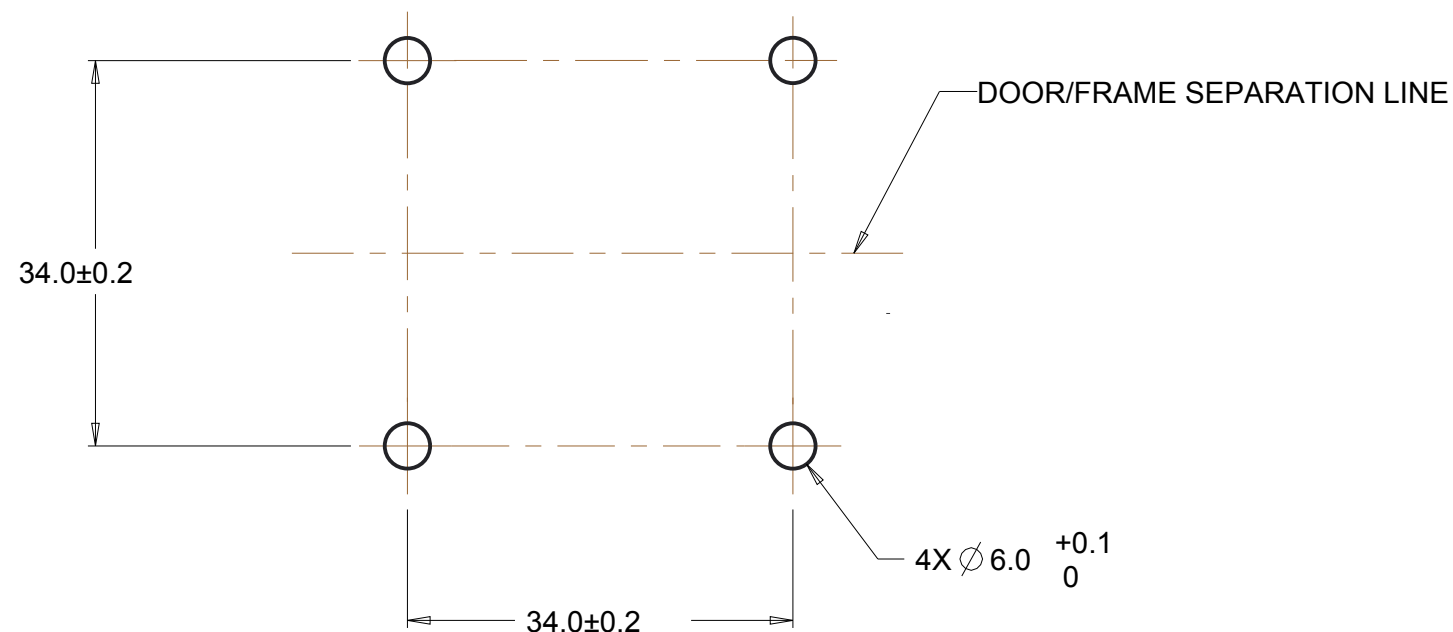

PANEL PREPARATION

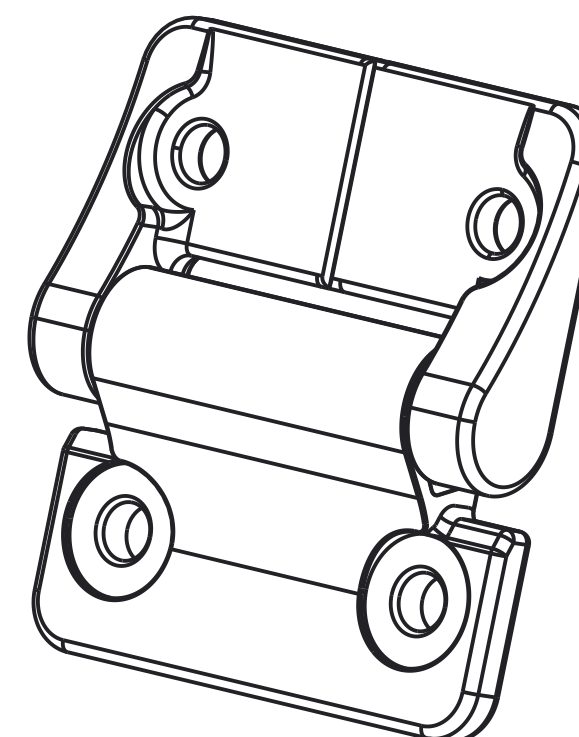
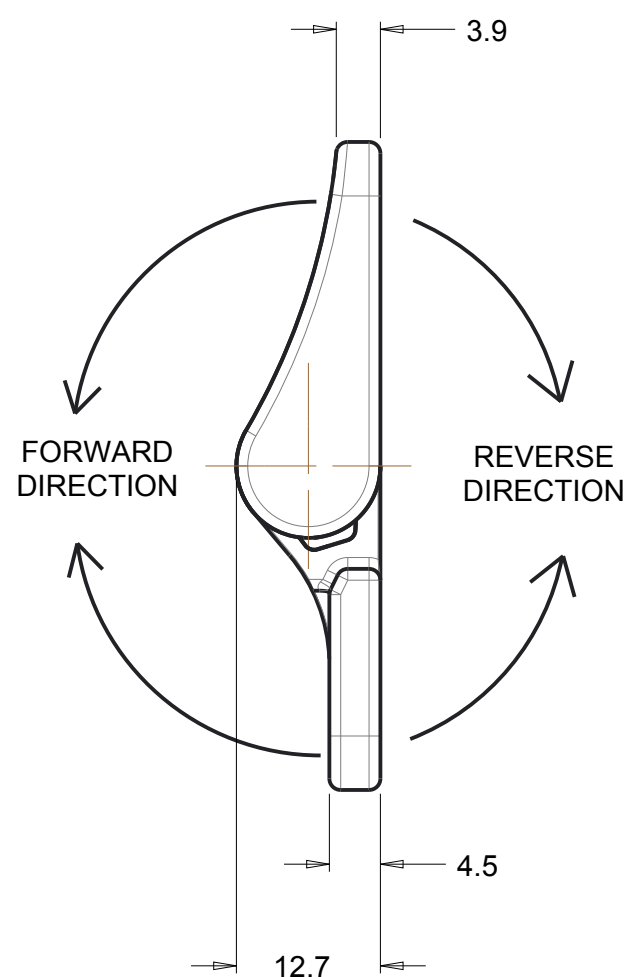
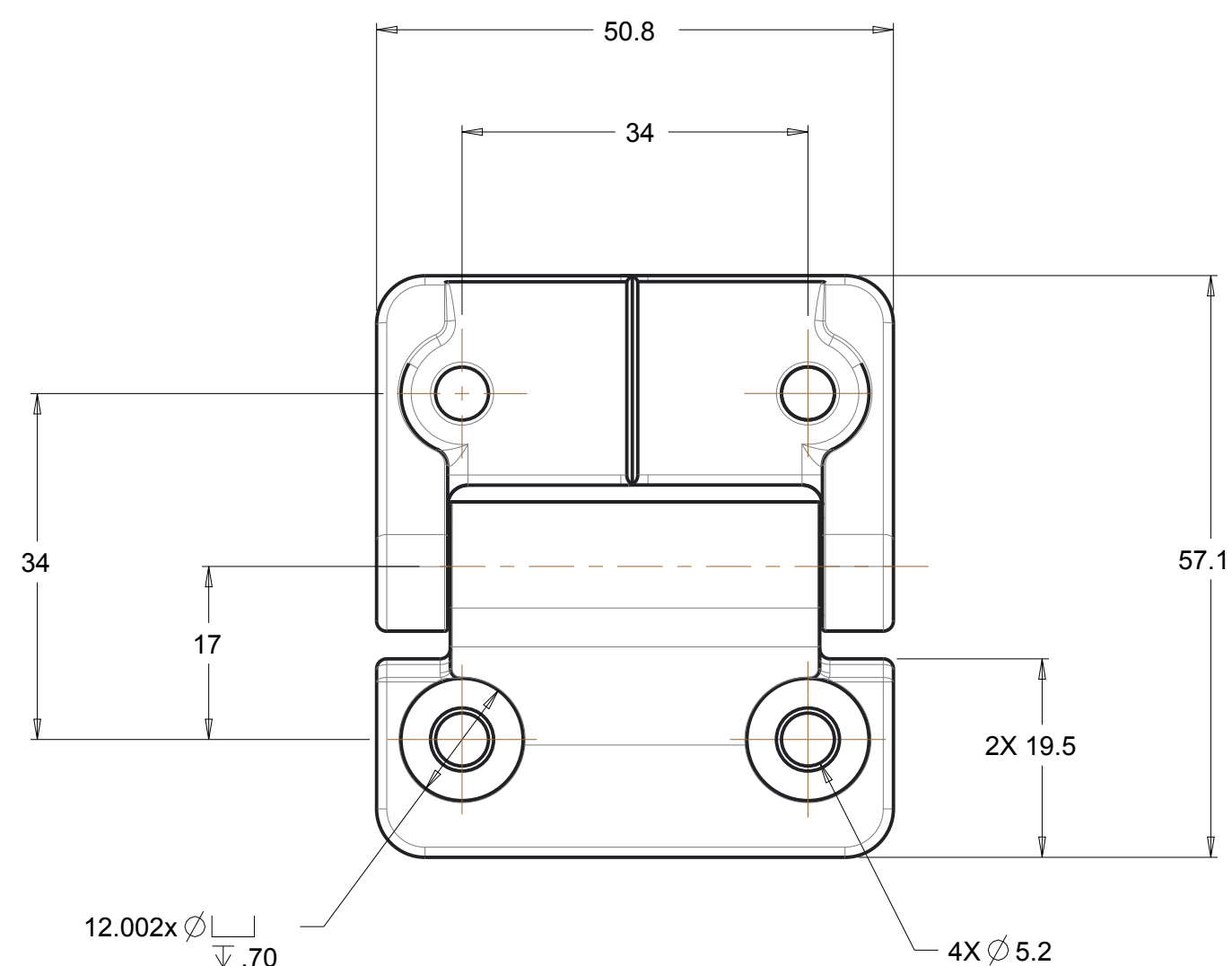

| PART NUMBER | FORWARD TORQUE | REVERSE TORQUE |
|---------------|-----------------------|-----------------------|
| E6-10-408-XX | 0.9 N-m (8.0 in-lbs) | |
| E6-10-416-XX | 1.8 N-m (16.0 in-lbs) | |
| E6-10-420-XX | 2.3 N-m (20.0 in-lbs) | |
| E6-10-430-XX | 3.4 N-m (30.0 in-lbs) | |
| E6-10-420F-XX | 2.3 N-m (20.0 in-lbs) | 1.5 N-m (13.6 in-lbs) |
| E6-10-430F-XX | 3.4 N-m (30.0 in-lbs) | 2.3 N-m (20.4 in-lbs) |
| E6-10-440F-XX | 4.5 N-m (40.0 in-lbs) | 3.1 N-m (27.3 in-lbs) |
| E6-10-420R-XX | 1.5 N-m (13.6 in-lbs) | 2.3 N-m (20.0 in-lbs) |
| E6-10-430R-XX | 2.3 N-m (20.4 in-lbs) | 3.4 N-m (30.0 in-lbs) |
| E6-10-440R-XX | 3.1 N-m (27.3 in-lbs) | 4.5 N-m (40.0 in-lbs) |

| PART NO. | DESCRIPTION | FINISH |
|---------------|--------------------|--------------|
| E6-10-4XXX-33 | ASSEMBLY - AS CAST | NATURAL |
| E6-10-4XXX-50 | ASSEMBLY - COATED | BLACK POWDER |

NOTES:

- PERFORMANCE TORQUE TOLERANCE ±20%
- DESIGNED TO ACCEPT M5 OR No. 10 SCREW OR EQUIVALENT
- MATERIAL AND FINISH:
HINGE LEAVES: DIE CAST ZINC, SEE TABLE FOR FINISH
SHAFT & PIN: STEEL
O-RINGS: BUNA-N RUBBER
BEARINGS: DIE CAST ZINC

| | | | | |
|--|-----------------------------|-------------------------------------|---------------------------------------|---------------|
| MILLIMETERS ALL DIMENSIONS WITHOUT TOLERANCES ARE FOR REFERENCE ONLY | southco | | TITLE E6 400 SERIES HINGE ASSEMBLY | |
| | DESIGNER AS 18AUG2006 | DRAFTER | DWG No J-E6-10-4-50 | REVISION H |
| | MODEL NAME E6-10-4XX-XX | SCALE 1.500 | MATERIAL SEE TABLE | |
| | ⊙ □ | 3.2 ALL SURFACES EXCEPT AS NOTED | CALC. WEIGHT | FORMAT C |