



PROPRIETARY ITEM - EXCEPT FOR USES EXPRESSLY GRANTED IN WRITING INFORMATION DISCLOSED HEREON IS CONFIDENTIAL AND ALL RIGHTS PATENT AND OTHERWISE ARE RESERVED BY SOUTHCO, INC.

AMC LIGHTPIPE BRACKET

DATE	DRAWN	CHKD	SCALE	DRAWING NUMBER
28AUG2006	TMS	XXX	1:1	J-P7-L-80

REV	DATE	DRAWN/CHKD	DESCRIPTION	PART NUMBER	MODULE SIZE	DIM. A	DIM. B
				P7-L-801	COMPACT	12.5	13.88
				P7-L-802	MID SIZE	17.6	18.96
				P7-L-803	FULL SIZE	27.6	28.95

MILLIMETERS

TOLERANCES UNLESS OTHERWISE NOTED

UP TO 0.5	±0.05
OVER 0.5 UP TO 6	±0.1
OVER 6 UP TO 30	±0.2
OVER 30	±0.3
ANGLES	±1°

THIRD ANGLE PROJECTION

A4 PAPER SIZE

NOTES:

- A. MATERIAL AND FINISH:
 - HOUSING: DIE CAST ZINC, ZINC PLATE CHROMATE DIP
 - LIGHTPIPE: POLYCARBONATE, UL V-0 RATED
 - THIS ASSEMBLY IS RoHS COMPLIANT
- B. BRACKET MEETS SOUTHCO COSMETIC SPECIFICATION
 S-121-02 CLASS C (HOUSING)
 S-121-04 CLASS A (LIGHT PIPE)
- C. ALL PANEL PREPARATION TOLERANCES TO BE ±0.1
- D. BRACKET MEETS REQUIREMENTS OF PICMG AMC.0 R1.0

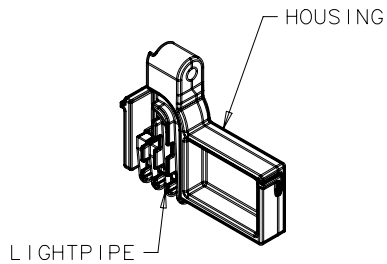

FACEPLATE PREPERATION

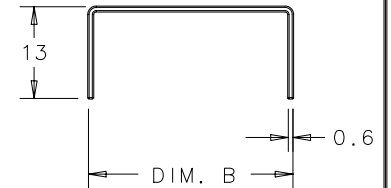

PRINTED CIRCUIT BOARD COMPONENT SIDE 2

