

ACCESS HARDWARE

MAGNETIC CABINET LATCH - RING STYLE

- 316 stainless steel and nylon
- Simple operation - insert finger into stainless steel ring hole and pull to open
- Suitable for both cabinets and drawers
- Low closing force required.

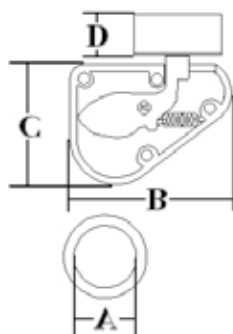

Part No	Model	A mm	B mm	C mm	D mm
M5-73-100-8	Right	25 (1")	70 (2 3/4")	53 (2")	16 (5/8")
M5-73-200-8	Left	25 (1")	70 (2 3/4")	53 (2")	16 (5/8")

MAGNETIC CABINET LATCH - KNOB STYLE

- 316 stainless steel and nylon
- Turn knob to open
- Low closing force required
- Three knob styles available – round, oval and finger
- Suitable for both cabinets and drawers

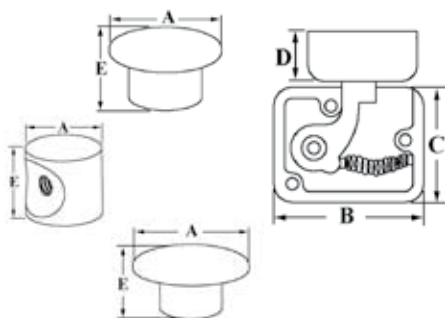

Part No	Knob	A mm	B mm	C mm	D mm	E mm
M5-74-100-8	Round	23 (7/8")	48 (1 7/8")	37 (1 1/2")	16 (5/8")	14 (9/16")
M5-74-200-8	Finger	20 (13/16")	48 (1 7/8")	37 (1 1/2")	16 (5/8")	18 (11/16")
M5-74-300-8	Oval	28 (1 1/8")	48 (1 7/8")	37 (1 1/2")	16 (5/8")	14 (9/16")

MAGNETIC DOOR & WINDOW HOLDER - STAINLESS STEEL

- 316 stainless steel
- Holder can be adjusted to any desired angle
- Magnet shrouded in stainless steel to withstand the marine environment
- Available with various holding power

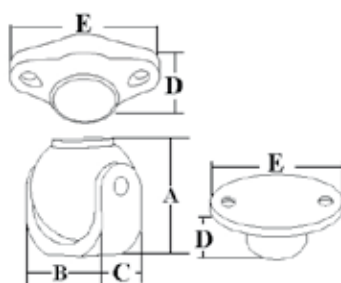

Part No	Mag. Size		A mm	B mm	C mm	D mm	E mm	Holding Power
	Ball	Strike						
M5-70-051-8	20x15	Proud 20x10	34 (1 5/16")	34 (1 5/16")	19 (3/4")	15 (19/32")	46 (1 13/16")	3.5Kgs
M5-70-052-8	20x15	Proud 30x15	34 (1 5/16")	34 (1 5/16")	19 (3/4")	19 (3/4")	70 (2 3/4")	5.4Kgs
M5-70-054-8	20x15	Flush 30x15	34 (1 5/16")	34 (1 5/16")	19 (3/4")	19 (3/4")	57 (2 1/8")	5.4Kgs
M5-70-072-8	30x15	Proud 30x15	48 (1 29/32")	48 (1 29/32")	27 (1 3/32")	19 (3/4")	70 (2 3/4")	10.6Kgs
M5-70-053-8	20x15	Flush 20x10	34 (1 5/16")	34 (1 5/16")	19 (3/4")	13 (9/16)	57 (2 3/16)	3.8Kgs