

Swivel and fixed castors

welded steel heavy-duty version



Material:

Housing solid welded steel construction. Wheels with welded steel body and Extrathane® tread.

Version:

The housing is a rugged welded steel construction. Swivel castor housing with DIN 711 axial groove ball bearing and DIN 720 tapered roller bearing in the swivel head. Dust and splash-proof, with grease nipple. Precision ball bearings in the wheels.

Sample order:

nlm 95032-20050

Note:

Centre pin welded in, bolted and secured. Wheel axle bolted.

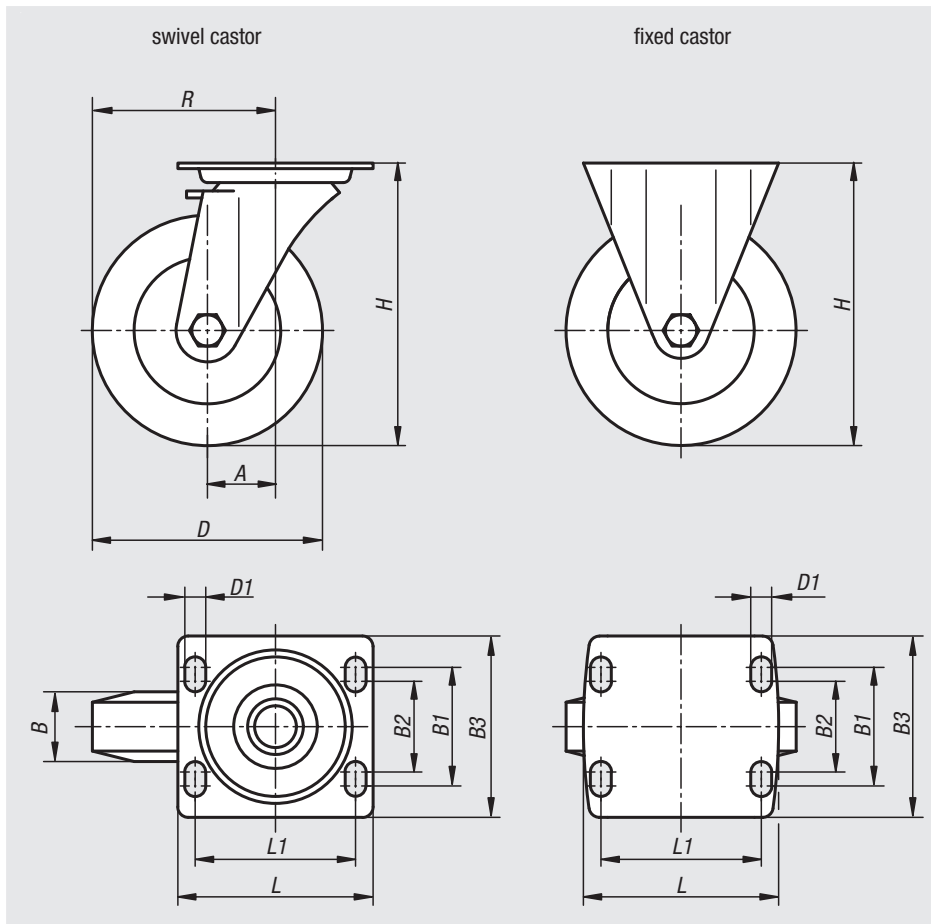

swivel head bearing

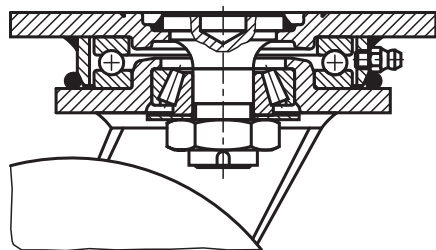

| Order No. Fixed Castor without locking system | Order No. Swivel Castor without locking system | Order No. Swivel Castor with stop-top locking system | Wheel bearing | A | B | B1 | B2 | B3 | D | D1 |
|---|--|--|---------------|---------|----|-----|----|-----|-----|----|
| 95032-160501 | 95032-16050 | 95032-160502 | ball bearing | -/55/55 | 50 | 80 | 75 | 110 | 160 | 11 |
| 95032-200501 | 95032-20050 | 95032-200502 | ball bearing | -/60/60 | 50 | 80 | 75 | 110 | 200 | 11 |
| 95032-250601 | 95032-25060 | 95032-250602 | ball bearing | -/75/75 | 60 | 105 | - | 140 | 250 | 14 |

| Order No. Fixed Castor without locking system | Order No. Swivel Castor without locking system | Order No. Swivel Castor with stop-top locking system | Wheel bearing | H | L | L1 | R | Permissible load kg |
|---|--|--|---------------|-----|-----|-----|-----------|---------------------|
| 95032-160501 | 95032-16050 | 95032-160502 | ball bearing | 205 | 140 | 105 | -/135/135 | 700 |
| 95032-200501 | 95032-20050 | 95032-200502 | ball bearing | 245 | 140 | 105 | -/160/160 | 1000 |
| 95032-250601 | 95032-25060 | 95032-250602 | ball bearing | 305 | 175 | 140 | -/200/200 | 1350 |

41000
80000
82000
83000
84000
85000
95000
96000
97000
A-Z