

# Probe inserts hardened steel

thread M2.5

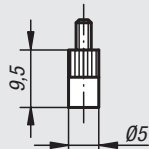

Steel, hardened  
flat Ø5



Order No.

33058-015

Steel, hardened  
flat Ø7.5

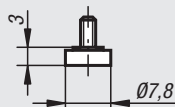

Order No.

33058-020

Steel, hardened  
flat Ø15

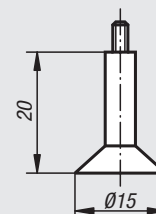

Order No.

33058-025

Steel, hardened  
disc Ø15

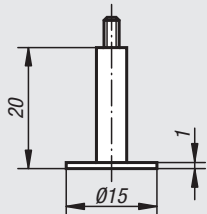

Order No.

33058-030

Steel, hardened  
pin Ø1

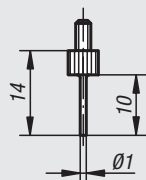

Order No.

33058-035

Steel, hardened  
pin Ø2

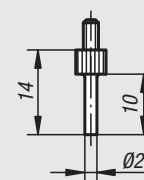

Order No.

33058-040

Steel, hardened  
ball Ø2

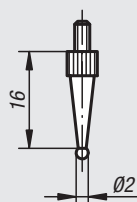

Order No.

33058-045

Steel, hardened  
ball Ø5

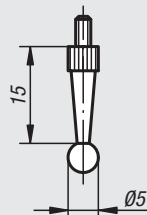

Order No.

33058-050

Steel, hardened  
ball Ø10

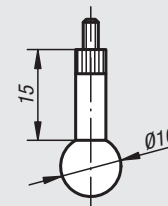

Order No.

33058-055

Steel, hardened  
domed R12

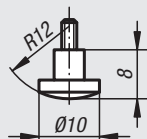

Order No.

33058-060

Steel, hardened  
knife  
angled 10°

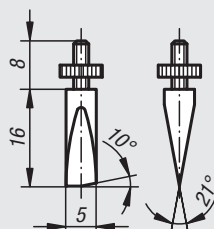

Order No.

33058-065

Steel, hardened  
knife  
laterally off-set

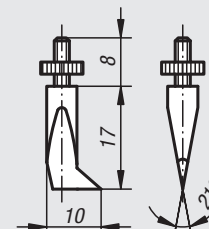

Order No.

33058-070

Steel, hardened  
knife  
one-sided

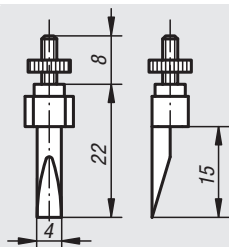

Order No.

33058-075

Steel, hardened  
knife

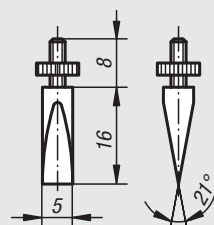

Order No.

33058-080

Steel, hardened  
point 60°

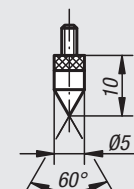

Order No.

33058-085

Steel, hardened  
standard inch  
ball Ø 1/8"

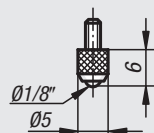

Order No.

33058-090

# Probe inserts carbide

thread M2.5



Carbide  
flat Ø5

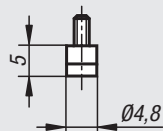

Order No.  
33058-515

Carbide  
domed R5

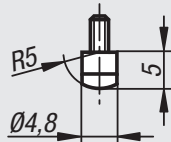

Order No.  
33058-520

Carbide  
flat Ø10

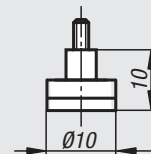

Order No.  
33058-525

Carbide  
domed R10

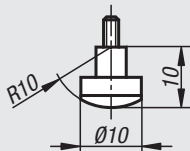

Order No.  
33058-530

Carbide  
blade 1x4

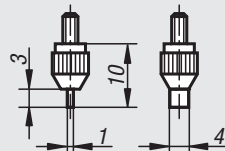

Order No.  
33058-540

Carbide  
knife 25°x4

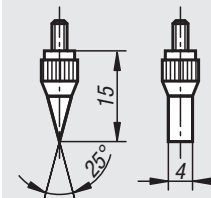

Order No.  
33058-545

Carbide  
pin Ø0,45

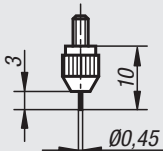

Order No.  
33058-550

Carbide  
pin Ø1.0

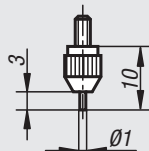

Order No.  
33058-555

Carbide  
pin Ø1.5

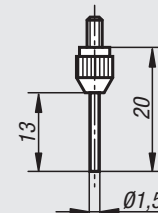

Order No.  
33058-560

Carbide  
flat Ø2

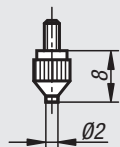

Order No.  
33058-565

Carbide  
point 90°x2

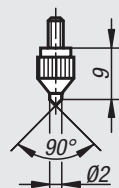

Order No.  
33058-570

Carbide  
standard inch  
ball Ø1/8"

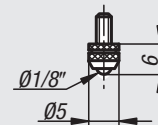

Order No.  
33058-575