

# Levelling feet

with hex. base



**Material:**

Polyethylene.  
Screw, steel.

**Version:**

Black.  
Screw electro zinc-plated.

**Sample order:**

nIm 27796-2006X020  
(include length L)

**Note:**

Levelling feet with hexagonal base. Rigid version.

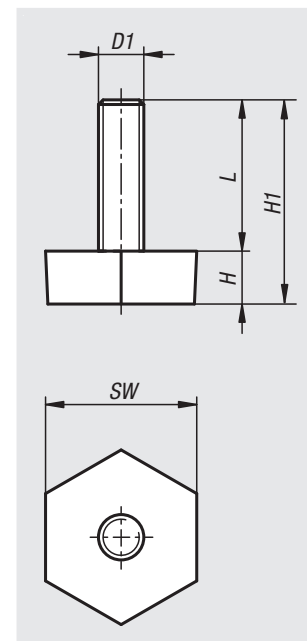

Order No.	D1	H	H1	SW	L	Load rating max. kN (static load only)
27796-2006X	M6	7	27/37/47/57	20	20/30/40/50	1,5
27796-2008X	M8	7	27/37/47/57	20	20/30/40/50	3
27796-2506X	M6	7,5	27,5/37,5/47,5/57,5	25	20/30/40/50	1,5
27796-2508X	M8	7,5	27,5/37,5/47,5/57,5	25	20/30/40/50	3
27796-2510X	M10	7,5	27,5/37,5	25	20/30	4
27796-3008X	M8	8	28/38/48/58	30	20/30/40/50	3
27796-3010X	M10	8	28/38	30	20/30	3