

# Gas springs

stainless steel

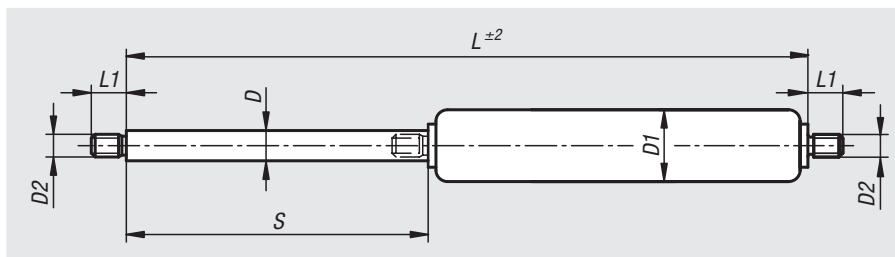
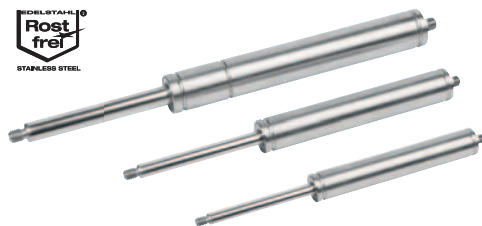

## Material:

Piston rod, stainless steel 1.4305.  
Pressure tube, stainless steel 1.4301.  
Filling medium: oil, nitrogen.

## Version:

Piston rod and pressure pipe, bright.

## Sample order:

nIm 26201-0615040X100  
(include extension force F1)

## Note:

Individual filled gas springs are excluded from replacement  
Gas springs are maintenance-free, self-contained systems that are filled with nitrogen under high pressure. There is also an internal defined quantity of oil for end position damping and lubrication purposes. The gas springs contain a check valve in the grub screw of the pressure pipe which enables the extension force to be subsequently reduced.

The gas springs must be stored and mounted with the piston rod extending downwards.

The physical properties that apply when a gas spring is being filled result in a tolerance range of  $\pm 5\%$  for the rated extension force.

Gas springs are filled with nitrogen under high pressure and under no circumstances should they be opened or overloaded.

## On request:

Other extension forces.

Potential extension force F1 (min.–max.)

Size 06/15: 40–400 N

Size 08/19: 50–700 N

Size 10/23: 100–1200 N

Size 14/28: 200–2500 N

## Accessories:

See adjacent illustration for connectors and hardware.

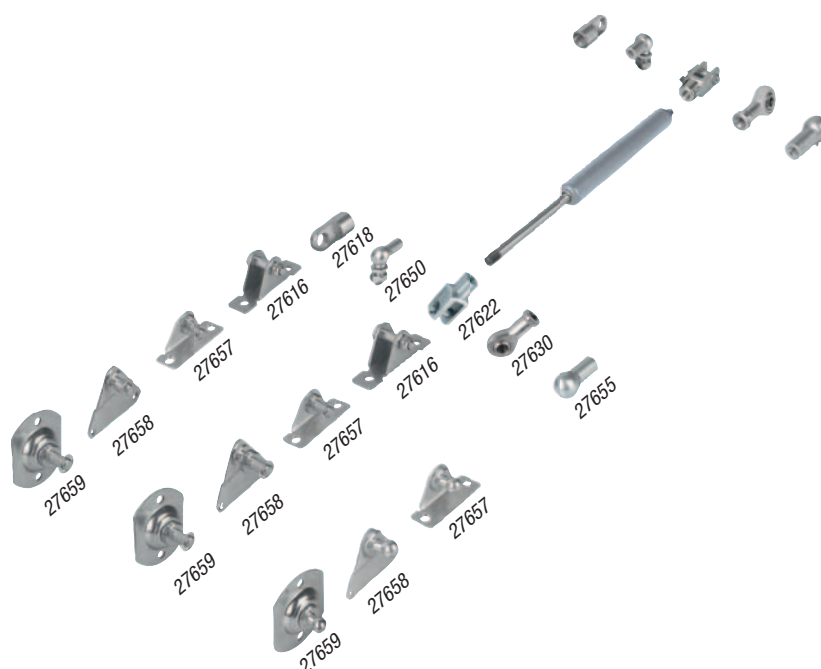

## Gas springs

stainless steel

Order No.	Size	D	D1	D2	Travel S	L	L1	Progression %	Extension force F1 N
26201-0615040X	06/15	6	15	M5	40	135	7	25	100/150/200/250/300/350/400
26201-0615050X	06/15	6	15	M5	50	155	7	25	100/150/200/250/300/350/400
26201-0615060X	06/15	6	15	M5	60	175	7	25	100/150/200/250/300/350/400
26201-0615080X	06/15	6	15	M5	80	215	7	25	100/150/200/250/300/350/400
26201-0615100X	06/15	6	15	M5	100	255	7	25	100/150/200/250/300/350/400
26201-0615120X	06/15	6	15	M5	120	295	7	25	100/150/200/250/300/350/400
26201-0615150X	06/15	6	15	M5	150	355	7	25	100/150/200/250/300/350/400
26201-0819060X	08/19	8	19	M8	60	190	10	30	100/150/200/250/300/350/400/500/600/700
26201-0819080X	08/19	8	19	M8	80	230	10	30	100/150/200/250/300/350/400/500/600/700
26201-0819100X	08/19	8	19	M8	100	270	10	30	100/150/200/250/300/350/400/500/600/700
26201-0819120X	08/19	8	19	M8	120	310	10	30	100/150/200/250/300/350/400/500/600/700
26201-0819150X	08/19	8	19	M8	150	370	10	30	100/150/200/250/300/350/400/500/600/700
26201-0819160X	08/19	8	19	M8	160	390	10	30	100/150/200/250/300/350/400/500/600/700
26201-0819180X	08/19	8	19	M8	180	430	10	30	100/150/200/250/300/350/400/500/600/700
26201-0819200X	08/19	8	19	M8	200	470	10	30	100/150/200/250/300/350/400/500/600/700
26201-0819220X	08/19	8	19	M8	220	510	10	30	100/150/200/250/300/350/400/500/600/700
26201-0819250X	08/19	8	19	M8	250	570	10	30	100/150/200/250/300/350/400/500/600/700
26201-1023050X	10/23	10	23	M8	50	170	10	30	150/200/250/300/350/400/500/600/700/800
26201-1023060X	10/23	10	23	M8	60	190	10	30	150/200/250/300/350/400/500/600/700/800
26201-1023080X	10/23	10	23	M8	80	230	10	30	150/200/250/300/350/400/500/600/700/800
26201-1023100X	10/23	10	23	M8	100	270	10	30	150/200/250/300/350/400/500/600/700/800
26201-1023150X	10/23	10	23	M8	150	370	10	30	150/200/250/300/350/400/500/600/700/800
26201-1023200X	10/23	10	23	M8	200	470	10	30	150/200/250/300/350/400/500/600/700/800
26201-1023250X	10/23	10	23	M8	250	570	10	30	150/200/250/300/350/400/500/600/700/800
26201-1023300X	10/23	10	23	M8	300	670	10	30	150/200/250/300/350/400/500/600/700/800
26201-1023350X	10/23	10	23	M8	350	770	10	30	150/200/250/300/350/400/500/600/700/800
26201-1428050X	14/28	14	28	M10	50	207	12	40	200/250/300/350/400/500/600/700/800
26201-1428100X	14/28	14	28	M10	100	307	12	40	200/250/300/350/400/500/600/700/800
26201-1428150X	14/28	14	28	M10	150	407	12	40	200/250/300/350/400/500/600/700/800
26201-1428200X	14/28	14	28	M10	200	507	12	40	200/250/300/350/400/500/600/700/800
26201-1428250X	14/28	14	28	M10	250	607	12	40	200/250/300/350/400/500/600/700/800
26201-1428300X	14/28	14	28	M10	300	707	12	40	200/250/300/350/400/500/600/700/800
26201-1428350X	14/28	14	28	M10	350	807	12	40	200/250/300/350/400/500/600/700/800
26201-1428400X	14/28	14	28	M10	400	907	12	40	200/250/300/350/400/500/600/700/800