

Item description/product images



Description

Material:

Steel 1.0308.

Version:Black oxidised, hardened 57 ± 1 HRC.**Note:**

Spacer tubes for guiding springs. These determine the position of the springs and prevent lateral flexing.

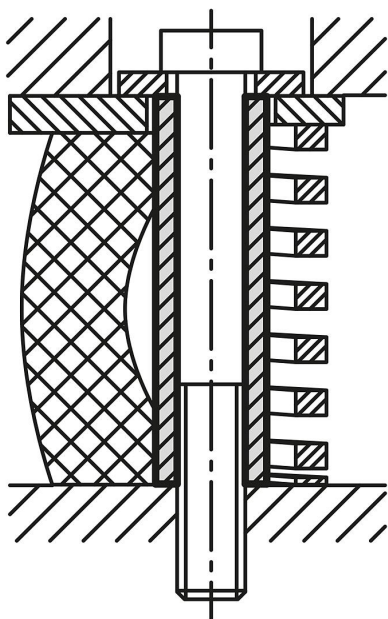

Drawings

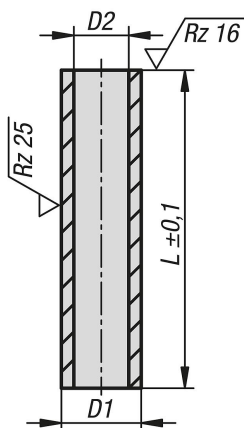

Overview of items

Order No.	D1	D2	L
26095-10070X020	10	7	20
26095-10070X030	10	7	30
26095-10070X040	10	7	40
26095-10070X050	10	7	50
26095-10070X063	10	7	63

Overview of items

Order No.	D1	D2	L
26095-10070X080	10	7	80
26095-12090X030	12,5	9	30
26095-12090X040	12,5	9	40
26095-12090X050	12,5	9	50
26095-12090X063	12,5	9	63
26095-12090X080	12,5	9	80
26095-12090X100	12,5	9	100
26095-13090X020	13	9	20
26095-13090X030	13	9	30
26095-13090X040	13	9	40
26095-13090X050	13	9	50
26095-13090X063	13	9	63
26095-13090X080	13	9	80
26095-13090X100	13	9	100
26095-16110X030	16	11	30
26095-16110X040	16	11	40
26095-16110X050	16	11	50
26095-16110X060	16	11	60
26095-16110X063	16	11	63
26095-16110X080	16	11	80
26095-16110X100	16	11	100
26095-16110X125	16	11	125
26095-16110X160	16	11	160
26095-16110X200	16	11	200
26095-19130X030	19	13	30
26095-19130X040	19	13	40
26095-19130X050	19	13	50
26095-19130X060	19	13	60
26095-19130X063	19	13	63
26095-19130X080	19	13	80
26095-19130X100	19	13	100
26095-19130X125	19	13	125
26095-19130X200	19	13	200
26095-20130X030	20	13	30
26095-20130X040	20	13	40
26095-20130X050	20	13	50
26095-20130X060	20	13	60
26095-20130X063	20	13	63
26095-20130X080	20	13	80
26095-20130X100	20	13	100
26095-20130X125	20	13	125
26095-20130X200	20	13	200
26095-25170X050	25	17	50
26095-25170X060	25	17	60
26095-25170X063	25	17	63
26095-25170X070	25	17	70
26095-25170X080	25	17	80
26095-25170X090	25	17	90
26095-25170X100	25	17	100
26095-25170X125	25	17	125
26095-25170X200	25	17	200
26095-30220X070	30	22	70
26095-30220X080	30	22	80
26095-30220X090	30	22	90
26095-30220X100	30	22	100
26095-30220X120	30	22	120
26095-30220X125	30	22	125
26095-30220X150	30	22	150
26095-30220X200	30	22	200
26095-36260X080	36	26	80
26095-36260X100	36	26	100
26095-36260X125	36	26	125
26095-36260X150	36	26	150
26095-36260X200	36	26	200

