

Shrink discs Form B

Material:

Steel.

Version:

Bright.

Sample order:

nIm 23382-1844

Note:

Shrink disc to connect a hollow hub to a shaft. They are mounted on the OD of the hub and generate pressure on the hub wall by reducing the ID with wedge-formed rings, creating a press fit between the hub and shaft. They are suitable for static, dynamic and shock loads.

- for extremely high torques
- no axial shaft/hub offset when assembling
- self-centring

The version 23380-01-4072 has high tensile ISO 4762 screws.

Assembly:

Remove existing transportation locks. Clean and lightly oil shaft, internal and external hub diameters. Do not use MoS2 or grease. Slide shrink disc onto hub. Then slide unit (shrink disc/hub) onto shaft and position correctly. Gently tighten clamping screws one after the other by hand. Then use a torque wrench to tighten the clamping screws crosswise in several increments to the defined tightening torque MS.

1st increment approx. 33% MS

2nd increment approx. 66% MS

3rd increment 100% MS

Dismantling: Gradually loosen all screws one after the other but do not fully remove from the thread. The shrinking disc usually loosens itself.

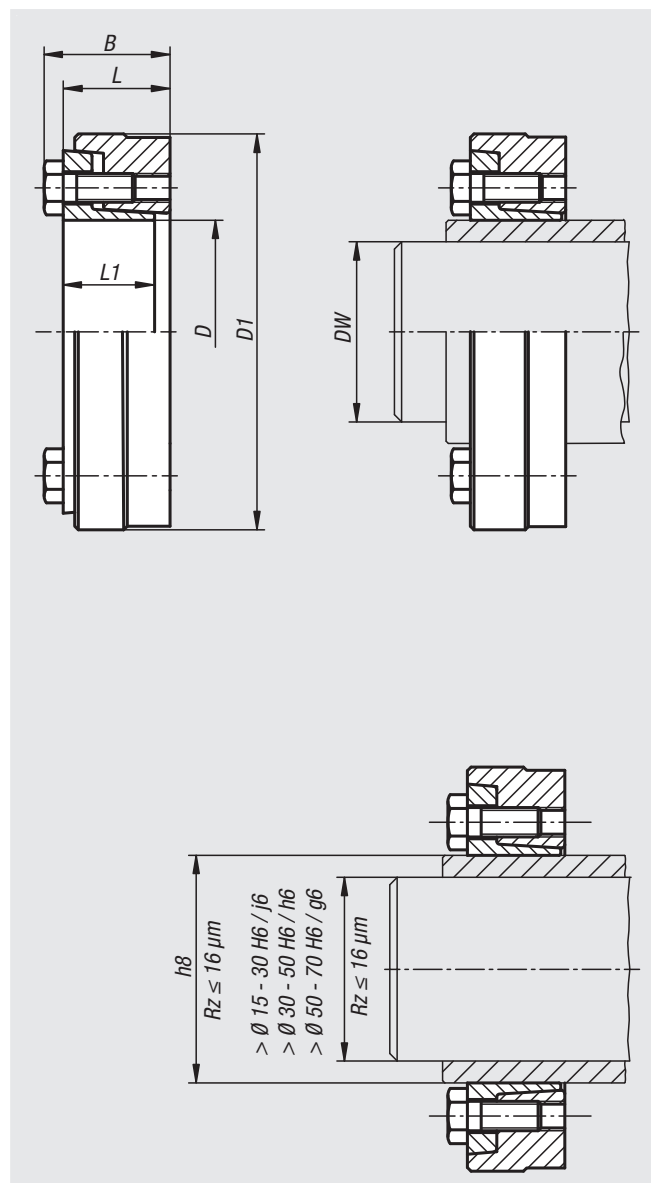

Shrink discs Form B

Order No.	Max. torque M Nm with tightening torque MS	Max. axial force F kN with tightening torque MS	Surface pressure on hub P N/mm ²	No. of screws	Tightening torque MS Nm
23382-1844	80/110	11/14	389	4 x M6	12
23382-2047	150/180	18/20	342	4 x M6	12
23382-2450	160/210/280	17/20/25	329	5 x M6	12
23382-3060	270/320/360	23/25/28	341	6 x M6	12
23382-3672	510/710/950	37/47/58	483	5 x M8	35
23382-3872	480/650/860	36/43/52	460	5 x M8	35
23382-4080	810/880/960	48/50/52	339	6 x M8	35
23382-4480	800/890/1050	52/57/60	341	6 x M8	35
23382-5090	1500/1700/2000	79/87/94	386	8 x M8	35
23382-55100	1600/2000/2400	78/88/99	360	8 x M8	35
23382-60110	2200/2500/2700	92/98/105	316	9 x M8	35
23382-62110	2200/2500/2700	92/98/105	318	9 x M8	35
23382-68115	2400/3000/3800	94/111/128	329	9 x M8	35
23382-75138	3700/4700/5800	135/156/177	424	10 x M10	70
23382-80141	4200/5200/6300	141/160/180	399	10 x M10	70

Order No.	D	D1	DW	B	L	L1
23382-1844	18	44	15/16	19	15	13
23382-2047	20	47	17/18	19,3	15,3	13,5
23382-2450	24	50	19/20/22	22	18	15
23382-3060	30	60	24/25/26	24	20	17
23382-3672	36	72	27/30/33	27,5	22	18,5
23382-3872	38	72	27/30/33	27,5	22	18,5
23382-4080	40	80	34/35/37	29,5	24	20,5
23382-4480	44	80	35/36/37	29,5	24	20,5
23382-5090	50	90	38/40/42	31,5	26	22
23382-55100	55	100	42/45/48	34,5	29	25
23382-60110	60	110	48/50/52	34,5	29	24,5
23382-62110	62	110	48/50/52	34,5	29	24,5
23382-68115	68	115	50/55/60	34,5	29	24,5
23382-75138	75	138	55/60/65	37,5	31	26,3
23382-80141	80	141	60/65/70	37,5	31	26