

Keyless locking couplings Form D

compact design



Material:
Steel.

Version:
Bright.

Sample order:
nlm 23354-0516

Note:
For applications that require a small construction volume and low surface pressure. The keyless locking coupling can be fully recessed in a hub connection.

- for shaft diameters from 5 to 50 mm
- for medium torques
- suitable for hubs with low wall thickness
- minimum axial offset possible
- self-centring

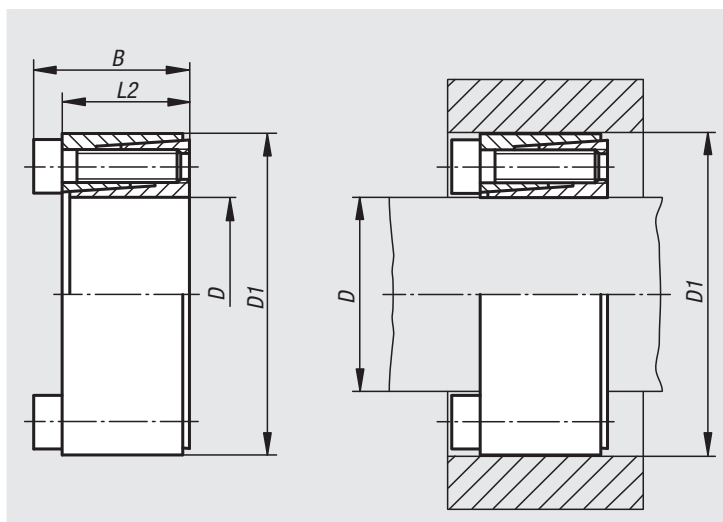

Order No.	D	D1	B	L2	Max. torque M Nm with tightening torque MS	Max. axial force F kN with tightening torque MS
23354-0516	5	16	13,5	11	6	2
23354-0616	6	16	13,5	11	6	2
23354-063516	6,35	16	13,5	11	6	2
23354-0717	7	17	13,5	11	8	2
23354-0818	8	18	13,5	11	10	2,5
23354-0920	9	20	15,5	13	15	3
23354-095320	9,53	20	15,5	13	15	3
23354-1020	10	20	15,5	13	15	3
23354-1122	11	22	15,5	13	18	3
23354-1222	12	22	15,5	13	20	3
23354-1426	14	26	20	17	35	5
23354-1528	15	28	20	17	40	5
23354-1632	16	32	21	17	70	8
23354-1735	17	35	25	21	75	8
23354-1835	18	35	25	21	80	8
23354-1935	19	35	25	21	85	8
23354-2038	20	38	26	21	150	15
23354-2240	22	40	26	21	160	14
23354-2447	24	47	32	26	250	20
23354-2547	25	47	32	26	260	20
23354-25447	25,4	47	32	26	265	20
23354-2850	28	50	32	26	440	30
23354-3055	30	55	32	26	470	30
23354-3255	32	55	32	26	500	30
23354-3560	35	60	37	29	730	40
23354-3865	38	65	37	29	800	40
23354-4065	40	65	37	29	840	40
23354-4275	42	75	44	36	1200	55
23354-4575	45	75	44	36	1300	55
23354-4880	48	80	44	36	1850	75
23354-5080	50	80	44	36	1900	75

Keyless locking couplings Form D

compact design

Assembly:

Lightly oil keyless locking coupling on the tapered faces and contact points of the shaft and hub. Do not use MoS2 or grease. Insert keyless locking coupling in the hub seat and slide onto shaft. Tighten screws crosswise in several increments to the defined tightening torque.

Dismantling: Remove all screws and screw into the extraction threads of the front flange. Tighten screws crosswise in several steps until the keyless locking coupling loosens.

Tolerances:

Shaft:

Recommended tolerance h8.

Surface quality $R_z \leq 16 \mu\text{m}$.

Hub:

Recommended tolerance H8.

Surface quality $R_z \leq 16 \mu\text{m}$.

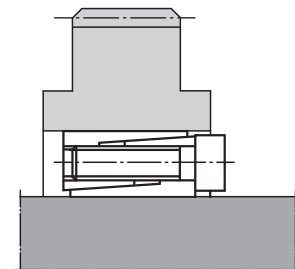

Order No.	Surface pressure on shaft P N/mm ²	Surface pressure on hub P N/mm ²	No. of screws	Tightening torque MS Nm
23354-0516	150	55	3 x M2,5	1,2
23354-0616	150	55	3 x M2,5	1,2
23354-063516	140	55	3 x M2,5	1,2
23354-0717	125	55	3 x M2,5	1,2
23354-0818	110	50	3 x M2,5	1,2
23354-0920	120	55	4 x M2,5	1,2
23354-095320	110	55	4 x M2,5	1,2
23354-1020	110	55	4 x M2,5	1,2
23354-1122	100	50	4 x M2,5	1,2
23354-1222	90	50	4 x M2,5	1,2
23354-1426	105	55	4 x M3	2,1
23354-1528	100	50	4 x M3	2,1
23354-1632	130	65	4 x M4	4,9
23354-1735	120	60	4 x M4	4,9
23354-1835	115	60	4 x M4	4,9
23354-1935	110	60	4 x M4	4,9
23354-2038	140	75	4 x M5	9,7
23354-2240	130	70	4 x M5	17
23354-2447	140	75	4 x M6	17
23354-2547	135	75	4 x M6	17
23354-25447	130	75	4 x M6	17
23354-2850	185	100	6 x M6	17
23354-3055	175	95	6 x M6	17
23354-3255	165	95	6 x M6	17
23354-3560	165	95	8 x M6	17
23354-3865	155	90	8 x M6	17
23354-4065	145	90	8 x M6	17
23354-4275	165	90	6 x M8	41
23354-4575	155	90	6 x M8	41
23354-4880	195	115	8 x M8	41
23354-5080	185	115	8 x M8	41