

Item description/product images



Description

Material:

Inclined columns low carbon steel 1.7139.

Version:

case-hardened.

Note:

Steel inclined columns with conical collar are the ideal solution for precise guiding tasks in tool and die making. These columns are used for reliable and precise positioning of tools, dies or components.

The inclined columns with conical collar enable precise and consistent alignment of tools and dies. The conical collar serves as a precision guide element that ensures secure positioning and minimises unwanted displacement during the working process.

The inclined columns with conical collar find a multitude of applications in tool and die making. They are used to hold tools, dies or components in precise alignment, whether for machining, injection moulding or other manufacturing processes.

Drawings

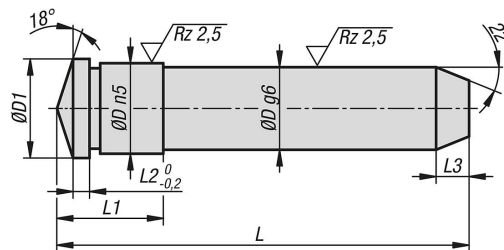

Overview of items

Order No.	D	D1	L	L1	L2	L3
21597-25-10100	10	12	100	13	2	4
21597-25-10120	10	12	120	13	2	4
21597-25-10040	10	12	40	13	2	4
21597-25-10050	10	12	50	13	2	4
21597-25-10060	10	12	60	13	2	4
21597-25-10070	10	12	70	13	2	4
21597-25-10080	10	12	80	13	2	4
21597-25-10090	10	12	90	13	2	4
21597-25-12060	12	15	60	17	3	5
21597-25-12070	12	15	70	17	3	5
21597-25-12080	12	15	80	17	3	5
21597-25-12090	12	15	90	17	3	5
21597-25-12100	12	15	100	17	3	5
21597-25-12110	12	15	110	17	3	5
21597-25-12120	12	15	120	17	3	5
21597-25-12140	12	15	140	17	3	5
21597-25-12160	12	15	160	17	3	5
21597-25-14060	14	17	60	17	3	5
21597-25-14070	14	17	70	17	3	5
21597-25-14080	14	17	80	17	3	5
21597-25-14090	14	17	90	17	3	5
21597-25-14100	14	17	100	17	3	5

Overview of items

Order No.	D	D1	L	L1	L2	L3
21597-25-14110	14	17	110	17	3	5
21597-25-14120	14	17	120	17	3	5
21597-25-14140	14	17	140	17	3	5
21597-25-14160	14	17	160	17	3	5
21597-25-16060	16	19	60	22	3	5
21597-25-16070	16	19	70	22	3	5
21597-25-16080	16	19	80	22	3	5
21597-25-16090	16	19	90	22	3	5
21597-25-16100	16	19	100	22	3	5
21597-25-16110	16	19	110	22	3	5
21597-25-16120	16	19	120	22	3	5
21597-25-16140	16	19	140	22	3	5
21597-25-16160	16	19	160	22	3	5
21597-25-16180	16	19	180	22	3	5
21597-25-16200	16	19	200	22	3	5
21597-25-18060	18	21	60	22	3	7
21597-25-18070	18	21	70	22	3	7
21597-25-18080	18	21	80	22	3	7
21597-25-18090	18	21	90	22	3	7
21597-25-18100	18	21	100	22	3	7
21597-25-18110	18	21	110	22	3	7
21597-25-18120	18	21	120	22	3	7
21597-25-18140	18	21	140	22	3	7
21597-25-18160	18	21	160	22	3	7
21597-25-18180	18	21	180	22	3	7
21597-25-18200	18	21	200	22	3	7
21597-25-18220	18	21	220	22	3	7
21597-25-18240	18	21	240	22	3	7
21597-25-20080	20	23	80	22	4	7
21597-25-20090	20	23	90	22	4	7
21597-25-20100	20	23	100	22	4	7
21597-25-20110	20	23	110	22	4	7
21597-25-20120	20	23	120	22	4	7
21597-25-20140	20	23	140	22	4	7
21597-25-20160	20	23	160	22	4	7
21597-25-20180	20	23	180	22	4	7
21597-25-20200	20	23	200	22	4	7
21597-25-20220	20	23	220	22	4	7
21597-25-20240	20	23	240	22	4	7
21597-25-22060	22	25	60	27	4	7
21597-25-22080	22	25	80	27	4	7
21597-25-22100	22	25	100	27	4	7
21597-25-22120	22	25	120	27	4	7
21597-25-22140	22	25	140	27	4	7
21597-25-22160	22	25	160	27	4	7
21597-25-22180	22	25	180	27	4	7
21597-25-22200	22	25	200	27	4	7
21597-25-22220	22	25	220	27	4	7
21597-25-22240	22	25	240	27	4	7
21597-25-24080	24	27	80	27	4	7
21597-25-24100	24	27	100	27	4	7
21597-25-24120	24	27	120	27	4	7
21597-25-24140	24	27	140	27	4	7
21597-25-24160	24	27	160	27	4	7
21597-25-24180	24	27	180	27	4	7
21597-25-24200	24	27	200	27	4	7
21597-25-24220	24	27	220	27	4	7
21597-25-24240	24	27	240	27	4	7
21597-25-24280	24	27	280	27	4	7
21597-25-30100	30	35	100	36	5	7
21597-25-30120	30	35	120	36	5	7
21597-25-30140	30	35	140	36	5	7
21597-25-30160	30	35	160	36	5	7
21597-25-30180	30	35	180	36	5	7
21597-25-30200	30	35	200	36	5	7

Overview of items

Order No.	D	D1	L	L1	L2	L3
21597-25-30220	30	35	220	36	5	7
21597-25-30240	30	35	240	36	5	7
21597-25-30280	30	35	280	36	5	7
21597-25-30320	30	35	320	36	5	7
21597-25-30360	30	35	360	36	5	7