

Item description/product images



Description

Material:

Ejector pins low carbon steel 1.7139.

Version:

case-hardened.

Note:

Steel ejector pins for tool and die making offer a reliable solution for precise ejection and removal tasks in demanding manufacturing processes. These ejector pins stand for precision, robustness and durability.

Steel ejector pins provide excellent stability and resilience. They are used to eject moulded parts, injection moulded parts or other workpieces safely and precisely from dies or tools.

The ejector pins are equipped with a precise guide that ensures smooth movement. This enables smooth de-moulding and ejection processes that increase the quality of the end products while minimising wear.

Drawings

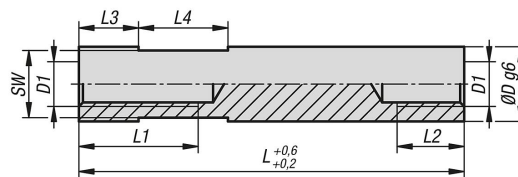

Overview of items

| Order No. | D | D1 | L | L1 | L2 | L3 | L4 | SW |
|----------------|----|-----|-----|----|----|----|----|----|
| 21597-20-10060 | 10 | M6 | 60 | 16 | 9 | 8 | 12 | 9 |
| 21597-20-10070 | 10 | M6 | 70 | 16 | 9 | 8 | 12 | 9 |
| 21597-20-10080 | 10 | M6 | 80 | 16 | 9 | 8 | 12 | 9 |
| 21597-20-10100 | 10 | M6 | 100 | 16 | 9 | 8 | 12 | 9 |
| 21597-20-10120 | 10 | M6 | 120 | 16 | 9 | 8 | 12 | 9 |
| 21597-20-10140 | 10 | M6 | 140 | 16 | 9 | 8 | 12 | 9 |
| 21597-20-14060 | 14 | M8 | 60 | 20 | 11 | 8 | 14 | 12 |
| 21597-20-14070 | 14 | M8 | 70 | 20 | 11 | 8 | 14 | 12 |
| 21597-20-14080 | 14 | M8 | 80 | 20 | 11 | 8 | 14 | 12 |
| 21597-20-14100 | 14 | M8 | 100 | 20 | 11 | 8 | 14 | 12 |
| 21597-20-14120 | 14 | M8 | 120 | 20 | 11 | 8 | 14 | 12 |
| 21597-20-14140 | 14 | M8 | 140 | 20 | 11 | 8 | 14 | 12 |
| 21597-20-14160 | 14 | M8 | 160 | 20 | 11 | 8 | 14 | 12 |
| 21597-20-14180 | 14 | M8 | 180 | 20 | 11 | 8 | 14 | 12 |
| 21597-20-14200 | 14 | M8 | 200 | 20 | 11 | 8 | 14 | 12 |
| 21597-20-18070 | 18 | M10 | 70 | 30 | 12 | 10 | 16 | 14 |
| 21597-20-18080 | 18 | M10 | 80 | 30 | 12 | 10 | 16 | 14 |
| 21597-20-18100 | 18 | M10 | 100 | 30 | 12 | 10 | 16 | 14 |
| 21597-20-18120 | 18 | M10 | 120 | 30 | 12 | 10 | 16 | 14 |
| 21597-20-18140 | 18 | M10 | 140 | 30 | 12 | 10 | 16 | 14 |
| 21597-20-18160 | 18 | M10 | 160 | 30 | 12 | 10 | 16 | 14 |
| 21597-20-18180 | 18 | M10 | 180 | 30 | 12 | 10 | 16 | 14 |
| 21597-20-18200 | 18 | M10 | 200 | 30 | 12 | 10 | 16 | 14 |
| 21597-20-18220 | 18 | M10 | 220 | 30 | 12 | 10 | 16 | 14 |
| 21597-20-18240 | 18 | M10 | 240 | 30 | 12 | 10 | 16 | 14 |
| 21597-20-20080 | 20 | M12 | 80 | 35 | 14 | 10 | 16 | 17 |

Overview of items

| Order No. | D | D1 | L | L1 | L2 | L3 | L4 | SW |
|----------------|----|-----|-----|----|----|----|----|----|
| 21597-20-20100 | 20 | M12 | 100 | 35 | 14 | 10 | 16 | 17 |
| 21597-20-20120 | 20 | M12 | 120 | 35 | 14 | 10 | 16 | 17 |
| 21597-20-20140 | 20 | M12 | 140 | 35 | 14 | 10 | 16 | 17 |
| 21597-20-20160 | 20 | M12 | 160 | 35 | 14 | 10 | 16 | 17 |
| 21597-20-20180 | 20 | M12 | 180 | 35 | 14 | 10 | 16 | 17 |
| 21597-20-20200 | 20 | M12 | 200 | 35 | 14 | 10 | 16 | 17 |
| 21597-20-20220 | 20 | M12 | 220 | 35 | 14 | 10 | 16 | 17 |
| 21597-20-20240 | 20 | M12 | 240 | 35 | 14 | 10 | 16 | 17 |
| 21597-20-24070 | 24 | M12 | 70 | 35 | 14 | 12 | 22 | 19 |
| 21597-20-24080 | 24 | M12 | 80 | 35 | 14 | 12 | 22 | 19 |
| 21597-20-24100 | 24 | M12 | 100 | 35 | 14 | 12 | 22 | 19 |
| 21597-20-24120 | 24 | M12 | 120 | 35 | 14 | 12 | 22 | 19 |
| 21597-20-24140 | 24 | M12 | 140 | 35 | 14 | 12 | 22 | 19 |
| 21597-20-24160 | 24 | M12 | 160 | 35 | 14 | 12 | 22 | 19 |
| 21597-20-24180 | 24 | M12 | 180 | 35 | 14 | 12 | 22 | 19 |
| 21597-20-24200 | 24 | M12 | 200 | 35 | 14 | 12 | 22 | 19 |
| 21597-20-24220 | 24 | M12 | 220 | 35 | 14 | 12 | 22 | 19 |
| 21597-20-24240 | 24 | M12 | 240 | 35 | 14 | 12 | 22 | 19 |
| 21597-20-24260 | 24 | M12 | 260 | 35 | 14 | 12 | 22 | 19 |
| 21597-20-24280 | 24 | M12 | 280 | 35 | 14 | 12 | 22 | 19 |
| 21597-20-30180 | 30 | M16 | 180 | 40 | 16 | 14 | 28 | 24 |
| 21597-20-30220 | 30 | M16 | 220 | 40 | 16 | 14 | 28 | 24 |
| 21597-20-30260 | 30 | M16 | 260 | 40 | 16 | 14 | 28 | 24 |
| 21597-20-30300 | 30 | M16 | 300 | 40 | 16 | 14 | 28 | 24 |
| 21597-20-30340 | 30 | M16 | 340 | 40 | 16 | 14 | 28 | 24 |
| 21597-20-40260 | 40 | M20 | 260 | 55 | 35 | 36 | 20 | 36 |
| 21597-20-40300 | 40 | M20 | 300 | 55 | 35 | 36 | 20 | 36 |
| 21597-20-40340 | 40 | M20 | 340 | 55 | 35 | 36 | 20 | 36 |
| 21597-20-40380 | 40 | M20 | 380 | 55 | 35 | 36 | 20 | 36 |