

Round slings



Material:
Polyester.

Version:
Single sleeve.

Sample order:
nlm 07798-0100005

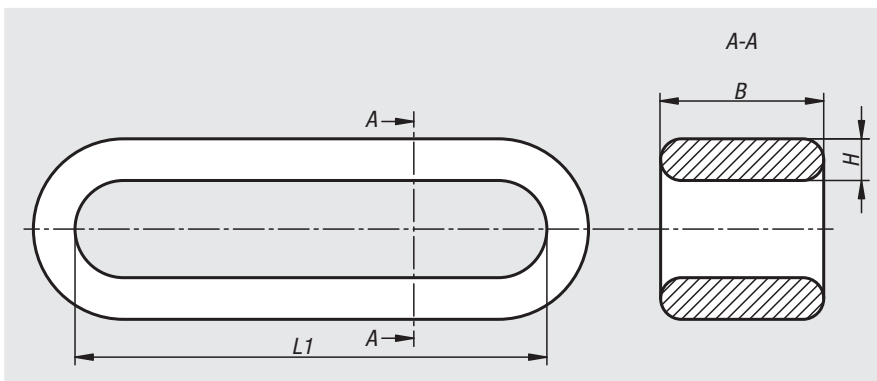

Note:
The round slings comply with DIN EN 1492-2. They are made of high-strength endless polyester fibre cords. These polyester fibre cords are protected by a sturdy and seamlessly woven polyester sleeve. This sleeve surface is also impregnated with polyurethane to make it abrasion-proof. The working load limit (WLL) and the cord tonnage (tonne capacity per cord) are either woven into or printed on the protective sleeve of the sling. The safety label with the CE mark and technical data is firmly sewn onto the sling.

The colour of the round sling corresponds to the colour code scheme for load capacities of textile type slings.

These round slings have high UV resistance and low moisture absorption.

Safety factor 7:1
Example: WLL 1000kg = break load 7000kg.

These round slings carry the CE mark according to the European machinery directive.

Temperature range:
-40 °C to +100 °C.

		Working load limit (WLL) (t) with round slings						Working load limit (WLL) (t) with 2 round slings				
Sling configuration												
Type		simple direct	simple laced	parallel	*Sling angle β over 7-45° over 45-60°		*Sling angle β over 7-45° over 45-60°		direct *Sling angle β over 7-45° over 45-60°		laced *Sling angle β over 7-45° over 45-60°	
**load hoisting factor	Colour	1,0	0,8	2,0	1,4	1,0	0,7	0,5	1,4	1,0	1,12	0,8
1 t	violet	1 t	0,8 t	2 t	1,4 t	1 t	0,7 t	0,5 t	1,4 t	1 t	1,12 t	0,8 t
2 t	green	2 t	1,6 t	4 t	2,8 t	2 t	1,4 t	1,0 t	2,8 t	2 t	2,24 t	1,6 t
3 t	yellow	3 t	2,4 t	6 t	4,2 t	3 t	2,1 t	1,5 t	4,2 t	3 t	3,36 t	2,4 t
4 t	grey	4 t	3,2 t	8 t	5,6 t	4 t	2,8 t	2,0 t	5,6 t	4 t	4,48 t	3,2 t
5 t	red	5 t	4,0 t	10 t	7,0 t	5 t	3,5 t	2,5 t	7,0 t	5 t	5,60 t	4,0 t

*inclination angle β reduces the WLL. Inclination angles over 60° are not permitted.
** The load hoisting factor takes into account the change in WLL due to the sling type.

Order No. violet	Order No. green	Order No. yellow	Order No. grey	Order No. red	B	H	L1	Permissible load kg
07798-0100005	07798-0200005	07798-0300005	07798-0400005	07798-0500005	47/48/54/70/72	12/18/20/22/28	0,5 m	1000/2000/3000/4000/5000
07798-0100010	07798-0200010	07798-0300010	07798-0400010	07798-0500010	47/48/54/70/72	12/18/20/22/28	1 m	1000/2000/3000/4000/5000
07798-0100015	07798-0200015	07798-0300015	07798-0400015	07798-0500015	47/48/54/70/72	12/18/20/22/28	1,5 m	1000/2000/3000/4000/5000
07798-0100020	07798-0200020	07798-0300020	07798-0400020	07798-0500020	47/48/54/70/72	12/18/20/22/28	2 m	1000/2000/3000/4000/5000
07798-0100025	07798-0200025	07798-0300025	07798-0400025	07798-0500025	47/48/54/70/72	12/18/20/22/28	2,5 m	1000/2000/3000/4000/5000
07798-0100030	07798-0200030	07798-0300030	07798-0400030	07798-0500030	47/48/54/70/72	12/18/20/22/28	3 m	1000/2000/3000/4000/5000
07798-0100040	07798-0200040	07798-0300040	07798-0400040	07798-0500040	47/48/54/70/72	12/18/20/22/28	4 m	1000/2000/3000/4000/5000
07798-0100050	07798-0200050	07798-0300050	07798-0400050	07798-0500050	47/48/54/70/72	12/18/20/22/28	5 m	1000/2000/3000/4000/5000