

Threaded inserts self-tapping

with cutting slot



Material:

Steel or 1.4305 stainless steel

Version:

Steel case hardened, electro zinc-plated.
Stainless steel bright.

Sample order:

nIm 07652-03

Note:

Self-tapping threaded inserts for making high-strength, wear-free, vibration resistant screw connections in materials with low shear strength such as aluminium and aluminium alloys, brass, bronze, cast iron, duro and thermoplastics.

The threaded inserts are tapered at the bottom and have a cutting slot. By screwing in they cut their own threads inside a receiver hole. This guarantees a completely secure and firm anchoring in the host material.

Internal thread D1 acc. to ISO 6H.

The threaded inserts with cutting slot spring slightly inwards in the slot region in some materials. This results in a screw locking effect. If this is not desired, we recommend the threaded inserts with a cutting bore.

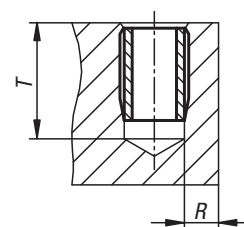
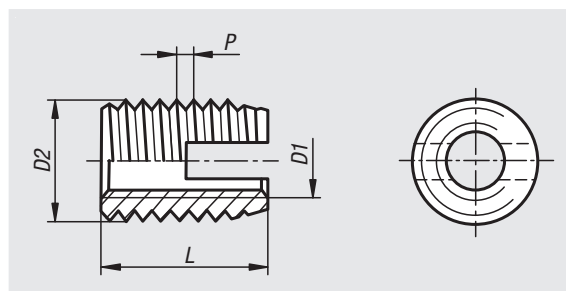

Order No.	Main material	D1 internal thread	D2	L length	P	T min.	R min. light metal	R min. cast iron	R min. plastics	Order No. Hand ass. tool	Order No. M/C ass. tool
07652-03	steel	M3	5	6	0,5	8	1	1,5	1,25	07652-803	07652-903
07652-04	steel	M4	6,5	8	0,75	10	1,3	1,95	1,6	07652-804	07652-904
07652-05	steel	M5	8	10	1	13	1,6	2,4	2	07652-805	07652-905
07652-06	steel	M6	10	14	1,5	17	2	3	2,5	07652-806	07652-906
07652-08	steel	M8	12	15	1,5	18	2,4	3,6	3	07652-808	07652-908
07652-10	steel	M10	14	18	1,5	22	2,8	4,2	3,5	07652-810	07652-910
07652-12	steel	M12	16	22	1,5	26	3,2	4,8	4	07652-812	07652-912
07652-16	steel	M16	20	22	1,5	27	4	6	5	-	07652-916
07652-103	stainless steel	M3	5	6	0,5	8	1	1,5	1,25	07652-803	07652-903
07652-104	stainless steel	M4	6,5	8	0,75	10	1,3	1,95	1,6	07652-804	07652-904
07652-105	stainless steel	M5	8	10	1	13	1,6	2,4	2	07652-805	07652-905
07652-106	stainless steel	M6	10	14	1,5	17	2	3	2,5	07652-806	07652-906
07652-108	stainless steel	M8	12	15	1,5	18	2,4	3,6	3	07652-808	07652-908
07652-110	stainless steel	M10	14	18	1,5	22	2,8	4,2	3,5	07652-810	07652-910
07652-112	stainless steel	M12	16	22	1,5	26	3,2	4,8	4	07652-812	07652-912
07652-116	stainless steel	M16	20	22	1,5	27	4	6	5	-	07652-916

Assembly tools

for self-tapping threaded inserts

Material:

Steel.

Version:

Hand assembly tool, electro zinc-plated.

Machine assembly tool, black oxidised.

Sample order:

nIm 07652-803

Note:

The turning in by hand is carried out with the manual assembly tool and a cordless screwdriver, ratchet, socket etc. Machine assembly is carried out with the machine assembly tool preferably on a thread-cutting machine.

Hand assembly tool

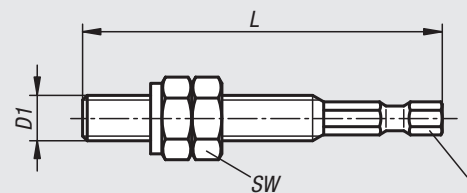

Machine assembly tool

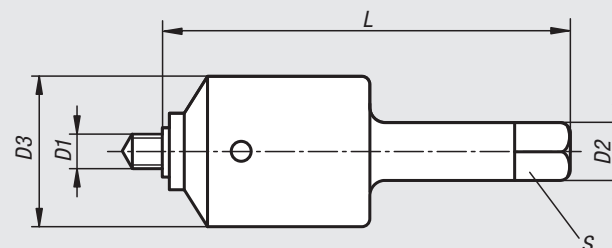

Order No.	Version 1	D1 internal thread	D2	D3	L length	S	SW	Insertion torque ref. values Nm	RPM ref. values for light metal
07652-803	manual operation	M3	-	-	46	1/4	5,5	2,5	-
07652-804	manual operation	M4	-	-	48	1/4	7	5,5	-
07652-805	manual operation	M5	-	-	57	1/4	8	10	-
07652-806	manual operation	M6	-	-	62	1/4	10	15	-
07652-808	manual operation	M8	-	-	72	1/4	13	28	-
07652-810	manual operation	M10	-	-	82	1/4	17	40	-
07652-812	manual operation	M12	-	-	92	1/4	19	60	-
07652-903	machine type	M3	8	18	80	6	-	2,5	650 - 900
07652-904	machine type	M4	8	18	80	6	-	5,5	400 - 600
07652-905	machine type	M5	12,5	30	96,5	10	-	10	400 - 600
07652-906	machine type	M6	12,5	30	96,5	10	-	15	280 - 400
07652-908	machine type	M8	12,5	30	96,5	10	-	28	280 - 400
07652-910	machine type	M10	13	40	110	10	-	40	200 - 300
07652-912	machine type	M12	13	40	110	10	-	60	200 - 300
07652-916	machine type	M16	13	40	110	10	-	160	150 - 200