

Conical spring washers

DIN 6796

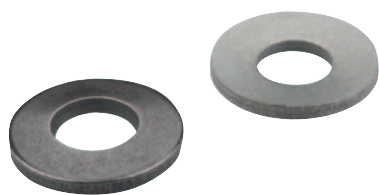

Material:
Spring steel

Version:
Hardened, bright, oiled or mechanically galvanised.

Sample order:
nlm 07303-03

Note:
The special shape (formed like a disc spring) enables the conical spring washer to achieve a high spring effect. The spring force resulting from the flattening load washer amounts to 70–90% of the corresponding contact pressure of a screw of grade 8.8–10.9.

Conical spring washers are used to compensate for subsidence formation in screw connections and to prevent a loosening or unfastening of the connection. The locking effect is purely frictional.

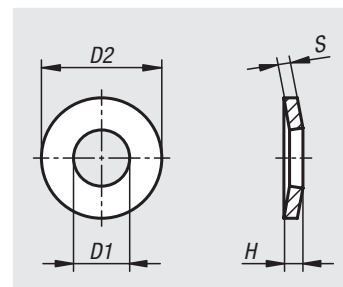

Order No. hardened, bright and oiled	Order No. passivated	for screws	D1	D2	H	S
07303-04	07303-104	M4	4,3	9	1,3	1
07303-05	07303-105	M5	5,3	11	1,55	1,2
07303-06	07303-106	M6	6,4	14	2	1,5
07303-08	07303-108	M8	8,4	18	2,6	2
07303-10	07303-110	M10	10,5	23	3,2	2,5
07303-12	07303-112	M12	13	29	3,95	3
07303-14	07303-114	M14	15	35	4,65	3,5
07303-16	07303-116	M16	17	39	5,25	4
07303-18	07303-118	M18	19	42	5,8	4,5
07303-20	07303-120	M20	21	45	6,4	5
07303-22	07303-122	M22	23	49	7,05	5,5
07303-24	07303-124	M24	25	56	7,75	6
07303-30	07303-130	M30	31	70	9,2	7