

Hexagon head bolts

DIN 933

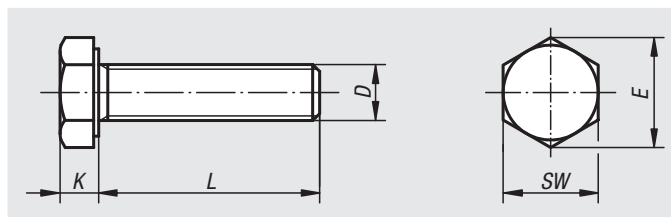

Material:

Steel, stainless steel A2 or stainless steel A4.

Version:

Steel grade 8.8, black or electro zinc-plated.
 Steel grade 10.9, black or electro zinc-plated.
 Steel grade 12.9, black.
 Stainless steel A2-70, bright.
 Stainless steel A4-70, bright.

Sample order:

nIm 07171-04X10 (include length L)

| Order No. steel Grade 8.8 | Order No. steel Grade 10.9 | Main colour | D | E | K | L | SW |
|---------------------------------|----------------------------------|----------------|-----|-------|------|--|----|
| 07171-04X | - | black | M4 | 7,66 | 2,8 | 10/12/16/18/20/25 | 7 |
| 07171-05X | - | black | M5 | 8,79 | 3,5 | 10/12/16/18/20/25/30/35/40 | 8 |
| 07171-06X | 07171-306X | black | M6 | 11,05 | 4 | 10/12/16/18/20/25/30/35/40/45/50/55/60 | 10 |
| 07171-08X | 07171-308X | black | M8 | 14,38 | 5,3 | 16/18/20/25/30/35/40/45/50/60/70/80/90/100 | 13 |
| 07171-10X | 07171-310X | black | M10 | 18,9 | 6,4 | 16/18/20/25/30/35/40/45/50/60/70/80/90/100 | 17 |
| 07171-12X | 07171-312X | black | M12 | 21,1 | 7,5 | 20/25/30/35/40/45/50/60/70/80/90/100/110/120 | 19 |
| 07171-14X | - | black | M14 | 24,49 | 8,8 | 30/35/40/45/50/60/70/80/90/100/110/120 | 22 |
| 07171-16X | 07171-316X | black | M16 | 26,75 | 10 | 30/35/40/45/50/60/70/80/90/100/110/120 | 24 |
| 07171-20X | 07171-320X | black | M20 | 33,53 | 12,5 | 40/45/50/60/70/80/90/100/110/120 | 30 |
| 07171-404X | - | - | M4 | 7,66 | 2,8 | 10/12/16/18/20/25 | 7 |
| 07171-405X | - | - | M5 | 8,79 | 3,5 | 10/12/16/18/20/25/30/35/40 | 8 |
| 07171-406X | 07171-506X | - | M6 | 11,05 | 4 | 10/12/16/18/20/25/30/35/40/45/50/55/60 | 10 |
| 07171-408X | 07171-508X | - | M8 | 14,38 | 5,3 | 16/18/20/25/30/35/40/45/50/60/70/80/90/100 | 13 |
| 07171-410X | 07171-510X | - | M10 | 18,9 | 6,4 | 16/18/20/25/30/35/40/45/50/60/70/80/90/100 | 17 |
| 07171-412X | 07171-512X | - | M12 | 21,1 | 7,5 | 20/25/30/35/40/45/50/60/70/80/90/100/110/120 | 19 |
| 07171-414X | - | - | M14 | 24,49 | 8,8 | 30/35/40/45/50/60/70/80/90/100/110/120 | 22 |
| 07171-416X | 07171-516X | - | M16 | 26,75 | 10 | 30/35/40/45/50/60/70/80/90/100/110/120 | 24 |
| 07171-420X | 07171-520X | - | M20 | 33,53 | 12,5 | 40/45/50/60/70/80/90/100/110/120 | 30 |

Hexagon head bolts

DIN 933

| Order No. | Main material | Grade | D | E | K | L | SW |
|------------|---------------|-------|-----|-------|------|--------------------------------|----|
| 07171-206X | steel | 12.9 | M6 | 11,05 | 4 | 12/16/20/25/30 | 10 |
| 07171-208X | steel | 12.9 | M8 | 14,38 | 5,3 | 16/20/25/30/35/40/45/50/60 | 13 |
| 07171-210X | steel | 12.9 | M10 | 18,9 | 6,4 | 20/25/30/35/40/45/50/60 | 17 |
| 07171-212X | steel | 12.9 | M12 | 21,1 | 7,5 | 25/30/35/40/45/50/60 | 19 |
| 07171-216X | steel | 12.9 | M16 | 26,75 | 10 | 30/35/40/45/50/60/70/80/90/100 | 24 |
| 07171-220X | steel | 12.9 | M20 | 33,53 | 12,5 | 40/45/50/60/70/80/90/100 | 30 |

| Order No. A2 | Order No. A4 | Main material | D | E | K | L | SW |
|-----------------|-----------------|-----------------|-----|-------|------|--|-----|
| 07171-104X | 07171-604X | stainless steel | M4 | 7,66 | 2,8 | 10/12/16/18/20/25/8 | 7 |
| 07171-105X | 07171-605X | stainless steel | M5 | 8,79 | 3,5 | 10/12/16/18/20/25/30/35/40 | 8 |
| 07171-106X | 07171-606X | stainless steel | M6 | 11,05 | 4 | 10/12/16/18/20/25/30/35/40/45/50/55/60 | 10 |
| 07171-108X | 07171-608X | stainless steel | M8 | 14,38 | 5,3 | 16/18/20/25/30/35/40/45/50/60/70/80/90/100 | 13 |
| 07171-110X | 07171-610X | stainless steel | M10 | 18,9 | 6,4 | 16/18/20/25/30/35/40/45/50/60/70/80/90/100 | 17 |
| 07171-112X | 07171-612X | stainless steel | M12 | 21,1 | 7,5 | 20/25/30/35/40/45/50/60/70/80/90/100/110/120 | 19 |
| 07171-116X | 07171-616X | stainless steel | M16 | 26,75 | 10 | 30/35/40/45/50/60/70/80/90/100/110/120 | 24 |
| 07171-120X | 07171-620X | stainless steel | M20 | 33,53 | 12,5 | 40/45/50/60/70/80/90/100/110/120 | 30 |
| - | 07171-603X | stainless steel | M3 | 6,01 | 2 | 6/8/10 | 5,5 |