

Hexagon head bolts

DIN 931/DIN EN ISO 4014/DIN EN 24014

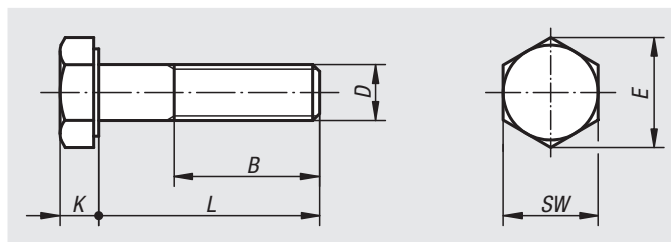

Material:

Steel, stainless steel A2 or stainless steel A4.

Version:

Steel grade 8.8, black or electro zinc-plated.

Steel grade 10.9, black or electro zinc-plated.

Steel grade 12.9, black.

Stainless steel A2-70, bright.

Stainless steel A4-70, bright.

Sample order:

nIm 07170-110X50 (include length L)

Note:

Screws where the dimension L is < B are threaded up to the head.

The screw length or thread length is specified by the dimension L.

Screws where L is > B have a shaft.

On request:

DIN ISO 272 spanner sizes.

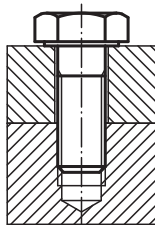

Order No. steel Grade 8.8	Order No. steel Grade 10.9	Surface finish body	D	B	E	K	L	SW
07170-04X	-	bright	M4	14	7,66	2,8	25/30/35/40/45/50	7
07170-05X	-	bright	M5	16	8,79	3,5	25/30/35/40/45/50/60	8
07170-06X	07170-306X	bright	M6	18	11,05	4	30/35/40/45/50/60/70	10
07170-08X	07170-308X	bright	M8	22	14,38	5,3	35/40/45/50/60/70/80	13
07170-10X	07170-310X	bright	M10	26	18,9	6,4	40/45/50/60/70/80/90/100	17
07170-12X	07170-312X	bright	M12	30	21,1	7,5	45/50/60/70/80/90/100/110/120	19
07170-16X	07170-316X	bright	M16	38	26,75	10	60/70/80/90/100/110/120	24
07170-20X	07170-320X	bright	M20	46	33,53	12,5	70/80/90/100/110/120	30
07170-404X	-	galvanised	M4	14	7,66	2,8	25/30/35/40/45/50	7
07170-405X	-	galvanised	M5	16	8,79	3,5	25/30/35/40/45/50/60	8
07170-406X	07170-506X	galvanised	M6	18	11,05	4	30/35/40/45/50/60/70	10
07170-408X	07170-508X	galvanised	M8	22	14,38	5,3	35/40/45/50/60/70/80	13
07170-410X	07170-510X	galvanised	M10	26	18,9	6,4	40/45/50/60/70/80/90/100	17
07170-412X	07170-512X	galvanised	M12	30	21,1	7,5	45/50/60/70/80/90/100/110/120	19
07170-416X	07170-516X	galvanised	M16	38	26,75	10	60/70/80/90/100/110/120	24
07170-420X	07170-520X	galvanised	M20	46	33,53	12,5	70/80/90/100/110/120	30

Hexagon head bolts

DIN 931/DIN EN ISO 4014/DIN EN 24014

Order No. steel Grade 12.9	Surface finish body	D	B	E	K	L	SW
07170-210X	bright	M10	26	18,9	6,4	40/45/50/60/70/80/90/100	17
07170-212X	bright	M12	30	21,1	7,5	45/50/60/70/80/90/100/120	19
07170-216X	bright	M16	38	26,75	10	60/70/80/90/100/120	24
07170-220X	bright	M20	46	33,53	12,5	70/80/90/100/120	30

Order No. A2	Order No. A4	Main material	D	B	E	K	L	SW
07170-105X	07170-605X	stainless steel	M5	16	8,79	3,5	25/30/35/40/45/50/60	8
07170-106X	07170-606X	stainless steel	M6	18	11,05	4	30/35/40/45/50/60/70	10
07170-108X	07170-608X	stainless steel	M8	22	14,38	5,3	35/40/45/50/60/70/80	13
07170-110X	07170-610X	stainless steel	M10	26	18,9	6,4	40/45/50/60/70/80/90/100	17
07170-112X	07170-612X	stainless steel	M12	30	21,1	7,5	45/50/60/70/80/90/100/110/120	19
07170-116X	07170-616X	stainless steel	M16	38	26,75	10	60/70/80/90/100/110/120	24