

# Grub screw with hexagon socket and pointed end

DIN 914 / DIN EN ISO 4027

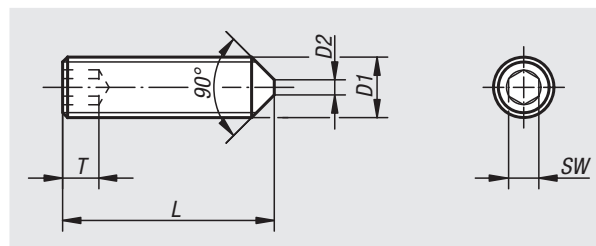

## Material:

Steel or stainless steel (A 2)

## Version:

Steel class 45 H, black.  
Stainless steel A 2-70, bright.

## Sample order:

nIm 07166-110X12 (include length L)

## Note:

By M4x5, M5x5, M5x6, M6x6, M8x8, M10x10 the point angle is 120°.

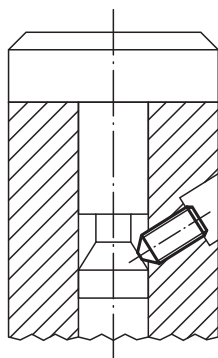

Order No. steel	Order No. stainless steel	D1	D2	L	T	SW
07166-03X	07166-103X	M3	-	5/6/8/10/12/16/20	1,2	1,5
07166-04X	07166-104X	M4	-	5/6/8/10/12/16/20/25	1,5	2
07166-05X	07166-105X	M5	-	5/6/8/10/12/14/16/20/25/30	2	2,5
07166-06X	07166-106X	M6	1,5	6/8/10/12/16/20/25/30/35/40/45/50/60	2	3
07166-08X	07166-108X	M8	2	8/10/12/14/16/20/25/30/35/40/45/50/60	3	4
07166-10X	07166-110X	M10	2,5	10/12/16/20/25/30/35/40/45/50/60/70/80	4	5