

Spherical knobs

revolving

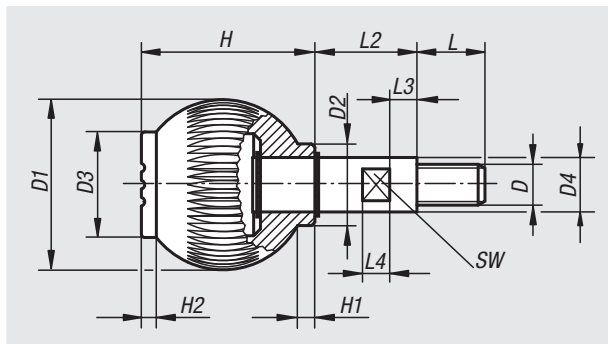

Material:

Thermoplastic, black grey.
Axis steel 5.8 or stainless steel 1.4305.

Version:







Trivalent blue passivated steel or bright stainless steel.
Circlips electro zinc-plated, including stainless steel version.

Sample order:

nIm 06246-1066 (cap colour traffic red)

Note:

Δ Add the desired cap colour here.
No colour code is required for black grey caps.

black grey  RAL 7021	pure orange Δ = 1  RAL 2004	signal green Δ = 2  RAL 6032	traffic blue Δ = 3  RAL 5017
light grey Δ = 5  RAL 7035	traffic red Δ = 6  RAL 3020	colza yellow Δ = 7  RAL 1021	

Order No. steel	Order No. stainless steel	D	D1	D2	D3	D4	H	H1	H2	L	L2	L3	L4	SW
06246-106Δ	06246-0106Δ	M6	25	12	17	8	25	3	2	10	15	5	5	7
06246-208Δ	06246-0208Δ	M8	32	15,5	19	10	33	3,5	2,6	12	20	6	6	8
06246-310Δ	06246-0310Δ	M10	40	19	23	13	41	4	3	15	25	7	10	10
06246-412Δ	06246-0412Δ	M12	50	24	31	16	51	5,5	4,5	20	30	8	8	13

01000
02000
03000
04000
05000
06000
07000
08000
09000
10000
12000