

Spring plungers

with slot and thrust pin, LONG-LOK secured, stainless steel

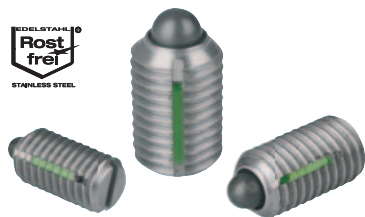

Material:

Sleeve 1.4305.
Thrust pin 1.4034.
Spring 1.4310.

LONG-LOK thread lock Nylon.

Version:

Bright.
Thrust pin hardened.

Sample order:

nIm 03026-10

Drawing reference:

L2 = approx. 2x thread pitch

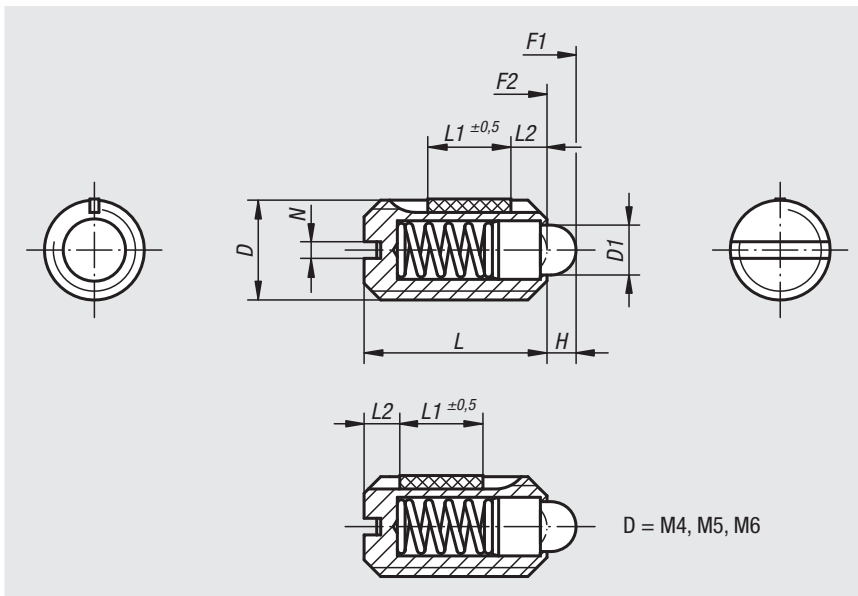

Spring plungers with slot and thrust pin, standard spring force, LONG-LOK secured

Order No.	D	D1	H	L	L1	N	Spring force initial pressure F1 approx. N	Spring force final pressure F2 approx. N	Tightening torque approx. Nm	Loosening torque approx. Nm
03026-04	M4	1,8	1,5	9	5	0,6	6	20	0,18	0,12
03026-05	M5	2,4	2	12	6	0,8	6	20	0,12	0,08
03026-06	M6	2,7	2	14	7	1	7	20	0,44	0,21
03026-08	M8	4	2	16	8	1,2	15	30	1,1	0,38
03026-10	M10	4,5	2,5	19	9	1,6	20	35	1,36	0,62
03026-12	M12	6	3,5	22	10	2	30	55	2,11	1,41
03026-16	M16	8,5	4,5	24	14	2,5	45	100	3,95	3,05

Spring plungers with slot and thrust pin, light spring force, LONG-LOK secured

Order No.	D	D1	H	L	L1	N	Spring force initial pressure F1 approx. N	Spring force final pressure F2 approx. N	Tightening torque approx. Nm	Loosening torque approx. Nm
03026-104	M4	1,8	1,5	9	5	0,6	3	10	0,18	0,12
03026-105	M5	2,4	2	12	6	0,8	3	10	0,12	0,08
03026-106	M6	2,7	2	14	7	1	4	10	0,44	0,21
03026-108	M8	4	2	16	8	1,2	7	15	1,1	0,38
03026-110	M10	4,5	2,5	19	9	1,6	9	16	1,36	0,62
03026-112	M12	6	3,5	22	10	2	14	26	2,11	1,41
03026-116	M16	8,5	4,5	24	14	2,5	22	50	3,95	3,05

Spring plungers with slot and thrust pin, reinforced spring force, LONG-LOK secured

Order No.	D	D1	H	L	L1	N	Spring force initial pressure F1 approx. N	Spring force final pressure F2 approx. N	Tightening torque approx. Nm	Loosening torque approx. Nm
03026-205	M5	2,4	2	12	6	0,8	9	25	0,12	0,08
03026-206	M6	2,7	2	14	7	1	11	25	0,44	0,21
03026-208	M8	4	2	16	8	1,2	22	43	1,1	0,38
03026-210	M10	4,5	2,5	19	9	1,6	20	54	1,36	0,62
03026-212	M12	6	3,5	22	10	2	36	94	2,11	1,41
03026-216	M16	8,5	4,5	24	14	2,5	60	110	3,99	3,05